

NO. OF COPIES RECEIVED	
DISTRIBUTION	
SANTA FE	
FILE	
U.S.G.S.	
LAND OFFICE	
OPERATOR	

NEW MEXICO OIL CONSERVATION COMMISSION
DIVISION OF O. & G. C. C.

SEP 20 8 57 AM '68

Form C-101
Revised 1-1-65

5A. Indicate Type of Lease STATE <input checked="" type="checkbox"/> FEE <input type="checkbox"/>
5. State Oil & Gas Lease No. L - 125
7. Unit Agreement Name
8. Farm or Lease Name New Mexico 'R' State
9. Well No. #1
10. Field and Pool, or Wildcat Undesignated
12. County Lea
19. Proposed Depth 9850
19A. Formation Pennsylvanian
20. Rotary or C.T. Rotary
21. Elevations (Show whether DF, RT, etc.)
21A. Kind & Status Plug. Bond Active
21B. Drilling Contractor
22. Approx. Date Work will start

APPLICATION FOR PERMIT TO DRILL, DEEPEN, OR PLUG BACK

1a. Type of Work b. Type of Well OIL WELL <input checked="" type="checkbox"/> GAS WELL <input type="checkbox"/> OTHER <input type="checkbox"/> DRILL <input checked="" type="checkbox"/> DEEPEN <input type="checkbox"/> PLUG BACK <input type="checkbox"/> SINGLE ZONE <input checked="" type="checkbox"/> MULTIPLE ZONE <input type="checkbox"/>	2. Name of Operator MIDWEST OIL CORPORATION	3. Address of Operator 1500 WILCO BLDG., MIDLAND, TEXAS 79701	4. Location of Well UNIT LETTER P LOCATED 660 FEET FROM THE South LINE AND 660 FEET FROM THE East LINE OF SEC. 2 TWP. 9-S RGE. 34-E NMPM	5. State Oil & Gas Lease No. L - 125	6. Farm or Lease Name New Mexico 'R' State	7. Unit Agreement Name	8. Field and Pool, or Wildcat Undesignated	9. Well No. #1	10. County Lea	11. Proposed Depth 9850	12. Formation Pennsylvanian	13. Rotary or C.T. Rotary	14. Elevations (Show whether DF, RT, etc.)	15. Kind & Status Plug. Bond Active	16. Drilling Contractor	17. Approx. Date Work will start
--	---	---	--	--	--	------------------------	--	--------------------------	--------------------------	-----------------------------------	---------------------------------------	-------------------------------------	--	---	-------------------------	----------------------------------

23.

PROPOSED CASING AND CEMENT PROGRAM

SIZE OF HOLE	SIZE OF CASING	WEIGHT PER FOOT	SETTING DEPTH	SACKS OF CEMENT	EST. TOP
15	11-3/4	31.2	320	350	Circ.
11	8-5/8	24 & 32	4100	450	
7-7/8	5-1/2	17	9850	350	

APPROVAL VALID
FOR 90 DAYS UNLESS
WORKING COMMENCED

EXPIRES **Dec 28, 1968**

THE COMMISSION MUST BE NOTIFIED
24 HOURS PRIOR TO RUNNING **11 3/4**
CASING.

IN ABOVE SPACE DESCRIBE PROPOSED PROGRAM: IF PROPOSAL IS TO DEEPEN OR PLUG BACK, GIVE DATA ON PRESENT PRODUCTIVE ZONE AND PROPOSED NEW PRODUCTIVE ZONE. GIVE BLOWOUT PREVENTER PROGRAM, IF ANY.

I hereby certify that the information above is true and complete to the best of my knowledge and belief.

Signed Carolyn Turner Title **PRODUCTION CLERK** Date **SEPT. 26, 1968**

(This space for State Use)

APPROVED BY John W. Runyan TITLE _____ DATE _____

CONDITIONS OF APPROVAL, IF ANY:

NEW MEXICO OIL CONSERVATION COMMISSION
WELL LOCATION AND ACREAGE DEDICATION PLAT

Form C-102
 Supersedes C-128
 Effective 1-1-65

All distances must be from the outer boundaries of the Section

Operator MIDWEST OIL CORP.			Lease NEW MEXICO R STATE <i>SEP 30 8 57 AM '68</i>		Well No. 1
Unit Letter P	Section 2	Township 9 SOUTH	Range 34 EAST	County LEA	
Actual Footage Location of Well: 660 feet from the SOUTH line and 660 feet from the EAST line					
Ground Level Elev. 4230.9	Producing Formation Penn	Pool Undesignated		Dedicated Acreage: \$E/4 160 Acres	

1. Outline the acreage dedicated to the subject well by colored pencil or hachure marks on the plat below.
2. If more than one lease is dedicated to the well, outline each and identify the ownership thereof (both as to working interest and royalty).
3. If more than one lease of different ownership is dedicated to the well, have the interests of all owners been consolidated by communitization, unitization, force-pooling, etc?

☐ Yes ☐ No If answer is "yes," type of consolidation _____

If answer is "no," list the owners and tract descriptions which have actually been consolidated. (Use reverse side of this form if necessary.) _____

No allowable will be assigned to the well until all interests have been consolidated (by communitization, unitization, forced-pooling, or otherwise) or until a non-standard unit, eliminating such interests, has been approved by the Commission.

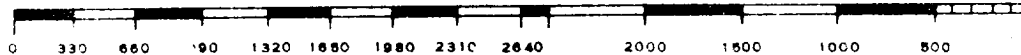
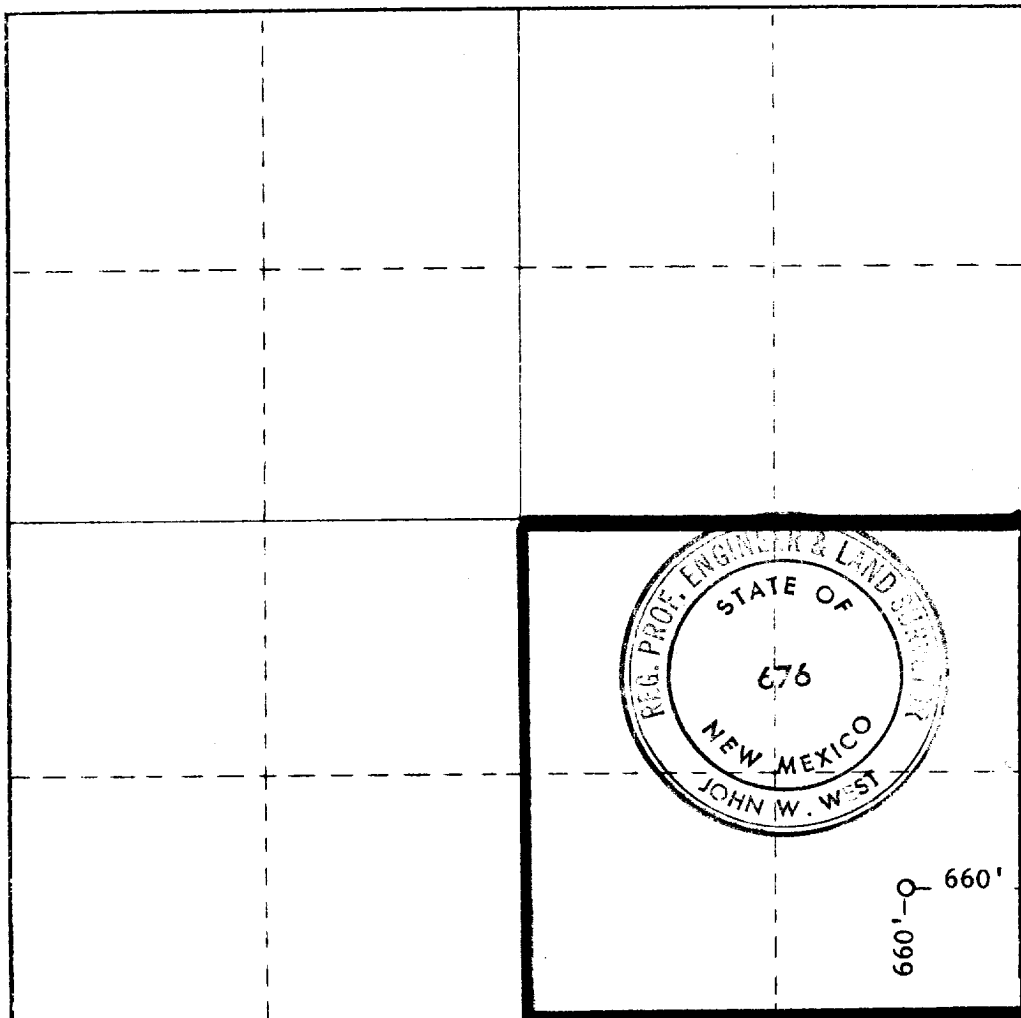

CERTIFICATION

I hereby certify that the information contained herein is true and complete to the best of my knowledge and belief.

Carolyn Turner
 Name

CAROLYN TURNER

Position

PRODUCTION CLERK

Company

MIDWEST OIL CORPORATION

Date

SEPT. 27, 1968

I hereby certify that the well location shown on this plat was plotted from field notes of actual surveys made by me or under my supervision, and that the same is true and correct to the best of my knowledge and belief.

Date Surveyed

SEPT. 25, 1968

Registered Professional Engineer and Land Surveyor

John W. West
 Certificate No. **676**