

NO. OF COPIES RECEIVED	
DISTRIBUTION	
SANTA FE	
FILE	
U.S.G.S.	
LAND OFFICE	
OPERATOR	

NEW MEXICO OIL CONSERVATION COMMISSION
HOBBS OFFICE O. C. C.

May 20 11 49 PM '69

AMENDED

Form C-101
Revised 1-1-65

5A. Indicate Type of Lease STATE <input checked="" type="checkbox"/> FEE <input type="checkbox"/>
5. State Oil & Gas Lease No. B-2148
7. Unit Agreement Name -
8. Farm or Lease Name Leamex
9. Well No. 15
10. Field and Pool, or Wildcat Undesignated
12. County Lea
19. Proposed Depth 4600
19A. Formation Grayburg/San Andres
20. Rotary or C.T. Rotary
21. Elevations (Show whether DF, RT, etc.) later
21A. Kind & Status Plug. Bond blanket
21B. Drilling Contractor later
22. Approx. Date Work will start upon approval

APPLICATION FOR PERMIT TO DRILL, DEEPEN, OR PLUG BACK

1a. Type of Work b. Type of Well OIL WELL <input checked="" type="checkbox"/> GAS WELL <input type="checkbox"/> OTHER <input type="checkbox"/> DRILL <input checked="" type="checkbox"/> DEEPEN <input type="checkbox"/> PLUG BACK <input type="checkbox"/> SINGLE ZONE <input checked="" type="checkbox"/> MULTIPLE ZONE <input type="checkbox"/>	2. Name of Operator Phillips Petroleum Company	3. Address of Operator Room B2 Phillips Bldg., Odessa, Texas 79760	4. Location of Well UNIT LETTER J LOCATED 1980 FEET FROM THE east LINE AND 1880 FEET FROM THE south LINE OF SEC. 21 TWP. 17S RGE. 33E NMPM
23. PROPOSED CASING AND CEMENT PROGRAM			

SIZE OF HOLE	SIZE OF CASING	WEIGHT PER FOOT	SETTING DEPTH	SACKS OF CEMENT	EST. TOP
12-1/4"	8-5/8"	24#	350'	250	circulate
7-7/8"	4-1/2"	11.6#	4600'	275	sufficient to
					cover all productive zones.

APPROVAL VALID
FOR 30 DAYS UNLESS
OR LONGER COMMENCED

EXPIRE **8-21-69**

Series 900 hydraulically operated BOP equipment
Use mud additives as required for control

THE COMMISSION MUST BE NOTIFIED
24 HOURS PRIOR TO RUNNING CASING

Location moved 100' south to clear pipe line

IN ABOVE SPACE DESCRIBE PROPOSED PROGRAM: IF PROPOSAL IS TO DEEPEN OR PLUG BACK, GIVE DATA ON PRESENT PRODUCTIVE ZONE AND PROPOSED NEW PRODUCTIVE ZONE. GIVE BLOWOUT PREVENTER PROGRAM, IF ANY.

I hereby certify that the information above is true and complete to the best of my knowledge and belief.

Signed **W.J. Mueller** Title **Associate Reservoir Engineer** Date **5-15-69**

(This space for State Use)

APPROVED BY **[Signature]** TITLE **SUPERVISOR, DISTRICT 1** DATE **MAY 21 1969**

CONDITIONS OF APPROVAL, IF ANY:

NEW TEXAS OIL CONSERVATION COMMISSION
WELL LOCATION AND ACREAGE DEDICATION PLAT

Form C-102
Supersedes C-128
Effective 1-1-65

AMENDED

All distances must be from the outer boundaries of the Section.

Operator Phillips Petroleum Company			Lease Leamox		Well No. 15
Unit Letter J	Section 21	Township 17-S	Range 33-E	County Lea	
Actual Footage Location of Well: 1880 feet from the south line and 1980 feet from the east line					
Ground Level Elev. later	Producing Formation Grayburg/San Andres	Pool UNDESIGNATED Mojave-Grayburg/San Andres		Dedicated Acreage: 40 Acres	

1. Outline the acreage dedicated to the subject well by colored pencil or hachure marks on the plat below.
2. If more than one lease is dedicated to the well, outline each and identify the ownership thereof (both as to working interest and royalty).
3. If more than one lease of different ownership is dedicated to the well, have the interests of all owners been consolidated by communitization, unitization, force-pooling, etc?

☐ Yes ☐ No If answer is "yes," type of consolidation _____

If answer is "no," list the owners and tract descriptions which have actually been consolidated. (Use reverse side of this form if necessary.) _____

No allowable will be assigned to the well until all interests have been consolidated (by communitization, unitization, forced-pooling, or otherwise) or until a non-standard unit, eliminating such interests, has been approved by the Commission.

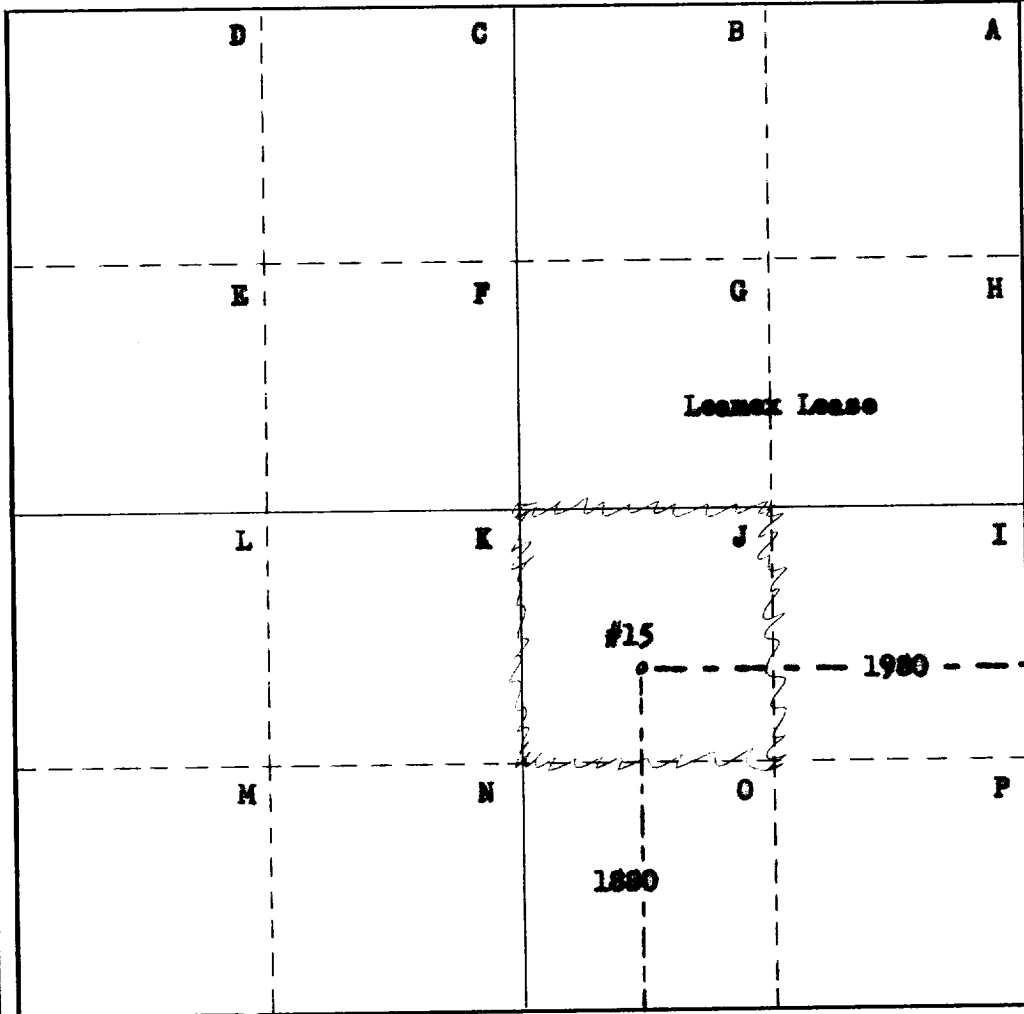

CERTIFICATION

I hereby certify that the information contained herein is true and complete to the best of my knowledge and belief.

Name W.J. Moeller
Position Associate Reservoir Engineer
Company Phillips Petroleum Company
Date 5-15-69

I hereby certify that the well location shown on this plat was plotted from field notes of actual surveys made by me or under my supervision, and that the same is true and correct to the best of my knowledge and belief.

Date Surveyed 5-15-69
Registered Professional Engineer and/or Land Surveyor Roger L. Leffler
Certificate No. 4357

