

NO. OF COPIES RECEIVED	
DISTRIBUTION	
SANTA FE	
FILE	
U.S.G.S.	
LAND OFFICE	
OPERATOR	

NEW MEXICO OIL CONSERVATION COMMISSION

3, 125 2011
HOBBS OFFICE O.C.C.
Form C-101
Revised 1-65
JUN 19 11 20 AM '69

5A. Indicate Type of Lease	STATE <input checked="" type="checkbox"/>	FEE <input type="checkbox"/>
5. State Oil & Gas Lease No.		

APPLICATION FOR PERMIT TO DRILL, DEEPEN, OR PLUG BACK

1a. Type of Work		7. Unit Agreement Name	
b. Type of Well OIL WELL <input checked="" type="checkbox"/> GAS WELL <input type="checkbox"/> OTHER <input type="checkbox"/> DRILL <input checked="" type="checkbox"/> DEEPEN <input type="checkbox"/> PLUG BACK <input type="checkbox"/> SINGLE ZONE <input checked="" type="checkbox"/> MULTIPLE ZONE <input type="checkbox"/>		8. Farm or Lease Name Stipp State	
2. Name of Operator SOLAR OIL COMPANY		9. Well No. 2	
3. Address of Operator P. O. Box 5596 Midland, Texas		10. Field and Pool, or Wildcat Undesignated (Saunders)	
4. Location of Well UNIT LETTER D LOCATED 660 FEET FROM THE North LINE AND 660 FEET FROM THE West LINE OF SEC. 9 TWP. 15-S RGE. 33-ENMPM		12. County Lea	
19. Proposed Depth 10,200'		19A. Formation Penn	20. Rotary or C.T. Rotary
21. Elevations (Show whether DF, RT, etc.) 4203'	21A. Kind & Status Plug. Bond Blanket-Current	21B. Drilling Contractor Not Selected	22. Approx. Date Work will start 6-25-69

23.

PROPOSED CASING AND CEMENT PROGRAM

SIZE OF HOLE	SIZE OF CASING	WEIGHT PER FOOT	SETTING DEPTH	SACKS OF CEMENT	EST. TOP
17-1/4"	13-3/8"	61#	350'	300 sx	Circ.
11"	8-5/8"	24# & 32#	4000'-4400'	700 sx	Base of salt
7-7/8"	5-1/2"	17#	10,200'	350 sx	

It is proposed to drill a well to sufficient depth to test the Pennsylvanian, estimated at 10,100'.

APPROVAL VALID
FOR 90 DAYS UNLESS
DRILLING COMMENCED,

EXPIRES 9-20-69

13 3/4
HOURS PRIOR TO RUNNING CASING.

IN ABOVE SPACE DESCRIBE PROPOSED PROGRAM; IF PROPOSAL IS TO DEEPEN OR PLUG BACK, GIVE DATA ON PRESENT PRODUCTIVE ZONE AND PROPOSED NEW PRODUCTIVE ZONE. GIVE BLOWOUT PREVENTER PROGRAM, IF ANY.

I hereby certify that the information above is true and complete to the best of my knowledge and belief.

Signed W. J. Smith Title Production Clerk Date June 18, 1969

(This space for State Use)

APPROVED BY [Signature] TITLE DATE
CONDITIONS OF APPROVAL, IF ANY:

**NEW MEXICO OIL CONSERVATION COMMISSION
WELL LOCATION AND ACREAGE DEDICATION PLAT**

Form C-102
Supersedes C-128
Effective 1-1-65

110665 OFFICE O. C. C.

All distances must be from the outer boundaries of the Section.

Operator SOLAR OIL COMPANY			Lease STIPP STATE			JUN 18 11:20 AM '69	
Unit Letter D	Section 9	Township 15 SOUTH	Range 33 EAST	County LEA			
Actual Footage Location of Well: 660 feet from the NORTH line and 660 feet from the WEST line							
Ground Level Elev. 4203.	Producing Formation Penn		Pool Undesignated (Saunders)		Dedicated Acreage: 40 Acres		

1. Outline the acreage dedicated to the subject well by colored pencil or hachure marks on the plat below.
2. If more than one lease is dedicated to the well, outline each and identify the ownership thereof (both as to working interest and royalty).
3. If more than one lease of different ownership is dedicated to the well, have the interests of all owners been consolidated by communitization, unitization, force-pooling, etc?

☐ Yes ☐ No If answer is "yes," type of consolidation _____

If answer is "no," list the owners and tract descriptions which have actually been consolidated. (Use reverse side of this form if necessary.) _____

No allowable will be assigned to the well until all interests have been consolidated (by communitization, unitization, forced-pooling, or otherwise) or until a non-standard unit, eliminating such interests, has been approved by the Commission.

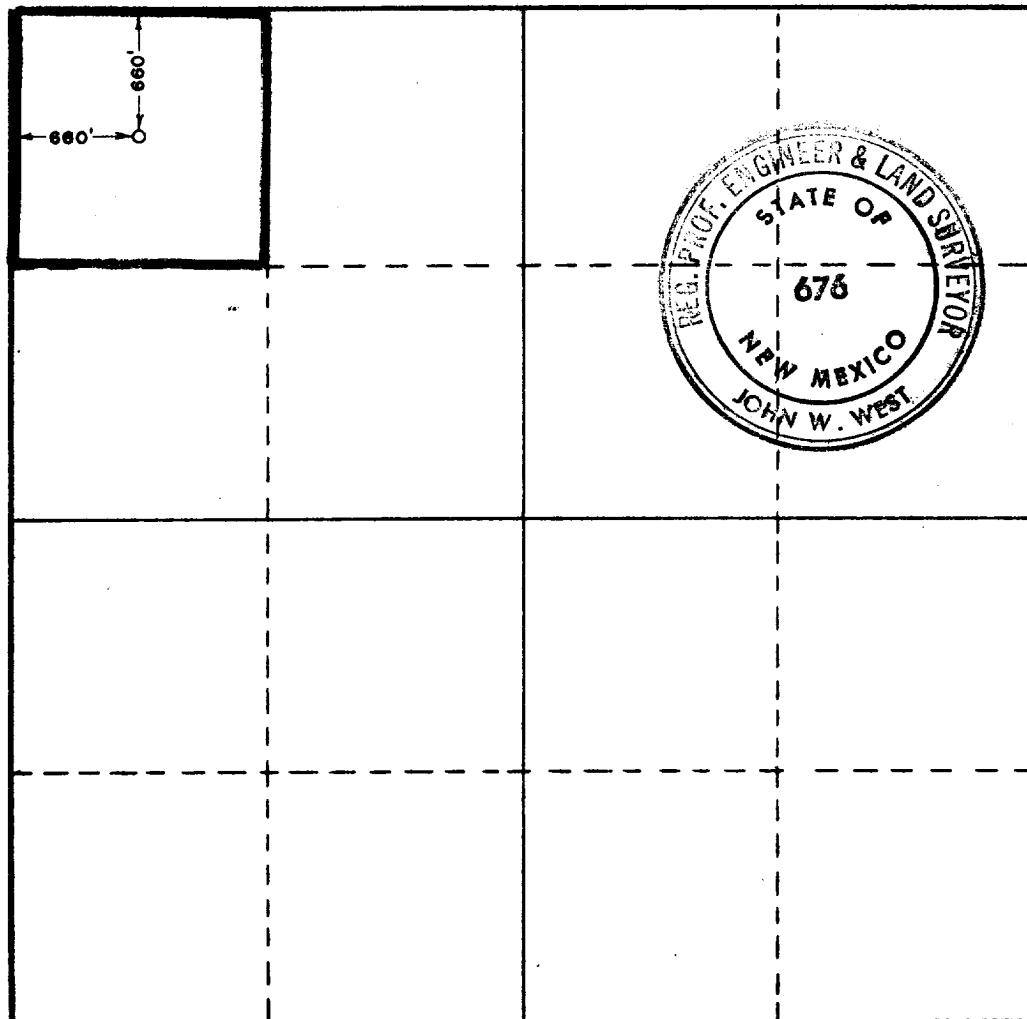

CERTIFICATION

I hereby certify that the information contained herein is true and complete to the best of my knowledge and belief.

Name *M. J. Smith*
 Position Production Clerk
 Company SOLAR OIL COMPANY
 Date June 18, 1969

I hereby certify that the well location shown on this plat was plotted from field notes of actual surveys made by me or under my supervision, and that the same is true and correct to the best of my knowledge and belief.

JUNE 13, 1969

Date Surveyed *John W. West*
 Registered Professional Engineer
 and/or Land Surveyor

Certificate No. **676**

