

NO. OF COPIES RECEIVED	
DISTRIBUTION	
SANTA FE	
FILE	
U.S.G.S.	
LAND OFFICE	
OPERATOR	

NEW MEXICO OIL CONSERVATION COMMISSION

Form C-101
Revised 1-1-65 *3-10-71*

5A. Indicate Type of Lease
STATE ☒ FEE ☐

5. State Oil & Gas Lease No.
E-8327

APPLICATION FOR PERMIT TO DRILL, DEEPEN, OR PLUG BACK

1a. Type of Work DRILL <input checked="" type="checkbox"/> DEEPEN <input type="checkbox"/> PLUG BACK <input type="checkbox"/>		7. Unit Agreement Name	
b. Type of Well OIL WELL <input checked="" type="checkbox"/> GAS WELL <input type="checkbox"/> OTHER <input type="checkbox"/>		8. Farm or Lease Name <i>State KQ-36</i>	
2. Name of Operator <i>Continental Oil Company</i>		9. Well No. <i>1</i>	
3. Address of Operator <i>Box 460 Hobbs, New Mexico</i>		10. Field and Pool, or Wildcat <i>Yardie Morris 7 Rivers</i>	
4. Location of Well UNIT LETTER <i>N</i> LOCATED <i>660'</i> FEET FROM THE <i>South</i> LINE AND <i>11-50'</i> FEET FROM THE <i>West</i> LINE OF SEC. <i>36</i> TWP. <i>28S</i> RGE. <i>36E</i> NMPM		12. County <i>Lea</i>	
21. Elevations (Show whether DI, RT, etc.) <i>3256 gr</i>		19. Proposed Depth <i>3050'</i>	19A. Formation <i>7 Rivers</i>
21A. Kind & Status Plug. Bond <i>Blanket Bond on file</i>	21B. Drilling Contractor <i>Leatherwood</i>	20. Rotary or C.T. <i>rotary</i>	
22. Approx. Date Work will start <i>July 15, 1971</i>			

PROPOSED CASING AND CEMENT PROGRAM

SIZE OF HOLE	SIZE OF CASING	WEIGHT PER FOOT	SETTING DEPTH	SACKS OF CEMENT	EST. TOP
<i>12 1/4"</i>	<i>8 5/8"</i>	<i>20 #</i>	<i>500'</i>	<i>300 S/KS</i>	<i>circ</i>
<i>7 7/8"</i>	<i>5 1/2"</i>	<i>14 #</i>	<i>3050'</i>	<i>250 S/KS</i>	<i>2100'</i>

It is proposed to drill a straight hole to 3050' and complete as a 7 Rivers producer.

APPROVAL VALID
FOR 90 DAYS UNLESS
DRILLING COMMENCED,

EXPIRES *10-7-71*

THE COMMISSION MUST BE NOTIFIED
24 HOURS PRIOR TO RUNNING *8 5/8"*
CASING

IN ABOVE SPACE DESCRIBE PROPOSED PROGRAM: IF PROPOSAL IS TO DEEPEN OR PLUG BACK, GIVE DATA ON PRESENT PRODUCTIVE ZONE AND PROPOSED NEW PRODUCTIVE ZONE. GIVE BLOWOUT PREVENTER PROGRAM, IF ANY.

I hereby certify that the information above is true and complete to the best of my knowledge and belief.

Signed *Thyrt Stange* Title *Admin. Supervisor* Date *7-6-71*

(This space for State Use)

APPROVED BY *Leslie A. Clements* TITLE *OIL & GAS INSPECTOR* DATE *JUL 9 1971*

CONDITIONS OF APPROVAL, IF ANY:

NMOEC (6) File

RECEIVED

JUL 6 1971

OIL CONSERVATION COMM.
HOBBS, N. M.

NEW MEXICO OIL CONSERVATION COMMISSION
WELL LOCATION AND ACREAGE DEDICATION PLAT

Form C-102
Supersedes C-128
Effective 1-1-65

All distances must be from the outer boundaries of the Section

Operator CONTINENTAL OIL COMPANY			Lease STATE "KQ" 36		Well No. 1
Unit Letter N	Section 36	Township 24 SOUTH	Range 36 EAST	County LEA	
Actual Footage Location of Well: 660 feet from the SOUTH line and 1650 feet from the WEST line					
Ground Level Elev. 3256.8	Producing Formation 7 Rivers		Pool Langlie Mares 7 Rivers	Dedicated Acreage: 40	

1. Outline the acreage dedicated to the subject well by colored pencil or hachure marks on the plat below.
2. If more than one lease is dedicated to the well, outline each and identify the ownership thereof (both as to working interest and royalty).
3. If more than one lease of different ownership is dedicated to the well, have the interests of all owners been consolidated by communitization, unitization, force-pooling, etc?

☐ Yes ☐ No If answer is "yes," type of consolidation _____

If answer is "no," list the owners and tract descriptions which have actually been consolidated. (Use reverse side of this form if necessary.) _____

No allowable will be assigned to the well until all interests have been consolidated (by communitization, unitization, forced-pooling, or otherwise) or until a non-standard unit, eliminating such interests, has been approved by the Commission.

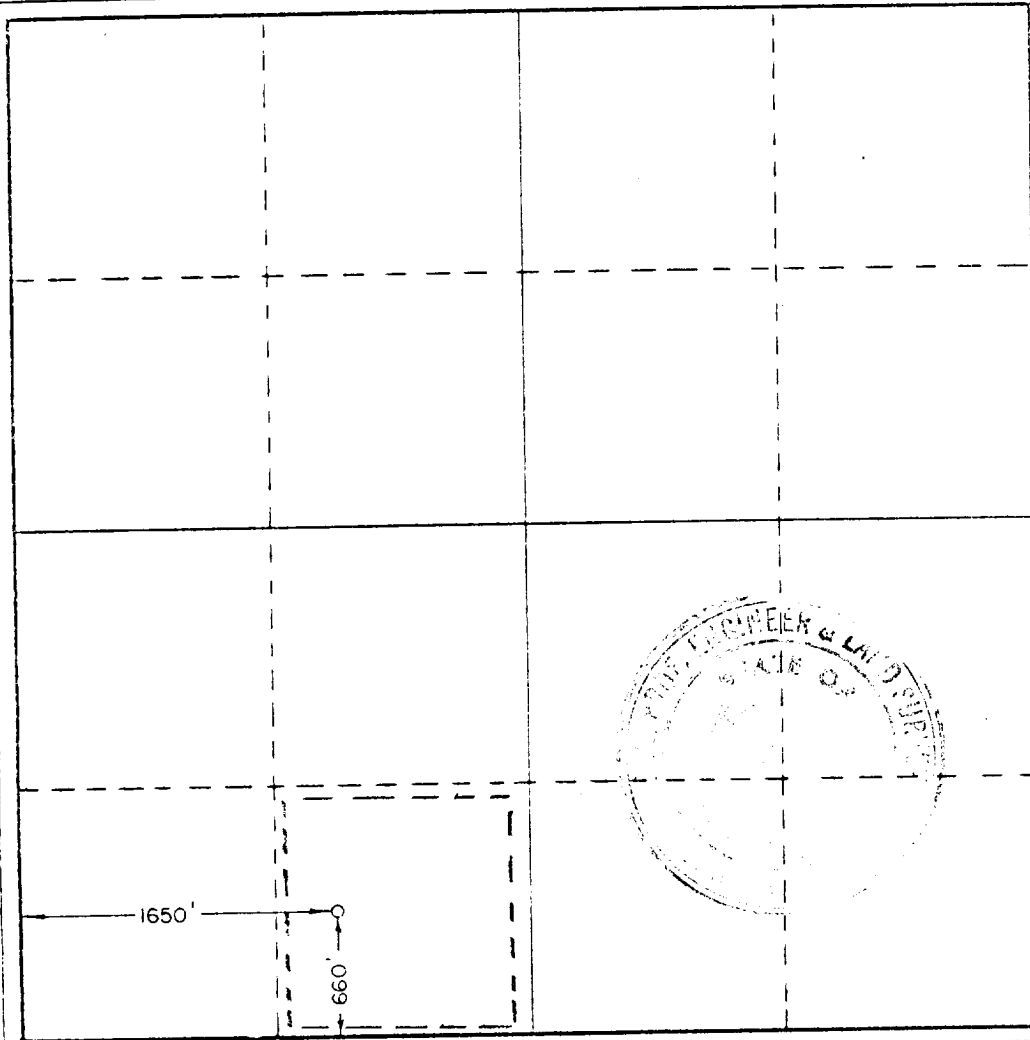

CERTIFICATION

I hereby certify that the information contained herein is true and complete to the best of my knowledge and belief.

[Signature]
Position

Admin. Supervisor
Company

Continental Oil Co.

Date
July 6, 1971

I hereby certify that the well location shown on this plat was plotted from field notes of actual surveys made by me or under my supervision, and that the same is true and correct to the best of my knowledge and belief.

Date Surveyed

JUNE 24, 1971

Registered Professional Engineer and/or Land Surveyor

John W. West
Certificate No.

676

173

RECEIVED

JUL - 8 1971

OIL CONSERVATION COMM.
HOBBS, N. M.