

NO. OF COPIES RECEIVED	
DISTRIBUTION	
SANTA FE	
FILE	
U.S.G.S.	
LAND OFFICE	
OPERATOR	

# NEW MEXICO OIL CONSERVATION COMMISSION

Form C-101  
Revised 1-1-65

5A. Indicate Type of Lease	
STATE <input checked="" type="checkbox"/>	FEE <input type="checkbox"/>
5. State Oil & Gas Lease No.	
A 1320	
7. Unit Agreement Name	
8. Farm or Lease Name	
Humble-State	
9. Well No.	
1	
10. Field and Pool, or Wildcat	
Undesignated	
12. County	
Lea	
19. Proposed Depth	19A. Formation
12,000	Penn
20. Rotary or C.T.	
Rotary	
21. Elevations (Show whether DF, RT, etc.)	21A. Kind & Status Plug. Bond
3996.9 Grcl	\$ 10,000 Blanket
21B. Drilling Contractor	22. Approx. Date Work will start
Tom Brown, Inc.	

## APPLICATION FOR PERMIT TO DRILL, DEEPEN, OR PLUG BACK

1a. Type of Work	
DRILL <input checked="" type="checkbox"/> DEEPEN <input type="checkbox"/> PLUG BACK <input type="checkbox"/>	
b. Type of Well	
OIL WELL <input type="checkbox"/>	GAS WELL <input checked="" type="checkbox"/> OTHER <input type="checkbox"/>
2. Name of Operator	
Tom Brown, Inc.	
3. Address of Operator	
P. O. Box 5706 Midland, Texas 79701	
4. Location of Well	
UNIT LETTER H	LOCATED 1980 FEET FROM THE N LINE
AND 660 FEET FROM THE E LINE OF SEC. 16	TWP. 16 RGE. 35 NMPM
19. Proposed Depth	
12,000	
19A. Formation	
Penn	
20. Rotary or C.T.	
Rotary	
21. Elevations (Show whether DF, RT, etc.)	
3996.9 Grcl	
21A. Kind & Status Plug. Bond	
\$ 10,000 Blanket	
21B. Drilling Contractor	
Tom Brown, Inc.	
22. Approx. Date Work will start	

## PROPOSED CASING AND CEMENT PROGRAM

SIZE OF HOLE	SIZE OF CASING	WEIGHT PER FOOT	SETTING DEPTH	SACKS OF CEMENT	EST. TOP
17-1/2"	12-3/4	40#	450	350 (circ)	
11"	8-5/8	24 & 32#	4650	300	4100
7-7/8"	5-1/2	17 & 20#	12,000	450	10,000

We propose to:

Run 5-1/2" casing to total depth and perforate opposite the Penn (Atoka) gas zone.

APPROVAL VALID  
FOR 90 DAYS UNLESS  
DRILLING COMMENCED,  
EXPIRES 5-28-72

THE COMMISSION MUST BE NOTIFIED  
OF ANY CHANGES IN THE  
PROGRAM BY 12/3/71  
OR EARLIER.

IN ABOVE SPACE DESCRIBE PROPOSED PROGRAM: IF PROPOSAL IS TO DEEPEN OR PLUG BACK, GIVE DATA ON PRESENT PRODUCTIVE ZONE AND PROPOSED NEW PRODUCTIVE ZONE. GIVE BLOWOUT PREVENTER PROGRAM, IF ANY.

I hereby certify that the information above is true and complete to the best of my knowledge and belief.

Signed R. G. De Paul Title Vice-President Date February 9, 1972

(This space for State Use)

APPROVED BY [Signature] TITLE SUPERVISOR DISTRICT I DATE FEB 28 1972

CONDITIONS OF APPROVAL, IF ANY:

**RECEIVED**

**FEB 17 1972**

**OIL CONSERVATION COMM.  
HOUSTON, TEXAS**

**NEW MEXICO OIL CONSERVATION COMMISSION  
WELL LOCATION AND ACREAGE DEDICATION PLAT**

Form C-102  
Supersedes C-128  
Effective 1-1-65

All distances must be from the outer boundaries of the Section.

Operator <b>TOM BROWN, INC.</b>			Lease <b>HUMBLE STATE</b>		Well No. <b>1</b>
Unit Letter <b>H</b>	Section <b>16</b>	Township <b>16 SOUTH</b>	Range <b>35 EAST</b>	County <b>LEA</b>	
Actual Footage Location of Well: <b>1980</b> feet from the <b>NORTH</b> line and <b>660</b> feet from the <b>EAST</b> line					
Ground Level Elev. <b>3996.9</b>	Producing Formation <b>PENN (ATOKA GAS)</b>	Pool <b>UNDESIGNATED</b>		Dedicated Acreage: <b>320</b> Acres	

1. Outline the acreage dedicated to the subject well by colored pencil or hatchure marks on the plat below.
2. If more than one lease is dedicated to the well, outline each and identify the ownership thereof (both as to working interest and royalty).
3. If more than one lease of different ownership is dedicated to the well, have the interests of all owners been consolidated by communitization, unitization, force-pooling, etc?

☐ Yes    ☐ No    If answer is "yes," type of consolidation \_\_\_\_\_

If answer is "no," list the owners and tract descriptions which have actually been consolidated. (Use reverse side of this form if necessary.) \_\_\_\_\_

No allowable will be assigned to the well until all interests have been consolidated (by communitization, unitization, forced-pooling, or otherwise) or until a non-standard unit, eliminating such interests, has been approved by the Commission.

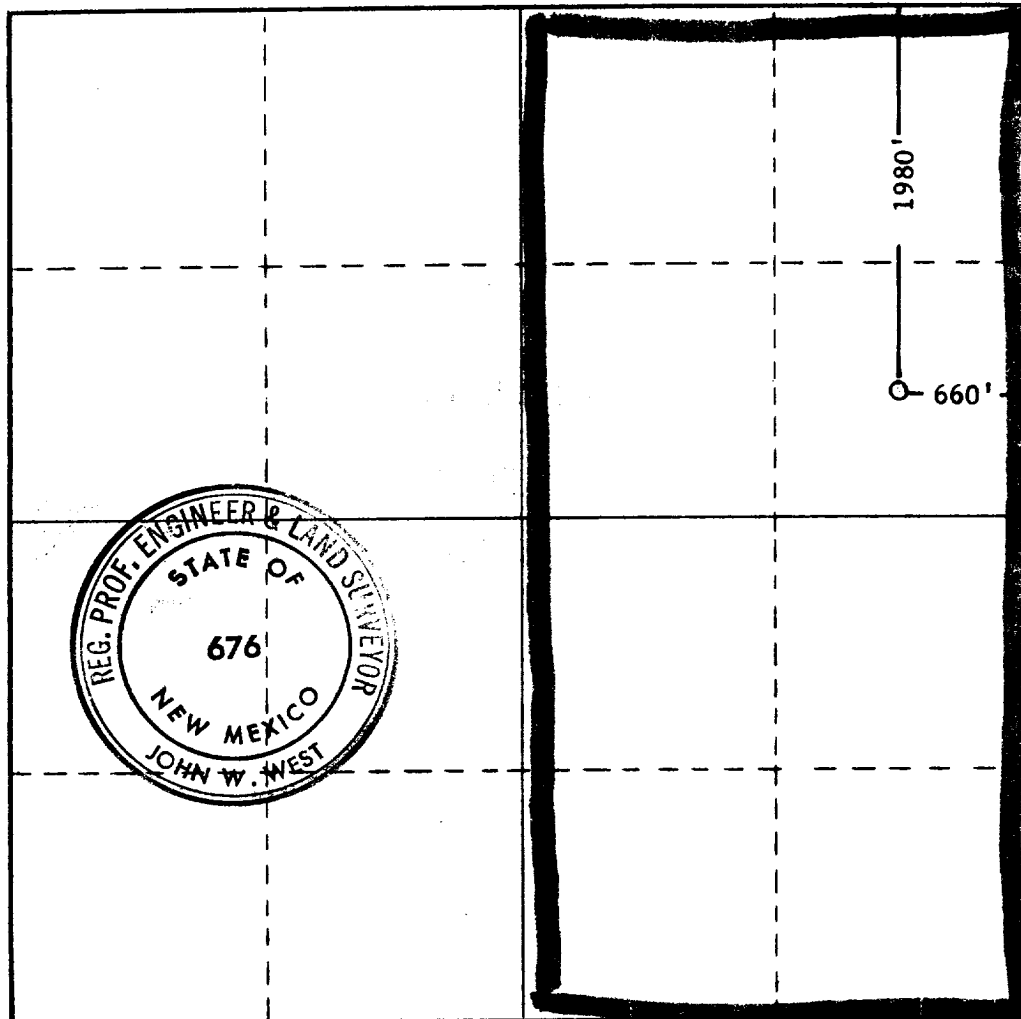

**CERTIFICATION**

I hereby certify that the information contained herein is true and complete to the best of my knowledge and belief.

Name *John W. West*

Position  
**AGENT**

Company  
**TOM BROWN, INC.**

Date  
**2-10-1972**

I hereby certify that the well location shown on this plat was plotted from field notes of actual surveys made by me or under my supervision, and that the same is true and correct to the best of my knowledge and belief.

Date Surveyed  
**2-10-1972**

Registered Professional Engineer and/or Land Surveyor

*John W. West*  
Certificate No. **676**

**RECEIVED**

**FEB 1 1972**

**OIL CONSERVATION COMM.  
HOBBES, N. H.**