

NO. OF COPIES RECEIVED	
DISTRIBUTION	
SANTA FE	4
FILE	
U.S.G.S.	
LAND OFFICE	
OPERATOR	

NEW MEXICO OIL CONSERVATION COMMISSION

Form C-101
Revised 1-1-65 *3-12-74*

5A. Indicate Type of Lease	
STATE <input checked="" type="checkbox"/>	FEE <input type="checkbox"/>
5. State Oil & Gas Lease No.	
-	

APPLICATION FOR PERMIT TO DRILL, DEEPEN, OR PLUG BACK

1a. Type of Work		7. Unit Agreement Name	
		-	
b. Type of Well DRILL <input checked="" type="checkbox"/> DEEPEN <input type="checkbox"/> PLUG BACK <input type="checkbox"/> OIL WELL <input checked="" type="checkbox"/> GAS WELL <input type="checkbox"/> OTHER <input type="checkbox"/> SINGLE ZONE <input checked="" type="checkbox"/> MULTIPLE ZONE <input type="checkbox"/>		8. Farm or Lease Name	
		State 4	
2. Name of Operator		9. Well No.	
Texas Western, Inc.		1	
3. Address of Operator		10. Field and Pool, or Wildcat	
4255 LBJ Fwy., Suite 238, Dallas, Texas 75234		Flying "M", San Andres	
4. Location of Well UNIT LETTER <u>P</u> LOCATED <u>860</u> FEET FROM THE <u>East</u> LINE AND <u>660</u> FEET FROM THE <u>South</u> LINE OF SEC. <u>4</u> TWP. <u>10S</u> RGE. <u>33E</u> NMPM		12. County	
		Lea	
19. Proposed Depth		19A. Formation	20. Rotary or C.T.
4800'		San Andres	Rotary
21. Elevations (Show whether DF, RT, etc.)	21A. Kind & Status Plug. Bond	21B. Drilling Contractor	22. Approx. Date Work will start
4257' GL	10,000 BP & 1B	Sitton & Morton	January, 1974 *

23.

PROPOSED CASING AND CEMENT PROGRAM

SIZE OF HOLE	SIZE OF CASING	WEIGHT PER FOOT	SETTING DEPTH	SACKS OF CEMENT	EST. TOP
12 3/4	8 5/8	23#	350'	Circulate	GL
7 7/8	4 1/2	11.60	4600'	500'	2000'

* As soon as rig is available.

NEW HOLE TO BE DRILLED
&
PREVENTERS TO BE USED

APPROVAL VALID
FOR 90 DAYS UNLESS
DRILLING COMMENCED,
EXPIRES 3-19-75

IN ABOVE SPACE DESCRIBE PROPOSED PROGRAM: IF PROPOSAL IS TO DEEPEN OR PLUG BACK, GIVE DATA ON PRESENT PRODUCTIVE ZONE AND PROPOSED NEW PRODUCTIVE ZONE. GIVE BLOWOUT PREVENTER PROGRAM, IF ANY.

I hereby certify that the information above is true and complete to the best of my knowledge and belief.

Signed C. J. Kruegel Title Accountant Date December 15, 1973
(This space for State Use)

APPROVED BY [Signature] TITLE DATE
CONDITIONS OF APPROVAL, IF ANY:

NEW MEXICO OIL CONSERVATION COMMISSION
WELL LOCATION AND ACREAGE DEDICATION PLAT

Form C-102
Supersedes C-128
Effective 1-1-65

All distances must be from the outer boundaries of the Section.

Operator TEXAS WESTERN, INC			Lease STATE		Well No. 1
Tract Letter P	Section 4	Township 10 SOUTH	Range 33 EAST	County LEA	
Actual Footage Location of Well: 860 feet from the EAST line and 660 feet from the SOUTH line					
Ground Level Elev. 4257'	Producing Formation SAN ANDRES		Pool FLYING "M" SAN ANDRES		Dedicated Acreage E 1/2 S 1/2 80 Acres

1. Outline the acreage dedicated to the subject well by colored pencil or hatchure marks on the plat below.
2. If more than one lease is dedicated to the well, outline each and identify the ownership thereof (both as to working interest and royalty).
3. If more than one lease of different ownership is dedicated to the well, have the interests of all owners been consolidated by communitization, unitization, force-pooling, etc?

☐ Yes ☐ No If answer is "yes," type of consolidation _____

If answer is "no," list the owners and tract descriptions which have actually been consolidated. (Use reverse side of this form if necessary.) _____

No allowable will be assigned to the well until all interests have been consolidated (by communitization, unitization, forced-pooling, or otherwise) or until a non-standard unit, eliminating such interests, has been approved by the Commission.

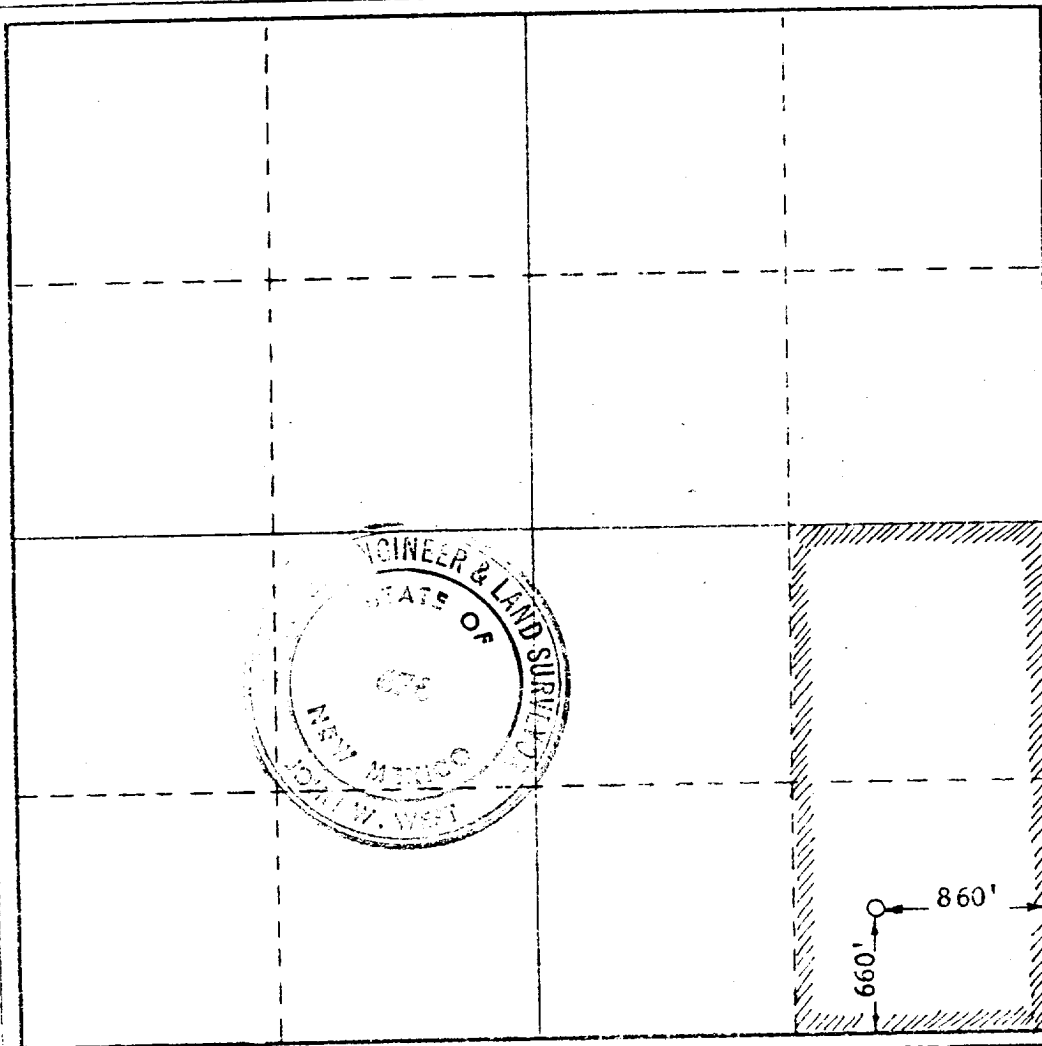

CERTIFICATION

I hereby certify that the information contained herein is true and complete to the best of my knowledge and belief.

C.J. Kruegel
Name **C.J. Kruegel**
Position **Accountant**

Company **Texas Western, Inc.**

Date **December 13, 1973**

Date

I hereby certify that the well location shown on this plat was plotted from field notes of actual surveys made by me or under my supervision, and that the same is true and correct to the best of my knowledge and belief.

Date Surveyed **JUNE 19, 1973**

Registered Professional Engineer and/or Land Surveyor

John W. West
Certificate No. **676**