

NO. OF COPIES RECEIVED	
DISTRIBUTION	
SANTA FE	
FILE	
U.S.G.S.	
LAND OFFICE	
OPERATOR	

NEW MEXICO OIL CONSERVATION COMMISSION

Form C-101
Revised 1-1-65

5A. Indicate Type of Lease
STATE ☒ FEE ☐
5. State Oil & Gas Lease No.

APPLICATION FOR PERMIT TO DRILL, DEEPEN, OR PLUG BACK

1a. Type of Work b. Type of Well OIL WELL <input checked="" type="checkbox"/> GAS WELL <input type="checkbox"/> OTHER <input type="checkbox"/> SINGLE ZONE <input type="checkbox"/> MULTIPLE ZONE <input type="checkbox"/>		7. Unit Agreement Name ----- 8. Farm or Lease Name State Com.	
2. Name of Operator Mesa Petroleum Co.		9. Well No. 1	
3. Address of Operator Box 2009 Amarillo, Texas 79105		10. Field and Foot, or Wildcat Shoe Bar, North, Strawn	
4. Location of Well UNIT LETTER <u>A</u> LOCATED <u>660</u> FEET FROM THE <u>North</u> LINE AND <u>660</u> FEET FROM THE <u>East</u> LINE OF SEC. <u>14</u> TWP. <u>16S</u> RGE. <u>35E</u> NMPM		12. County Lea	
21. Elevations (Show whether DT, RT, etc.) 3970.4		21A. Kind & Status of Log. Bond Blanket	21B. Drilling Contractor Robinson Bros.
19. Proposed Depth 11,600'		19A. Formation Strawn	20. Rotary or C.T. Rotary
22. Approx. Date Work will start 12-26-73			

PROPOSED CASING AND CEMENT PROGRAM

SIZE OF HOLE	SIZE OF CASING	WEIGHT PER FOOT	SETTING DEPTH	SACKS OF CEMENT	EST. TOP
17 1/2"	13 3/8"	54.50	325	350+-	Circ.
12 1/4"	9 5/8	36	4200	600+-	3,000
8 3/4"	4 1/2 or 7"		11,600'	To be determined	7800'

API 3,000 psi WP BOP's will be used. There is a possibility of a dual completion in the Wolfcamp-Strawn

APPROVAL VALID
FOR 90 DAYS UNLESS
DRILLING COMMENCED,
EXPIRES March 20, 1974

IN ABOVE SPACE DESCRIBE PROPOSED PROGRAM: IF PROPOSAL IS TO DEEPEN OR PLUG BACK, GIVE DATA ON PRESENT PRODUCTIVE ZONE AND PROPOSED NEW PRODUCTIVE ZONE. GIVE BLOWOUT PREVENTER PROGRAM, IF ANY.

I hereby certify that the information above is true and complete to the best of my knowledge and belief.

Signed Michael A. Houston Title Production Engineer Date 12/19/73

(This space for State Use)

APPROVED BY John A. Runyan TITLE DATE
CONDITIONS OF APPROVAL, IF ANY:

NEW MEXICO OIL CONSERVATION COMMISSION
WELL LOCATION AND ACREAGE DEDICATION PLAT

Form C-102
 Supersedes C-128
 Effective 1-1-65

All distances must be from the outer boundaries of the Section.

Operator MESA PETROLEUM COMPANY			Lease STATE COM		Well No. 1
Tract Letter A	Section 14	Township 16 SOUTH	Range 35 EAST	County LEA	
Actual Portage Location of Well: 660 feet from the NORTH line and 660 feet from the EAST line					
Ground Level Elev. 3970.4	Producing Formation SHOEBAR NORTH		Pool STRAWN		Dedicated Acreage 160

1. Outline the acreage dedicated to the subject well by colored pencil or hatchure marks on the plat below.
2. If more than one lease is dedicated to the well, outline each and identify the ownership thereof (both as to working interest and royalty).
3. If more than one lease of different ownership is dedicated to the well, have the interests of all owners been consolidated by communitization, unitization, force-pooling, etc?

☐ Yes ☐ No If answer is "yes," type of consolidation _____

If answer is "no," list the owners and tract descriptions which have actually been consolidated. (Use reverse side of this form if necessary.) _____

No allowable will be assigned to the well until all interests have been consolidated (by communitization, unitization, forced-pooling, or otherwise) or until a non-standard unit, eliminating such interests, has been approved by the Commission.

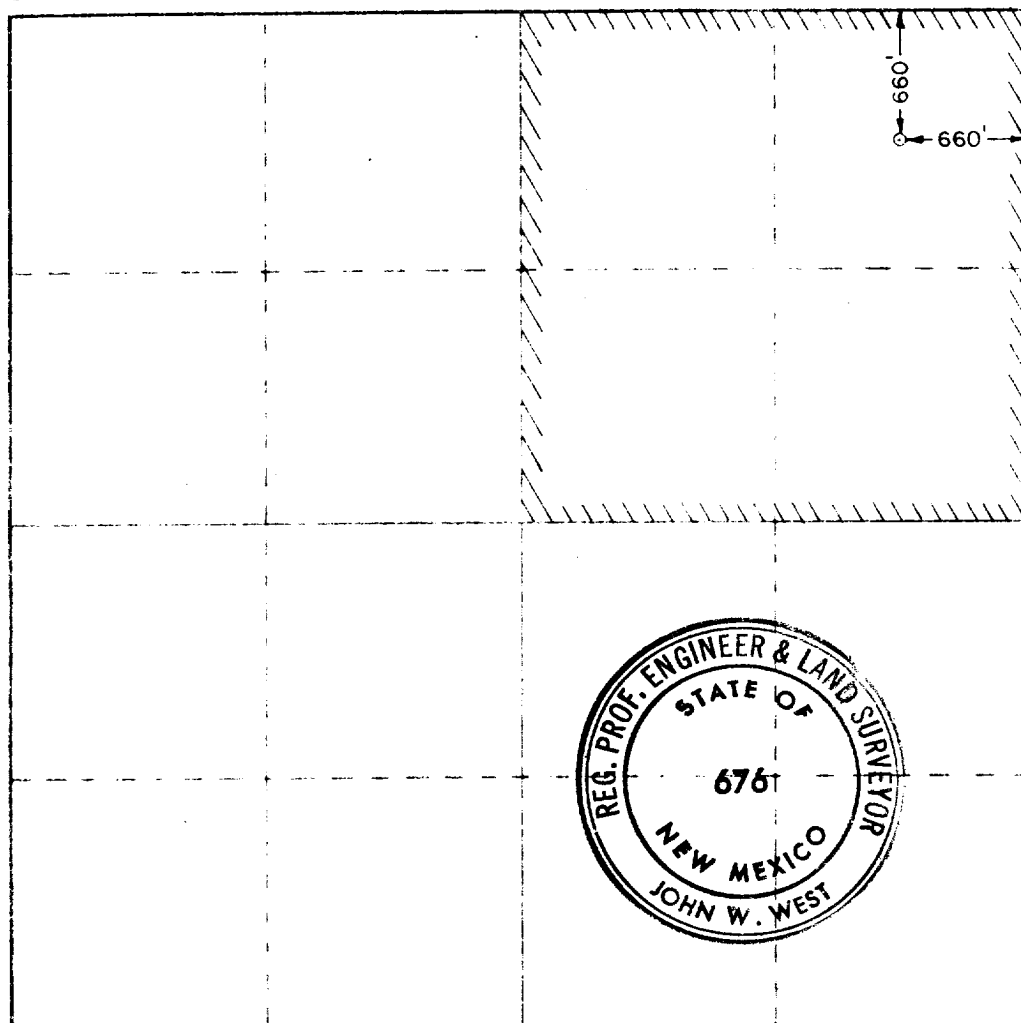

CERTIFICATION

I hereby certify that the information contained herein is true and complete to the best of my knowledge and belief.

Name John W. West

Position
AGENT

Company
MESA PETROLEUM COMPANY

Date
December 18, 1973

I hereby certify that the well location shown on this plat was plotted from the notes of actual surveys made by me or under my supervision, and that the same is true and correct to the best of my knowledge and belief.

Date Surveyed
December 18, 1973

Registered Professional Engineer and/or Land Surveyor

John W. West
 Certificate No. **676**

330 660 990 1320 1650 1980 2310 2640 2970 3300 3630 3960 4290 4620 4950 5280 5610 5940 6270 6600