

UNITED STATES  
DEPARTMENT OF THE INTERIOR  
GEOLOGICAL SURVEY

## APPLICATION FOR PERMIT TO DRILL, DEEPEN, OR PLUG BACK

1a. TYPE OF WORK DRILL <input checked="" type="checkbox"/> DEEPEN <input type="checkbox"/> PLUG BACK <input type="checkbox"/>		5. LEASE DESIGNATION AND SERIAL NO. L.C. 063458	
b. TYPE OF WELL OIL WELL <input checked="" type="checkbox"/> GAS WELL <input type="checkbox"/> OTHER <input type="checkbox"/>		6. IF INDIAN, ALLOTTEE OR TRIBE NAME	
2. NAME OF OPERATOR CONTINENTAL OIL COMPANY		7. UNIT AGREEMENT NAME WARREN	
3. ADDRESS OF OPERATOR Box 460, Hobbs, N.M. 88240		8. FARM OR LEASE NAME WARREN UNIT	
4. LOCATION OF WELL Report location clearly and in accordance with any State requirements.* At surface 660' FSL & 660' FEL OF SEC. 26		9. WELL NO. 32	
14. DISTANCE IN MILES AND DIRECTION FROM NEAREST TOWN OR POST OFFICE*		10. FIELD AND POOL, OR WILDCAT WARREN ABO	
15. DISTANCE FROM PROPOSED* LOCATION TO NEAREST PROPERTY OR LEASE LINE, FT. (Also to nearest drilg. unit line, if any)		11. SEC., T., R., M., OR BLK. AND SURVEY OR AREA Sec. 26, T. 20S, R. 38E	
16. DISTANCE FROM PROPOSED* LOCATION TO NEAREST WELL, DRILLING, COMPLETED, OR APPLIED FOR, ON THIS LEASE, FT.		12. COUNTY OR PARISH LEA	
17. NO. OF ACRES IN LEASE 2240		13. STATE N.M.	
18. PROPOSED DEPTH 7850'		14. NO. OF ACRES ASSIGNED TO THIS WELL 40	
20. ROTARY OR CABLE TOOLS ROTARY		21. APPROX. DATE WORK WILL START* 8-19-74	
22. ELEVATIONS (Show whether DF, RT, GR, etc.)			

## 23. PROPOSED CASING AND CEMENTING PROGRAM

SIZE OF HOLE	SIZE OF CASING	WEIGHT PER FOOT	SETTING DEPTH	QUANTITY OF CEMENT
17 1/2"	13 3/8" H-40	48#	400'	Circ. - 400 lbs.
10 5/8"	8 5/8" H-40	28#	2800'	Circ. - 1200 lbs.
7 7/8"	5 1/2" J-55 or K-55	15.5# (last 150' - 17.0#)	7850'	375 lbs.

It is proposed to drill a straight hole to a TD of 7850' and complete as an Abo oil well.

Mud Program: 0-400', 8.5-9.0# Spud Mud; 400'-2800', 9.0-10.0# Brine & Gel; 2800'-7850', 8.3-8.5# fresh wtr. & Gel.

See Attached for Blowout Preventer Program.

IN ABOVE SPACE DESCRIBE PROPOSED PROGRAM: If proposal is to deepen or plug back, give data on present productive zone and proposed new productive zone. If proposal is to drill or deepen directionally, give pertinent data on subsurface locations and measured and true vertical depths. Give blowout preventer program, if any.

24. SIGNED [Signature] TITLE SR. ANALYST DATE 7-16-74  
(This space for Federal or State office use)

PERMIT NO. \_\_\_\_\_

APPROVAL DATE

APPROVED BY \_\_\_\_\_  
CONDITIONS OF APPROVAL, IF ANY:

TITLE: \_\_\_\_\_

APPROVED  
JUL 24 1974  
ARTHUR A. BROWN  
DISTRICT ENGINEER

\*See Instructions On Reverse Side

11666-X NMEH &amp; E.10

NEW MEXICO OIL CONSERVATION COMMISSION  
WELL LOCATION AND ACREAGE DEDICATION PLAT

Form C-102  
Supersedes C-128  
Effective 1-1-65

All distances must be from the outer boundaries of the Section

Operator <b>Continental Oil Company</b>			Lease <b>Warren Unit</b>		Well No. <b>232</b>
Section <b>P</b>	Section <b>26</b>	Township <b>20 South</b>	Range <b>38 East</b>	County <b>Lea</b>	
Actual Plot - the location of Well: <div style="display: flex; justify-content: space-between;"> <span>660 feet from the</span> <span>South line and</span> <span>660 feet from the</span> <span>East line</span> </div>					
Ground Elev. Elev. <b>3567.6</b>	Producing Formation <b>ABO</b>		Pool <b>WARREN ABO</b>	Dedicated Acreage: <b>40</b> Acres	

1. Outline the acreage dedicated to the subject well by colored pencil or hatchure marks on the plat below.
2. If more than one lease is dedicated to the well, outline each and identify the ownership thereof (both as to working interest and royalty).
3. If more than one lease of different ownership is dedicated to the well, have the interests of all owners been consolidated by communitization, unitization, force-pooling, etc?

☐ Yes ☐ No If answer is "yes," type of consolidation \_\_\_\_\_

If answer is "no," list the owners and tract descriptions which have actually been consolidated. (Use reverse side of this form if necessary.) \_\_\_\_\_

No allowable will be assigned to the well until all interests have been consolidated (by communitization, unitization, forced-pooling, or otherwise) or until a non-standard unit, eliminating such interests, has been approved by the Commission.

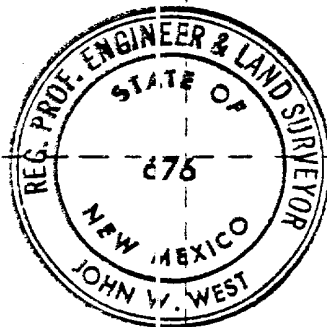

CERTIFICATION

I hereby certify that the information contained herein is true and complete to the best of my knowledge and belief.

Name John W. West  
Position SR. ANALYST  
Company CONTINENTAL OIL CO.  
Date 7-16-74

I hereby certify that the well location shown on this plat was plotted from field notes of actual surveys made by me or under my supervision, and that the same is true and correct to the best of my knowledge and belief.

Date Surveyed July 5, 1974  
Registered Professional Engineer and/or Land Surveyor

John W. West  
Certificate No. 676

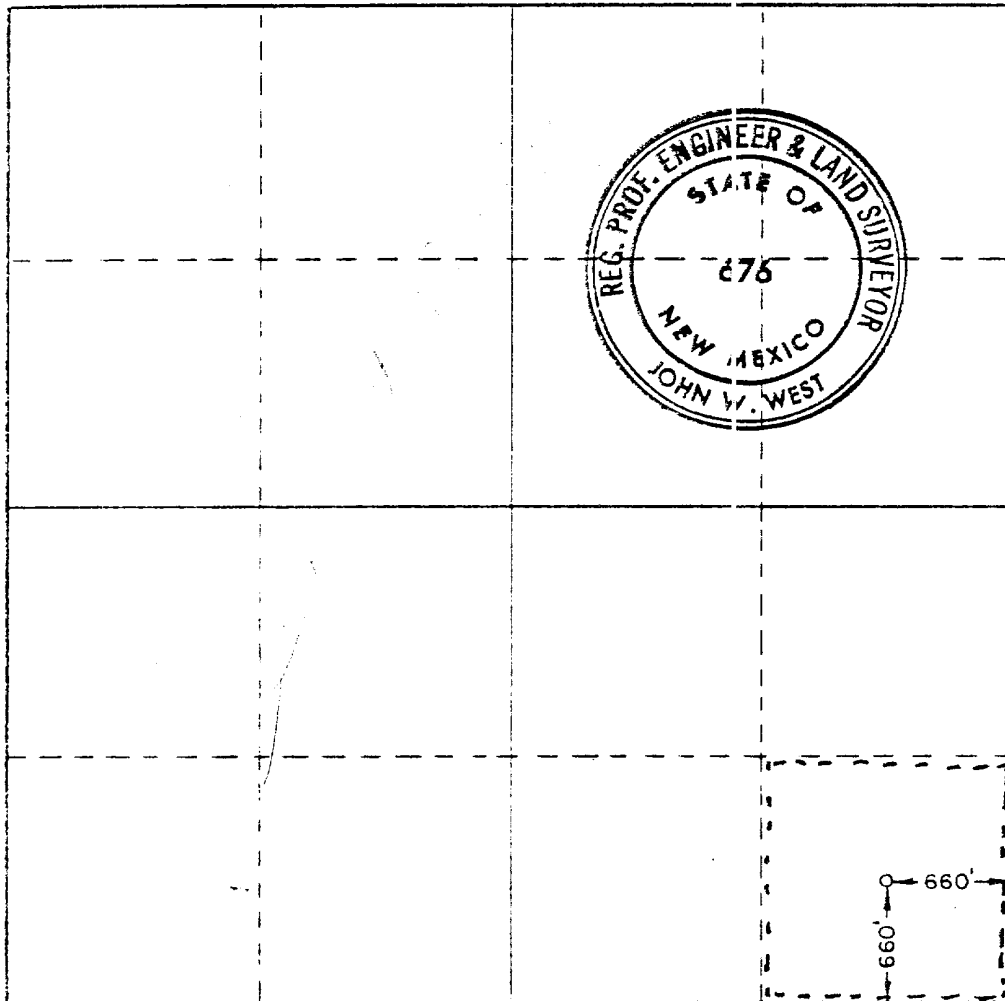

330 660 990 1320 1650 1980 2310 2640 2000 1500 1000 500 0

Development Plan For Surface

1. Existing roads including location of the exit from the main highway  
See Attached Map
2. Planned access roads  
See Below and Attached Map
  - (a) Length and width of new road *1320' X 12'*
  - (b) Roads will be compacted ~~or surfaced~~
3. Location of existing wells  
See Attached Map
4. Lateral roads to well location  
See Attached Map
5. Location of tank batteries and flowlines  
See Attached Map
6. Location and type of water supply
  - (X) Water will be hauled to location  
*(Both sources will be used).*
  - (X) See attached map for location of proposed water lines
7. Methods for handling waste disposal  
All litter and scrap material will be disposed of by burying in a trash pit with a minimum cover of 24 inches of dirt.
8. and 9. Location of camps and airstrips  
There are no camps or airstrips contemplated to serve this lease.
10. Location of layout to include position of the rig, mud tanks, reserve pits, burn pits, pipe racks, etc.  
See Below and Attached plat
  - (a) Size of drilling pad
  - (b) Drilling pad X compacted ~~or surfaced~~
11. Plans for restoration of the surface  
Surface will be levelled and properly conditioned.
12. Other information that may be used in evaluating the impact on environment  
The terrain in this area is generally flat with very little vegetation.  
No streams or other major water sheds are located in this area.

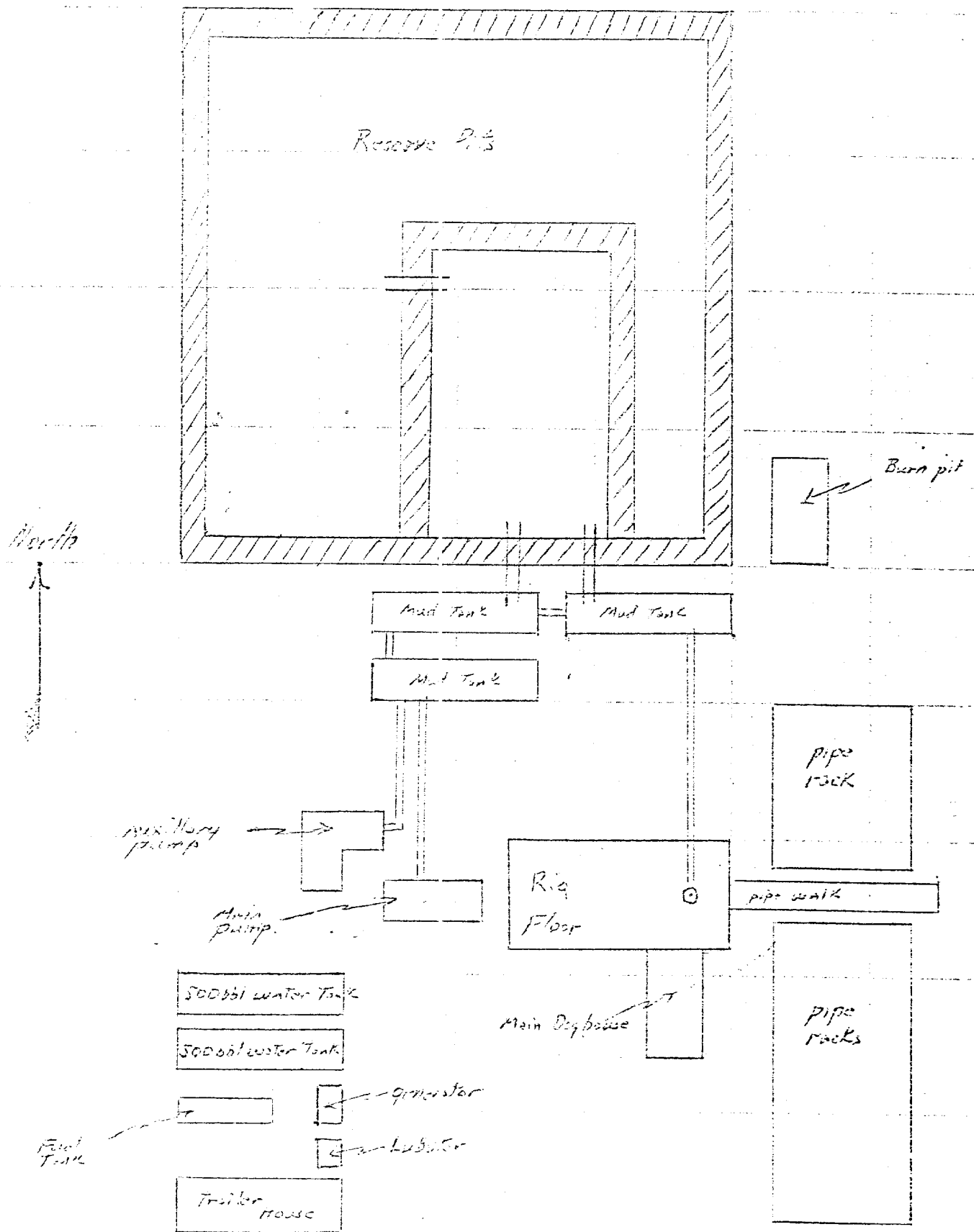

Robinson Bros. Drilling Co.  
 Rig No 3  
 Scale 1" = 25 feet.

CONTINENTAL OIL COMPANY  
Blow-out Preventer Specifications

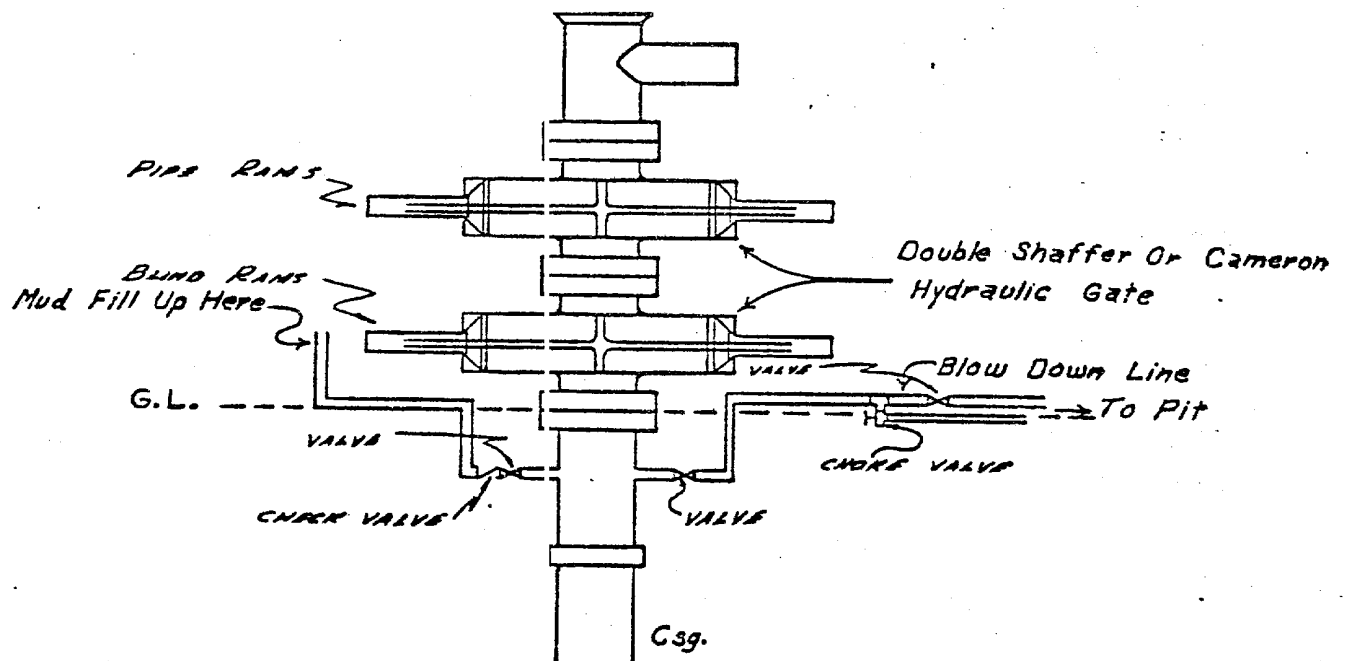

NOTE:

Manual and hydraulic controls with closing unit no less than 75' from well head.

R 38 E

WARREN UNIT AREA  
LEA COUNTY, NEW MEXICO  
Scale: 1"=2000'

T  
20 IN  
S

24

23

22

20  
Cont. et al  
28

W.D. Burger  
U S

0316701(B)

W.D. Burger  
U S

Cont. et al

7

W.D. Burger  
U S

0316701(B)

W.D. Burger  
U S

Cont. et al

Cont. et al  
5

9

W.D. Burger  
U S

0316701(B)

Cont. et al

Cont. et al

29

28

27

26

25

3

8

26

25

T  
20 IN  
S

25

D.M. Warren  
U S

0316951(B)

D.M. Warren  
U S

Cont. et al

21

29

26

D.M. Warren  
U S

0316951(B)

Cont. et al

O.L. Fisher  
U S

063458

Water Line →

New Road  
O.L. Fisher  
U S

U S

Tank

32

33

34

35

36

17

20

18

35

Existing Road →

14

12

13

D.M. Warren  
U S

16

15

O.L. Fisher  
U S

O.L. Fisher  
U S

063458

O.L. Fisher  
U S

063458

0316951(B)

O.L. Fisher  
U S

16

15

O.L. Fisher  
U S

O.L. Fisher  
U S

063458

O.L. Fisher  
U S

063458

0316951(B)

O.L. Fisher  
U S

16

15

O.L. Fisher  
U S

O.L. Fisher  
U S

063458

O.L. Fisher  
U S

063458

0316951(B)

O.L. Fisher  
U S

16

15

O.L. Fisher  
U S

O.L. Fisher  
U S

063458

O.L. Fisher  
U S

063458

0316951(B)

O.L. Fisher  
U S

16

15

O.L. Fisher  
U S

O.L. Fisher  
U S

063458

O.L. Fisher  
U S

063458

0316951(B)

O.L. Fisher  
U S

16

15

O.L. Fisher  
U S

O.L. Fisher  
U S

063458

O.L. Fisher  
U S

063458

0316951(B)

O.L. Fisher  
U S

16

15

O.L. Fisher  
U S

O.L. Fisher  
U S

063458

O.L. Fisher  
U S

063458

0316951(B)

O.L. Fisher  
U S

16

15

O.L. Fisher  
U S

O.L. Fisher  
U S

063458

O.L. Fisher  
U S

063458

0316951(B)

O.L. Fisher  
U S

16

15

O.L. Fisher  
U S

O.L. Fisher  
U S

063458

O.L. Fisher  
U S

063458

0316951(B)

O.L. Fisher  
U S

16

15

O.L. Fisher  
U S

O.L. Fisher  
U S

063458

O.L. Fisher  
U S

063458

0316951(B)

O.L. Fisher  
U S

16

15

O.L. Fisher  
U S

O.L. Fisher  
U S

063458

O.L. Fisher  
U S

063458

0316951(B)

O.L. Fisher  
U S

16

15

O.L. Fisher  
U S

O.L. Fisher  
U S

063458

O.L. Fisher  
U S

063458

0316951(B)

O.L. Fisher  
U S

16

15

O.L. Fisher  
U S

O.L. Fisher  
U S

063458

O.L. Fisher  
U S

063458

0316951(B)

O.L. Fisher  
U S

16

15

O.L. Fisher  
U S

O.L. Fisher  
U S

063458

O.L. Fisher  
U S

063458

0316951(B)

O.L. Fisher  
U S

16

15

O.L. Fisher  
U S

O.L. Fisher  
U S

063458

O.L. Fisher  
U S

063458

0316951(B)

O.L. Fisher  
U S

16

15

O.L. Fisher  
U S

O.L. Fisher  
U S

063458

O.L. Fisher  
U S

063458

0316951(B)

O.L. Fisher  
U S

16

15

O.L. Fisher  
U S

O.L. Fisher  
U S

063458

O.L. Fisher  
U S

063458

0316951(B)

O.L. Fisher  
U S

16

15

O.L. Fisher  
U S

O.L. Fisher  
U S

063458

O.L. Fisher  
U S

063458

0316951(B)

O.L. Fisher  
U S

16

15

O.L. Fisher  
U S

O.L. Fisher  
U S

063458

O.L. Fisher  
U S

063458

0316951(B)

O.L. Fisher  
U S

16

15

O.L. Fisher  
U S

O.L. Fisher  
U S

063458

O.L. Fisher  
U S

063458

0316951(B)

O.L. Fisher  
U S

16

15

O.L. Fisher  
U S

O.L. Fisher  
U S

063458

O.L. Fisher  
U S

063458

0316951(B)

O.L. Fisher  
U S

16

15

O.L. Fisher  
U S

O.L. Fisher  
U S

063458

O.L. Fisher  
U S

063458

0316951(B)

O.L. Fisher  
U S

16

15

O.L. Fisher  
U S

O.L. Fisher  
U S

063458

O.L. Fisher  
U S

063458

0316951(B)

O.L. Fisher  
U S

16

15

O.L. Fisher  
U S

O.L. Fisher  
U S

063458

O.L. Fisher  
U S

063458

0316951(B)

O.L. Fisher  
U S

16

15

O.L. Fisher  
U S

O.L. Fisher  
U S

063458

O.L. Fisher  
U S

063458

0316951(B)

O.L. Fisher  
U S

16

15

O.L. Fisher  
U S

O.L. Fisher  
U S

063458

O.L. Fisher  
U S

063458

0316951(B)

O.L. Fisher  
U S

16

15

O.L. Fisher  
U S

O.L. Fisher  
U S

063458

O.L. Fisher  
U S

063458

0316951(B)

O.L. Fisher  
U S

16

15

O.L. Fisher  
U S

O.L. Fisher  
U S

063458

O.L. Fisher  
U S

063458

0316951(B)

O.L. Fisher  
U S

16

15

O.L. Fisher  
U S

O.L. Fisher  
U S

063458

O.L. Fisher  
U S

063458

0316951(B)

O.L. Fisher  
U S

16

15

O.L. Fisher  
U S

O.L. Fisher  
U S

063458

O.L. Fisher  
U S

063458

0316951(B)

O.L. Fisher  
U S

16