

UNITED STATES
DEPARTMENT OF THE INTERIOR
GEOLOGICAL SURVEY30 625-25218
5. LEASE DESIGNATION AND SERIAL NO.

NM-086

6. IF INDIAN, ALLOTTEE OR TRIBE NAME

7. UNIT AGREEMENT NAME

8. FARM OR LEASE NAME

Government "E"

9. WELL NO.

7

10. FIELD AND POOL, OR WILDCAT

Lea (San Andres)

11. SEC., T. R., M., OR BLK.
AND SURVEY OR AREA

Sec. 25-19S-34E

12. COUNTY OR PARISH 13. STATE

Lea

New Mexico

1a. TYPE OF WORK

DRILL ☒DEEPEN ☐PLUG BACK ☐

b. TYPE OF WELL

OIL
WELL ☒GAS
WELL ☐

OTHER

SINGLE
ZONE ☒MULTIPLE
ZONE ☐

2. NAME OF OPERATOR

The Superior Oil Company

3. ADDRESS OF OPERATOR

P. O. Box 1900, Midland, Texas 79701

4. LOCATION OF WELL (Report location clearly and in accordance with any State requirements.)*
At surface

2310' FSL & 1980' FEL Section 25

At proposed prod. zone

Same as above

14. DISTANCE IN MILES AND DIRECTION FROM NEAREST TOWN OR POST OFFICE*

8 miles southwest of Arkansas Junction

15. DISTANCE FROM PROPOSED* 330' from nearest 40
LOCATION TO NEAREST
PROPERTY OR LEASE LINE, FT. acre proration unit.
(Also to nearest drilg. line, if any)

16. NO. OF ACRES IN LEASE

640

17. NO. OF ACRES ASSIGNED
TO THIS WELL

40

18. DISTANCE FROM PROPOSED LOCATION*
TO NEAREST WELL, DRILLING, COMPLETED,
OR APPLIED FOR, ON THIS LEASE, FT.

1360'

19. PROPOSED DEPTH

6200'

20. ROTARY OR CABLE TOOLS

Rotary

21. ELEVATIONS (Show whether DF, RT, GR, etc.)

3753' GR

22. APPROX. DATE WORK WILL START*

1-15-76

23.

PROPOSED CASING AND CEMENTING PROGRAM

| SIZE OF HOLE | SIZE OF CASING | WEIGHT PER FOOT | SETTING DEPTH | QUANTITY OF CEMENT |
|--------------|----------------|-----------------|---------------|--------------------|
| 11" | 8-5/8" | 24# | 400' | 300 sx circulated |
| 7-7/8" | 5-1/2" | 15.5# | 6200' | 700 sx |

cement behind 5 1/2" casing
and fill to base of hole

The above well will be drilled using accepted and safe practices and down to industry using blowout preventers and hydril for proper well control. The above casing program will be used except that the 5-1/2" casing will be run only if the objective zones are determined to be commercial.

Blowout preventers and hydril will be installed after setting 8-5/8" surface pipe and until total depth is reached. The preventer equipment will be hydraulic controlled and contain hand wheels for manual operation. The preventer equipment will be tested at regular intervals during drilling operations to insure proper working capabilities.

APR 1 1976

IN ABOVE SPACE DESCRIBE PROPOSED PROGRAM: If proposal is to deepen or plug back, give data on present productive zone and proposed new productive zone. If proposal is to drill or deepen directionally, give pertinent data on subsurface locations and measured and true vertical depths. Give blowout preventer program, if any.

24.

SIGNED P. R. Blancett P. R. Blancett TITLE Petroleum Engineer DATE Dec. 23, 1975

(This space for Federal or State office use)

PERMIT NO. _____

APPROVAL DATE

APPROVED BY _____

TITLE _____

DATE _____

CONDITIONS OF APPROVAL, IF ANY:

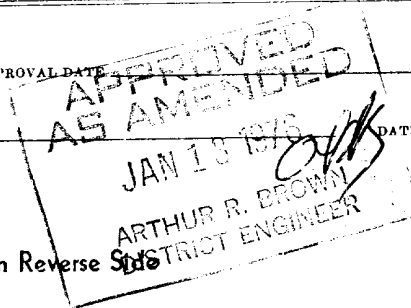

*See Instructions On Reverse Side

OIL CONSERVATION COMM.
HOBBS, N. M.

JAN 19 1976

RECEIVED
OIL CONSERVATION COMM.
HOBBS, N. M.

JAN 20 1976

RECEIVED

NEW MEXICO OIL CONSERVATION COMMISSION
WELL LOCATION AND ACREAGE DEDICATION PLAT

Form No. 1
Supersedes Form
No. 1, 1964

All distances must be from the outer boundaries of the section.

| | | | | |
|---|----------------------|-------------------------------|-------------------------|-------------|
| Operator Superior Oil Company | | Lessee Government E | | 7 |
| Tract Letter J | Section 25 | Township 19 South | Range 34 East | |
| Actual Footage Location of Well | | | | |
| 2310 | feet from the | South | line and | 1980 |
| Ground Level Elev 3753.2 | | Containing the title | | East |
| SAN ANDRES | | LEA (SAN ANDRES) | | 40 |

1. Outline the acreage dedicated to the subject well by colored pencil. (Based on the actual footage location of the well.)
2. If more than one lease is dedicated to the well, outline each and identify (by name of owner, interest and royalty).
3. If more than one lease of different ownership is dedicated to the well, have they been consolidated (by communitization, unitization, force-pooling, etc)?

☒ Yes ☐ No If answer is "yes," type of consolidation _____

If answer is "no," list the owners and tract descriptions which have a right to be included in this form if necessary.) _____

No allowable will be assigned to the well until all interests have been consolidated (by communitization, unitization, forced-pooling, or otherwise) or until a non-standard unit, eliminating such interests, has been approved by the Commission.

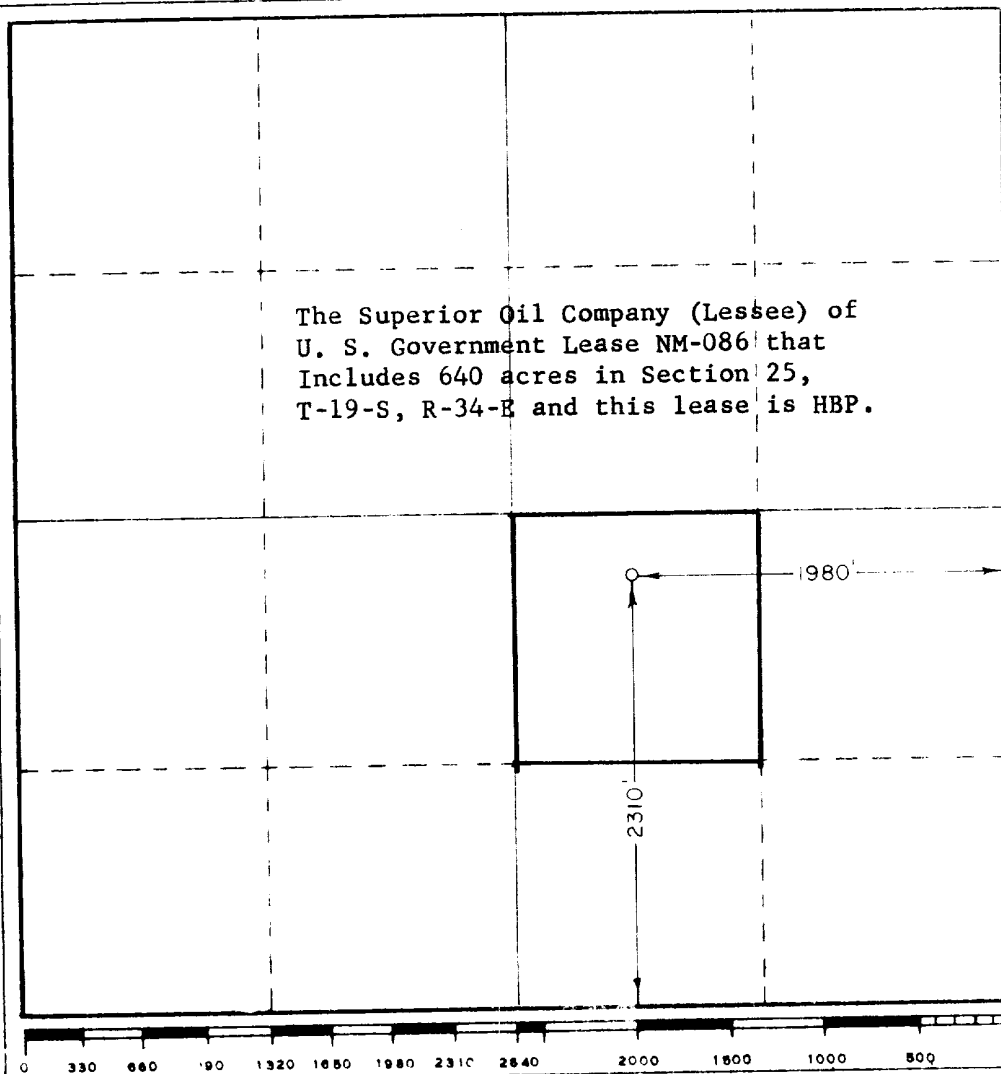

RECEIVED
JAN 20 1976
U.S. DEPARTMENT OF JUSTICE

THE SUPERIOR OIL COMPANY

P. O. BOX 1900
MIDLAND, TEXAS 79701

December 18, 1975

U. S. G. S.
P. O. Box 1157
Hobbs, New Mexico 88240

Attention: Mr. A. R. Brown

Re: Government "E" No. 7
C N/2 NW SE
Section 25-19S-34E
Lea (San Andres) Field
Lea County, New Mexico

Gentlemen:

Regarding the above captioned proposed 6,200' well, we plan to operate and oversee this operation and abide by environmental guidelines as follows:

1. Proposed road into drilling pad is shown on Exhibit "A" and existing highways and roads are shown on Exhibit "B".
2. Size of drilling pad and pits relative to roads are shown on Exhibit "A".
3. Proposed Government "E" No. 7 well is located 1,360 feet from nearest Superior Oil Company well located in the SW NE Section 25-19S-34E. The nearest tank battery under Superior's operations is at the Government "E" No. 2 well at approximately 2,400' from the proposed Government "E" No. 7 well.
4. Source of water supply for drilling: Water will be hauled by truck.
5. Trash on location will be put in reserve pit and covered with dirt.
6. If well is plugged and abandoned, earth pits will be filled with dirt and location restored to original contour.
7. If well is completed as a producer, earth pits will be filled and location restored. Tank battery will be located as shown on Exhibit "A" or production will be commingled at Government "E" No. 2 tank battery. Produced water will be stored in tank until hauled or piped to an approved disposal well.
8. Development Plans: The Government "E" No. 7 well will be drilled as rig is available and pending the outcome of log and drilling sample interpretation at the current drilling "E" No. 6 well. Additional wells are planned east and west of the proposed well as economic conditions permit.

December 18, 1975

9. Regarding oil or gas that may be produced during drilling or completion operations, this hydrocarbon will be piped a safe distance from the drilling rig and either burned or contained in storage. Blowout preventers consisting of blind and pipe rams will be used during drilling operations to provide safety and prevent spillage.

Yours very truly,

THE SUPERIOR OIL COMPANY

A handwritten signature in cursive script, reading "P. R. Blancett". The signature is written in dark ink and is positioned above the typed name and title.

P. R. Blancett
Petroleum Engineer

PRB/pbt

Attachments

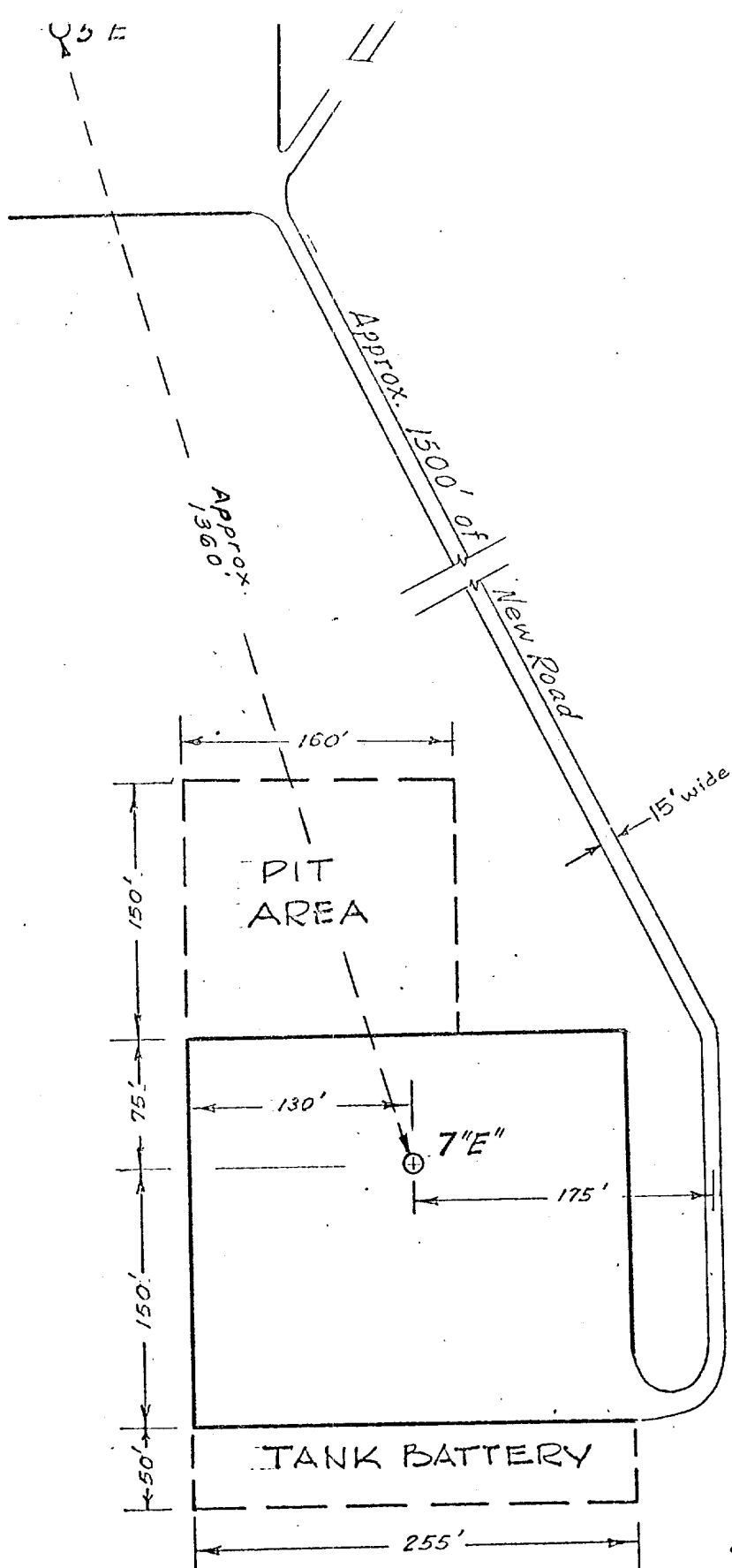
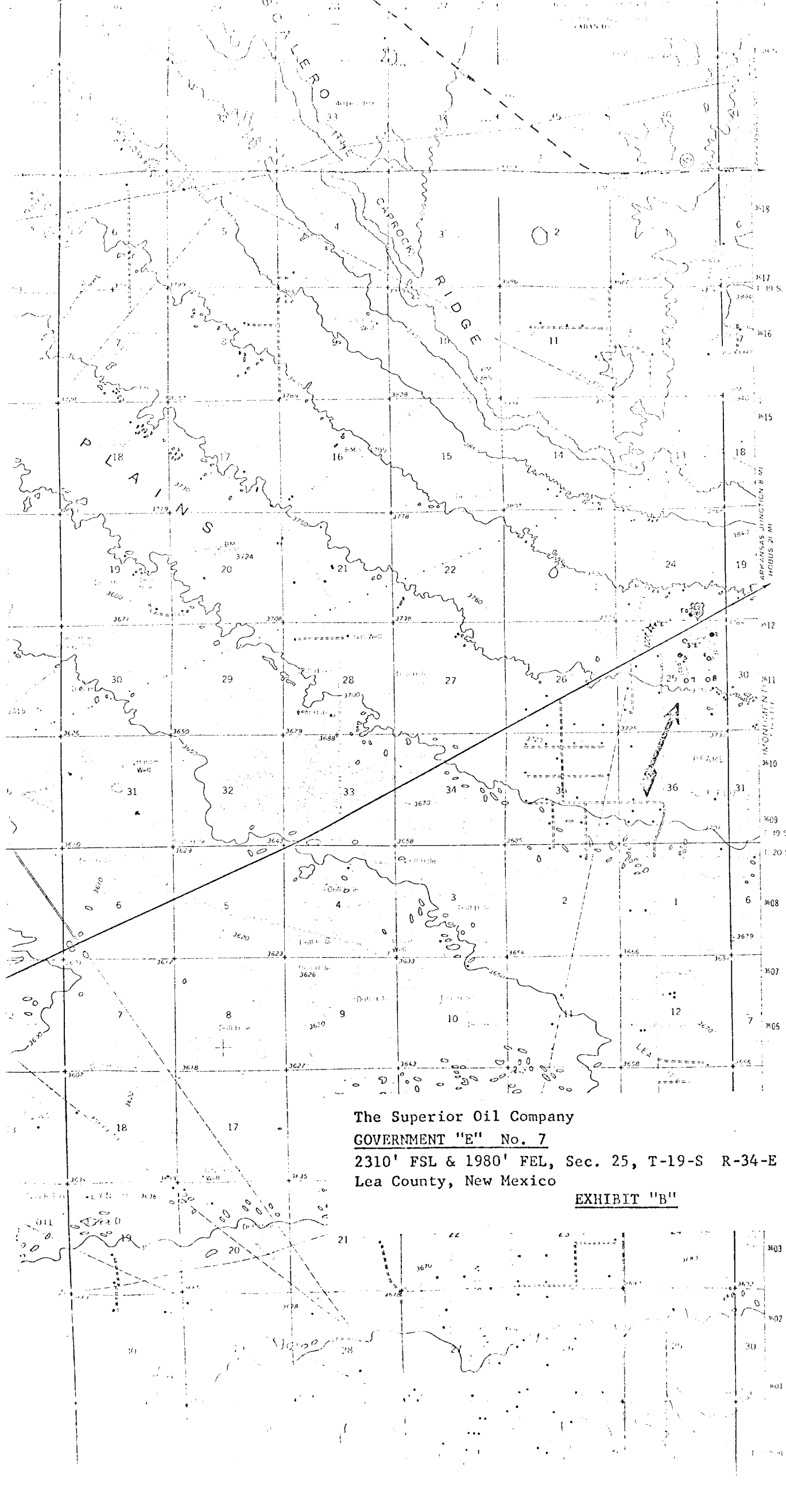

EXHIBIT "A"

The Superior Oil Company
GOVERNMENT "E" No.7
 2310' FSL & 1980' FEL
 Sec. 25, T-19-S R-34-E
 Lea County, New Mexico



The Superior Oil Company

GOVERNMENT "E" No. 7

2310' FSL & 1980' FEL, Sec. 25, T-19-S R-34-E
Lea County, New Mexico

EXHIBIT "B"

THE SUPERIOR OIL COMPANY

GOVERNMENT "E" NO. 7 WELL

2310' FSL & 1980' FEL SECTION 25, T-19-S, R-34-E
LEA (SAN ANDRES) FIELD
LEA COUNTY, NEW MEXICO

0 to 400' or 8-5/8" Casing Shoe:

Drill 11" hole with fresh water with gel and lime added along with fiber and cottonseed hulls for possible fluid loss.

400' to 6200' or 5-1/2" Casing Shoe:

Drill with brine water to prevent abnormal leaching of salt and anhydrite section. Maintain viscosity at 30 - 35 cp for cleaning hole and water loss at 10 - 12cc when drilling thru potential pay zones.

PRB/jf
12-23-75