

UNITED STATES
DEPARTMENT OF THE INTERIOR
GEOLOGICAL SURVEY

APPLICATION FOR PERMIT TO DRILL, DEEPEN, OR PLUG BACK

1a. TYPE OF WORK

DRILL ☒DEEPEN ☐PLUG BACK ☐

b. TYPE OF WELL

OIL
WELL ☒GAS
WELL ☐OTHER ☐SINGLE
ZONE ☒MULTIPLE
ZONE ☐

2. NAME OF OPERATOR

The Superior Oil Company

3. ADDRESS OF OPERATOR

P. O. Box 1900, Midland, Texas 79701

4. LOCATION OF WELL (Report location clearly and in accordance with any State requirements.)*

At surface

2310' FSL & 990' FEL of Section 25

At proposed prod. zone

Same as above

14. DISTANCE IN MILES AND DIRECTION FROM NEAREST TOWN OR POST OFFICE*

8 miles southwest of Arkansas Junction

15. DISTANCE FROM PROPOSED* LOCATION TO NEAREST PROPERTY OR LEASE LINE, FT. (Also to nearest drilg. unit line, if any)

330' from nearest 40

acre proration unit.

16. NO. OF ACRES IN LEASE

640

18. DISTANCE FROM PROPOSED LOCATION* TO NEAREST WELL, DRILLING, COMPLETED, OR APPLIED FOR, ON THIS LEASE, FT.

990'

19. PROPOSED DEPTH

6200'

17. NO. OF ACRES ASSIGNED TO THIS WELL

40

20. ROTARY OR CABLE TOOLS

Rotary

21. ELEVATIONS (Show whether DF, RT, GR, etc.)

3753' GR.

22. APPROX. DATE WORK WILL START*

February 8, 1976

23.

PROPOSED CASING AND CEMENTING PROGRAM

SIZE OF HOLE	SIZE OF CASING	WEIGHT PER FOOT	SETTING DEPTH	QUANTITY OF CEMENT
11"	8-5/8"	24#	400'	300 sx circulated //
7-7/8"	5-1/2"	15.5#	6200'	700 sx

Cement behind 5 1/2" casing
must fill to 6200'

The above well will be drilled using accepted and safe practices known to industry using blowout preventers and hydril for proper well control. The above casing program will be used except that 5-1/2" casing will be run only if the objective zones are determined to be commercial.

Blowout preventers and hydril will be installed after setting 8-5/8" surface pipe and until total depth is reached. The preventer equipment will be hydraulic controlled and contain hand wheels for manual operation. The preventer equipment will be tested at regular intervals during drilling operations to insure proper working capabilities.

APR 18 1976

IN ABOVE SPACE DESCRIBE PROPOSED PROGRAM: If proposal is to deepen or plug back, give data on present productive zone and proposed new productive zone. If proposal is to drill or deepen directionally, give pertinent data on subsurface locations and measured and true vertical depths. Give blowout preventer program, if any.

24.

SIGNED P. R. Blancett P. R. BlancettTITLE Petroleum EngineerDATE December 30, 1975

(This space for Federal or State office use)

PERMIT NO. _____

APPROVAL DATE _____

APPROVED BY _____

TITLE _____

CONDITIONS OF APPROVAL, IF ANY:

*See Instructions On Reverse Side

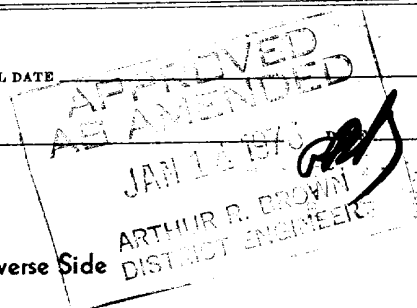

SECRET

DECLASSIFIED
JAN 23 1976
SECURITY CONTROL
NOBIS, H. M.

NEW MEXICO OIL CONSERVATION COMMISSION
WELL LOCATION AND ACREAGE DEDICATION

Form O-102
Supersedes O-128
Effective 10-1-65

All distances must be from the outer boundaries of the Section

Operator Superior Oil Company		Lease Government E		Area 8
Tract Letter I	Section 25	Township 19 South	Range 34 East	Lea
Actual Footage Location of Well: 990 (feet from toe) East line and 2310 South				
Ground Level Elev. 3753.2	Producing Formation SAN ANDRES		Lea UNDESIGNATED LEA (SAN ANDRES) 40	

1. Outline the acreage dedicated to the subject well by colored pencil or hatchure marks on the plat below.
2. If more than one lease is dedicated to the well, outline each and identify the ownership to each (as to working interest and royalty).
3. If more than one lease of different ownership is dedicated to the well, have the interests of all owners been consolidated by communitization, unitization, force-pooling, etc?

☒ Yes ☐ No If answer is "yes," type of consolidation _____

If answer is "no," list the owners and tract descriptions which have actually been consolidated. (Use reverse side of this form if necessary.) _____

No allowable will be assigned to the well until all interests have been consolidated (by communitization, unitization, forced-pooling, or otherwise) or until a non-standard unit, eliminating such interests, has been approved by the Commission.

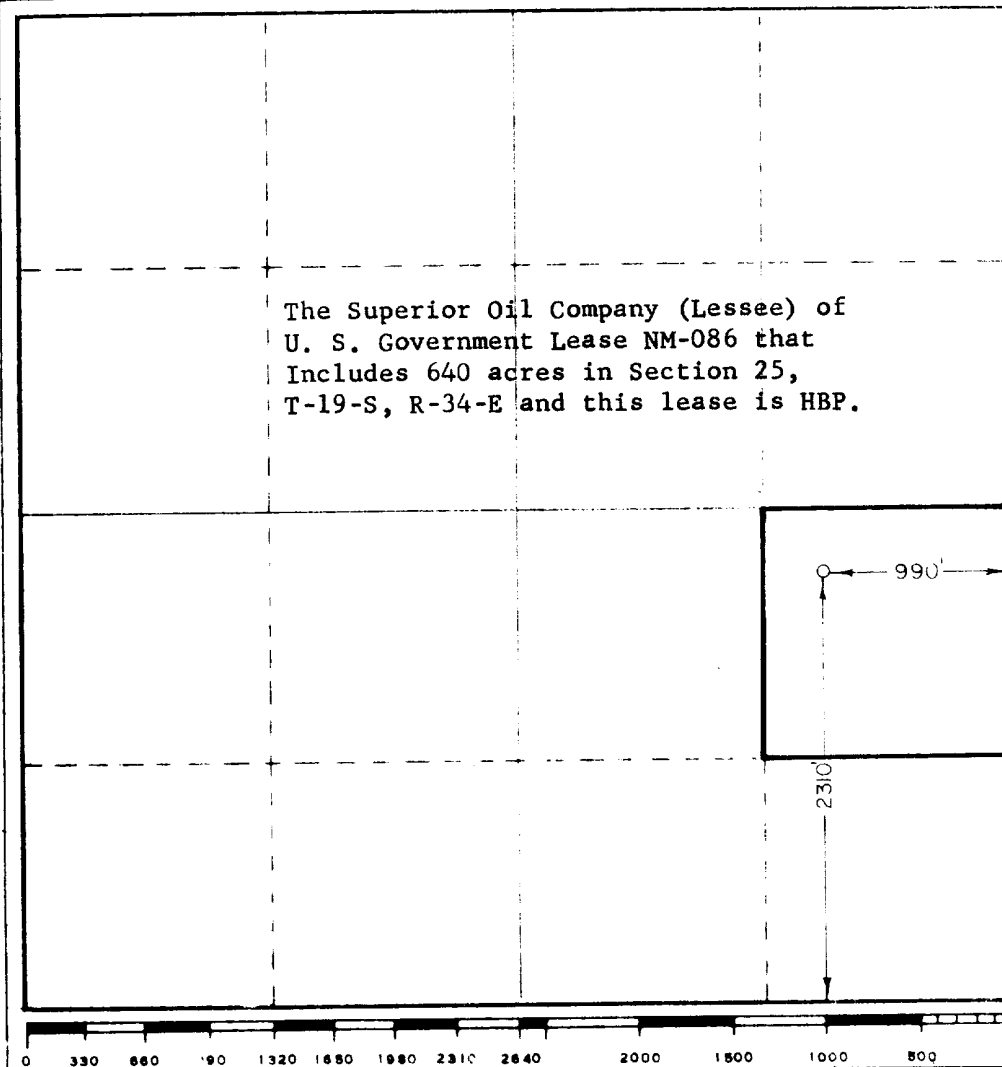

CERTIFICATION

I hereby certify that the information contained herein is true and complete to the best of my knowledge and belief.

P. R. Blancett

P. R. Blancett

Petroleum Engineer

The Superior Oil Company

December 30, 1975

I hereby certify that the well location shown on this plat was plotted from field notes of actual surveys made by me or under my supervision, and that the same is true and correct to the best of my knowledge and belief.

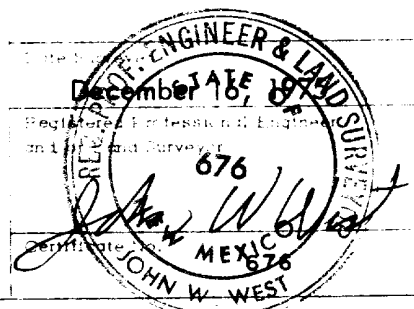

THE SUPERIOR OIL COMPANY

P. O. BOX 1900
MIDLAND, TEXAS 79701

December 30, 1975

U. S. G. S.
P. O. Box 1157
Hobbs, New Mexico 88240

Attention: Mr. A. R. Brown

Re: Government "E" No. 8
2310' FSL & 990' FEL
Section 25-19S-34E
Lea (San Andres) Field
Lea County, New Mexico

Gentlemen:

Regarding the above captioned proposed 6,200' well, we plan to operate and oversee this operation and abide by environmental guidelines as follows:

1. Proposed road into drilling pad is shown on Exhibit "A" and existing highways and roads are shown on Exhibit "B".
2. Size of drilling pad and pits relative to roads are shown on Exhibit "A".
3. Proposed Government "E" No. 8 well is located 990' feet from the nearest Superior Oil Company proposed well located in the N/2 NW SE Section 25-19S-34E. The nearest tank battery under Superior's operations is at the Government "E" No. 2 well at approximately 2200' from the proposed Government "E" No. 8 well.
4. Source of water supply for drilling: Water will be hauled by truck.
5. Trash on location will be put in reserve pit and covered with dirt. **TRASH AND JUNK SHOULD BE BURIED IN A SEPARATE TRASH PIT AND COVERED WITH 24" OF SOIL**
6. If well is plugged and abandoned, earth pits will be filled with dirt and location restored to original contour.
7. If well is completed as a producer, earth pits will be filled and location restored. Tank battery will be located as shown on Exhibit "A" or production will be commingled at Government "E" No. 2 tank battery. Produced water will be stored in tank until hauled or piped to an approved disposal well.

Re: Government "E" No. 8
2310' FSL & 990' FEL
Section 25-19S-34E
Lea (San Andres) Field
Lea County, New Mexico

8. Development Plans: The Government "E" No. 8 well will be drilled as rig is available and pending the outcome of log and drilling sample interpretation at the proposed "E" No. 7 well. Additional wells are planned west and north of the proposed well as economic conditions permit.
9. Regarding oil or gas that may be produced during drilling or completion operations, this hydrocarbon will be piped a safe distance from the drilling rig and either burned or contained in storage. Blowout preventers consisting of blind and pipe rams will be used during drilling operations to provide safety and prevent spillage.

Yours very truly,

THE SUPERIOR OIL COMPANY



P. R. Blancett
Petroleum Engineer

PRB/kb

Attachments

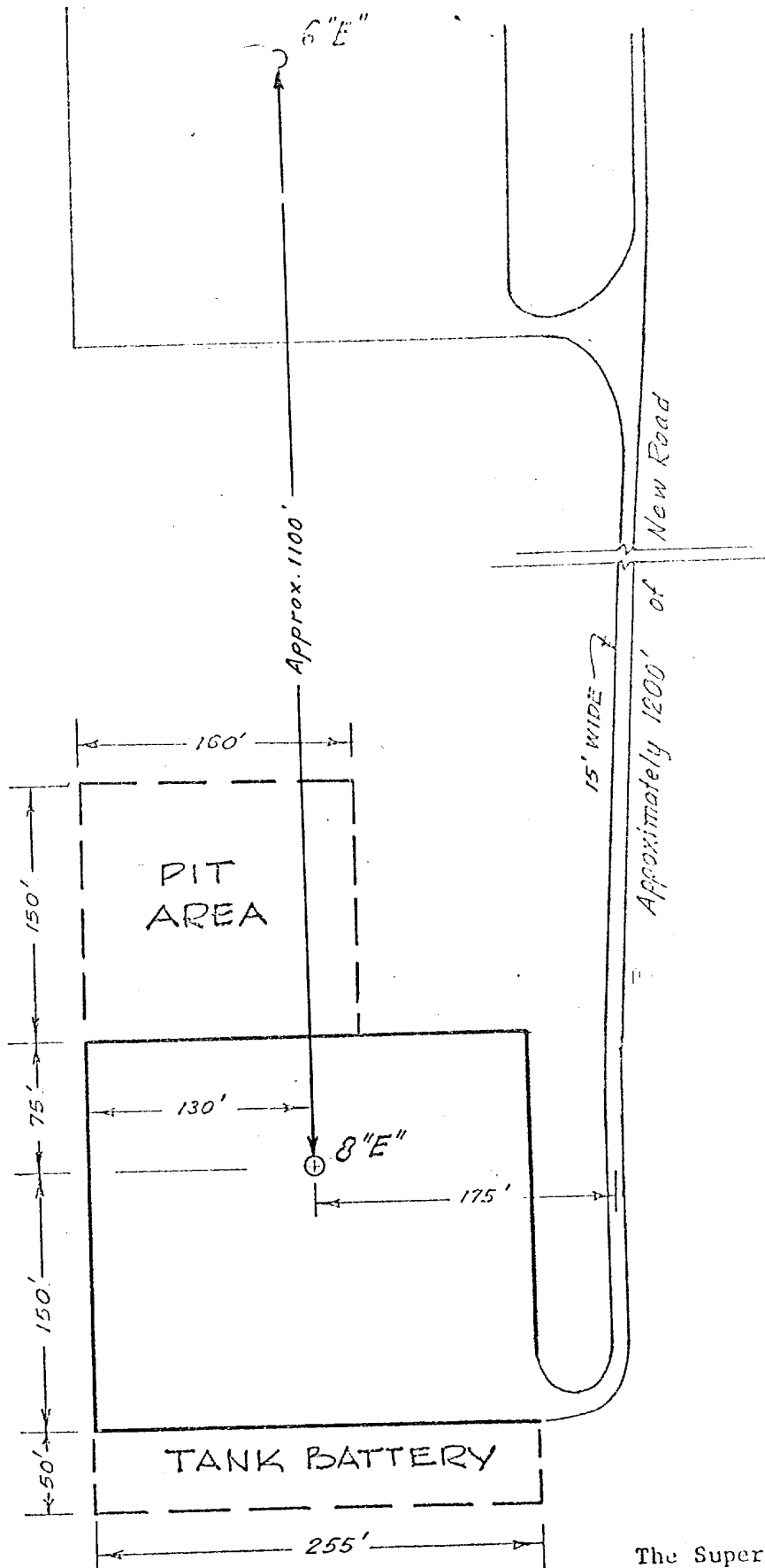
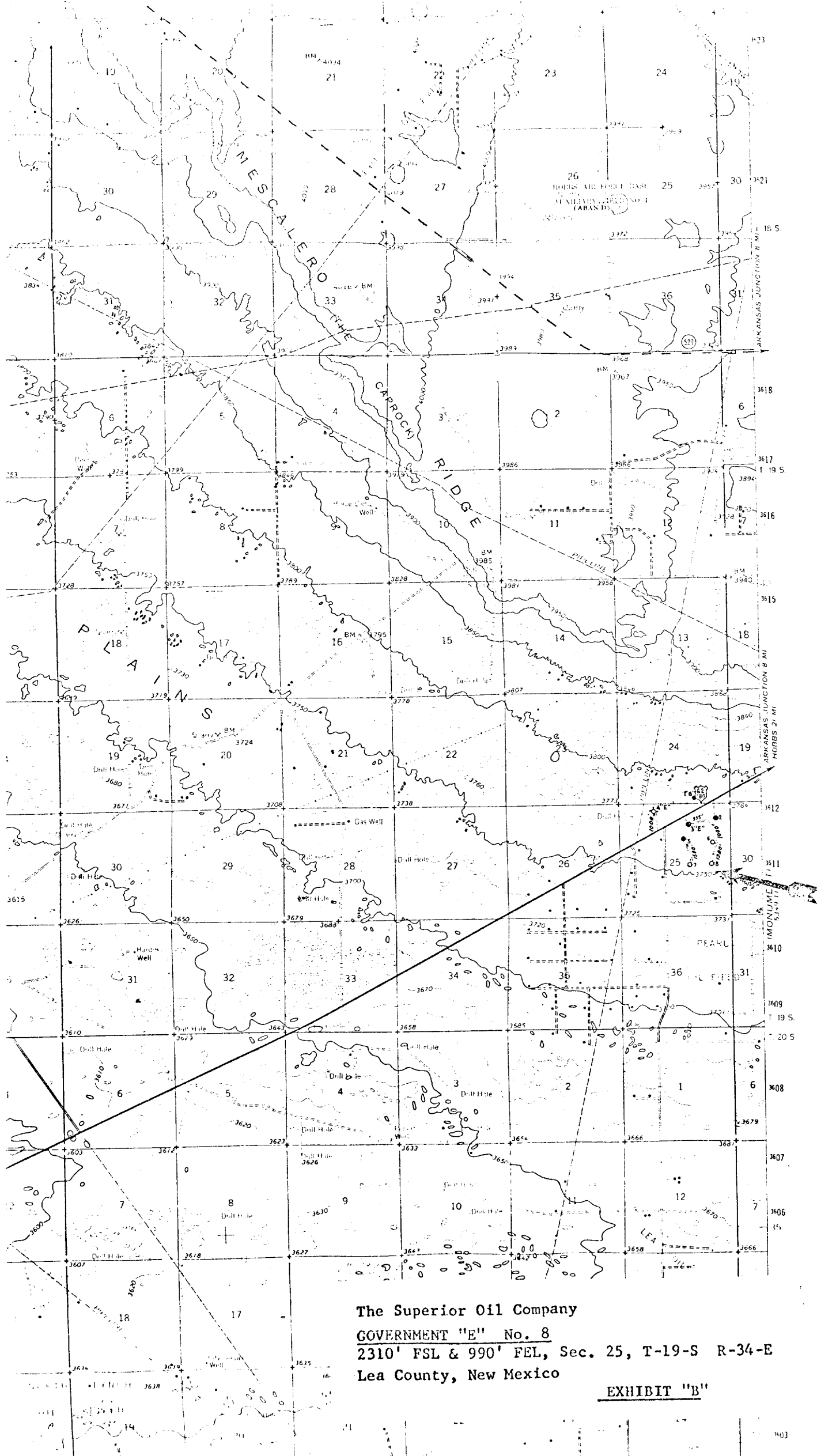

EXHIBIT "A"

The Superior Oil Company
GOVERNMENT "E" No.8
2310' FSL & 990' FEL
Sec. 25, T-19-S R-34-E
Lea County, New Mexico



The Superior Oil Company
GOVERNMENT "E" No. 8
2310' FSL & 990' FEL, Sec. 25, T-19-S R-34-E
Lea County, New Mexico

EXHIBIT "B"

THE SUPERIOR OIL COMPANY

GOVERNMENT "E" NO. 8 WELL

2310' FSL & 990' FEL SECTION 25, T-19-S, R-34-E
LEA (SAN ANDRES) FIELD
LEA COUNTY, NEW MEXICO

0 to 400' or 8-5/8" Casing Shoe:

Drill 11" hole with fresh water with gel and lime added along with fiber and cottonseed hulls for possible fluid loss.

400' to 6200' or 5-1/2" Casing Shoe:

Drill with brine water to prevent abnormal leaching of salt and anhydrite section. Maintain viscosity at 30 - 35 cp for cleaning hole and water loss at 10 - 12cc when drilling thru potential pay zones.

PRB/jf
12-23-75