

UNITED STATES
DEPARTMENT OF THE INTERIOR
GEOLOGICAL SURVEY

APPLICATION FOR PERMIT TO DRILL, DEEPEN, OR PLUG BACK

1a. TYPE OF WORK

DRILL ☒DEEPEN ☐PLUG BACK ☐

b. TYPE OF WELL

OIL
WELL ☒GAS
WELL ☐

OTHER

SINGLE
ZONE ☒MULTIPLE
ZONE ☐

2. NAME OF OPERATOR

Julian Ard

3. ADDRESS OF OPERATOR

P. O. Box 2361, Midland, Texas 79701

4. LOCATION OF WELL (Report location clearly and in accordance with any State requirements.)*

At surface

660' from West line and 1980' from Southline, Section

At proposed prod. zone 33. T-9-S, R-38-E

14. DISTANCE IN MILES AND DIRECTION FROM NEAREST TOWN OR POST OFFICE*

10 miles Southwest of Bledsoe, Texas

15. DISTANCE FROM PROPOSED*

LOCATION TO NEAREST
PROPERTY OR LEASE LINE, FT.
(Also to nearest drlg. unit line, if any)

660 feet

16. NO. OF ACRES IN LEASE

304.92

17. NO. OF ACRES ASSIGNED
TO THIS WELL

40

18. DISTANCE FROM PROPOSED LOCATION*
TO NEAREST WELL, DRILLING, COMPLETED,
OR APPLIED FOR, ON THIS LEASE, FT.

No other wells

19. PROPOSED DEPTH

5400

20. ROTARY OR CABLE TOOLS

Rotary

21. ELEVATIONS (Show whether DF, RT, GR, etc.)

3918 GR

22. APPROX. DATE WORK WILL START*

May 25, 1976

23.

PROPOSED CASING AND CEMENTING PROGRAM

SIZE OF HOLE	SIZE OF CASING	WEIGHT PER FOOT	SETTING DEPTH	QUANTITY OF CEMENT
12 1/4	8 5/8"	24	450 See ATTACHED STIPS	250 - Sacks
7 7/8	4 1/2"	10.5	5100	300 - Sacks

8 5/8" surface casing will be cemented to surface of ground.

Mud Program

See proposed Mud Program Attached

Blow-Out Equipment

See diagram attached.

IN ABOVE SPACE DESCRIBE PROPOSED PROGRAM: If proposal is to deepen or plug back, give data on present productive zone and proposed new productive zone. If proposal is to drill or deepen directionally, give pertinent data on subsurface locations and measured and true vertical depths. Give blowout preventer program, if any.

24.

SIGNED

Betty Thompson

TITLE

Agent

(This space for Federal or State office use)

PERMIT NO.

APPROVAL DATE

DATE

April 27, 1976

APPROVED BY

TITLE

CONDITIONS OF APPROVAL, IF ANY:

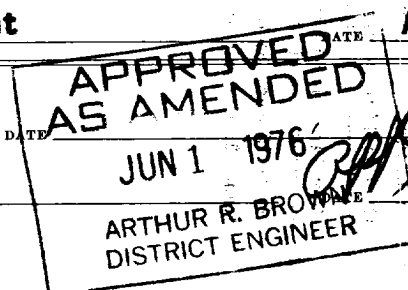

*See Instructions On Reverse Side

Instructions

General: This form is designed for submitting proposals to perform certain well operations, as indicated, on all types of lands and leases for appropriate action by either a Federal or a State agency, or both, pursuant to applicable Federal and/or State laws and regulations. Any necessary specific instructions concerning the use of this form and the number of copies to be submitted, particularly with regard to local, area, or regional procedures and practices, either are shown below or will be issued by, or may be obtained from, the local Federal and/or State office.

Item 1: If the proposal is to redrill to the same reservoir at a different subsurface location or to a new reservoir, use this form with appropriate notations. Consult applicable State or Federal regulations concerning subsequent work proposals or reports on the well.

Item 4: If there are no applicable State requirements, locations on Federal or Indian land should be described in accordance with Federal requirements. Consult local State or Federal office for specific instructions.

Item 14: Needed only when location of well cannot readily be found by road from the land or lease description. A plat, or plats, separate or on this reverse side, showing the route to, and the surveyed location of, the well, and any other required information, should be furnished when required by Federal or State agency offices.

Items 15 and 18: If well is to be, or has been directionally drilled, give distances for subsurface location of hole in any present or objective production zone.

Item 22: Consult applicable Federal or State regulations, or appropriate officials, concerning approval of the proposal before operations are started.

**NEW MEXICO OIL CONSERVATION COMMISSION
WELL LOCATION AND ACREAGE DEDICATION PLAT**

Form C-102
Supersedes C-128
Effective 1-1-65

All distances must be from the outer boundaries of the Section.

Operator Julian Ard			Lease KGS-Federal		Well No. 1
Unit Letter L	Section 33	Township 9S	Range 38E	County Lea	
Actual Footage Location of Well: 660 feet from the West line and 1980 feet from the South line					
Ground Level Elev. 3918	Producing Formation San Andres		Pool Sawyer		Dedicated Acreage: 40 Acres

1. Outline the acreage dedicated to the subject well by colored pencil or hachure marks on the plat below.
2. If more than one lease is dedicated to the well, outline each and identify the ownership thereof (both as to working interest and royalty).
3. If more than one lease of different ownership is dedicated to the well, have the interests of all owners been consolidated by communitization, unitization, force-pooling, etc?

☐ Yes ☐ No If answer is "yes," type of consolidation _____

If answer is "no," list the owners and tract descriptions which have actually been consolidated. (Use reverse side of this form if necessary.) _____

No allowable will be assigned to the well until all interests have been consolidated (by communitization, unitization, forced-pooling, or otherwise) or until a non-standard unit, eliminating such interests, has been approved by the Commission.

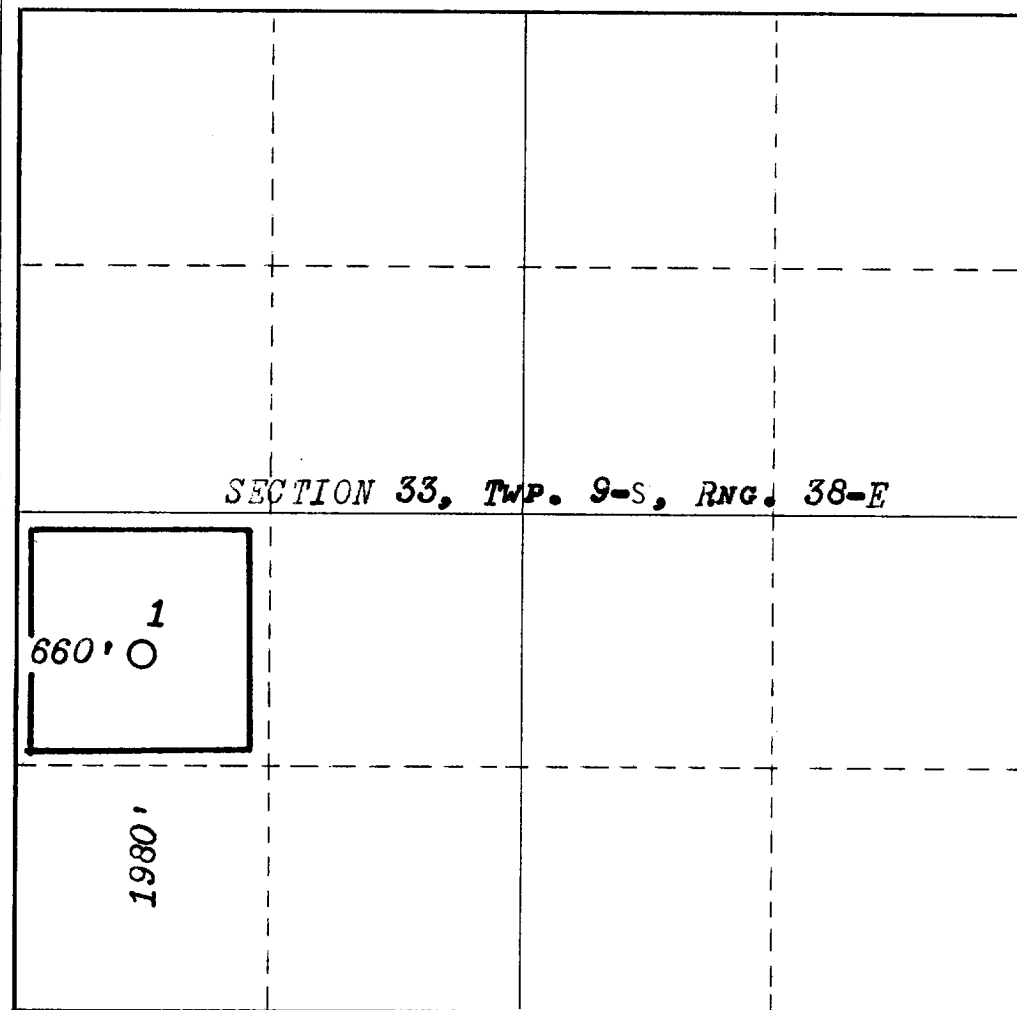

CERTIFICATION

I hereby certify that the information contained herein is true and complete to the best of my knowledge and belief.

Betty Thompson

Name

Agent

Position

Julian Ard

Company

April 27, 1976

Date

I hereby certify that the well location shown on this plat was plotted from field notes of actual surveys made by me or under my supervision, and that the same is true and correct to the best of my knowledge and belief.

Date Surveyed

JAN. 8, 1976

Registered Professional Engineer
and/or Land Surveyor

Robert M. White

Certificate No.

754

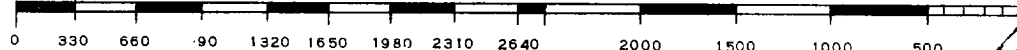



P. O. BOX 7237
MIDLAND, TEXAS 79701

Company Julian Ard County Lea State New Mexico

Well Name KGS-Federal #1 Prepared for Mr. Ard

Legal Description Section 33, 9 S- 38 E. Date 1-30-76

660 FWL and 1980 F5L

MUD RECOMMENDATIONS				CASING	FORMATION TOPS
Depth ft.	Mud Weight ppg	Viscosity Sec./Qt.	API Filtrate ml	8 5/8	
0-500	8.0-9.4	36-40	No Control	500'	1000'
Spud Mud and Native Mud.					
500-4900	9.5-10.1	33-35	No Control		2000' Yates
Continue drilling with Native Mud from surface hole. Control the Viscosity at 33 to 35 seconds 1000c.c. with water added at the flowline only. Circulate the reserve pit to keep solids at a minimum. Control seepage to shallow sands with Dicks Mud Seal.					3000'
4900'-5200'	10.0-10.1	38-40	10.0-20.0c.c.		4000'
At 4900' return to working pits and reduce the water loss to 10.0-20.0 c.c. with WF Starch and maintain the Viscosity at 38-40 seconds 1000 c.c.					5000'
				5200'	

Estimated Cost \$3000.00 - \$4000.00

