

WELL NAME: Pearl B No. 4

COUNTY: Lea

LOCATION: 660' FSL & 1980' FWL of Sec. 25,
T-17S, R-32E

STATE: New Mexico
Est. 3985' KB

DEPTH	FORMATION TOPS & TYPE	DRILLING PROBLEMS	TYPE OF FORMATION EVALUATION	HOLE SIZE (IN)	New CASING		FRACTURE GRADIENT (PPG)	FORMATION PRESSURE GRADIENT (PPG)	MUD	
					SIZE (IN)	DEPTH (FT)			WEIGHT (PPG)	TYPE
	Quaternary Surface Santa Rosa S.S.									
	Rustler Anhy 1180 Salado Salt 1280			12-1/4	5-8	1200	-	-	8.5 9.0	Fresh Water
	Tansill Anhy 2470 Yates S.S. 2590		GR-SNP 2500'-TD DLL 2500'-TD Temp Survey 0'-3000'							
	Seven Rivers Dolomite 2970									
	Queen S.S. 3550 Penrose S.S. 3710									
	3rd zone 4010 4th zone 4050 5th zone 4110 6th zone 4200 7th zone 4300 TD 4450		DEFLECTION & GEOLOGRAPH 0 - TD Cement Bond 0 - TD	7-5/8	5-1/2	4450	16.0 17.0	Less than 8.5	9.0 10.0	Salt Gel

RECEIVED

JAN 28 1977

OIL CONSERVATION COMM.
HOBBS, N. M.

CONTINENTAL OIL COMPANY
Blow-out Preventer Specifications

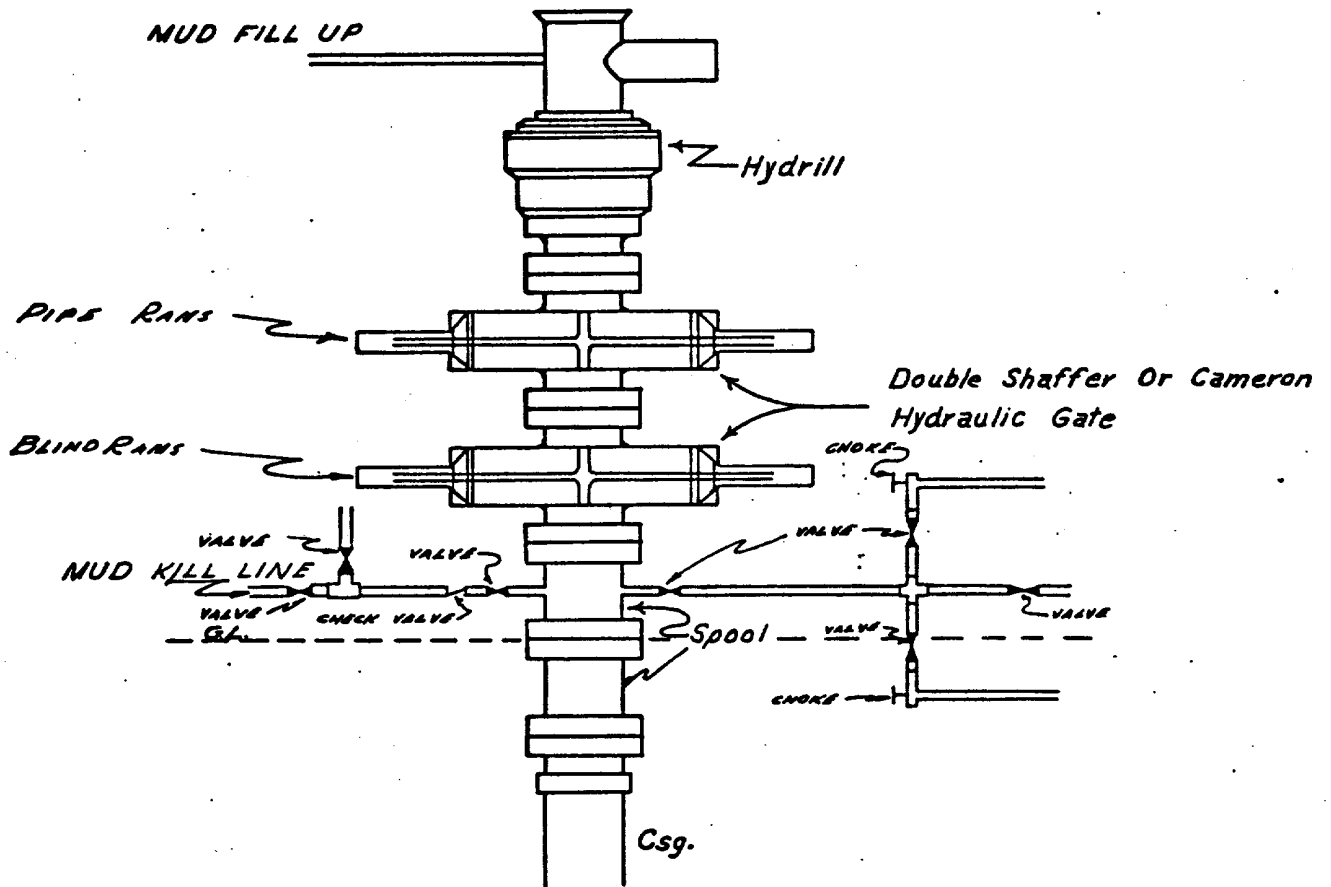

API Series 900

NOTE:

Manual and Hydraulic controls with closing unit no less than 75' from well head. Remote controls on rig floor.

DUE TO SUBSTRUCTURE CLEARANCE, HYDRILL MAY OR MAY NOT BE USED.

Per 1 "B" NO. 4

RECEIVED

JAN 28 1977

OIL CONSERVATION COMM.
HOBBS, N. M.

SURFACE USE PLAN
Continental Oil Company, Pearl "B" No. 4
660' FSL and 1980' FWL of Section 25, T-17S, R-32E
Lease LC-058697, Lea County, NM

The plan is to accompany "Application for Permit to Drill" the subject well which is located approximately 38 miles northwest of Hobbs, New Mexico. The following is a discussion of pertinent information concerning possible effect which the proposed drilling of the well may have on the environment of the well and road sites and surrounding acreage. A copy will be posted on the derrick floor so that all contractors and sub-contractors will be aware of all items of this plan.

1. Existing Roads

- A. The proposed well site is 660' FSL and 1980' FWL of Section 25, T-17S, R-32E, Lea County, New Mexico.
- B. Exhibit "A" is a portion of a New Mexico road map showing existing roads. Directions to the location (outlined in red on map) from Hobbs, New Mexico are as follows: From Hobbs travel west on Highway 62-180 for 15 miles to the intersection of Highway 529 bear right on 529 and go west 22 miles; turn north on blacktop road to Maljamar and go 1 1/2 miles; turn east on caliche road for 1.8 miles to the second black and silver tank battery on south side of road; turn south on caliche road for .5 miles; turn east for .2 miles south .1 mile; turn east .2 miles to the MCA Unit Well No. 192 and the new road stakes will be south from this point to approximately 1500'
- C, D, E. The access roads are shown on Exhibits "B" and "C".
- F. No improvement or maintenance are anticipated for the existing roads.

2. Planned Access Roads

- A. Width and Length: New road required will be 12' wide and 1500' long. This new road is labeled and color coded on Exhibits "B" and "C". (staked)
- B. Turnouts: None.
- C. Drainage Design: New road will have a drop of 6" from center line on each side.
- D. Culverts, Cuts and Fills: None
- E. Surfacing Material: Six inches of caliche, bladed, watered and compacted.

RECEIVED

JAN 25 1977

OIL CONSERVATION COMM.
HOBBS, N. M.

F. Gates, Cattleguards, Fences: None required.

G. The proposed road is staked.

3. Location of Existing Wells

See Exhibit "C"

4. Location of Existing and/or Proposed Facilities

A. Tank Batteries: The existing production header is located in the NW/4 of Section 25 and located on Exhibit "D".

B. Producing Facilities: If productive a new battery will be installed on east edge of the new well pad.

C. Oil Gathering Lines: Refer to item B above.

D. Other Lines: No additional gas gathering, injection or disposal lines will be required.

E. Rehabilitation: Pits will be backfilled and leveled as soon as practical to original condition. Commencement of rehabilitation operations will immediately follow removal of drilling and completion equipment from location and rehabilitation of the surface is planned to be completed within 45 days from commencement.

5. Water Supply

1900' of 2" water line will be installed from the MCA Unit No. 190 injection well.

6. Source of Construction Materials

A. Caliche for surfacing the new road and the well pad will be obtained from an existing pit in the NW/SE Section 25, T-17S, R-32E as shown on Exhibit "C".

B. Caliche to be purchased from Bureau of Land Management.

C. The caliche to be hauled, from the location of caliche pit. travel 300' north; 1500' west; 400' south; 400' east.

7. Methods for Handling Waste Disposal

Waste Disposal: Well cuttings will be disposed in reserve pit. Barrel trash containers to be in accessible locations within

RECEIVED

JAN 25 1977

OIL CONSERVATION COMM.
HOBBS, N. M.

drill site area during drilling and completion procedures. All detrimental waste will be hauled away, burned or buried with a minimum cover of 24" of dirt. See Exhibit "E" for location of pits. If well is productive, maintenance waste will be placed in special trash cans and hauled away periodically. Any produced water will be collected in tanks until hauled to an approved disposal system, or separate disposal applications will be submitted to the survey for appropriate approval.

8. Ancillary Facilities

None

9. Well Site Layout

Exhibit "E" shows the relative location and dimensions of the well pad, mud pit, reserve pit, trash barrel, etc. The reserve pit will be lined with plastic. The pad and pits are staked.

10. Plans for Restoration of Surface

Pits will be backfilled and leveled as soon as practical to original condition. Commencement of rehabilitation operations will immediately follow removal of drilling and completion equipment from location and rehabilitation of the surface is planned to be completed within 45 days from commencement.

11. Other Information

- A. Terrain: Low rolling sand hills. See Exhibit "B", topographic map of area.
- B. Soil: Sandy Cover on Caliche
- C. Vegetation: Shinnery, Mesquite, clumps of Range Grass
- D. Surface Use: Grazing
- E. Ponds and Streams: None within one mile
- F. Water Wells: None within one mile
- G. Residences and Building: None within one mile
- H. Arroyos, Canyons, Etc.: There are no significant surface features, see attached Exhibit "B".
- I. Well Sign: Sign identifying and locating well will be maintained at drill site with the spudding of the well.
- J. Open Pits: All pits containing mud or other liquids will be fenced.

RECEIVED

JAN 28 1977

**OIL CONSERVATION COMM.
HOBBS, N. M.**

K. Archaeological Resources: None observed

12. Operator's Representative

Field personnel who can be contacted concerning compliance of this Surface Use Plan are as follows:

Production and Drilling
D. S. Anderson or D. A. Sowers
1001 North Turner
Hobbs, New Mexico 88240

Phone: 393-4141

13. Certification

I hereby certify that I, or persons under my direct supervision, have inspected the proposed drill site and access route; that I am familiar with the conditions which presently exist; that the statements made in this plan are, to the best of my knowledge, true and correct; and that the work associated with the operations proposed herein will be performed by Continental Oil Company and its contractors and sub-contractors in conformity with this plan and the terms and conditions under which it is approved.

1-6-77

Date

D. A. Sowers

D. A. Sowers

Production Superintendent

rej

RECEIVED

JAN 25 1977

**OIL CONSERVATION COMM.
HOBBS, N. M.**

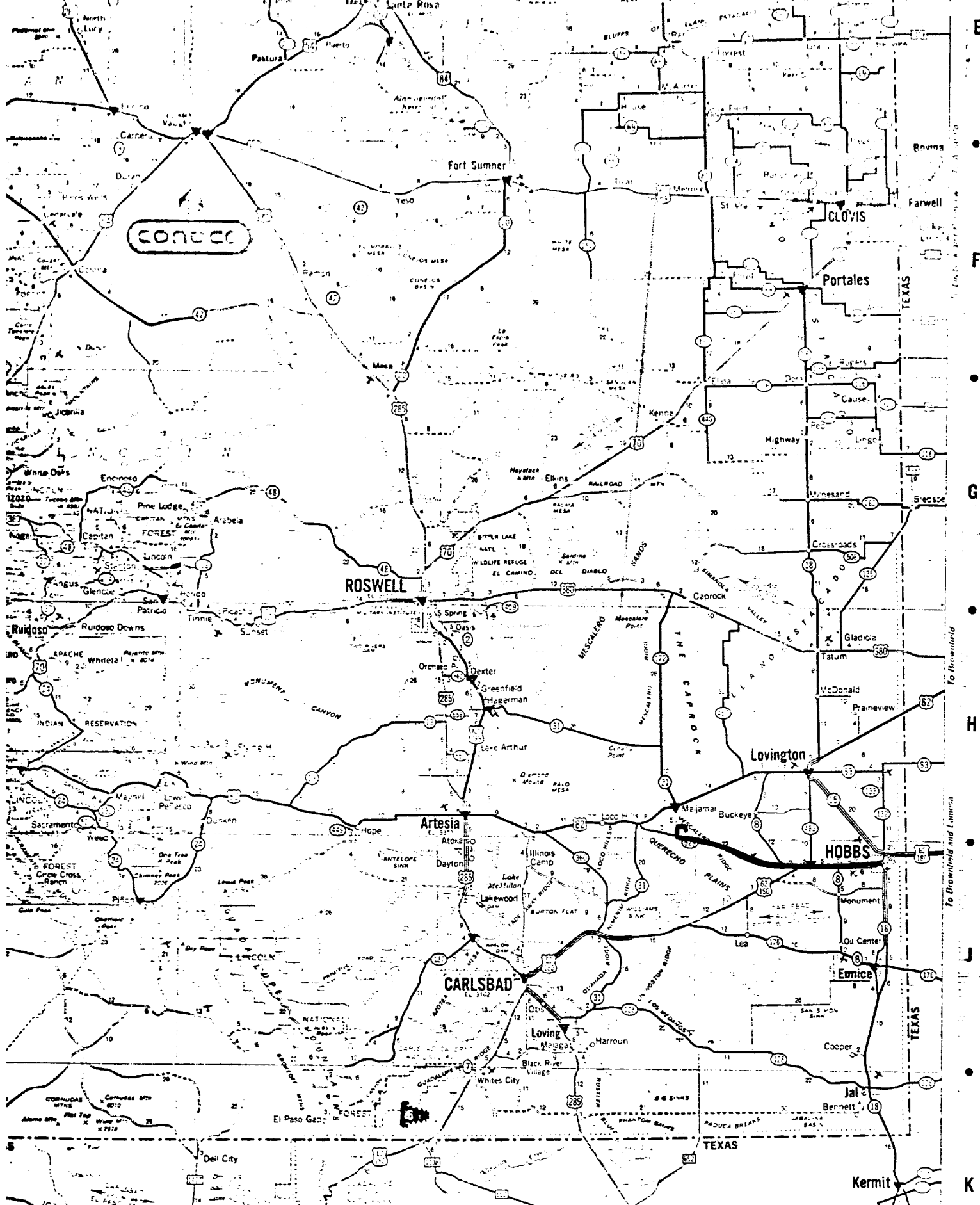

11	San Antonio	C4	Springer	C6	Tucuman	D6	Wagon Mound
12	San Juan	C4	Springer	C6	Tucuman	D6	Wagon Mound
13	San Jose	C4	Springer	C6	Tucuman	D6	Wagon Mound
14	San Luis	C4	Springer	C6	Tucuman	D6	Wagon Mound
15	San Marcos	C4	Springer	C6	Tucuman	D6	Wagon Mound
16	San Miguel	C4	Springer	C6	Tucuman	D6	Wagon Mound
17	San Rafael	C4	Springer	C6	Tucuman	D6	Wagon Mound
18	San Regis	C4	Springer	C6	Tucuman	D6	Wagon Mound
19	San Rita	C4	Springer	C6	Tucuman	D6	Wagon Mound
20	San Saba	C4	Springer	C6	Tucuman	D6	Wagon Mound
21	San Simón	C4	Springer	C6	Tucuman	D6	Wagon Mound
22	San Vicente	C4	Springer	C6	Tucuman	D6	Wagon Mound
23	Santa Ana	C4	Springer	C6	Tucuman	D6	Wagon Mound
24	Santa Clara	C4	Springer	C6	Tucuman	D6	Wagon Mound
25	Santa Cruz	C4	Springer	C6	Tucuman	D6	Wagon Mound
26	Santa Fe	C4	Springer	C6	Tucuman	D6	Wagon Mound
27	Santa Rosa	C4	Springer	C6	Tucuman	D6	Wagon Mound
28	Sauger	C4	Springer	C6	Tucuman	D6	Wagon Mound
29	Schick	C4	Springer	C6	Tucuman	D6	Wagon Mound
30	Schick	C4	Springer	C6	Tucuman	D6	Wagon Mound
31	Schick	C4	Springer	C6	Tucuman	D6	Wagon Mound
32	Schick	C4	Springer	C6	Tucuman	D6	Wagon Mound
33	Schick	C4	Springer	C6	Tucuman	D6	Wagon Mound
34	Schick	C4	Springer	C6	Tucuman	D6	Wagon Mound
35	Schick	C4	Springer	C6	Tucuman	D6	Wagon Mound
36	Schick	C4	Springer	C6	Tucuman	D6	Wagon Mound
37	Schick	C4	Springer	C6	Tucuman	D6	Wagon Mound
38	Schick	C4	Springer	C6	Tucuman	D6	Wagon Mound
39	Schick	C4	Springer	C6	Tucuman	D6	Wagon Mound
40	Schick	C4	Springer	C6	Tucuman	D6	Wagon Mound

LOCATIONS WHERE CONOCO P
 ▼ LOCATIONS OF INTEREST - RAILROADS, AIRPORTS, AND OTHER FACILITIES
 ▼ LOCATIONS OF CONOCO TANKS
 ▼ LOCATIONS WHERE CONOCO HAS A POSSESSORY INTEREST IN OIL PROPERTIES - LOOK FOR THIS

CONTINENTAL OIL CO.
 PEARL "B" NO. 4
 EXHIBIT "A"

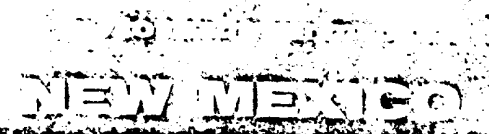

HIGHWAY MARKERS
 INTERSTATE 40 UNITED STATES 66 STATE 41 TEXAS FARM OR RANCH 300

ROAD CLASSIFICATIONS
 CONTROLLED ACCESS DIVIDED HIGHWAYS Interstate interchange numbers are marked
 OTHER DIVIDED HIGHWAYS
 PRINCIPAL THROUGH HIGHWAYS
 OTHER THROUGH HIGHWAYS

Divided Interchange
 Undivided Interchange
 Paved Gravel

MILEAGES
 MILEAGE BETWEEN TOWNS AND JUNCTIONS 3 1/4 MILEAGE BETWEEN DOTS

LONG DISTANCE MILEAGES SHOWN IN RED

SPECIAL FEATURES
 STATE MARKS With Composites Without Composites
 RECREATION AREAS With Composites Without Composites
 PORTS OF ENTRY Open 24 Hours Inquire Locally
 POINTS OF INTEREST

SCHEDULED AIRLINE STOPS
 MILITARY AIRPORTS
 OTHER AIRPORTS
 TOURIST INFORMATION
 SKI AREAS
 SELECTED REST AREAS
 BOAT RAMPS
 TIME ZONE BOUNDARY

POPULATION SYMBOLS
 See Capital
 Under 1,000
 1,000 to 2,500
 2,500 to 5,000
 5,000 to 10,000
 10,000 to 25,000
 25,000 to 50,000
 50,000 to 100,000

RECEIVED

JAN 20 1977

OIL CONSERVATION COMM.
HOBBS, N. M.

BLKTOP ROAD TO MALJAMAR
1.8 MILES
1.5 MILES

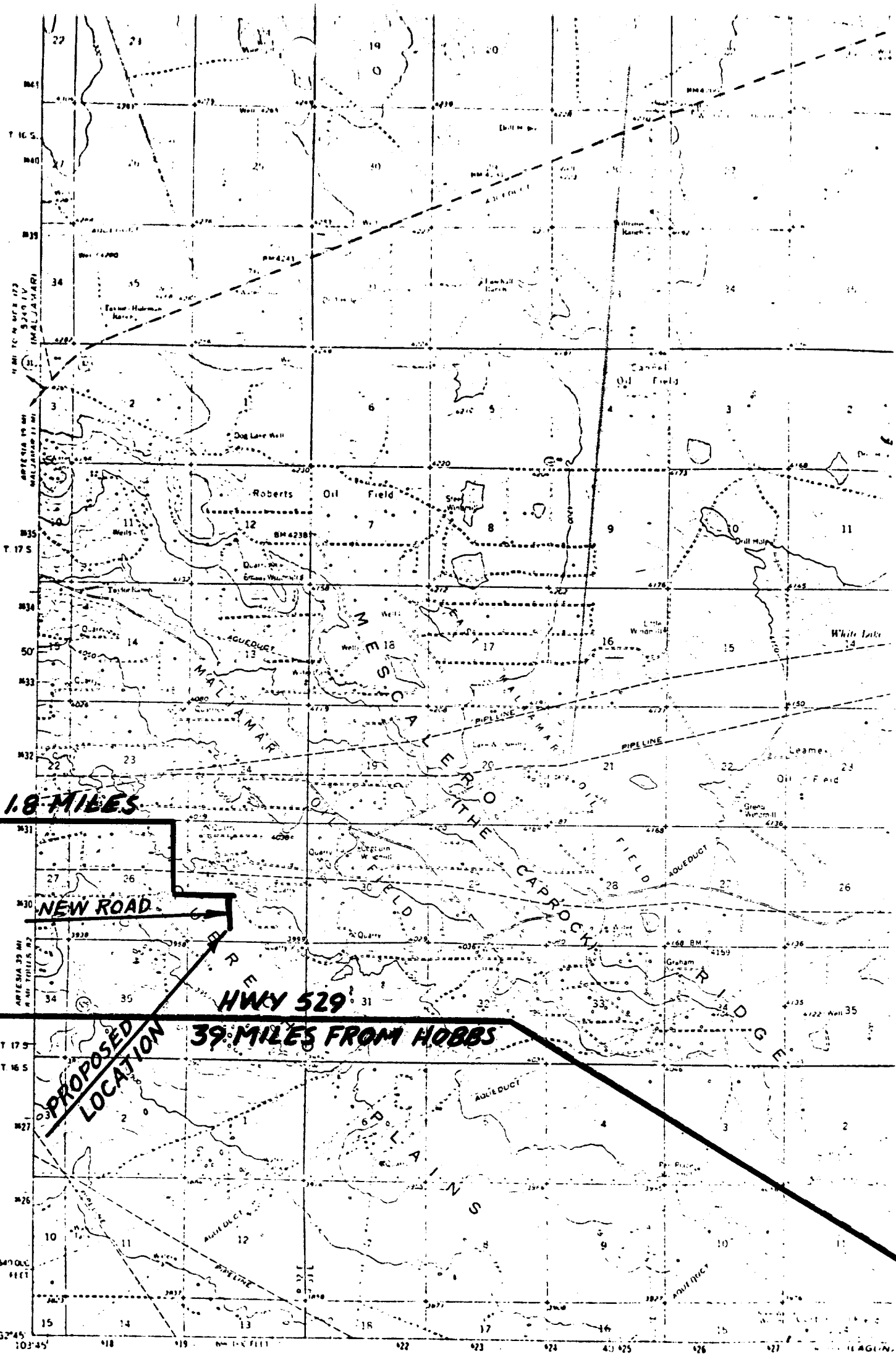

Maped, edited, and published by the Geological Survey
Control by USGS and USC&GS
Planimetry by photogrammetric methods from aerial photographs taken 1957. Topography by planimetric surveys 1962
Polyconic projection. 1927 North American datum
10 (NA) foot grid based on true Mexico coordinate system east zone
1000 meter Universal Transverse Mercator grid ticks
zone 13 shown in blue
Fine red dashed lines indicate selected fence lines

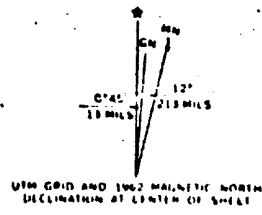

CONTINENTAL OIL CO.
PEARL "B" NO. 4
EXHIBIT "B"

FOR SALE BY U.S. GEOLOGICAL SURVEY, DIT
A FOLDER DESCRIBING TOPOGRAPHIC MAP

RECEIVED

JAN 25 1977

**OIL CONSERVATION COMM.
HOBBS, N. M.**

LC 030417

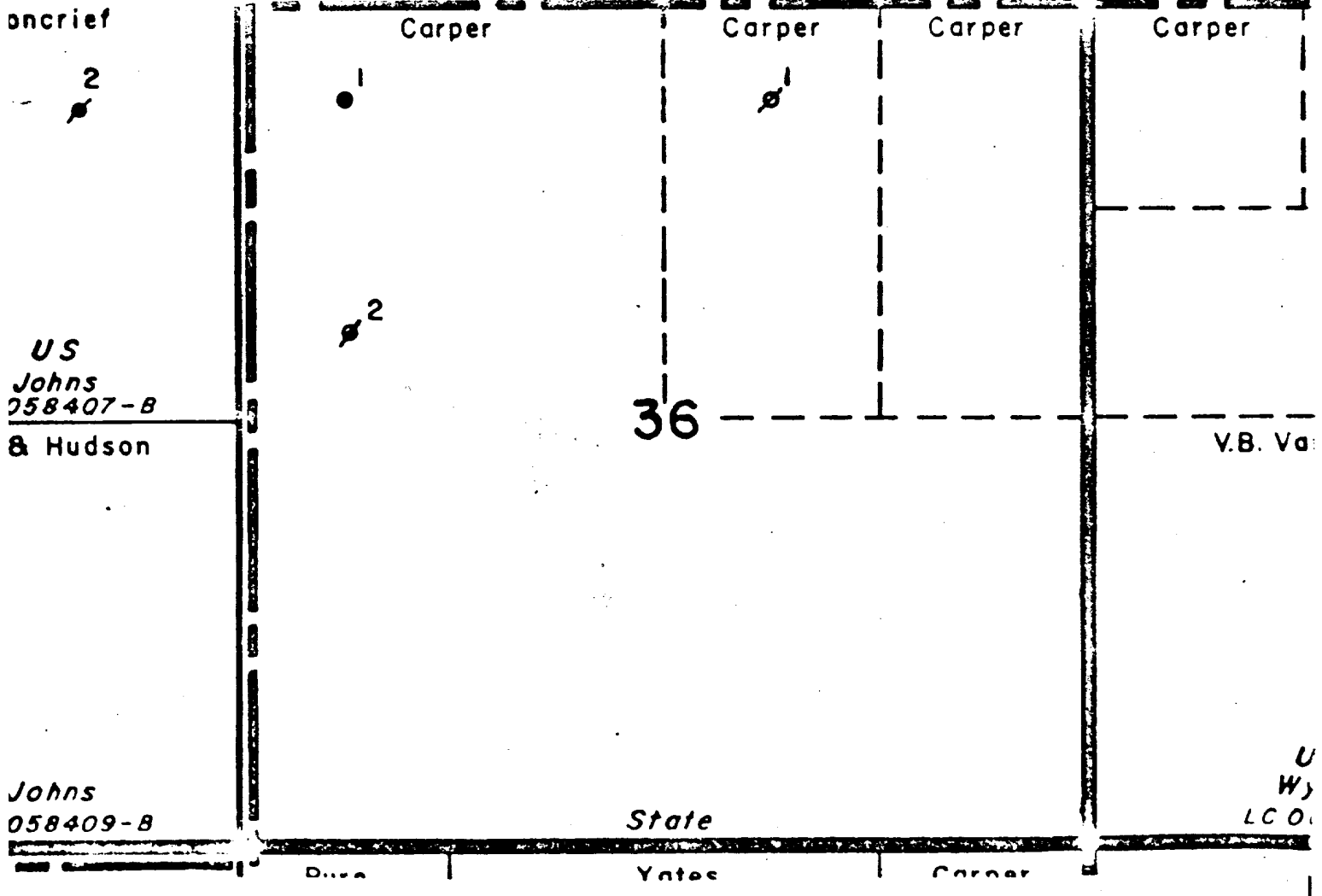
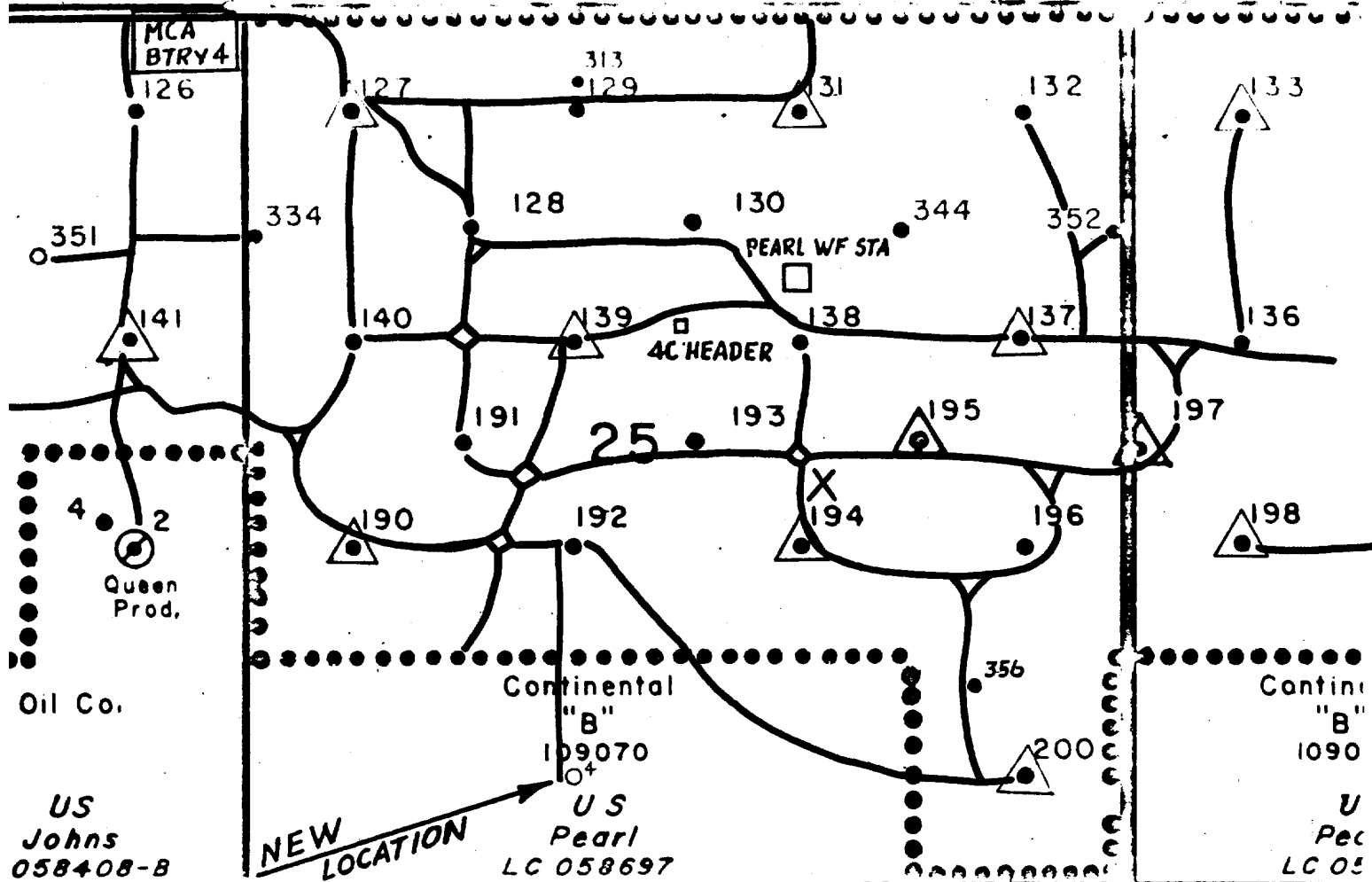

EXHIBIT "C"
 PEARL "B" NO. 4 - ROAD MAP

- SURROUNDING CALICHE ROADS
- PROPOSED NEW ROAD TO LOCATION
- X CALICHE PIT

RECEIVED

JAN 25 1977

OIL CONSERVATION COMM.
HOBBS, N. M.

LC 030417

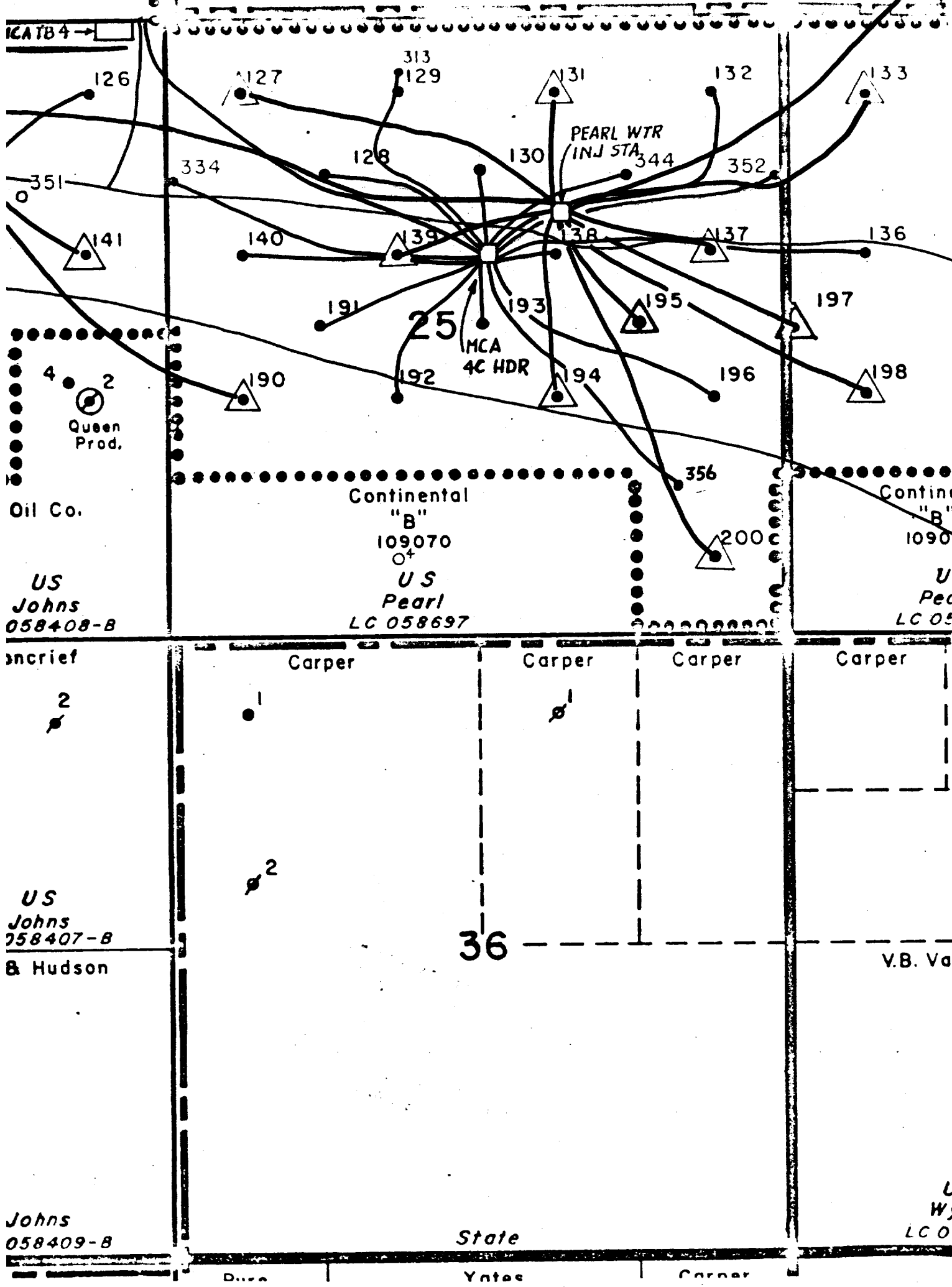

EXHIBIT "D"
PEARL "B" NO. 4 - FLOWLINE MAP

- PRODUCTION FLOWLINE
- INJECTION LINE
- GAS OR LPG LINE
- SALT WTR. TRANSFER (DISPOSAL) LINE

RECEIVED

JAN 23 1977

OIL CONSERVATION COMM.
HOBBS, N. M.

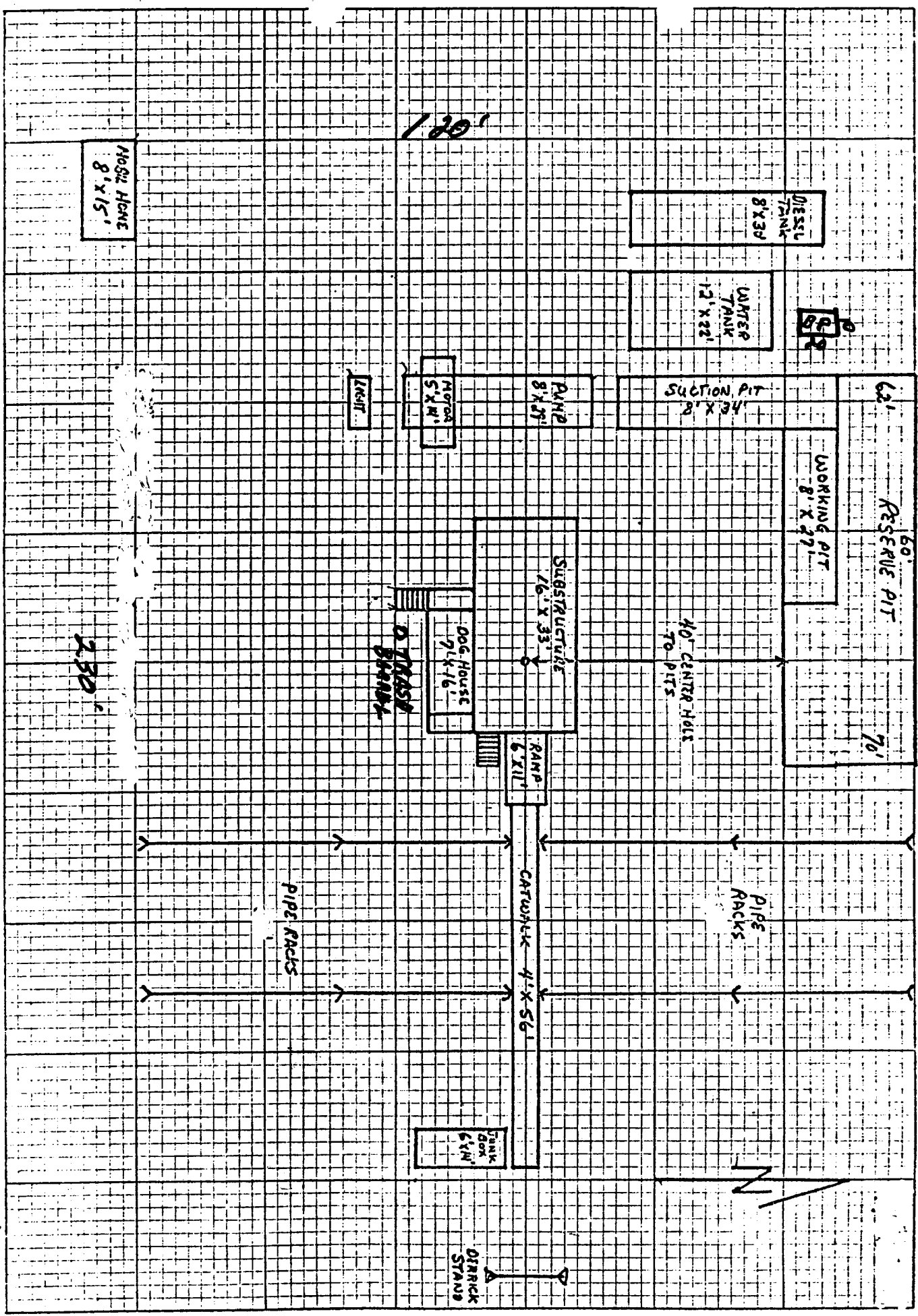

Plan B No. 4
EXHIBIT E

RECEIVED

JAN 25 1977

**OIL CONSERVATION COMM.
HOBBS, N. M.**