

NO. OF COPIES RECEIVED	
DISTRIBUTION	
SANTA FE	
FILE	
U.S.G.S.	
LAND OFFICE	
OPERATOR	

MEXICO OIL CONSERVATION COMMISSION

Form C-101
Revised 1-1-65

5A. Indicate Type of Lease	
STATE <input type="checkbox"/>	FEE <input checked="" type="checkbox"/>
5. State Oil & Gas Lease No.	

APPLICATION FOR PERMIT TO DRILL, DEEPEN, OR PLUG BACK

1a. Type of Work				7. Unit Agreement Name	
b. Type of Well DRILL <input checked="" type="checkbox"/> DEEPEN <input type="checkbox"/> PLUG BACK <input type="checkbox"/>				8. Farm or Lease Name	
OIL WELL <input checked="" type="checkbox"/> GAS WELL <input type="checkbox"/> OTHER <input type="checkbox"/> SINGLE ZONE <input type="checkbox"/> MULTIPLE ZONE <input type="checkbox"/>				Julia Culp	
2. Name of Operator Tenneco Oil Company				9. Well No. 1	
3. Address of Operator 1860 Lincoln St. Suite 1200, Denver, Colorado 80203				10. Field and Pool, or Wildcat North Bagley Penn.	
4. Location of Well UNIT LETTER <u>B</u> LOCATED <u>660</u> FEET FROM THE <u>North</u> LINE AND <u>1980</u> FEET FROM THE <u>East</u> LINE OF SEC. <u>12</u> TWP. <u>12S</u> RGE. <u>32E</u> NMPM				12. County Lea	
19. Proposed Depth <u>+10,500'</u>				19A. Formation Pennsylvanian	
20. Rotary or C.T. Rotary				21. Elevations (Show whether DF, RT, etc.) <u>4,309.4' GL</u>	
21A. Kind & Status Plug. Bond Blanket				21B. Drilling Contractor To be assigned.	
22. Approx. Date Work will start 3/10/77					

PROPOSED CASING AND CEMENT PROGRAM

SIZE OF HOLE	SIZE OF CASING	WEIGHT PER FOOT	SETTING DEPTH	SACKS OF CEMENT	EST. TOP
17-1/2"	13-3/8"	48#	+ 300'	350	Surface
12-1/4"	8-5/8"	32#	+ 4,150'	800	1000'
7-7/8"	5-1/2"	17#	+10,500'	570	7000'

Well to be drilled to approximate T.D. of 10,500', logged, and if commercial production is indicated, run 5-1/2" casing to T.D. and cement as directed. Perforate casing and treat formation with HCL acid as necessary to establish production.
BOP: 3000 PSI W.P. Double Ram and Hydril. To be tested during each 24 hr. period.

Gas production from this well has not yet been contracted.

IN ABOVE SPACE DESCRIBE PROPOSED PROGRAM: IF PROPOSAL IS TO DEEPEN OR PLUG BACK, GIVE DATA ON PRESENT PRODUCTIVE ZONE AND PROPOSED NEW PRODUCTIVE ZONE. GIVE BLOWOUT PREVENTER PROGRAM, IF ANY.

I hereby certify that the information above is true and complete to the best of my knowledge and belief.

Signed D. D. Myers Title Division Production Manager Date 3-2-77

(This space for State Use)

APPROVED BY [Signature] TITLE SUPERVISOR DISTRICT 1 DATE MAR 4 1977

CONDITIONS OF APPROVAL, IF ANY:

**NEW MEXICO OIL CONSERVATION COMMISSION
WELL LOCATION AND ACREAGE DEDICATION PL.**

Form O-102
Supersedes O-128
Effective 1-1-65

All distances must be from the outer boundaries of the Section.

Operator TENNECO OIL COMPANY			Lease Julia Culp		Well No. 1
Unit Letter B	Section 12	Township 12 South	Range 32 East	County Lea	
Actual Footage Location of Well: 660 feet from the north line and 1980 feet from the east line N/2 NE/4					
Ground Level Elev. 4309.4	Producing Formation North Bagley Penn		Pool North Bagley Penn.		Estimated Acreage 80

1. Outline the acreage dedicated to the subject well by colored pencil or hachure marks on the plat below.
2. If more than one lease is dedicated to the well, outline each and identify the ownership thereof (both as to working interest and royalty).
3. If more than one lease of different ownership is dedicated to the well, have the interests of all owners been consolidated by communitization, unitization, force-pooling, etc?

One Lease

☐ Yes ☐ No If answer is "yes," type of consolidation _____

If answer is "no," list the owners and tract descriptions which have actually been consolidated. (Use reverse side of this form if necessary.) _____

No allowable will be assigned to the well until all interests have been consolidated (by communitization, unitization, forced-pooling, or otherwise) or until a non-standard unit, eliminating such interests, has been approved by the Commission.

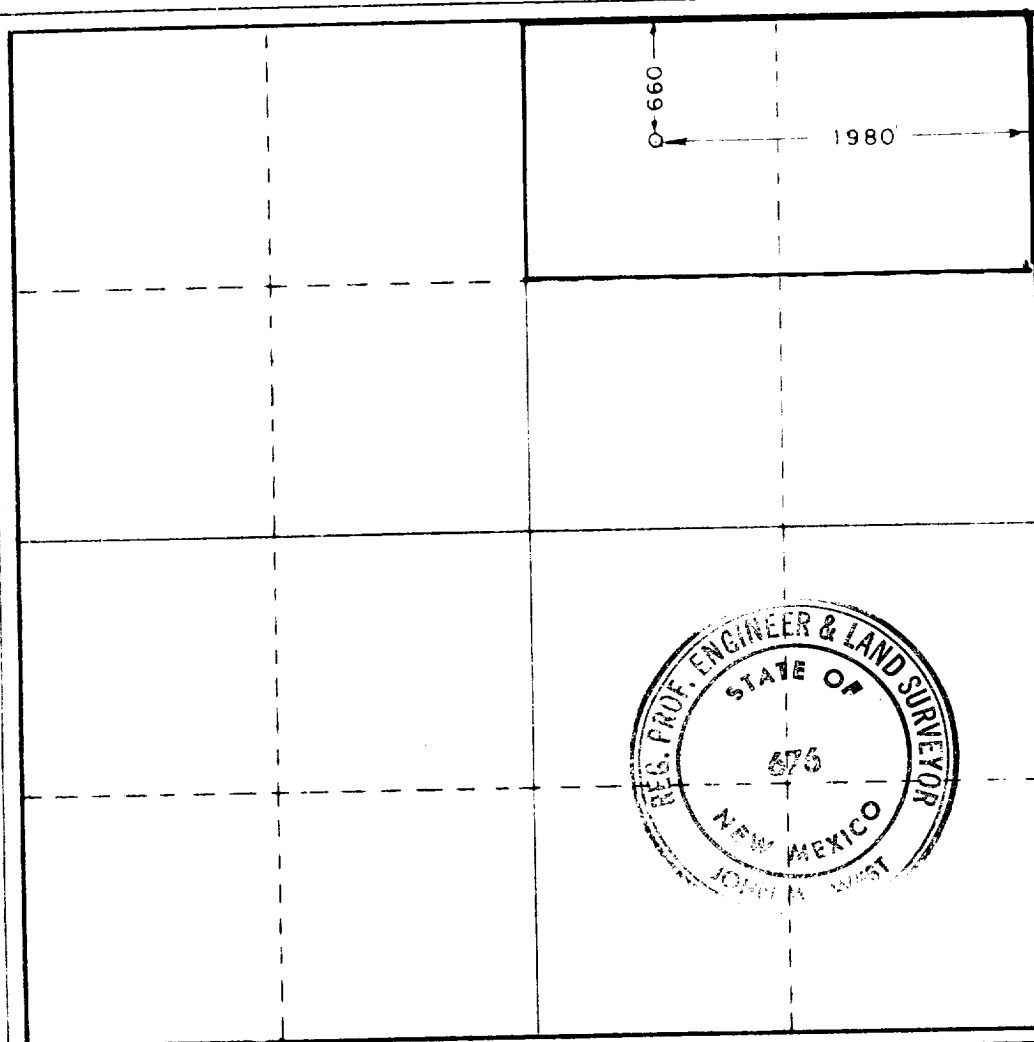

CERTIFICATION

I hereby certify that the information contained herein is true and complete to the best of my knowledge and belief.

Ted F. Drake

Name

Ted F. Drake

Position

Production Analyst

Company

Tenneco Oil Company

Date

March 2, 1977

I hereby certify that the well location shown on this plat was plotted from field notes of actual surveys made by me or under my supervision, and that the same is true and correct to the best of my knowledge and belief.

Date Surveyed

Feb. 26, 1980

Registered Professional Engineer and or Land Surveyor

John A. West

Certificate No.

676

0 330 660 990 1320 1650 1980 2310 2640 2000 1500 1000 500