

UNITED STATES
DEPARTMENT OF THE INTERIOR
GEOLOGICAL SURVEY

APPLICATION FOR PERMIT TO DRILL, DEEPEN, OR PLUG BACK

1a. TYPE OF WORK

DRILL ☒DEEPEN ☐PLUG BACK ☐

b. TYPE OF WELL

OIL
WELL ☒GAS
WELL ☐OTHER ☐SINGLE
ZONE ☒MULTIPLE
ZONE ☐

2. NAME OF OPERATOR

AMOCO PRODUCTION COMPANY

3. ADDRESS OF OPERATOR

P.O. DRAWER A, LEVELLAND, TEXAS 79336

4. LOCATION OF WELL (Report location clearly and in accordance with any State requirements.)*

At surface

1940' FNL * 804' FEL SEC 22 (SE 1/4, NE 1/4, UNIT 18) NEW MEXICO

At proposed prod. zone

14. DISTANCE IN MILES AND DIRECTION FROM NEAREST TOWN OR POST OFFICE*

15 MILES SOUTH OF EUNICE, NM

15. DISTANCE FROM PROPOSED*

LOCATION TO NEAREST
PROPERTY OR LEASE LINE, FT.
(Also to nearest drlg. unit line, if any)

804

18. DISTANCE FROM PROPOSED LOCATION*
TO NEAREST WELL, DRILLING, COMPLETED,
OR APPLIED FOR, ON THIS LEASE, FT.

1026

16. NO. OF ACRES IN LEASE

19. PROPOSED DEPTH

5800

17. NO. OF ACRES ASSIGNED
TO THIS WELL

80

20. ROTARY OR CABLE TOOLS

ROTARY

21. ELEVATIONS (Show whether DF, RT, GR, etc.)

3230.7 GR

22. APPROX. DATE WORK WILL START*

ASAP

23.

PROPOSED CASING AND CEMENTING PROGRAM

SIZE OF HOLE	SIZE OF CASING	WEIGHT PER FOOT	SETTING DEPTH	QUANTITY OF CEMENT
11"-12 1/4"	8 5/8"	24#	1000	CIRCULATE
7 7/8"	5 1/2"	14-15.5#	5745	CIRCULATE

After reaching TD, run logs and evaluate. Perforate and stimulate as necessary to attempt commercial production.

MUD PROGRAM: O-SCP - NATIVE MUD

SCP - TD - BRINE WITH MINIMUM PROPERTIES
TO MAINTAIN GOOD HOLE CONDITIONS,

BOP Program previously submitted.

(TO SHARE PRORATION UNIT WITH WELL NO. 18)

(* Revised form to reflect movement of location 6' EAST)

IN ABOVE SPACE DESCRIBE PROPOSED PROGRAM: If proposal is to deepen or plug back, give data on present productive zone and proposed new productive zone. If proposal is to drill or deepen directionally, give pertinent data on subsurface locations and measured and true vertical depths. Give blowout preventer program, if any.

24.

SIGNED Kenneth BrandTITLE Senior Staff AssistantDATE 8-1-77

(This space for Federal or State office use)

PERMIT NO. _____

APPROVAL DATE _____

APPROVED BY _____

CONDITIONS OF APPROVAL, IF ANY: _____

TITLE _____

044-USGS, ART 1-TENNECO
1-DIV 1-ARCO
1-KWB
1-COCONO
1-CHEVRON

*See Instructions On Reverse Side

APPROVED
AS AMENDED
AUG 2 1977
BERNARD MOROZ
ACTING DISTRICT ENGINEER

RECEIVED

AUG 9 1977

OIL CONSERVATION COMM.
HOBBS, N. M.

NEW MEXICO OIL CONSERVATION COMMISSION
WELL LOCATION AND ACREAGE DEDICATION PLAT

Form C-102
Supersedes C-128
Effective 1-1-65

All distances must be from the outer boundaries of the Section

Operator Amoco Production Co.		Lease South Mattix Unit		Well No. 29
Unit Letter H	Section 22	Township 24 South	Range 37 East	County Lea

Actual Well Location of Wells:

1940	feet from the	North	line and	804	feet from the	East	line
Ground Level Elev 3230.7	Producing Formation UPPER YESO		Foot FOWLER UPPER YESO		Dedicated Acreage 80		Acres

- Outline the acreage dedicated to the subject well by colored pencil or hatchure marks on the plat below.
- If more than one lease is dedicated to the well, outline each and identify the ownership thereof (both as to working interest and royalty).
- If more than one lease of different ownership is dedicated to the well, have the interests of all owners been consolidated by communitization, unitization, force-pooling, etc?

☒ Yes ☐ No If answer is "yes" type of consolidation **UNITIZED**

If answer is "no," list the owners and tract descriptions which have actually been consolidated. (Use reverse side of this form if necessary.)

No allowable will be assigned to the well until all interests have been consolidated (by communitization, unitization, forced-pooling, or otherwise) or until a non-standard unit, eliminating such interests, has been approved by the Commission.

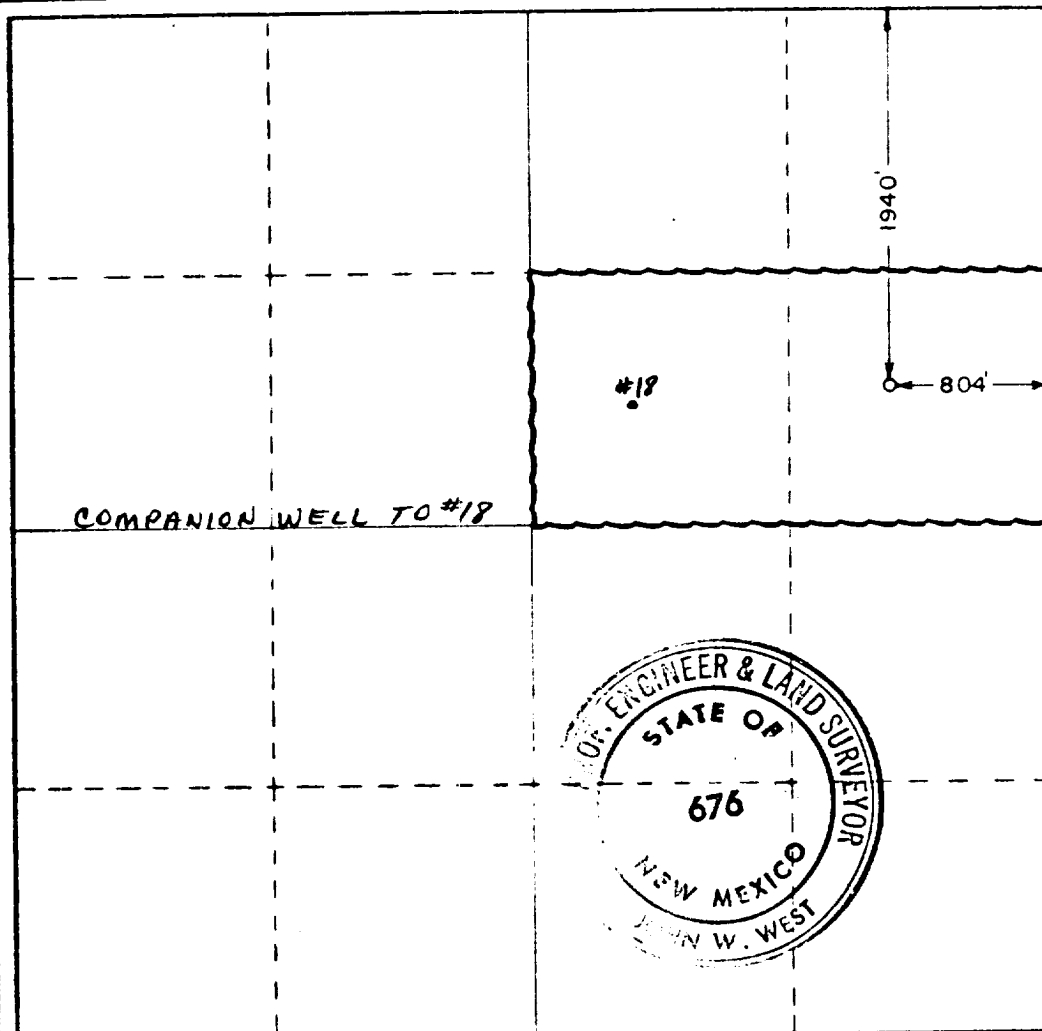

CERTIFICATION

I hereby certify that the information contained herein is true and complete to the best of my knowledge and belief.

Name
Kenneth Brand
Position
Senior Staff Assistant
Company
Amoco Production Company
Date
8-1-77

I hereby certify that the well location shown on this plat was plotted from field notes of actual surveys made by me or under my supervision and that the same is true and correct to the best of my knowledge and belief.

Date Surveyed
July 29, 1977

Registered Professional Engineer and/or Land Surveyor

Registration No.
676

0 330 660 990 1320 1650 1980 2310 2640 2970 3300 3630 3960 4290 4620 4950 5280 5610 5940 6270 6600

RECEIVED

AUG 4 1977

OIL CONSERVATION COMM.
HOBBS, N. M.