

UNITED STATES
DEPARTMENT OF THE INTERIOR
BUREAU OF LAND MANAGEMENT

N.M. Oil Cons. Division
1625 N. French Dr.
Hobbs, NM 88240

FORM APPROVED
Budget Bureau No. 1004-0135
Expires: March 31, 1993

SUNDRY NOTICES AND REPORTS ON WELLS

Do not use this form for proposals to drill or to deepen or reentry to a different reservoir.
Use "APPLICATION FOR PERMIT-" for such proposals

SUBMIT IN TRIPLICATE

1. Type of Well <input type="checkbox"/> Oil Well <input checked="" type="checkbox"/> Gas Well <input type="checkbox"/> Other	6. If Indian, Allottee or Tribe Name
2. Name of Operator Doyle Hartman	7. If Unit or CA, Agreement Designation
3. Address and Telephone No. 500 N. Main St., Midland, Texas 79701 (915) 684-4011	8. Well Name and No. Courtland Myers "B" Federal No. 2
4. Location of Well (Footage, Sec., T., R., M., or Survey Description) 660' FNL & 810' FWL (D) Section 15, T-24-S, R-37-E, NMPM	9. API Well No. 30-025-25745
	10. Field and Pool, or Exploratory Area Langlie Mattix
	11. County or Parish, State Lea Co., NM

12. CHECK APPROPRIATE BOX(s) TO INDICATE NATURE OF NOTICE, REPORT, OR OTHER DATA

TYPE OF SUBMISSION	TYPE OF ACTION
<input checked="" type="checkbox"/> Notice of Intent	<input checked="" type="checkbox"/> Abandonment
<input type="checkbox"/> Subsequent Report	<input type="checkbox"/> Recompletion
<input type="checkbox"/> Final Abandonment Notice	<input type="checkbox"/> Plugging Back
	<input type="checkbox"/> Casing Repair
	<input type="checkbox"/> Altering Casing
	<input type="checkbox"/> Other
	<input type="checkbox"/> Change of Plans
	<input type="checkbox"/> New Construction
	<input type="checkbox"/> Non-Routine Fracturing
	<input type="checkbox"/> Water Shut-Off
	<input type="checkbox"/> Conversion to Injection
	<input type="checkbox"/> Dispose Water

(Note: Report results of multiple completion on Well Completion or Recompletion Report and Log form.)

13. Describe Proposed or Completed Operations (Clearly state all pertinent details, and give pertinent dates, including estimated date of starting any proposed work. If well is directionally drilled, give subsurface locations and measured and true vertical depths for all markers and zones pertinent to this work.)

On 12-11-99, the 2 3/8" O.D. tubing string, in the Courtland Myers "B" Federal No. 2 well, was inadvertently cemented in the wellbore, from 618' to 3340', while repairing the defective primary cement job, in lower part of Courtland Myers "B" Federal No. 2 wellbore (copy of 1999 Well Work Report herein enclosed).

We now propose to rig up well service unit, and finish plugging the Courtland Myers "B" Federal No. 2 well, by filling 7" O.D. casing, with cement, from 0' to 618'. Top of cement is presently at 618', inside of 7" O.D. casing. When well was initially drilled, in December, 1977, cement was circulated back to surface, on outside of 7" O.D. casing.

After setting a 618' top cement plug, from 0' to 618', a dryhole marker will be installed, and the surface will be cleaned and restored, as specified by BLM regulations.

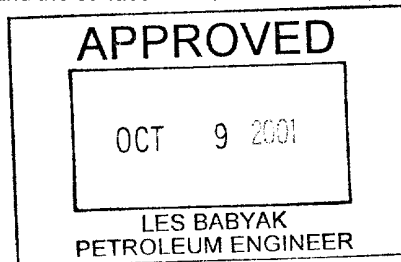

14. I hereby certify that the foregoing is true and correct

Signed [Signature]

Title Engineer

Date 10/09/01

(This space for Federal or State office use)

Approved by _____
Conditions of approval, if any:

Title _____

Date _____

Title 18 U.S.C. Section 1001, makes it a crime for any person knowingly and willfully to make to any department or agency of the United States any false, fictitious or fraudulent statements or representations as to any matter within its jurisdiction.

*See Instruction on Reverse Side

Doyle Hartman
Courtland Myers "B" No. 2
660' FNL and 810' FWL (D)
Section 15, T-24-S, R-37-E
Lea County, New Mexico
Langlie Mattix Pool
GL = 3256.5'
KB = 3270.0'
Type Lease: Federal
Lease No.: LC-032450B

Operator OGRID No.: 6473
Property No.: 19387
Pool Code: 37240
API No.: 30-025-25745
P.U. Description: NW/4 NW/4 Section 15, T-24-S, R-37-E (40 acres)

WELL WORK REPORT

11-26-99

Rate = 129 MCFPD
 1 BWPD
 PCP = 8.7 psig
 LP = 8.3 psig

Shut well in and performed the following pressure buildup:

Date	Time (CST)	Elapsed Time (hrs)	TP (psig)	CP (psig)	LP (psig)	Remarks
11-26-99	12:35 PM	0		8.7		Shut in casing.
11-26-99	12:36 PM	0.017		10.6		
11-26-99	12:37 PM	0.033		11.0		
11-26-99	12:38 PM	0.050		11.3		
11-26-99	12:39 PM	0.067		12.0		
11-26-99	12:40 PM	0.083		12.8		
11-26-99	12:45 PM	0.167		14.7		
11-26-99	12:50 PM	0.250		15.9		
11-26-99	12:55 PM	0.333		16.4		
11-26-99	1:00 PM	0.417		17.9		
11-26-99	1:15 PM	0.667		18.9		
11-26-99	1:30 PM	0.917		19.1		
11-26-99	2:00 PM	1.417		20.0		
11-26-99	2:30 PM	1.917		20.4		
11-26-99	3:00 PM	2.417		20.8		
11-26-99	3:30 PM	2.917		21.3		
11-26-99	4:00 PM	3.417		21.8		
11-26-99	4:30 PM	3.917		22.2		

Courtland-Myers "B" No. 2 -- WELL WORK REPORT
Page 2

<u>Date</u>	<u>Time (CST)</u>	<u>Elapsed Time (hrs)</u>	<u>TP (psig)</u>	<u>CP (psig)</u>	<u>LP (psig)</u>	<u>Remarks</u>
11-26-99	5:00 PM	4.417		22.5		
11-26-99	5:30 PM	4.917		22.8		
11-26-99	6:00 PM	5.417		23.3		
11-26-99	7:00 PM	6.417		24.0		
11-26-99	8:00 PM	7.417		24.0		
11-26-99	9:00 PM	8.417		24.5		
11-26-99	10:00 PM	9.417		24.5		
11-26-99	11:00 PM	10.417		24.5		
11-27-99	12:00 AM	11.417		25.0		
11-27-99	1:00 AM	12.417		25.5		
11-27-99	2:00 AM	13.417		25.5		
11-27-99	3:00 AM	14.417		26.0		
11-27-99	4:00 AM	15.417		26.0		
11-27-99	5:00 AM	16.417		26.5		
11-27-99	6:00 AM	17.417		27.0		
11-27-99	7:00 AM	18.417		27.5		
11-27-99	7:30 AM	18.917		28.0		
11-27-99	8:00 AM	19.417		28.1		
11-27-99	10:00 AM	21.417		29.0		
11-27-99	12:00 AM	23.417		29.0		
11-27-99	2:00 AM	25.417		29.5		
11-27-99	4:00 AM	27.417		29.5		
11-27-99	6:00 AM	29.417		30.0		
11-27-99	8:00 AM	31.417		30.0		
11-27-99	10:00 AM	33.417		30.5		
11-28-99	12:00 PM	35.417		30.5		
11-28-99	2:00 AM	37.417		31.0		
11-28-99	4:00 AM	39.417		31.0		
11-28-99	6:00 AM	41.417		31.5		
11-28-99	7:30 AM	42.917		31.5		
11-28-99	8:00 AM	43.417		31.5		
11-28-99	10:00 AM	45.417		32.0		
11-28-99	12:00 PM	47.417		32.0		
11-28-99	2:00 PM	49.417		32.5		
11-28-99	4:00 PM	51.417		32.5		
11-28-99	6:00 PM	53.417		32.5		

Courtland-Myers "B" No. 2 -- WELL WORK REPORT

Page 3

Date	Time (CST)	Elapsed Time (hrs)	TP (psig)	CP (psig)	LP (psig)	Remarks
11-28-99	8:00 PM	55.417		33.0		
11-28-99	10:00 PM	57.417		33.0		
11-29-99	12:00 AM	59.417		33.0		
11-29-99	2:00 AM	61.417		33.0		
11-29-99	4:00 AM	63.417		33.0		
11-29-99	6:00 AM	65.417		33.0		
11-29-99	12:00 PM	71.417		33.0		
11-29-99	9:00 PM	80.417		33.0		

12-08-99

Rigged up well service unit. Pulled rods, pump and tubing. Ran 6-1/4" bit and 7" casing scraper. Found PBTD at 3547' (6' of fill since 11-12-96). Cleaned out fill.

Rigged up Schlumberger. Loaded lower part of hole, with 60 bbls of 2% KCl water. Did not significantly raise fluid level. Logged well with CNL-DAS-GR-CCL log and USI-GR-CCL log. Found fluid level at 3190', while running CNL-DAS-GR-CCL log, and fluid level at 3250', while running USI-GR-CCL bond log.

12-09-99

Ran bottom-hole assembly consisting of 6-1/4" bit and (4) 4-3/4" drill collars. Drilled out float collar and cement, to 3590'.

Ran Baker 7" Model "C" packer. Set packer at 3330'. Pressure tested 7" casing, from 3330' to 3590', to 3600 psi. Pressure held okay.

Rigged up Capitan Corporation. Shot (8) 0.38" squeeze holes, with one shot each at:

3380'	3439'
3421'	3445'
3425'	3451'
3431'	
3435'	

Ran Baker 7" Model "C" packer. Set packer at 3370'. Shut in well for night. After being shut in overnight, SITP = 146 psig.

12-10-99

Pulled Baker 7" Model "C" packer. Ran 7" Model "C" RBP and 7" Model "C" packer. Set Model "C" RBP at 3435'. Spotted 170 gal of 15% MCA acid across and above squeeze perforations. Set packer at 3401'. Acidized squeeze holes, from 3421'-3431' (3 holes), with an additional 400 gal (total of 570 gal) of 15% MCA acid, at an average rate of 4 BPM. Flushed with 14 bbls of 2% KCl water.

$TP_{MX} = 1800 \text{ psi}$
 $TP_{mn} = 1100 \text{ psi}$
 $TP_{avg} = 1200 \text{ psi}$

Courtland-Myers "B" No. 2 -- WELL WORK REPORT**Page 4**

Raised RBP to 3401'. Set packer at 3370'. Acidized remaining squeeze perforation, at 3380', with 130 gal of 15% MCA, at 0.6 BPM. While flushing acid, pressure broke, from 450 psi to 0 psi.

Pulled RBP and packer. Ran 2-3/8" tubing to 3400'. Hooked up foam circulating unit. Unloaded fluid, above 3400'. Maximum pump pressure, to establish circulation, was 700 psi. Final pump pressure was 300 psi.

Lowered tubing to 3590'. Attempted to unload remaining fluid from hole. With a pump pressure of 1100 psi, could not circulate with air. Pulled tubing. Found mud anchor plugged with iron sulfide.

Ran into hole with Baker 7" Model "C" RBP and 7" Model "C" packer. Set RBP at 3480' and packer at 3370'. Observed the following overnight pressure buildup:

Date	Time (CST)	Elapsed Time (hrs)	TP (psig)	CP (psig)	LP (psig)	Remarks
12-10-99	7:05 PM	0	0	0		
12-10-99	7:10 PM		0	7.0		
12-10-99	7:20 PM		0.5	13.0		
12-10-99	7:25 PM		0.5	14.5.0		
12-10-99	7:30 PM		0.5	15.5		
12-10-99	7:35 PM		0.5	16.5		
12-10-99	7:40 PM		0.5	18.0		
12-10-99	7:45 PM		0.5	19.5		
12-10-99	7:50 PM		1.0	21.5		
12-10-99	8:00 PM		1.0	25.5		
12-10-99	9:00 PM		2.5	29.5		
12-10-99	10:00 PM		5.0	31.0		
12-10-99	11:00 PM		6.0	31.5		
12-11-99	12:00 AM		7.5	32.0		
12-11-99	1:00 AM		10.0	32.0		
12-11-99	2:00 AM		12.5	32.0		
12-11-99	3:00 AM		15.0	32.0		
12-11-99	4:00 AM		18.5	33.0		
12-11-99	5:00 AM		20.0	33.0		
12-11-99	6:00 AM		22.0	33.0		
12-11-99	7:00 AM		23.5	33.0		
12-11-99	7:45 AM		25.0	33.0		

12-11-99

Installed lubricator. Made four swab runs. Observed the following fluid recovery:

Courtland-Myers "B" No. 2 -- WELL WORK REPORT
Page 5

Run No.	Fluid Recovery (ft)	Fluid Description
1	200	Black Sulfur Water
2	80	Black Sulfur Water
3	200	Black Sulfur Water
4	150	Black Sulfur Water

Shot Fluid level. Top of fluid, in annulus, at 3176'.

Lowered packer below squeeze perfs. Spotted 100 gal of 15% MCA across and above squeeze perfs. Raised and set packer at 3430'. Acidized squeeze perfs, from 3431'-3451' (4 holes), with an additional 200 gal of 15% MCA acid, at 1.3 BPM, at 450 psi. Flushed with 14 bbls of water.

Raised packer to 3330'. Performed injectivity test into all 8 squeeze holes, at rate of 5.5 BPM, at 550 psi. Pumped 28 bbls, of water, before catching pressure.

Lowered packer to 3401'. Performed injectivity test, into bottom 7 squeeze perforations (3421'-3451'), at a rate of 5.5 BPM, at 580 psi.

Pulled packer and RBP. Ran 2 3/8" O.D. tubing and Halliburton 7" EZ-Drill Type SV cement retainer. Set retainer at 3340'. Rigged up BJ Hughes, to repair defective cement. Cemented all squeeze perfs, from 3380'-3451' (8 holes), with 600 sx of API Class-C cement containing 2% CaCl₂:

Pump Rate (BPM)	Pump Pressure (psi)	Sacks Mixed	Slurry or Flush Pumped	Remarks
5	1100			
5	135		22	
4.1	200		27	
4.1	236		50	
3	104		53	
3.3	104		75	
3.3	160		85	
3.3	465		95	
3	500		100	
2	90		110	
2	102		120	
2	250		130	
2	350		135	
2	400		137	
0			137	Shut down 6 min to wash lines.
1	1300		1	

Courtland-Myers "B" No. 2 -- WELL WORK REPORT

Page 6

1	732		1.5	
Pump Rate (BPM)	Pump Pressure (psi)	Sacks <u>Mixed</u>	Slurry or Flush <u>Pumped</u>	<u>Remarks</u>
1	634		2	
0.5	851		3	
0.5	990		4	
0.8	1144		5	
0.8	1380		8.5	
0.8	1440		10	
0.8	1540		12.7	
ISIP =	1400			

Pulled out of retainer, and pulled one joint of 2 3/8" O.D. tubing, but could not pull any further, due to cement communication, into 7" x 2 3/8" annulus, above 7" EZ-Drill retainer, at 3340'. At 6:30 P.M., 12-11-99, measured 16" of tubing stretch, by pulling 20,000 lbs over tubing weight.

12-13-99

Rigged up Baker Atlas. Ran free-point tool. Found tubing free, at 618' (top of cement inside of 7" O.D. casing, at 618'). Ran chemical cutter. Cut 2 3/8" O.D. tubing, at 618'. Pulled free 2 3/8" O.D. tubing.

Rigged down Baker Atlas.

Rigged down and moved off well service unit.

Note: 7" O.D. casing full of cement (below 618').

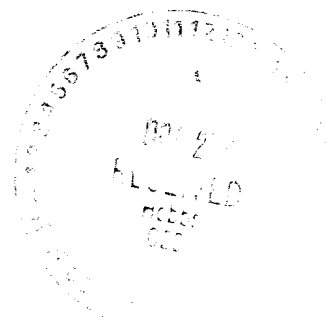

CAPITAN CORPORATION
P.O. BOX 69292 (915) 385-1808
ODESSA, TX 79769

Invoice

DATE	INVOICE NO.
12/10/99	3162

BILL TO
Doyle Hartman 500 N. Main Midland, Texas 79701

Ship To
Courtland Meyers B #2 Lea county, New Mexico

P.O. No	Terms	Due Date	Engin...	Service ...	Field Inv. #	Ordered By																				
	net 30 days	01/09/'00	ED	12/09/99	3235	D. Hartman																				
Services Performed						AMOUNT																				
Jet Perforating Service Perforated 7" casing with 3 1/8" select fire guns 1spf from 3382 - 3451. Total - 8 holes DOYLE HARTMAN, OIL OPERATOR <table border="1"><tr><td>Unit/Well No.</td><td>8052</td><td></td><td></td></tr><tr><td>Vendor No</td><td>27346</td><td></td><td></td></tr><tr><td>Account No.</td><td></td><td></td><td></td></tr><tr><td>Amount</td><td></td><td></td><td></td></tr><tr><td>Approved By</td><td></td><td></td><td></td></tr></table> ENTERED DEC 16 1999 Total Job Price						Unit/Well No.	8052			Vendor No	27346			Account No.				Amount				Approved By				1,430.00
Unit/Well No.	8052																									
Vendor No	27346																									
Account No.																										
Amount																										
Approved By																										
THANK YOU Billy						Total \$1,430.00																				

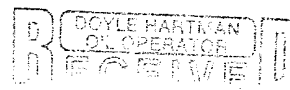





Original

BJ Services Company

REMIT TO: P.O. BOX 843710
DALLAS, TX 75284-3710

Hartman Doyle
P. O. Box 10426
Midland Texas 79702

INVOICE NO. 828487	OUR RECEIPT NO. 175410418	DATE 12/11/1999
CUSTOMER NO. 20038838	COST CENTER 1014	YOUR ORDER NO.

SERVICES FROM OUR STATION AT Hobbs Operations	BJ SERVICES SUPERVISOR Jerry Meyer	SIGNED FOR YOU BY Don Mashburn
FOR SERVICE WELL NAME Courtland Myers "B" #2	COUNTY/PARISH Lea	STATE New Mexico

PRODUCT CODE	DESCRIPTION	UNIT OF MEASURE	QUANTITY	LIST PRICE UNIT	GROSS AMOUNT	PERCENT DISC.	NET AMOUNT
100020	Class C Cement	sacks	600	11.240	6,744.00	38%	4,181.28**
100091	Ferrotrol-300L	gals	2	19.000	38.00	38%	23.56**
100112	Calcium Chloride	lbs	1128	0.530	597.84	38%	370.66**
100138	LT-21	gals	1	31.000	31.00	38%	19.22**
100472	NE-940	gals	1	45.450	45.45	38%	28.18**
398004	HCl, 10.1 - 15%	gals	300	1.690	507.00	38%	314.34**
488019	FP-6L	gals	3	50.000	150.00	38%	93.00**
488220	CI-27	gals	1	58.300	58.30	38%	36.15**
499680	Static Free	lbs	3	17.500	52.50	38%	32.55**
M100	Bulk Materials Service Charge	cu ft	622	1.700	1,057.40	38%	655.59**
F058	Cement Pump Tubing, 3001 - 3500 ft	6hrs	1	1,960.000	1,960.00	38%	1,215.20**
J225	Data Acquisition, Cement, Standard	job	1	710.000	710.00	38%	440.20**
J390	Mileage, Heavy Vehicle	miles	176	3.800	668.80	38%	414.66**
J391	Mileage, Auto, Pick-Up or Treating Van	miles	88	2.300	202.40	38%	125.49**
J401	Bulk Delivery, Dry Products	ton-mi	1266	1.270	1,607.82	38%	996.85**
SUB TOTAL					14,430.51		8,946.93

New Mexico State Sales Tax 5%
Lea County Sales Tax .25%

DOYLE HARTMAN, OIL OPERATOR

Unit/Well No.	8052
Vendor No.	4756
Account No.	5500
Amount	
Amount Paid	

DEC 15 1999

PHONE: (713) 462-4239

TERMS: NET 30 DAYS

PAY THIS AMOUNT

USD

9,416.65



CEMENT JOB REPORT

CUSTOMER Hartman Doyle		DATE 11-DEC-99	F.R. # 175410418		SERV. SUPV. Jerry Meyer						
LEASE & WELL NAME Courtland Myers "B" #2 - API 30025257450000		LOCATION Sec. 15, T24S, R37E		COUNTY-PARISH-BLOCK Lea New Mexico							
DISTRICT Hobbs		DRILLING CONTRACTOR RIG # Pool		TYPE OF JOB Squeeze-Perforation							
SIZE & TYPE OF PLUGS		LIST-CSG-HARDWARE		PHYSICAL SLURRY PROPERTIES							
				SLURRY WGT PPG	SLURRY YLD FT ³	WATER GPS	PUMP TIME HR:MIN	Bbl SLURRY	Bbl MIX WATER		
MATERIALS FURNISHED BY BJ											
15% Hcl Acid											
Fresh Water											
Fresh water											
600 SX"C"+2%CaCl2											
Fresh water											
Available Mix Water 260 Bbl. Available Displ. Fluid 140 Bbl.											
TOTAL											
230.8 90.21											
HOLE		TBG-CSG-D.P.				COLLAR DEPTHS					
SIZE	% EXCESS	DEPTH	SIZE	WGT.	TYPE	DEPTH	GRADE	SHOE	FLOAT	STAGE	
			2.375	4.7	TBG	3330	J-55				
LAST CASING		PKR-CMT RET-BR PL-LINER		PERF. DEPTH		TOP CONN		WELL FLUID			
SIZE	WGT	TYPE	DEPTH	BRAND & TYPE	DEPTH	TOP	BTM	SIZE	THREAD	TYPE	WGT.
7	20	CSG	6000	Ball Check Cement Retainer,	3330			2.375	EUE	FRESH WATER	8.34
DISPL. VOLUME		DISPL. FLUID		CAL. PSI	CAL. MAX PSI	OP. MAX	MAX TBG PSI		MAX CSG PSI		MIX WATER SOURCE
VOLUME	UOM	TYPE	WGT.	BUMP PLUG	TO REV.	SQ. PSI	RATED	Operator	RATED	Operator	
	BBLS	Fresh water	8.3			2500	7770	6216	3740	2992	truck
EXPLANATION: TROUBLE SETTING TOOL, RUNNING CSG, ETC. PRIOR TO CEMENTING:											
PRESSURE/RATE DETAIL						EXPLANATION					
TIME HR:MIN.	PRESSURE - PSI		RATE BPM	Bbl. FLUID PUMPED	FLUID TYPE	SAFETY MEETING: BJ CREW <input checked="" type="checkbox"/> CO. REP. <input type="checkbox"/>					
	PIPE	ANNULUS				TEST LINES 3500 PSI					
						CIRCULATING WELL - RIG <input type="checkbox"/> BJ <input checked="" type="checkbox"/>					
11:51	0		1.2	2.5	ACID	START ACID SPOT					
11:53	0		1.2	.5	H2O	START FLUSH					
11:53	0					SHUT DOWN					
12:03	50		3	5	ACID	START ACID					
12:05	50		3	10	H2O	START FLUSH					
12:08	445		1.3	4	H2O	CAUGHT PRESSURE SLOWED RATE					
12:11	0					SHUT DOWN					
12:25	530		5.4	28	H2O	START INJECTION RATE					
12:33	0					SHUT DOWN					
13:22	580		5.5	27	H2O	START PUMPING					
13:27	0					SHUT DOWN					
15:46	0		2.4	15	H2O	START PUMPING TUBING VOLUME					
15:51	0					SHUT DOWN SET TOOL					
16:03	73		5.5	15	H2O	START FRESH WATER					
16:15	200		4	54	CEMENT	START CEMENT SLURRY					
16:27	190		3	48	CEMENT	SLOWED RATE					
16:47	120		2	40	CEMENT	SLOWED RATE					
17:00	0					SHUT DOWN WASH PUMP AND LINES					
17:05	1380		.9	1.5	H2O	START DISPLACEMENT					
	757		.6	3.5	H2O	SLOWED RATE					
	1163		.8	7.7	H2O	INCREASE RATE					
17:24	1400					SHUT DOWN STRING OUT OF TOOL					

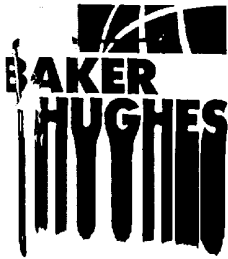

BAKER ATLAS

P.O. Box 540069
Grand Prairie, TX 75054-0069
For Inquiries Please Call:

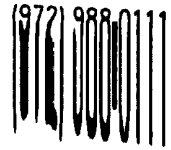

FAX (972) 660-5160

REMIT TO: P.O. Box 201918 HOUSTON, TX 77216-1918

INVOICE NO.

2499124916 RI

Work Performed : 12-13-99

SOLD TO DOYLE HARTMAN OIL OPERATORS
PO BOX 10426
MIDLAND TX 79702

WELL: COURTLAND MEYERS B #2
COUNTY: LEA, NEW MEXICO
CUSTOMER REP: MASHBURN

CUSTOMER NUMBER	CONTRACT NUMBER	CUSTOMER PURCHASE ORDER NUMBER	SALES REP.	ORDER DATE	FIELD RECEIPT NO:	INVOICE DATE
316600					287821 SL	12/20/99

TERMS

SHIPPED VIA

SPECIAL INFORMATION

Net 30 Days

QUANTITY ORDERED	ITEM	DESCRIPTION	UNIT PRICE	EXTENDED	AMOUNT
1.00	SCPR	SERVICE CHARGE - PIPE RECOVERY	1,500.0000 Per EA	1,500.00	1,500.00
1.00	ENVP	ENVIRONMENTAL PROTECTION CHARGE	75.0000 Per EA	75.00	75.00
1.00	WCE101	PRESSURE CONTROL CHARGES 0-1000 PSI	500.0000 Per EA	500.00	500.00
6000.00	FP1S01	FREEPOINT INDICATOR TUBING DEPTH CHARGE	.2400 Per FT	1,440.00	1,440.00
1.00	FP1S03	FREEPOINT INDICATOR TUBING OPERATIONS CHARGE	1,000.0000 Per EA	1,000.00	1,000.00
6000.00	CCSD01	CHEMICAL CUTTER DEPTH CHARGE, PER FT.	.2800 Per FT	1,680.00	1,680.00
1.00	CCSD03	CHEMICAL CUTTER OPERATIONS CHARGE	1,000.0000 Per EA	1,000.00	1,000.00
1.00	DISC	DISCOUNT PRICE EXCEPTION	4,317.0000- Per EA	4,317.00-	4,317.00-
1.00	TXNM	TAX - NEW MEXICO 6%	172.6800 Per EA	172.68	172.68
DOYLE HARTMAN, OIL OPERATOR					
Unit/Well No.		8052			
Vendor No.		5191			
Account No.		5500			
Amount					
Approved By					

ENTERED

DEC 23 1999

DEC 23 1999

PAYMENT IS MADE
IN TERMS:

PLEASE REFERENCE INVOICE NUMBER ON YOUR PAYMENT.

Sales Tax

Total Order

3,050.68

3,050.68

ORIGINAL INVOICE

CUSTOMER				CITY				STATE					
DOYLE HARTMAN													
MAIL INVOICE TO				UNIT #									
DATE 12-13-99				DISTRICT Hobbs NM				LOCATION CODE 1310					
OPEN		NEW WELL		WORK OVER		<input checked="" type="checkbox"/> RIG		NO RIG		OIL WELL			
<input checked="" type="checkbox"/>													
LAND		INLAND		OFFSHORE		DEV.		EXPLORATION		OTHER			
WELL NAME				COUNTRY				STATE					
Courtland Meyers P#2				Don Mashburn				N.M.					
P.O., AFE, CONTRACT NUMBER				COUNTY				STATE					
				Lea				N.M.					
Baker Atlas is hereby instructed to deliver the equipment or perform the services ordered, or as orally directed, under the TERMS AND CONDITIONS printed on the reverse side of this order and which I ACCEPT as Customer or as Customer's Authorized Agent, pursuant to the terms stated herein.													
INSTRUMENT PROTECTION YES <input type="checkbox"/> NO <input type="checkbox"/> NOT AVAILABLE <input checked="" type="checkbox"/>													
CODE		DESCRIPTION						UNIT COST		UNITS		DATE/TIME AMOUNT	
SC	PR	SERVICE CHARGE: OPEN HOLE Cased Hole						\$1500	1	#	1500.00		
FIL	UP	ENVIRONMENTAL CHARGE						\$75	1	#	75.00		
		INSTRUMENT PROTECTION CHARGE NOT AVAILABLE									N/C		
LIFE	101	Pressure Control						\$500	1	#	500.00		
FPI	SD 001	Fire Point depth charge						\$.24	minimum	#	1440.00		
FPI	SD 003	Overstuck Charge						\$1000	1	#	1000.00		
CSS	SD 001	Chemical Cut depth charge						\$.28	minimum	#	1680.00		
CSS	SD 003	Operation Charge						\$1000	1	#	1000.00		
						Book price discount						\$ 7,175.00	
						Total						\$ 2,878.00	
Duffin [Signature]													

THE SERVICE(S) AND/OR EQUIPMENT COVERED BY THIS SERVICE ORDER CONTRACT HAVE BEEN PERFORMED OR RECEIVED AS SET FORTH ABOVE

CUSTOMER SIGNATURE _____
BA ENGINEER SIGNATURE [Signature]
DISTRICT MANAGER APPROVAL _____ DATE _____

DEC 27 1977

UNITED STATES
DEPARTMENT OF THE INTERIOR
GEOLOGICAL SURVEYSUBMIT IN TR
(Other Instruct
verse side)TE
reForm approved.
Budget Bureau No. 42-R1424.

5. LEASE DESIGNATION AND SERIAL NO.

LC-032450 (b)

6. IF INDIAN, ALLOTTEE OR TRIBE NAME

7. UNIT AGREEMENT NAME

8. FARM OR LEASE NAME

Myers B Federal

9. WELL NO.

28

10. FIELD AND POOL, OR WILDCAT

Langlie Mattix Queen

11. SEC., T., R., M., OR BLK. AND
SURVEY OR AREA

15-24-37

12. COUNTY OR PARISH

Lea

13. STATE

NM

SUNDRY NOTICES AND REPORTS ON WELLS

(Do not use this form for proposals to drill or to deepen or plug back to a different reservoir.
Use "APPLICATION FOR PERMIT—" for such proposals.)

1.

OIL WELL ☐ GAS WELL ☒ OTHER

2. NAME OF OPERATOR

Amoco Production Company

3. ADDRESS OF OPERATOR

P. O. Drawer A, Levelland, Texas 79336

4. LOCATION OF WELL (Report location clearly and in accordance with any State requirements.*

See also space 17 below.)

At surface

660' FNL x 810' FWL (Unit D, Sec 15)

14. PERMIT NO.

15. ELEVATIONS (Show whether DF, RT, GR, etc.)

3269.7 RDB

16.

Check Appropriate Box To Indicate Nature of Notice, Report, or Other Data

NOTICE OF INTENTION TO:

TEST WATER SHUT-OFF ☐FRACTURE TREAT ☐SHOOT OR ACIDIZE ☐REPAIR WELL ☐(Other) ☐PULL OR ALTER CASING ☐MULTIPLE COMPLETE ☐ABANDON* ☐CHANGE PLANS ☐

SUBSEQUENT REPORT OF:

WATER SHUT-OFF ☒FRACTURE TREATMENT ☐SHOOTING OR ACIDIZING ☐(Other) ☐REPAIRING WELL ☐ALTERING CASING ☐ABANDONMENT* ☐Set Casing ☒(NOTE: Report results of multiple completion on Well
Completion or Recompletion Report and Log form.)17. DESCRIBE PROPOSED OR COMPLETED OPERATIONS (Clearly state all pertinent details, and give pertinent dates, including estimated date of starting any
proposed work. If well is directionally drilled, give subsurface locations and measured and true vertical depths for all markers and zones perti-
nent to this work.)*

Continued drilling to TD of 3600'. Ran 7" casing and set at 3600'. Pumped 700 sx
Dow Filler & Incor cement down the casing. Plugged down 5:05 P.M. on 12-11-77
Circulated 55 sx. Released rig 7:00 P.M. on 12-11-77.

Move in service unit 12-16-77. On 12-18-77, ran tubing and displaced hole with
3% KCL water. Pulled tubing and evaluated. Perforated the following intervals;
3187'-3202', 3225'-38', 3243'-63', 3270'-76', 3301'-04', and 3311'-17' with
2/DPJSPF. Ran tubing to 3330'.

18. I hereby certify that the foregoing is true and correct

SIGNED

Randy Atkins

TITLE

Staff Assistant (SG)

DATE

12-20-77

(This space for Federal or State office use)

APPROVED BY

CONDITIONS OF APPROVAL, IF ANY:

0 & 4-USGS-H

1-Div.

1-Susp.

1-RC

TITLE

*See Instructions on Reverse Side

ACCEPTED FOR RECORD

DEC 22 1977

U. S. GEOLOGICAL SURVEY
HOBBS, NEW MEXICO

New Mexico Oil Conservation Division, District I
1625 N. French Drive
Hobbs, NM 88240

Form 3160-3
(July 1992)

UNITED STATES
DEPARTMENT OF THE INTERIOR
BUREAU OF LAND MANAGEMENT

SUBMIT IN TRIPLICATE*
(Other instructions on
reverse side)

FORM APPROVED
OMB NO. 1004-0136
Expires: February 28, 1995

APPLICATION FOR PERMIT TO DRILL OR DEEPEN

1a. TYPE OF WORK DRILL <input checked="" type="checkbox"/> DEEPEN <input type="checkbox"/>		5. LEASE DESIGNATION AND SERIAL NO. LC 032450-B
b. TYPE OF WELL OIL WELL <input type="checkbox"/> GAS WELL <input checked="" type="checkbox"/> OTHER <input type="checkbox"/> SINGLE ZONE <input type="checkbox"/> MULTIPLE ZONE <input type="checkbox"/>		6. IF INDIAN, ALLOTTEE OR TRIBE NAME
2. NAME OF OPERATOR Doyle Hartman		7. UNIT AGREEMENT NAME
3. ADDRESS AND TELEPHONE NO. 500 N. Main St., Midland, Texas 79701 (915) 684-41		8. FARM OR LEASE NAME, WELL NO. Courtland Myers B Fed. #3
4. LOCATION OF WELL (Report location clearly and in accordance with any State) At surface 840' FWL & 990' FNL, Unit (D) At proposed prod. zone Seven Rivers Queen Grayburg		9. API WELL NO. 30-025-35062
14. DISTANCE IN MILES AND DIRECTION FROM NEAREST TOWN OR POST. 6 miles northwest of Jal, New Mexico		10. FIELD AND POOL, OR WILDCAT Langlie Mattix 1R-QN-GR
15. DISTANCE FROM PROPOSED* LOCATION TO NEAREST PROPERTY OR LEASE LINE, FT (Also to nearest drg. unit line, if any) 840		11. SEC., T., R., M., OR BLK. AND SURVEY OR AREA D-15-T24S-R37E
16. NO. OF ACRES IN LEASE		12. COUNTY OR PARISH Lea
17. NO. OF ACRES ASSIGNED TO THIS WELL		13. STATE NM
18. DISTANCE FROM PROPOSED LOCATION* TO NEAREST WELL, DRILLING, COMPLETED, OR APPLIED FOR, ON THIS LEASE, FT. 390' South		19. PROPOSED DEPTH 3650'
20. ROTARY OR CABLE TOOLS Rotary		21. ELEVATIONS (Show whether DF, RT, GR, etc.) GR 3256'
22. APPROX. DATE WORK WILL START*		

OPER. OGRID NO. 6473
PROPERTY NO. 26106
POOL CODE 372.40
EFF. DATE 6-22-00
API NO. 30-025-35062

PROPOSED CASING AND CEMENTING PROGRAM

SIZE OF HOLE	GRADE, SIZE OF CASING	WEIGHT PER FOOT	SETTING DEPTH	QUANTITY OF CEMENT
12 1/4"	9 5/8"	36	1025' 500'	350
8 3/4"	7"	23 or 26	3650'	750

Before drilling out from under surface pipe, the well will be equipped with a 3000 psig 10-inch series 900 double ram hydraulic BOP. For other necessary BOP data required with this APD, see attached drilling prognosis.

Proposed cementing detail - note quantities listed are tentative as based upon previously drilled wells in the area but may be adjusted as indicated by actual drilling conditions and openhole caliper logs.

This is a replacement well for the Courtland Myers No. 2. This well was abandoned due to a squeeze job that communicated uphole and cemented the tubing and retainer in the 7" casing.

APPROVAL SUBJECT TO
GENERAL REQUIREMENTS AND
SPECIAL STIPULATIONS

DOYLE HARTMAN
OIL OPERATOR
RECEIVED

JUN 26 2000

IN ABOVE SPACE DESCRIBE PROGRAM: If proposal is to deepen, give data on present productive zone and proposed new productive zone. If proposal is to drill or deepen directionally, give pertinent data on subsurface locations and measured and true vertical depths. Give blowout preventer program, if any.

24. SIGNED Don Mashburn TITLE Don Mashburn, Engineer

(This space for Federal or State office use)

PERMIT NO. _____ APPROVAL DATE _____

Application approval does not warrant or certify that the applicant holds legal or equitable title to those rights in the subject lease which would entitle the applicant to conduct operations thereon.

APPROVED BY (ORIG. SGD.) ARMANDO A. LOPEZ

Acting Assistant Field Manager, JUN 19 2000
Lands And Minerals

*See Instructions On Reverse Side

Title 18 U.S.C. Section 1001, makes it a crime for any person knowingly and willfully to make to any department or agency of the United States any false, fictitious or fraudulent statements or representations as to any matter within its jurisdiction.

APPROVED FOR 1 YEAR

DISTRICT I
P.O. Box 1980, Hobbs, NM 88241-1980

DISTRICT II
P.O. Drawer DD, Artesia, NM 88211-0719

DISTRICT III
1000 Rio Brazos Rd., Aztec, NM 87410

DISTRICT IV
P.O. BOX 2088, SANTA FE, N.M. 87504-2088

State of New Mexico
Energy, Minerals and Natural Resources Department

Form C-102
Revised February 10, 1984
Submit to Appropriate District Office
State Lease - 4 Copies
Fee Lease - 3 Copies

OIL CONSERVATION DIVISION

P.O. Box 2088
Santa Fe, New Mexico 87504-2088

☐ AMENDED REPORT

WELL LOCATION AND ACREAGE DEDICATION PLAT

API Number	Pool Code 37240	Pool Name LANGLIE MATTIX 7R-QN-GR
Property Code 19387	Property Name COURTLAND MYERS "B"	Well Number 2-A 3
OGRID No. 6473	Operator Name DOYLE HARTMAN OPERATORS	Elevation 3256

Surface Location

UL or lot No. D	Section 15	Township 24 S	Range 37 E	Lot Idn	Feet from the 990	North/South line NORTH	Feet from the 840	East/West line WEST	County LEA
--------------------	---------------	------------------	---------------	---------	----------------------	---------------------------	----------------------	------------------------	---------------

Bottom Hole Location If Different From Surface

UL or lot No.	Section	Township	Range	Lot Idn	Feet from the	North/South line	Feet from the	East/West line	County
Dedicated Acres 40	Joint or Infill N	Consolidation Code	Order No.						

NO ALLOWABLE WILL BE ASSIGNED TO THIS COMPLETION UNTIL ALL INTERESTS HAVE BEEN CONSOLIDATED
OR A NON-STANDARD UNIT HAS BEEN APPROVED BY THE DIVISION

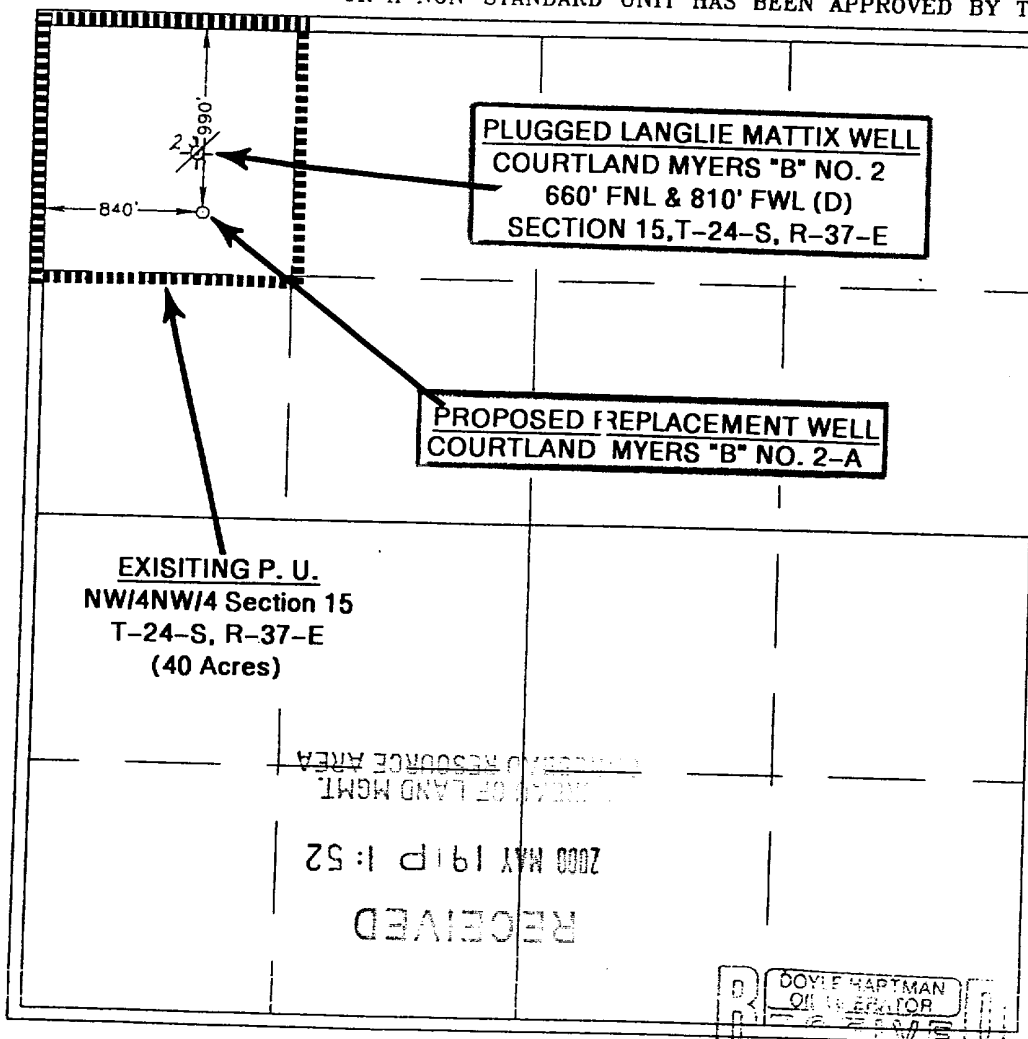

OPERATOR CERTIFICATION

I hereby certify the the information contained herein is true and complete to the best of my knowledge and belief.

Don Mashburn (DB)
Signature

Don Mashburn
Printed Name

Engineer
Title

Date 5/18/00

SURVEYOR CERTIFICATION

I hereby certify that the well location shown on this plat was plotted from field notes of actual surveys made by me or under my supervision and that the same is true and correct to the best of my belief.

FEBRUARY 15, 2000

Date Surveyed J. EIDSON DC

Signature & Seal of
Professional Surveyor

Ronald J. Eidson
5/19/2000
08-11-02-12

Certificate No. RONALD J. EIDSON 3239
GARRISON 12641
JACOB McDONALD 12165

MAY 10 2000