

NEW MEXICO OIL CONSERVATION COMMISSION  
WELL LOCATION AND ACREAGE DEDICATION

Form O-112  
Supersedes O-128  
Effective 1-1-65

All distances must be from the outer boundaries of the Section

Operator <b>Amoco Production Company</b>			Lease <b>Myers B Federal</b>		Well No. <b>29</b>
Unit Letter <b>K</b>	Section <b>15</b>	Township <b>24 South</b>	Range <b>37 East</b>	County <b>Lea</b>	
Actual Plotage Location of Well: <b>1980</b> feet from the <b>South</b> line and <b>1830</b> feet from the <b>West</b> line					
Ground Level Elev. <b>3250.2</b>	Producing Formation <b>QUEEN</b>		Pool <b>LANGLIE MATTIX</b>	Dedicated Acreage: <b>40</b> Acres	

1. Outline the acreage dedicated to the subject well by colored pencil or hachure marks on the plat below.
2. If more than one lease is dedicated to the well, outline each and identify the ownership thereof (both as to working interest and royalty).
3. If more than one lease of different ownership is dedicated to the well, have the interests of all owners been consolidated by communitization, unitization, force-pooling, etc?

☐ Yes ☐ No If answer is "yes," type of consolidation \_\_\_\_\_

If answer is "no," list the owners and tract descriptions which have actually been consolidated. (Use reverse side of this form if necessary.) \_\_\_\_\_

No allowable will be assigned to the well until all interests have been consolidated (by communitization, unitization, forced-pooling, or otherwise) or until a non-standard unit, eliminating such interests, has been approved by the Commission.

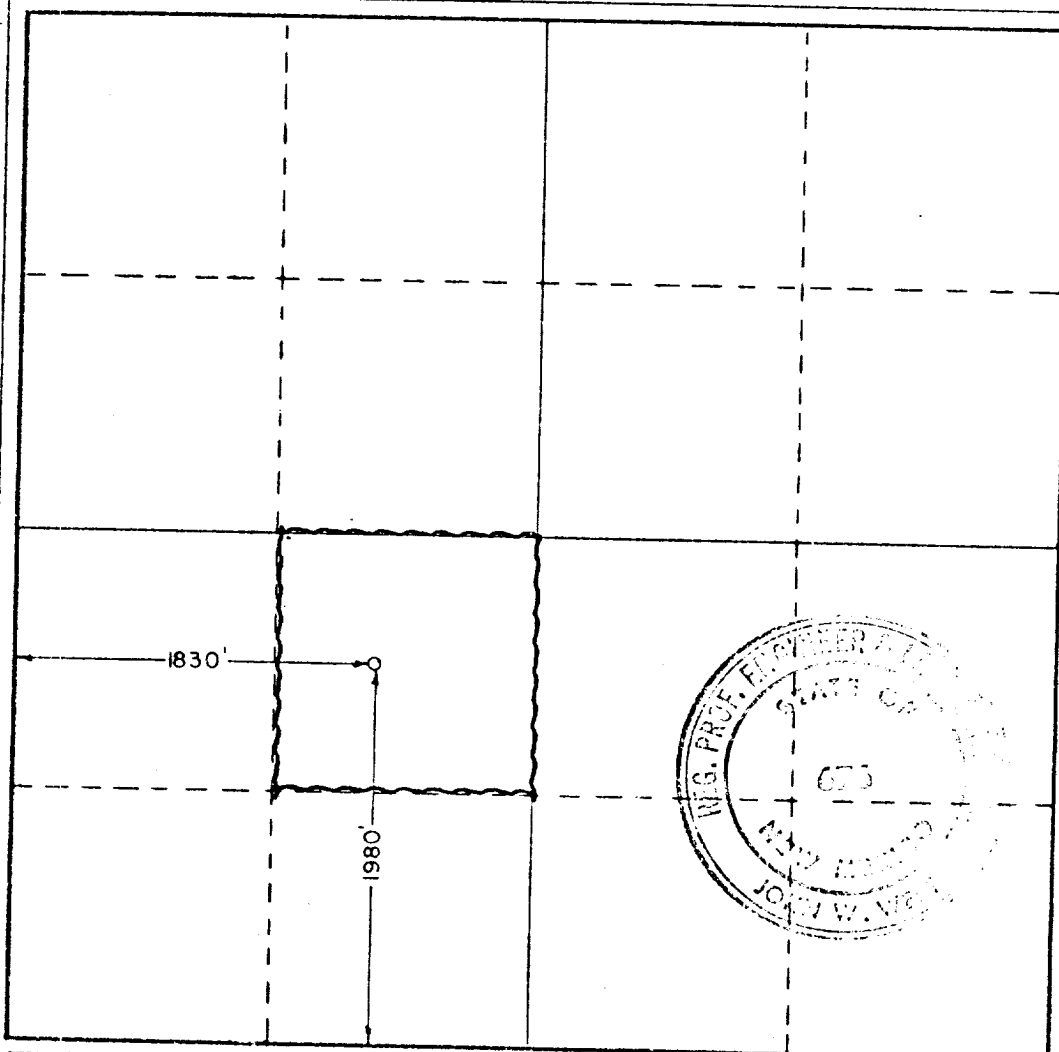

CERTIFICATION

I hereby certify that the information contained herein is true and complete to the best of my knowledge and belief.

Name  
**Randy Atkins**  
Position  
**STAFF ASSISTANT (SG)**  
Company  
**AMOCO PRODUCTION CO.**  
Date  
**10-27-77**

I hereby certify that the well location shown on this plat was plotted from field notes of actual surveys made by me or under my supervision, and that the same is true and correct to the best of my knowledge and belief.

Date Surveyed  
**October 1, 1977**

Registered Professional Engineer and/or Land Surveyor

**John W. West**

Certificate No. **676**

0 230 460 690 920 1150 1380 1610 1840 2070 2300 2530 2760 3000 3230 3460 3690 3920 4150 4380 4610 4840 5070 5300 5530 5760 5990 6220 6450 6680 6910 7140 7370 7600 7830 8060 8290 8520 8750 8980 9210 9440 9670 9900 10130 10360 10590 10820 11050 11280 11510 11740 11970 12200 12430 12660 12890 13120 13350 13580 13810 14040 14270 14500 14730 14960 15190 15420 15650 15880 16110 16340 16570 16800 17030 17260 17490 17720 17950 18180 18410 18640 18870 19100 19330 19560 19790 20020 20250 20480 20710 20940 21170 21400 21630 21860 22090 22320 22550 22780 23010 23240 23470 23700 23930 24160 24390 24620 24850 25080 25310 25540 25770 26000 26230 26460 26690 26920 27150 27380 27610 27840 28070 28300 28530 28760 28990 29220 29450 29680 29910 30140 30370 30600 30830 31060 31290 31520 31750 31980 32210 32440 32670 32900 33130 33360 33590 33820 34050 34280 34510 34740 34970 35200 35430 35660 35890 36120 36350 36580 36810 37040 37270 37500 37730 37960 38190 38420 38650 38880 39110 39340 39570 39800 40030 40260 40490 40720 40950 41180 41410 41640 41870 42100 42330 42560 42790 43020 43250 43480 43710 43940 44170 44400 44630 44860 45090 45320 45550 45780 46010 46240 46470 46700 46930 47160 47390 47620 47850 48080 48310 48540 48770 49000 49230 49460 49690 49920 50150 50380 50610 50840 51070 51300 51530 51760 51990 52220 52450 52680 52910 53140 53370 53600 53830 54060 54290 54520 54750 54980 55210 55440 55670 55900 56130 56360 56590 56820 57050 57280 57510 57740 57970 58200 58430 58660 58890 59120 59350 59580 59810 60040 60270 60500 60730 60960 61190 61420 61650 61880 62110 62340 62570 62800 63030 63260 63490 63720 63950 64180 64410 64640 64870 65100 65330 65560 65790 66020 66250 66480 66710 66940 67170 67400 67630 67860 68090 68320 68550 68780 69010 69240 69470 69700 69930 70160 70390 70620 70850 71080 71310 71540 71770 72000 72230 72460 72690 72920 73150 73380 73610 73840 74070 74300 74530 74760 74990 75220 75450 75680 75910 76140 76370 76600 76830 77060 77290 77520 77750 77980 78210 78440 78670 78900 79130 79360 79590 79820 80050 80280 80510 80740 80970 81200 81430 81660 81890 82120 82350 82580 82810 83040 83270 83500 83730 83960 84190 84420 84650 84880 85110 85340 85570 85800 86030 86260 86490 86720 86950 87180 87410 87640 87870 88100 88330 88560 88790 89020 89250 89480 89710 89940 90170 90400 90630 90860 91090 91320 91550 91780 92010 92240 92470 92700 92930 93160 93390 93620 93850 94080 94310 94540 94770 95000 95230 95460 95690 95920 96150 96380 96610 96840 97070 97300 97530 97760 97990 98220 98450 98680 98910 99140 99370 99600 99830 10000