

NO. OF COPIES RECEIVED		
DISTRIBUTION		
SANTA FE		
FILE		
U.S.G.S.		
LAND OFFICE		
OPERATOR		

N. MEXICO OIL CONSERVATION COMMISSION

Form C-101
Revised 1-1-65

5A. Indicate Type of Lease STATE <input checked="" type="checkbox"/> FEE <input type="checkbox"/>
5. State Oil & Gas Lease No. B-2616

APPLICATION FOR PERMIT TO DRILL, DEEPEN, OR PLUG BACK

1a. Type of Work b. Type of Well OIL WELL <input type="checkbox"/> GAS WELL <input checked="" type="checkbox"/> OTHER <input type="checkbox"/> SINGLE ZONE <input type="checkbox"/> MULTIPLE ZONE <input type="checkbox"/>	DRILL <input checked="" type="checkbox"/> DEEPEN <input type="checkbox"/> PLUG BACK <input type="checkbox"/>	7. Unit Agreement Name
2. Name of Operator Amoco Production Company	8. Farm or Lease Name State "D"	9. Well No. 4
3. Address of Operator P. O. Drawer "A", Levelland, TX 79336	10. Field and Pool, or Wildcat Langlie Mattix Queen	
4. Location of Well UNIT LETTER B LOCATED 990 FEET FROM THE north LINE AND 1,650 FEET FROM THE east LINE OF SEC. 16 TWP. 24-S RGE. 37-E NMPM	12. County Lea	
19. Proposed Depth 3,600'	19A. Formation Queen	20. Rotary or C.T. Rotary
21. Elevations (Show whether DE, RI, etc.) 3272.3 GR	21A. Kind & Status Plug. Bond Blanket-On File	21B. Drilling Contractor NA
	22. Approx. Date Work will start February 3, 1978	

23.

PROPOSED CASING AND CEMENT PROGRAM

SIZE OF HOLE	SIZE OF CASING	WEIGHT PER FOOT	SETTING DEPTH	SACKS OF CEMENT	EST. TOP
12-1/4"	8-5/8"	24#	1,100'	Circ.	
8-3/4"	5-1/2"	14#	3,600'	Circ.	

After drilling well, logs will be run and evaluation made, perforating and/or stimulating as necessary in attempting commercial production.

Mud Program: 0' - 1,100' - Native mud and fresh water
1,100' - 3,600' - Native mud and brine water and minimum commercial properties to maintain safe hole conditions and run open hole logs

BOP Program is attached.

Gas is committed.

IN ABOVE SPACE DESCRIBE PROPOSED PROGRAM: IF PROPOSAL IS TO DEEPEN OR PLUG BACK, GIVE DATA ON PRESENT PRODUCTIVE ZONE AND PROPOSED NEW PRODUCTIVE ZONE. GIVE BLOWOUT PREVENTER PROGRAM, IF ANY.

I hereby certify that the information above is true and complete to the best of my knowledge and belief.

Signed Randy Atkins Title Asst. Admin. Analyst Date 1-24-78

(This space for State Use)

APPROVED BY [Signature] TITLE SUPERVISOR DISTRICT 1 DATE JAN 28 1978

CONDITIONS OF APPROVAL, IF ANY:

0+4 - NMOC, H 1 - RC
1 - Div 1 - Susp

NEW MEXICO OIL CONSERVATION COMMISSION
WELL LOCATION AND ACREAGE DEDICATION PL

Form C-102
Supersedes C-128
Effective 1-4-65

All distances must be from the outer boundaries of the Section

Operator Amoco Production Company		Lease State D		Well No. 4
Tract Letter B	Section 16	Township 24 South	Range 37 East	County Lea
Actual Well Location of Well: 990 feet from the North line and 1650 feet from the East line				
Ground Level Elev. 3272.3	Producing Formation QUEEN	Pool LANGLIE MATTIX	Dedicated Acreage 40 Acres	

1. Outline the acreage dedicated to the subject well by colored pencil or hachure marks on the plat below.
2. If more than one lease is dedicated to the well, outline each and identify the ownership thereof (both as to working interest and royalty).
3. If more than one lease of different ownership is dedicated to the well, have the interests of all owners been consolidated by communization, unitization, force-pooling, etc?

☐ Yes ☐ No If answer is "yes," type of consolidation _____

If answer is "no," list the owners and tract descriptions which have actually been consolidated. (Use reverse side of this form if necessary.) _____

No allowable will be assigned to the well until all interests have been consolidated (by communization, unitization, forced-pooling, or otherwise) or until a non-standard unit, eliminating such interests, has been approved by the Commission.

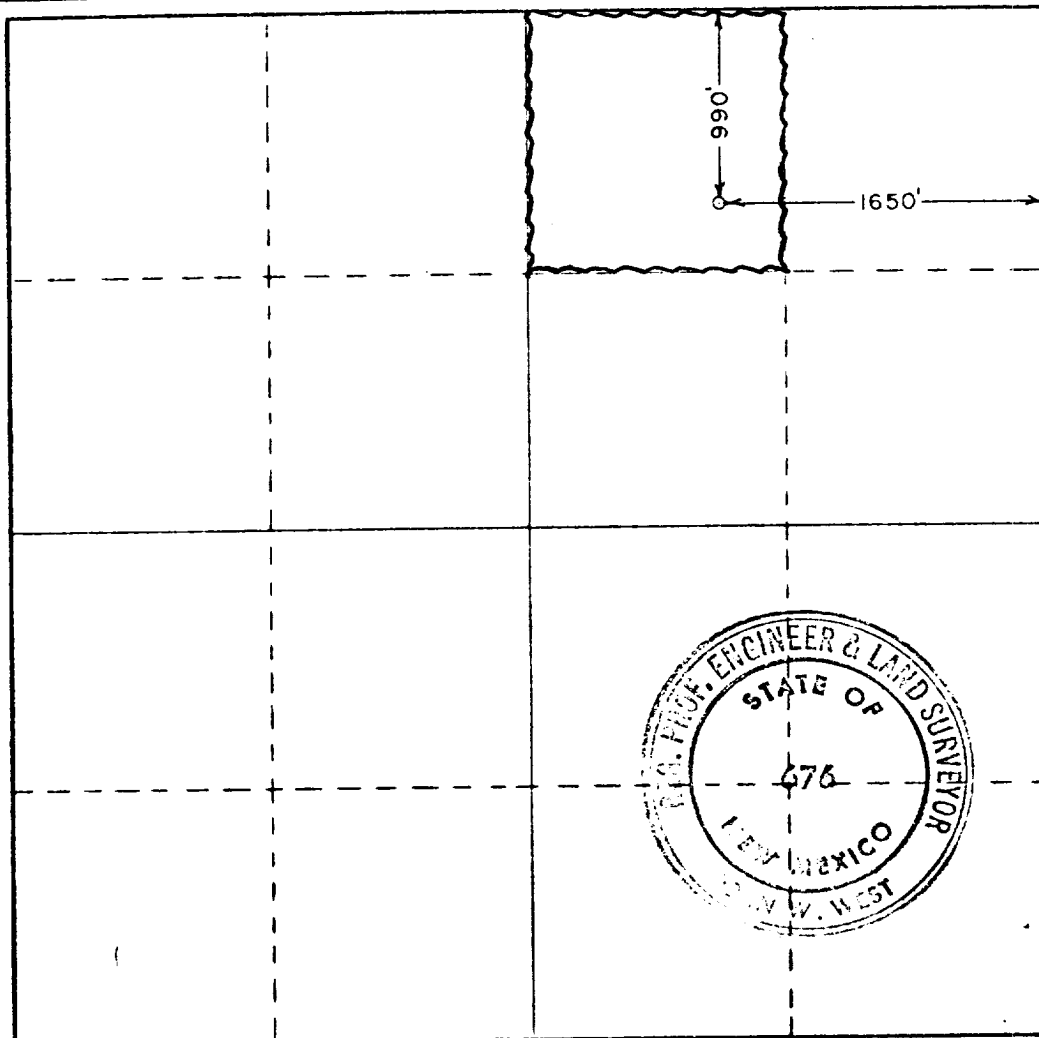

CERTIFICATION

I hereby certify that the information contained herein is true and complete to the best of my knowledge and belief.

Signature: Randy Atkins
Position: ASS'T. ADMIN. ANALYST
Company: AMOCO PRODUCTION CO.
Date: 1-24-78

I hereby certify that the well location shown on this plat was plotted from field notes of actual surveys made by me or under my supervision, and that the same is true and correct to the best of my knowledge and belief.

Date Surveyed: Jan. 19, 1978
Registered Professional Engineer and/or Land Surveyor:
Signature: John W. West
Certificate No. John W. West 676
Ronald J. Edson 3239

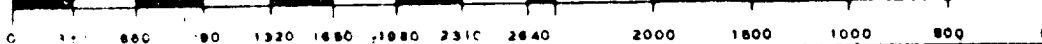

1. Blow-out preventers and master valve to be fluid operated and all fittings must be in good condition, 3,000 W.P. (6,000 p.s.i. test), minimum.
2. Equipment through which bit must pass shall be as large as the inside diameter of the casing that is being drilled through.
3. B nipple above blow-out preventer shall be same size as casing being drilled through.
4. Kelly cock required, 3,000 W.P. (6,000 p.s.i. test), minimum.
5. OMSCO or comparable safety valve must be available on rig floor at all times with proper connection or sub, 3,000 W.P. (6,000 p.s.i. test), minimum.
6. Blow-out preventers and master valve while drilling intermediate hole to 6,000' may be 2,000 W.P. (4,000 p.s.i. test), minimum.
7. Choke assembly, beyond second valve from cross, may be positioned (Optional) outside of derrick foundation.
8. Spool or cross may be eliminated if connections are available in the lower part of the blow-out preventer body.
9. Plug valves - gate valves are optional. Valves shown as 2" are minimum size.
10. Casing head and casing head spool, including attached valves, to be furnished by Pan American.
11. Rams in preventers will be installed as follows:
 When drilling, use:
 Top Preventer - Drill pipe rams
 Bottom Preventer - Blind rams or master valve
 When running casing, use:
 Top Preventer - Casing rams
 Bottom Preventer - Blind rams or master valve.

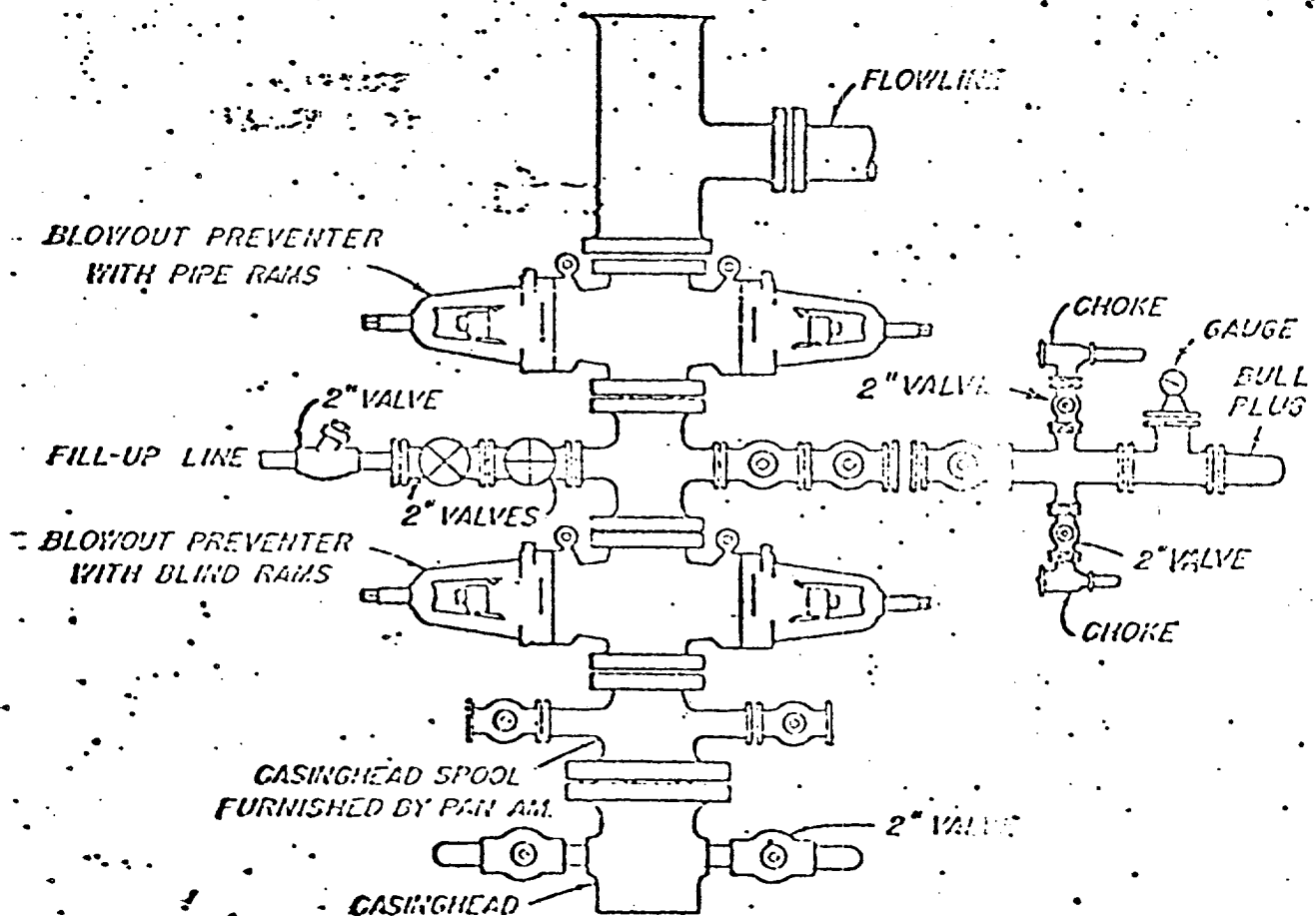

BLOWOUT PREVENTER HOOK-UP PAN AMERICAN PETROLEUM CORP.

EXHIBIT D-1 MODIFIED

JUNE 1, 1962