

**NEW MEXICO OIL CONSERVATION COMMISSION
WELL LOCATION AND ACREAGE DEDICATION PLAT**

Form C-102
Supersedes C-128
Effective 1-1-65

All distances must be from the outer boundaries of the Section

Lessee Amoco Production Co.			Lease South Mattix			Section 37		
Section 1	Range 15	Meridian 24 South	Range 37 East	County Lea				
Acres Dedicated to the well			Acres					
1840			660					
feet from the South line and			feet from the East line					
Ground Level Elev 3230.9		Producing Formation Upper Yeso		Pool Fowler Upper Yeso			Dedicated Acreage 80	

1. Outline the acreage dedicated to the subject well by colored pencil or hatchure marks on the plat below.
2. If more than one lease is dedicated to the well, outline each and identify the ownership thereof (both as to working interest and royalty).
3. If more than one lease of different ownership is dedicated to the well, have the interests of all owners been consolidated by communitization, unitization, force-pooling, etc?

☒ Yes ☐ No If answer is "yes," type of consolidation **Unitization**

If answer is "no," list the owners and tract descriptions which have actually been consolidated (Use reverse side of this form if necessary.) _____

No allowable will be assigned to the well until all interests have been consolidated (by communitization, unitization, forced-pooling, or otherwise) or until a non-standard unit, eliminating such interests, has been approved by the Commission.

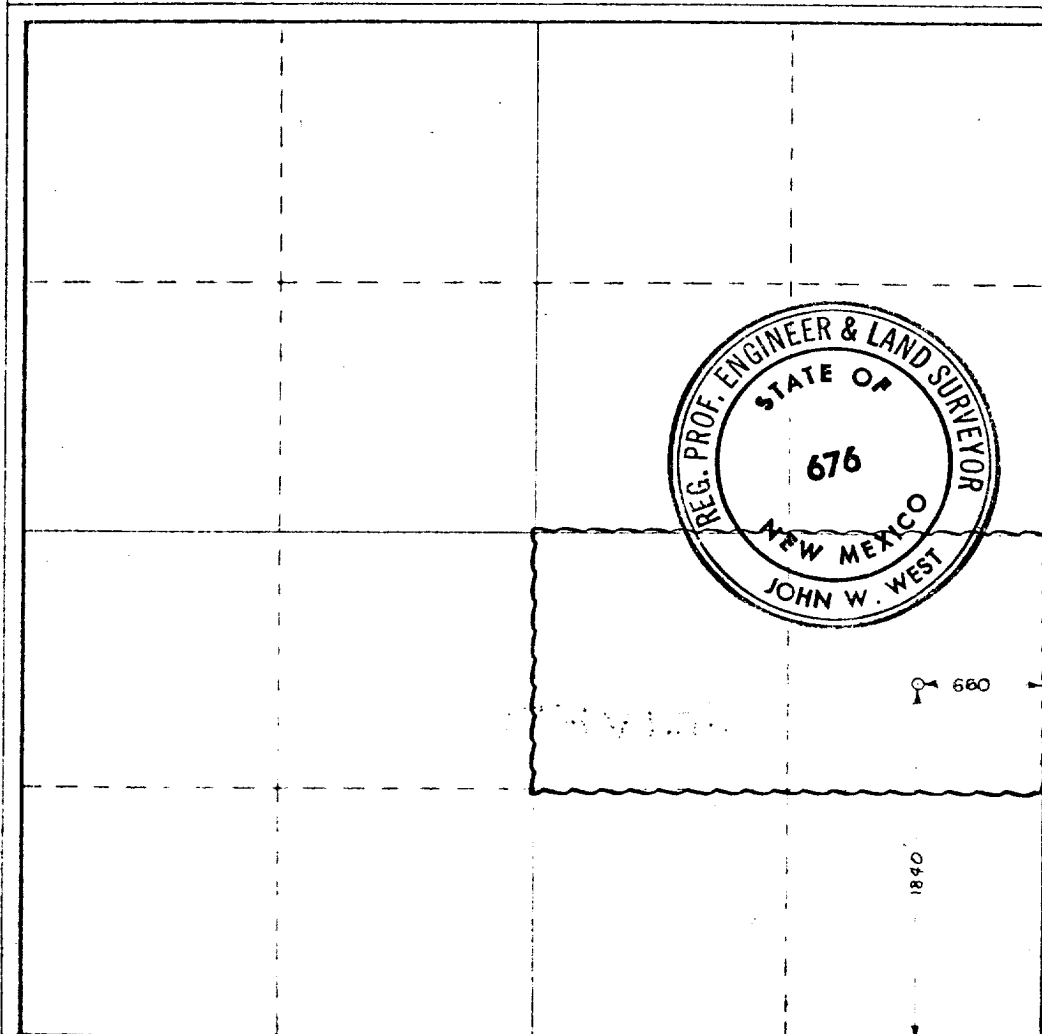

CERTIFICATION

I hereby certify that the information contained herein is true and complete to the best of my knowledge and belief.

Randy Atkins
Position

Administrative Analyst

Company
Amoco Production Company

Date
May 8, 1979

I hereby certify that the well location shown on this plat was plotted from field notes of actual surveys made by me or under my supervision, and that the same is true and correct to the best of my knowledge and belief.

Date Surveyed
May 1, 1979

Registered Professional Engineer and/or Land Surveyor

John W. West
Certificate No.

John W. West 676
Ronald J. Eldon 3239

RECEIVED

JUN 19 1979

CHL. CO. 11. 11.
HOURS. N. M.