

30-025-26981

NO. OF COPIES RECEIVED	
DISTRIBUTION	
SANTA FE	
FILE	
U.S.G.S.	
LAND OFFICE	
OPERATOR	

NEW MEXICO OIL CONSERVATION COMMISSION

Form C-101
Revised 1-1-65

5A. Indicate Type of Lease	
STATE <input checked="" type="checkbox"/>	FEE <input type="checkbox"/>
5. State Oil & Gas Lease No.	
A-1212-1	

APPLICATION FOR PERMIT TO DRILL, DEEPEN, OR PLUG BACK

1a. Type of Work		7. Unit Agreement Lease	
b. Type of Well OIL WELL <input checked="" type="checkbox"/> GAS WELL <input type="checkbox"/> OTHER <input type="checkbox"/>		8. Term or Lease Name	
DEEPEN <input type="checkbox"/> PLUG BACK <input type="checkbox"/>		State A	
SINGLE ZONE <input type="checkbox"/> MULTIPLE ZONE <input type="checkbox"/>		9. Well No.	
2. Name of Operator		39	
Amoco Production Company		10. Field and Section	
3. Address of Operator		UNDERSIGNED	
P. O. Box 68 Hobbs, NM 88240		Bowers Seven Rivers	
4. Location of Well		12. County	
UNIT LETTER P LOCATED 760 FEET FROM THE South LINE		Lea	
AND 760 FEET FROM THE East LINE OF SEC. 4 TWP. 19-S RGE. 38-F NMPM			
19. Proposed Depth		19A. Formation	
3400'		Seven Rivers	
20. Rotary or C.T.		Rotary	
21. Elevations (Show whether DT, RT, etc.)		22. Approx. Date Work will start	
3606.0 GL		8-27-80	
21A. Kind & Status Plug. Bend		21B. Drilling Contractor	
Blanket-on-file		NA	

PROPOSED CASING AND CEMENT PROGRAM

SIZE OF HOLE	SIZE OF CASING	WEIGHT PER FOOT	SETTING DEPTH	SACKS OF CEMENT	EST. TOP
11" or 12-1/4"	8-5/8"	36#	400'	Circulate	Surface
7-7/8"	5-1/2"	26#	3350'	Circulate	Surface

Propose to drill and equip well in the Seven Rivers formation. After reaching TD, log will be run and evaluated; perforate and stimulate as necessary in attempting commercial production.

MUD PROGRAM: 0'- 400' Native mud and fresh water
400'-TD Commercial mud and brine water with minimum properties for safe hole conditions.

BOP PROGRAM ATTACHED

APPROVAL VALID
FOR 90 DAYS UNLESS
CORKING COMMENCED,

EXPIRES 11/11/80

0+4-NMOCD, H 1-Hou 1-Susp 1-LBG 1-Wayne Stafford, Hou

IN ABOVE SPACE DESCRIBE PROPOSED PROGRAM: IF PROPOSAL IS TO DEEPEN OR PLUG BACK, GIVE DATA ON PRESENT PRODUCTIVE ZONE AND PROPOSED NEW PRODUCTIVE ZONE. GIVE BLOWOUT PREVENTER PROGRAM, IF ANY.

I hereby certify that the information above is true and complete to the best of my knowledge and belief.

Signed Ray Cox Title Administrative Supervisor Date 8-7-80
(This space for State Use)

APPROVED BY [Signature] TITLE SUPERVISOR DISTRICT I DATE AUG 11 1980
CONDITIONS OF APPROVAL, IF ANY:

NEW MEXICO OIL CONSERVATION COMMISSION
WELL LOCATION AND ACREAGE DEDICATION PLAT

Form C-102
Supersedes C-128
Effective 1-1-75

All distances must be from the outer boundaries of the Section

Operator AMOCO Production Co.			Lease State A		Well No. 39
Unit Letter P	Section 4	Township 19 South	Range 38 East	County Lea	
Actual Footage Location of Well: 760 feet from the South line and 760 feet from the East line					
Ground Level Elev. 3606.0	Producing Formation Seven Rivers		Pool Bowers Seven Rivers		Dedicated Acreage: 40 Acres

1. Outline the acreage dedicated to the subject well by colored pencil or hatchure marks on the plat below.
2. If more than one lease is dedicated to the well, outline each and identify the ownership thereof (both as to working interest and royalty).
3. If more than one lease of different ownership is dedicated to the well, have the interests of all owners been consolidated by communitization, unitization, force-pooling, etc?

☐ Yes ☐ No If answer is "yes," type of consolidation _____

If answer is "no," list the owners and tract descriptions which have actually been consolidated. (Use reverse side of this form if necessary.) _____

No allowable will be assigned to the well until all interests have been consolidated (by communitization, unitization, forced-pooling, or otherwise) or until a non-standard unit, eliminating such interests, has been approved by the Commission.

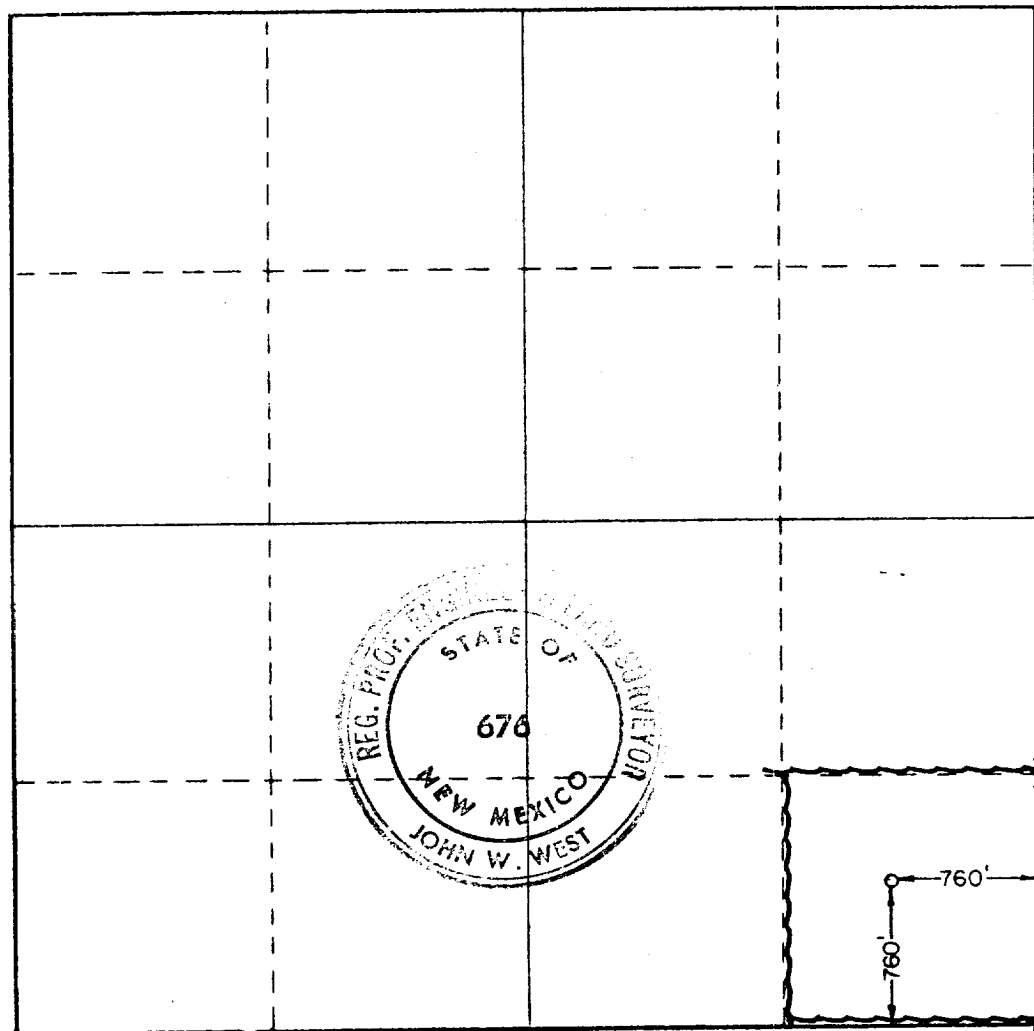

CERTIFICATION

I hereby certify that the information contained herein is true and complete to the best of my knowledge and belief.

Name Ray Cox
Position Administrative Supervisor
Company Amoco Production Company
Date 8-7-80

I hereby certify that the well location shown on this plat was plotted from field notes of actual surveys made by me or under my supervision, and that the same is true and correct to the best of my knowledge and belief.

Date Surveyed July 29, 1980
Registered Professional Engineer and/or Land Surveyor

John W. West
Certificate No. JOHN W. WEST 676
PATRICK A. ROMERO 6863
Ronald J. Eidson 3239

0 330 660 990 1320 1650 1980 2310 2640 2970 3300 3630 3960 4290 4620 4950 5280 5610 5940 6270 6600 6930 7260 7590 7920 8250 8580 8910 9240 9570 9900

ATTACHMENT "B"
NOTES

1. Blow-out preventers and master valve to be fluid operated and oil fittings must be in good condition, 3,000# W.P. (6,000 p.s.i. test), minimum.
2. Equipment through which bit must pass shall be as large as the inside diameter of the casing that is being drilled through.
3. Nipple above blow-out preventer shall be same size as casing being drilled through.
4. Kelly cock required, 3,000# W.P. (6,000 p.s.i. test) minimum.
5. OMSCO or comparable safety valve must be available on rig floor at all times with proper connection or sub, 3,000# W.P. (6,000 p.s.i. test), minimum.
6. Blow-out preventers and master valve while drilling intermediate hole to 6000' may be 2,000# W.P. (4,000 p.s.i. test), minimum.
7. Choke assembly, beyond second valve from cross, may be positioned (Optional) outside of derrick foundation.
8. Spool or cross may be eliminated if connections are available in the lower part of the blow-out preventer body.
9. Plug valves - gate valves are optional. Valves shown as 2" are minimum size.
10. Casing head and casing head spool, including attached valves, to be furnished by Amoco.
11. Rams in preventers will be installed as follows:

When drilling, use:	When running casing, use:
Top Preventer - Drill pipe rams	Top Preventer - Casing rams
Bottom Preventer - Blind rams or master valve	Bottom Preventer - Blind rams or master valve

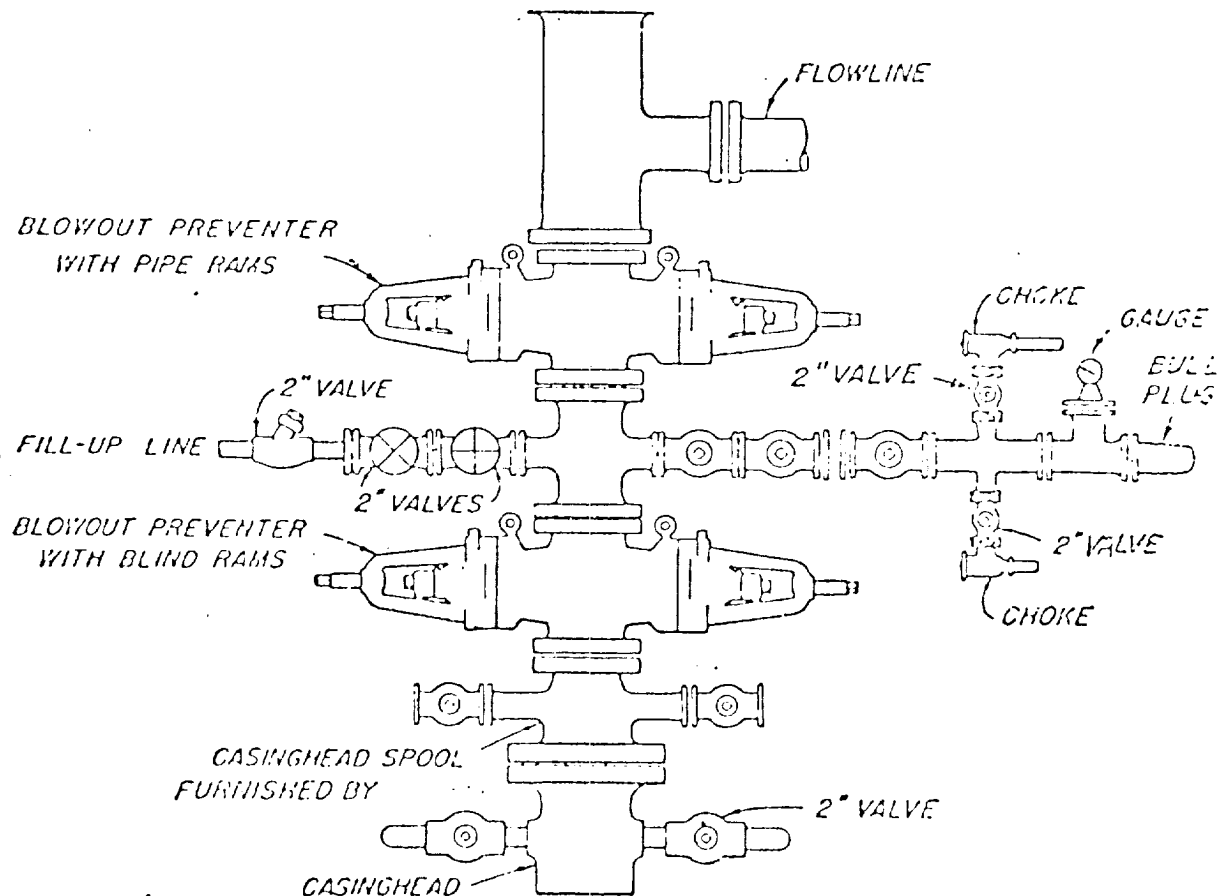

BLOWOUT PREVENTER HOOK-UP

AMOCO PRODUCTION COMPANY

EXHIBIT D-I MODIFIED

JUNE 1, 1962