

UNITED STATES
DEPARTMENT OF THE INTERIOR
GEOLOGICAL SURVEY

30-025-27071

APPLICATION FOR PERMIT TO DRILL, DEEPEN, OR PLUG BACK

1a. TYPE OF WORK

DRILL ☒DEEPEN ☐PLUG BACK ☐

b. TYPE OF WELL

OIL
WELL ☐GAS
WELL ☐

OTHER

SINGLE
ZONE ☐MULTIPLE
ZONE ☐

2. NAME OF OPERATOR

The Superior Oil Company

3. ADDRESS OF OPERATOR

P. O. Box 4500, The Woodlands, TX 77380

4. LOCATION OF WELL (Report location clearly and in accordance with any State requirements.*)

At surface

1980' FNL & 1980' FEL

At proposed prod. zone

Straight Hole

14. DISTANCE IN MILES AND DIRECTION FROM NEAREST TOWN OR POST OFFICE*

20 Miles NW of Jal.

15. DISTANCE FROM PROPOSED*

LOCATION TO NEAREST

PROPERTY OR LEASE LINE, FT.

(Also to nearest drlg. unit line, if any)

18. DISTANCE FROM PROPOSED LOCATION*

TO NEAREST WELL, DRILLING, COMPLETED,
OR APPLIED FOR, ON THIS LEASE, FT.

1st Well

16. NO. OF ACRES IN LEASE

1520

19. PROPOSED DEPTH

15200

17. NO. OF ACRES ASSIGNED

TO THIS WELL

320

20. ROTARY OR CABLE TOOLS

Rotary

21. ELEVATIONS (Show whether DF, RT, GR, etc.)

3547' GR

22. APPROX. DATE WORK WILL START*

4-10-81

23.

PROPOSED CASING AND CEMENTING PROGRAM

SIZE OF HOLE	SIZE OF CASING	WEIGHT PER FOOT	SETTING DEPTH	QUANTITY OF CEMENT	Est. Top
26"	20" K55	94.0	600'	1250 sxs light&"C"	Surface
17-1/2"	13-3/8" K55	68.0	5,300'	3000 sxs light&"C"	Surface
12-1/4"	9-5/8" S95	47.0	12,900'	1750 sxs light&"C"	10,400
8-1/2"	7-5/8" S95	39.0-29.7	14,300'	800 sxs Class "H"	12,900
6-1/2"	5" N80	23.2	15,200'	250 sxs Class "H"	14,300

SEE ATTACHED SHEETS

7-5/8" liner 12,600' - 14,300'
5" liner 14,000' - 15,200'

NOTE: 7-5/8" liner may be omitted if pressures allow.

East half of SEC 19 dedicated

U. S. GEOLOGICAL SURVEY
HOBBS, NEW MEXICO

IN ABOVE SPACE DESCRIBE PROPOSED PROGRAM: If proposal is to deepen or plug back, give data on present productive zone and proposed new productive zone. If proposal is to drill or deepen directionally, give pertinent data on subsurface locations and measured and true vertical depths. Give blowout preventer program, if any.

24.

SIGNED

G. Bannantine
G. Bannantine

TITLE Regulatory Group Mgr.

DATE 9-2-80

(This space for Federal or State office use)

PERMIT NO.

APPROVAL DATE

APPROVED BY (Orig. Sgd.) PETER W. CHESTER

TITLE ACTING DISTRICT ENGINEER

DATE SEP 24 1980

CONDITIONS OF APPROVAL, IF ANY:

Exhibit A
NEW MEXICO OIL CONSERVATION COMMISSION
WELL LOCATION AND ACREAGE DEDICATION PLAT

Form C-102
Supersedes C-128
Effective 1-1-63

All distances must be from the outer boundaries of the Section.

Operator Superior Oil Company			Lease Smith Federal		Well No. 1
Unit Letter G	Section 19	Township 24 South	Range 34 East	County Lea	
Actual Footage Location of Well: 1980 feet from the North line and 1980 m feet from the East line					
Ground Level Elev. 3547.2	Producing Formation Morrow		Pool	Dedicated Acreage: 320 Acres	

1. Outline the acreage dedicated to the subject well by colored pencil or hachure marks on the plat below.
100% Superior Lease
2. If more than one lease is dedicated to the well, outline each and identify the ownership thereof (both as to working interest and royalty).
3. If more than one lease of different ownership is dedicated to the well, have the interests of all owners been consolidated by communitization, unitization, force-pooling, etc?

☐ Yes ☐ No If answer is "yes," type of consolidation _____

If answer is "no," list the owners and tract descriptions which have actually been consolidated. (Use reverse side of this form if necessary.) _____

No allowable will be assigned to the well until all interests have been consolidated (by communitization, unitization, forced-pooling, or otherwise) or until a non-standard unit, eliminating such interests, has been approved by the Commission.

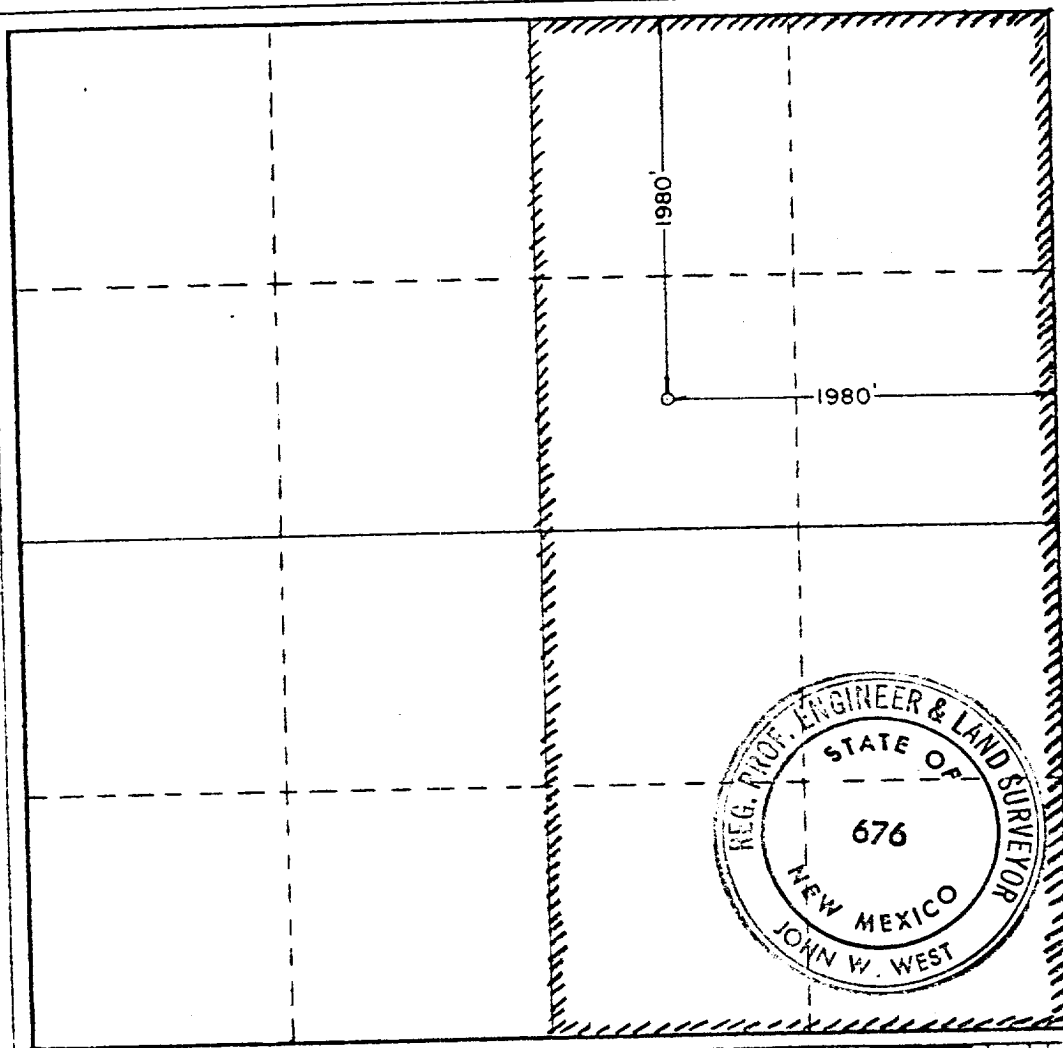

CERTIFICATION

I hereby certify that the information contained herein is true and complete to the best of my knowledge and belief.

G. Bannantine
Name

G. Bannantine
Position

Regulatory Group Manager
Company

The Superior Oil Company
Date

August 26, 1980

I hereby certify that the well location shown on this plat was plotted from field notes of actual surveys made by me or under my supervision, and that the same is true and correct to the best of my knowledge and belief.

Date Surveyed

8/8/80

Registered Professional Engineer and/or Land Surveyor

John W. West
Certificate No. **JOHN W. WEST 676**
PATRICK A. ROMERO 6668
Ronald J. Eidson 3239

INFORMATION REQUIRED WITH APD IN COMPLIANCE WITH NTL-6.

1. Geologic name of surface location is Red Beds.
2. Estimated tops of important Geological Markers are:

<u>TOPS</u>	<u>DEPTHS</u>
Red Beds	Surface
Rustler	1,270'
Base of Salt	4,840'
Delaware	5,220'
Bone Spring	9,030'
Wolf Camp	11,940'
Strawn	13,100'
Atoka	13,490'
Morrow	14,300'

3. Anticipate Gas/Oil in Bone Spring at 10,200', and Atoka at 13,550'. Gas anticipated in Morrow at 14,300'.
4. For Casing Program, see Application FPD Form 9-331-C. All casing strings are new pipe.
5. For Pressure Control Equipment, see Exhibit "C".
6. For Mud Program, see Exhibit "B".
7. List of auxillary equipment to be used:
 1. Kelly cock.
 2. Flow show indicator.
 3. Pit level indicator.
 4. Full opening valve on floor for drill pipe being used (inside BOP).
 5. Gas detector.
 6. Geolograph.
 7. Mud logger will be on location while drilling objective sands.
 8. Mud gas separator.
 9. De-gasser.
 10. De-sander.
 11. De-silter.

8. Possible DST's in Bone Spring, Atoka and Morrow.

Logs: FDC/CNL, GR, BHD/DLL, w/RXO, VDL

No coring is anticipated.

9. Abnormal pressures are anticipated in the Wolfcamp and Atoka formations at 11,940' and 13,490' respectively. No abnormal temperature or other potential hazards are expected.
10. The anticipated starting date or spud date is April 10, 1981.

Exhibit B

MUD PROGRAM

<u>APPROX. INTERVAL</u>	<u>TYPE MUD</u>	<u>WEIGHT, LB./GAL.</u>	<u>APPROX. VISCOSITY</u>	<u>WATER LOSS, CC/30 MIN.</u>
50-600'	Fresh Water	8.3 - 8.5	34 - 45	No Control
600-5,300'	Brine Water	8.6 - 10.0	28 - 31	No Control
5,300-11,500'	Fresh Water	8.6 - 9.0	28	No Control
11,500-12,900'	Brine Water	9.0 - 9.5	28	No Control
12,900-15,200'	Brine Water	10.5 - 12.5	34 - 45	5-10