

NO. OF COPIES RECEIVED	
DISTRIBUTION	
SANTA FE	
FILE	
U.S.G.S.	
LAND OFFICE	
OPERATOR	

NEW MEXICO OIL CONSERVATION COMMISSION

30-025-27080
Form C-101
Revised 1-1-65

5A. Indicate Type of Lease	
STATE <input checked="" type="checkbox"/>	FEE <input type="checkbox"/>
5. State Oil & Gas Lease No.	
E 1933	

APPLICATION FOR PERMIT TO DRILL, DEEPEN, OR PLUG BACK

1a. Type of Work		7. Unit Agreement Name	
b. Type of Well OIL WELL <input type="checkbox"/> DRILL <input checked="" type="checkbox"/> DEEPEN <input type="checkbox"/> PLUG BACK <input type="checkbox"/> GAS WELL <input checked="" type="checkbox"/> OTHER <input type="checkbox"/> SINGLE ZONE <input checked="" type="checkbox"/> MULTIPLE ZONE <input type="checkbox"/>		8. Farm or Lease Name Bell Lake Unit 2	
2. Name of Operator CONOCO INC.		9. Well No. 20	
3. Address of Operator P. O. Box 460, Hobbs, N.M. 88240		10. Field and Pool, or Wildcat Bell Lake Devonion North	
4. Location of Well UNIT LETTER J LOCATED 1980 FEET FROM THE East LINE AND 1650 FEET FROM THE South LINE OF SEC. 7 TWP. 23S RGE. 34E NMPM		12. County LEA	
19. Proposed Depth 14,810'		19A. Formation Devonion	20. Rotary or C.T. Rotary
21. Elevations (Show whether DF, RT, etc.) 3497' GR (est.)	21A. Kind & Status Plug. Bond	21B. Drilling Contractor	22. Approx. Date Work will start November 1, 1980

PROPOSED CASING AND CEMENT PROGRAM

SIZE OF HOLE	SIZE OF CASING	WEIGHT PER FOOT	SETTING DEPTH	SACKS OF CEMENT	EST. TOP
26"	20"	94#	1100'	18213K	Circ.
17 1/2"	13 3/8"	61#	5000'	35815K	Circ.
12 1/4"	9 5/8"	43.5#	12,000'	28475K	4900'
8 1/2"	7 3/4" liner	39#	11500' - 14000'	2725K	11500'
6 1/2"	5 1/2" liner	23#	11000' - 14810'	3535K	11000'

It is proposed to drill a straight hole to a TD of 14,810' and complete it as a Devonion gas well.

See attachment for BOP specifications.

Gas is dedicated to a purchaser

APPROVAL VALID FOR 90 DAY
PERMIT EXPIRES 7/6/81
UNLESS DRILLING UNDERWAY

IN ABOVE SPACE DESCRIBE PROPOSED PROGRAM; IF PROPOSAL IS TO DEEPEN OR PLUG BACK, GIVE DATA ON PRESENT PRODUCTIVE ZONE AND PROPOSED NEW PRODUCTIVE ZONE. GIVE BLOWOUT PREVENTER PROGRAM, IF ANY.

I hereby certify that the information above is true and complete to the best of my knowledge and belief.

Signed Al E. Bingham Title Administrative Supervisor Date October 2, 1980

(This space for State Use)

Orig. Signed by

Lee Clements

APPROVED BY Lee Clements TITLE Oil & Gas Inspector DATE Oct 8 1980

CONDITIONS OF APPROVAL, IF ANY:

ent

RECEIVED

OCT 3 1980

OFFICE OF THE ATTORNEY GENERAL

RECEIVED

OCT 7 1980

OFFICE OF THE ATTORNEY GENERAL

NEW MEXICO OIL CONSERVATION COMMISSION
WELL LOCATION AND ACREAGE DEDICATION PLAT

Form C-102
Supersedes C-128
Effective 1-1-65

All distances must be from the outer boundaries of the Section.

Operator Conoco Inc.		Lease Bell Lake Unit		Well No. 20
Unit Letter J	Section 7	Township 23 south	Range 34 east	County Lea
Actual Footage Location of Well: 1980 feet from the east line and 1650 feet from the south line				
Ground Level Elev. 3500.9	Producing Formation Devonion	Pool Bell Lake Devonion North	Dedicated Acreage: 640 Acres	

- Outline the acreage dedicated to the subject well by colored pencil or hatchure marks on the plat below.
- If more than one lease is dedicated to the well, outline each and identify the ownership thereof (both as to working interest and royalty).
- If more than one lease of different ownership is dedicated to the well, have the interests of all owners been consolidated by communitization, unitization, force-pooling, etc?

☐ Yes ☐ No If answer is "yes," type of consolidation _____

If answer is "no," list the owners and tract descriptions which have actually been consolidated. (Use reverse side of this form if necessary.) _____

No allowable will be assigned to the well until all interests have been consolidated (by communitization, unitization, forced-pooling, or otherwise) or until a non-standard unit, eliminating such interests, has been approved by the Commission.

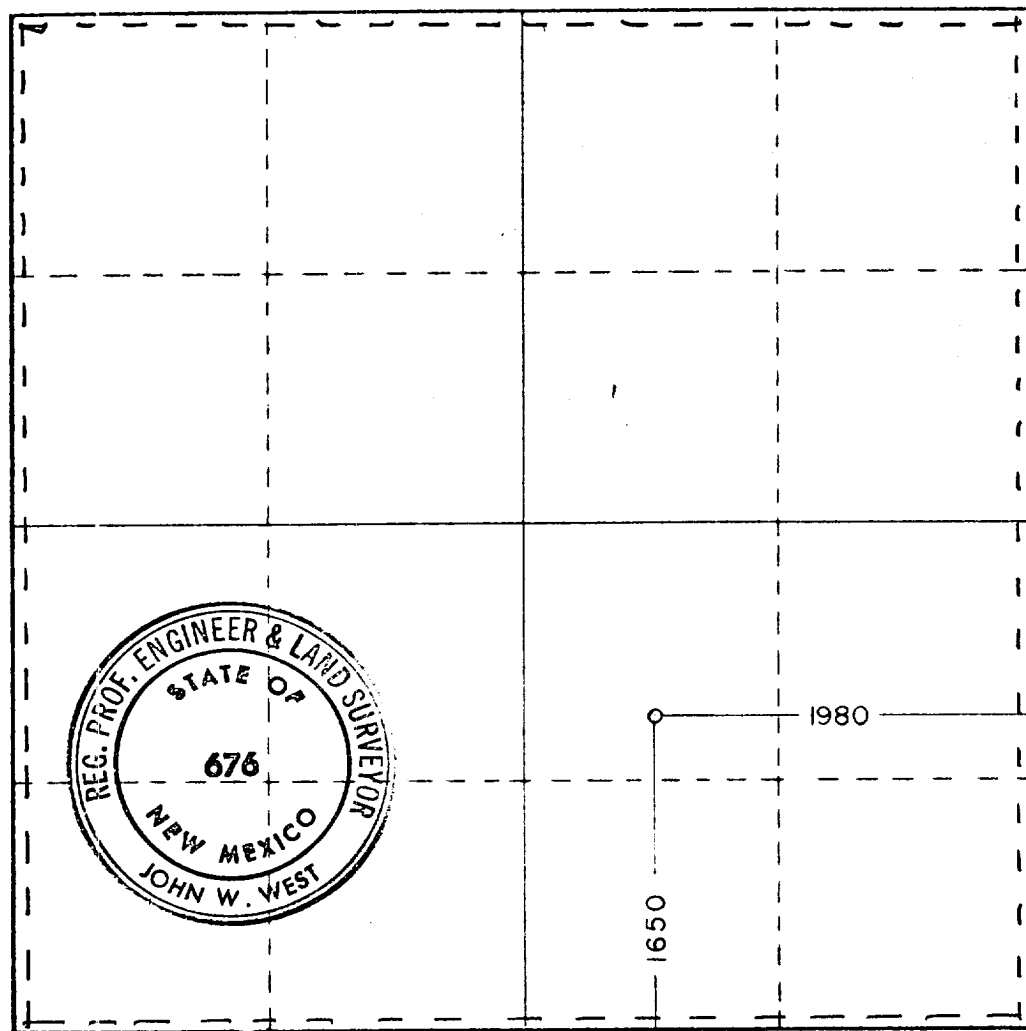

CERTIFICATION

I hereby certify that the information contained herein is true and complete to the best of my knowledge and belief.

Name
A. E. Bingham

Position
Senior Analyst

Company
Conoco Inc.

Date
10/1/80

I hereby certify that the well location shown on this plat was plotted from field notes of actual surveys made by me or under my supervision, and that the same is true and correct to the best of my knowledge and belief.

Date Surveyed
9-12-80

Registered Professional Engineer and/or Land Surveyor

John W. West

Certificate No. **JOHN W. WEST 676**
PATRICK A. ROMERO 8863
Ronald J. Eldson 3239

RECEIVED

OCT 3 1980

DEPT. OF JUSTICE

RECEIVED

OCT 7 1980

DEPT. OF JUSTICE

CONTINENTAL OIL COMPANY
Blow-out Preventer Specifications

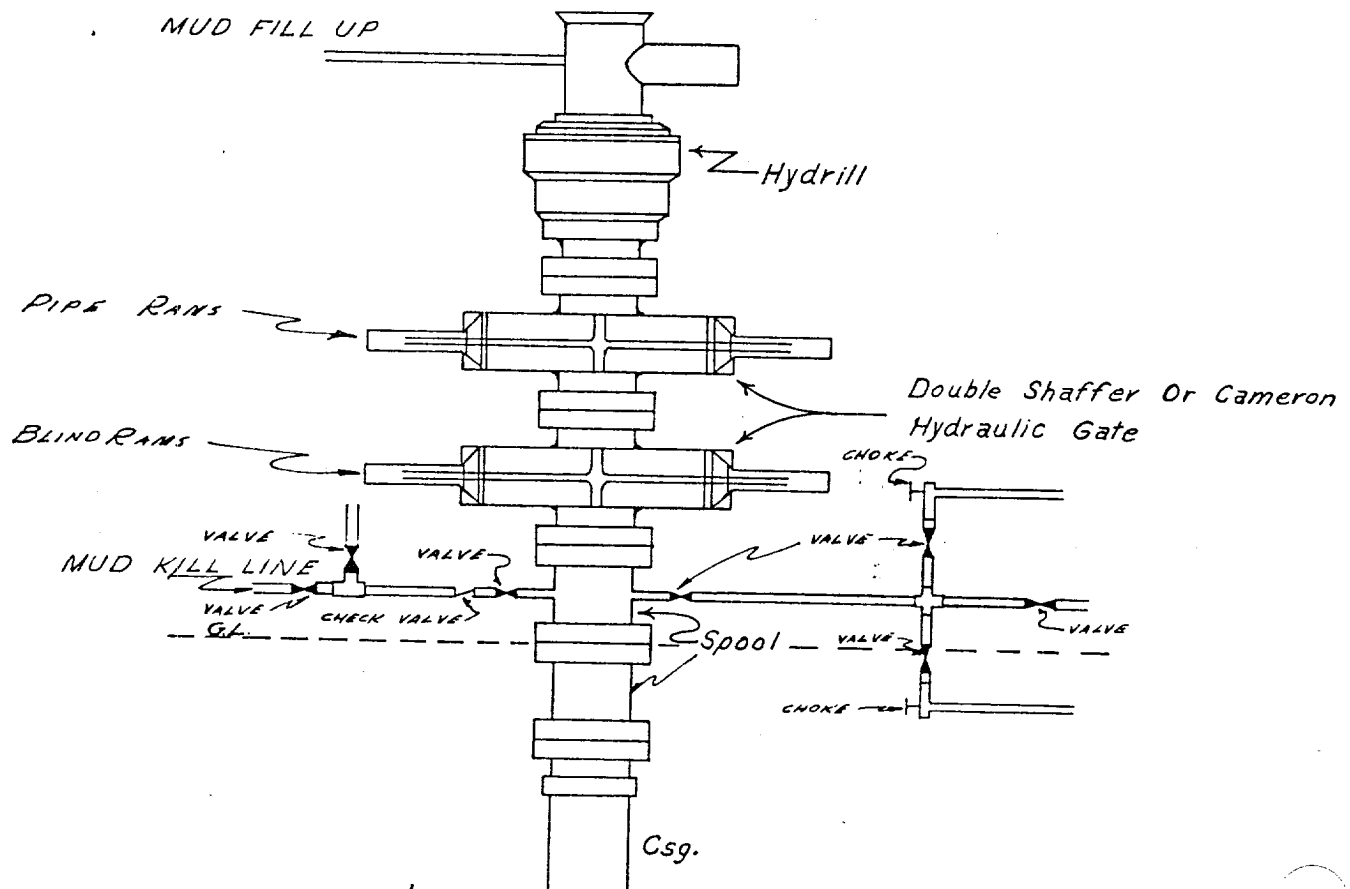

NOTE:

Manual and Hydraulic controls with closing unit no less than 75' from well head.
Remote controls on rig floor.

**DUE TO SUBSTRUCTURE CLEARANCE,
HYDRILL MAY OR MAY NOT BE USED.**