

30-125-27103

NO. OF COPIES RECEIVED	
DISTRIBUTION	
SANTA FE	
FILE	
U.S.G.S.	
LAND OFFICE	
OPERATOR	

NEW MEXICO OIL CONSERVATION COMMISSION

Form C-101
Revised 1-1-65*Revised location*

5A. Indicate Type of Lease	
STATE <input type="checkbox"/>	FEE <input checked="" type="checkbox"/>
5. State Oil & Gas Lease No.	

APPLICATION FOR PERMIT TO DRILL, DEEPEN, OR PLUG BACK

1a. Type of Work		7. Unit Agreement Name	
b. Type of Well OIL WELL <input checked="" type="checkbox"/> GAS WELL <input type="checkbox"/> OTHER <input type="checkbox"/>		8. Farm or Lease Name McQuatters	
2. Name of Operator Amoco Production Company		9. Well No. 6	
3. Address of Operator P.O. Box 68, Hobbs, New Mexico 88240		10. Field and Pool, or Wildcat Hardy Drinkard	
4. Location of Well UNIT LETTER <u>C</u> LOCATED <u>330</u> FEET FROM THE <u>North</u> LINE AND <u>1830</u> FEET FROM THE <u>West</u> LINE OF SEC. <u>12</u> TWP. <u>21-S</u> RGE. <u>36-E</u> NMPM		12. County Lea	
19. Proposed Depth 6900'		19A. Formation Drinkard	
20. Rotary or C.T. Rotary		21. Elevations (Show whether DF, RT, etc.) 3514.7' GL	
21A. Kind & Status Plug. Bond Blanket-on-file		21B. Drilling Contractor NA	
22. Approx. Date Work will start 8-15-81			

23.

PROPOSED CASING AND CEMENT PROGRAM

SIZE OF HOLE	SIZE OF CASING	WEIGHT PER FOOT	SETTING DEPTH	SACKS OF CEMENT	EST. TOP
17-1/2"	13-3/8"	48#	1300'	circulate	surf
12-1/4"	*9-5/8"	36#	5100	Tie back to 13-3/8"	surf
8-3/4"	7"	20,23,26#	4800'-6900'	circ. at 4800'	Btm. 9-5/8"

* 9-5/8" intermediate will be run only if lost circulation occurs above top of Glorieta Gas Zone. If no lost circulation is encountered above top of Glorieta, will reduce hole size to 8-3/4" and run 7" casing from surface to TD. Cement will tie back to 13-3/8" casing.

Propose to drill and equip well in the Drinkard formation. After reaching TD, logs will be run and evaluated. Stimulate and perforate as necessary in attempting commercial production.

Mud Program: 0-1300' Native mud and fresh water
1300'-TD Commercial mud and brine with minimum properties for safe hole conditions.

BOP program attached

IN ABOVE SPACE DESCRIBE PROPOSED PROGRAM: IF PROPOSAL IS TO DEEPEN OR PLUG BACK, GIVE DATA ON PRESENT PRODUCTIVE ZONE AND PROPOSED NEW PRODUCTIVE ZONE. GIVE BLOWOUT PREVENTER PROGRAM, IF ANY.

I hereby certify that the information above is true and complete to the best of my knowledge and belief.

Signed Mark Randolph Title Asst. Administrative Analyst Date 7-13-81

(This space for State Use)

SUPERVISOR DISTRICT I

JUL 20 1981

APPROVED BY [Signature] TITLE _____ DATE _____
CONDITIONS OF APPROVAL, IF ANY:

ATTACHMENT "B"
NOTES

1. Blow-out preventers and master valve to be fluid operated and oil fittings must be in good condition, 3,000# W.P. (6,000 p.s.i. test), minimum.
2. Equipment through which bit must pass shall be as large as the inside diameter of the casing that is being drilled through.
3. Nipple above blow-out preventer shall be same size as casing being drilled through.
4. Kelly cock required, 3,000# W.P. (6,000 p.s.i. test) minimum.
5. OMSCO or comparable safety valve must be available on rig floor at all times with proper connection or sub, 3,000# W.P. (6,000 p.s.i. test), minimum.
6. Blow-out preventers and master valve while drilling intermediate hole to 6000' may be 2,000# W.P. (4,000 p.s.i. test), minimum.
7. Choke assembly, beyond second valve from cross, may be positioned (Optional) outside of derrick foundation.
8. Spool or cross may be eliminated if connections are available in the lower part of the blow-out preventer body.
9. Plug valves - gate valves are optional. Valves shown as 2" are minimum size.
10. Casing head and casing head spool, including attached valves, to be furnished by Amoco.
11. Rams in preventers will be installed as follows:

When drilling, use:	When running casing, use:
Top Preventer - Drill pipe rams	Top Preventer - Casing rams
Bottom Preventer - Blind rams or master valve	Bottom Preventer - Blind rams or master valve

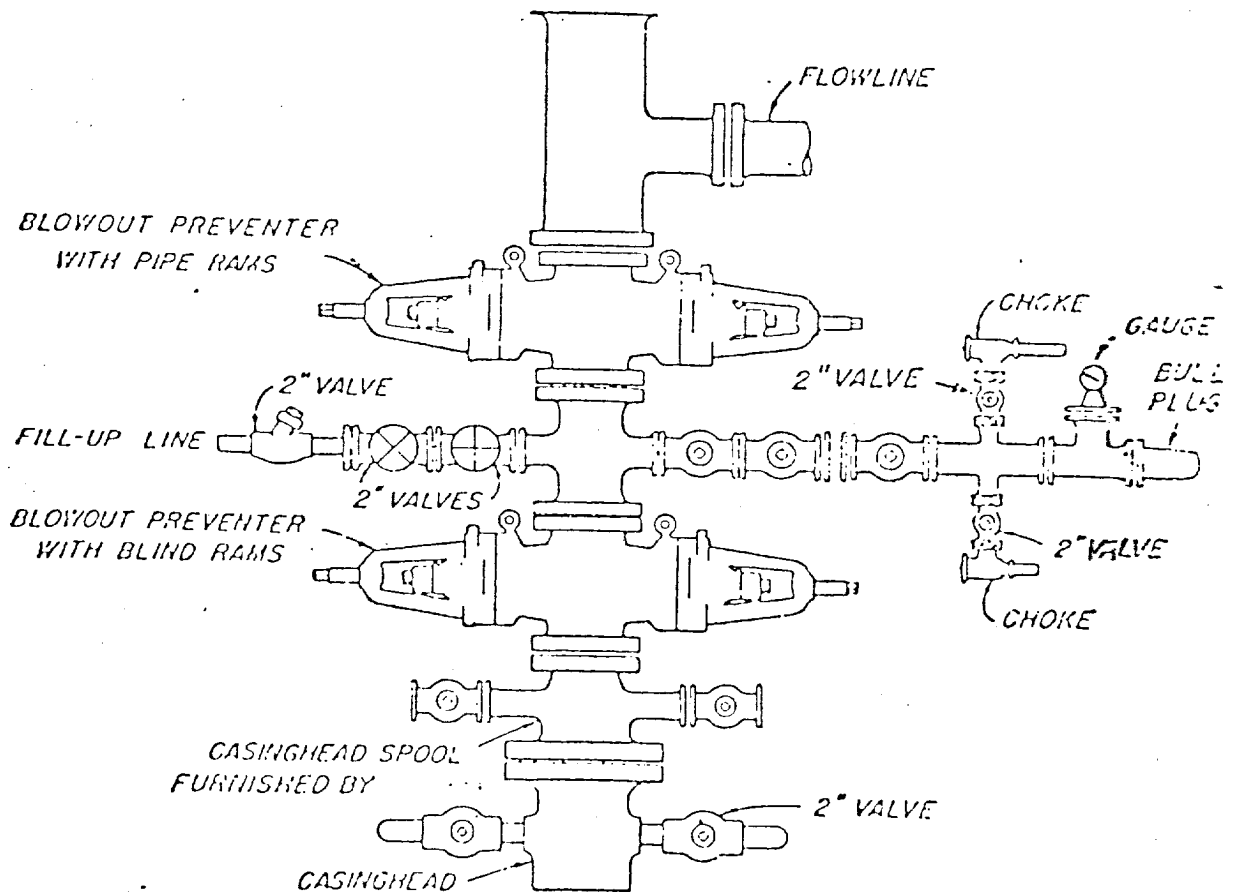

BLOWOUT PREVENTER HOOK-UP

AMOCO PRODUCTION COMPANY

EXHIBIT D-1 MODIFIED

JUNE 1, 1962

**NEW MEXICO OIL CONSERVATION COMMISSION
WELL LOCATION AND ACREAGE DEDICATION PLAT**

Form C-102
Supersedes C-128
Effective 1-1-65

All distances must be from the outer boundaries of the Section.

Operator Amoco Production Co.			Lease McQuatters		Well No. 6
Unit Letter C	Section 12	Township 21South	Range 36East	County Lea	
Actual Footage Location of Well: 330 feet from the North line and 1830 feet from the West line					
Ground Level Elev. 3511.8'	Producing Formation Drinkard		Pool Hardy Drinkard		Dedicated Acreage: 40 Acres

1. Outline the acreage dedicated to the subject well by colored pencil or hatchure marks on the plat below.
2. If more than one lease is dedicated to the well, outline each and identify the ownership thereof (both as to working interest and royalty).
3. If more than one lease of different ownership is dedicated to the well, have the interests of all owners been consolidated by communitization, unitization, force-pooling, etc?

☐ Yes ☐ No If answer is "yes," type of consolidation _____

If answer is "no," list the owners and tract descriptions which have actually been consolidated. (Use reverse side of this form if necessary.) _____

No allowable will be assigned to the well until all interests have been consolidated (by communitization, unitization, forced-pooling, or otherwise) or until a non-standard unit, eliminating such interests, has been approved by the Commission.

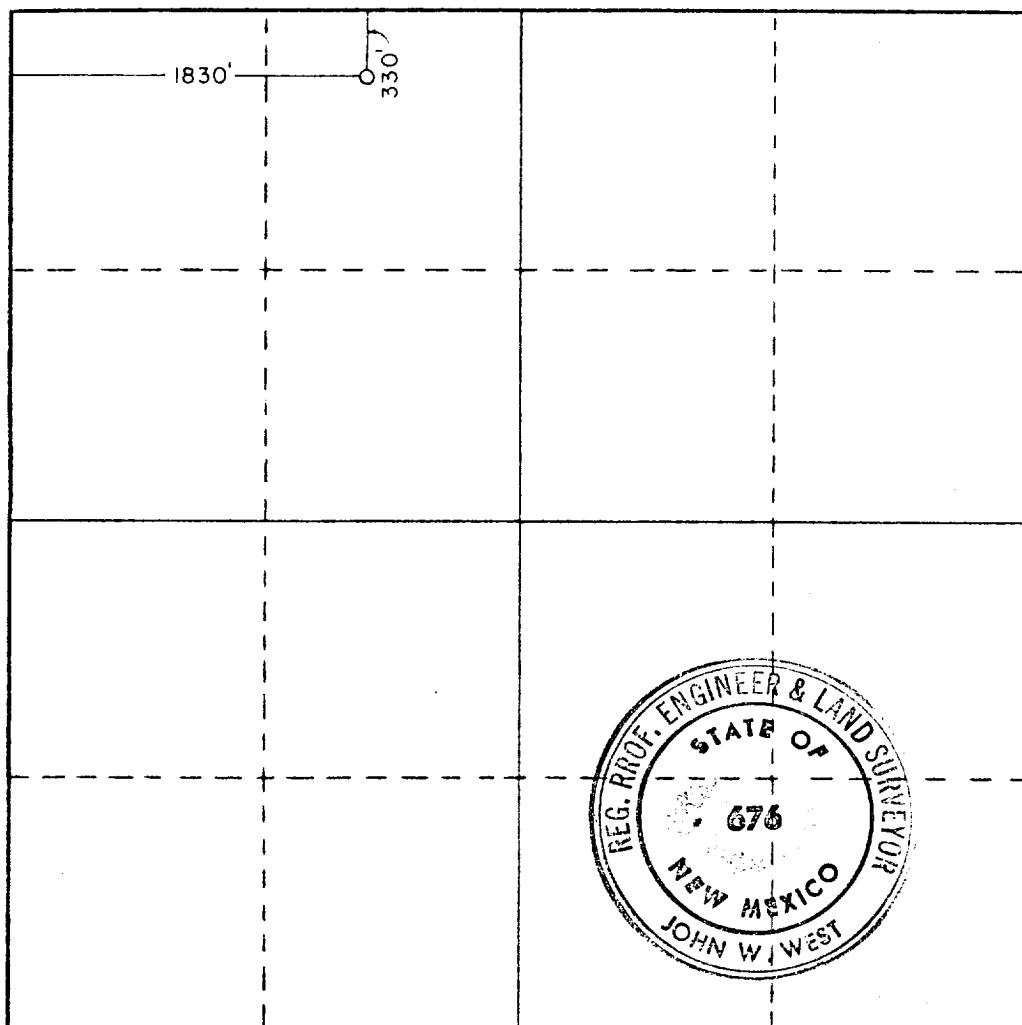

CERTIFICATION

I hereby certify that the information contained herein is true and complete to the best of my knowledge and belief.

Name
Mark Randolph
Position
Asst. Admin. Analyst
Company
Amoco Production Company
Date
7-13-81

I hereby certify that the well location shown on this plat was plotted from field notes of actual surveys made by me or under my supervision, and that the same is true and correct to the best of my knowledge and belief.

Date Surveyed
Sept. 29, 1980

Registered Professional Engineer and/or Land Surveyor

John W. West

Certificate No. **JOHN W. WEST 676**
PATRICK A. ROMERO 6868
Ronald J. Eidson 3239

0 330 660 990 1320 1650 1980 2310 2640 2970 3300 3630 3960 4290 4620 4950 5280 5610 5940 6270 6600

RECEIVED

JUL 17 1981

OIL CONSERVATION DIV

RECEIVED

JUL 15 1981

OIL CONSERVATION DIV