

NEW MEXICO OIL CONSERVATION COMMISSION
WELL LOCATION AND ACREAGE DEDICATION PLAT

All distances must be from the outer boundaries of the Section

Shell Oil Co.		State B. Con.		2
J	36	24 South	36 East	Lea County, N.M.
1650	feet from the South	line and	1980	feet from the East
3267.7	Producing Formation	Devonian	Custer(Devonian)	380 Acres

- Outline the acreage dedicated to the subject well by colored pencil or hatchure marks on the plat below.
- If more than one lease is dedicated to the well, outline each and identify the ownership thereof (both as to working interest and royalty)
- If more than one lease of different ownership is dedicated to the well, have the interests of all owners been consolidated by communitization, unitization, force-pooling, etc?

☐ Yes ☐ No If answer is "yes," type of consolidation Communitization

If answer is "no," list the owners and tract descriptions which have actually been consolidated (Use reverse side of this form if necessary.)

No allowable will be assigned to the well until all interests have been consolidated (by communitization, unitization, forced-pooling, or otherwise) or until a non-standard unit, eliminating such interests, has been approved by the Commission.

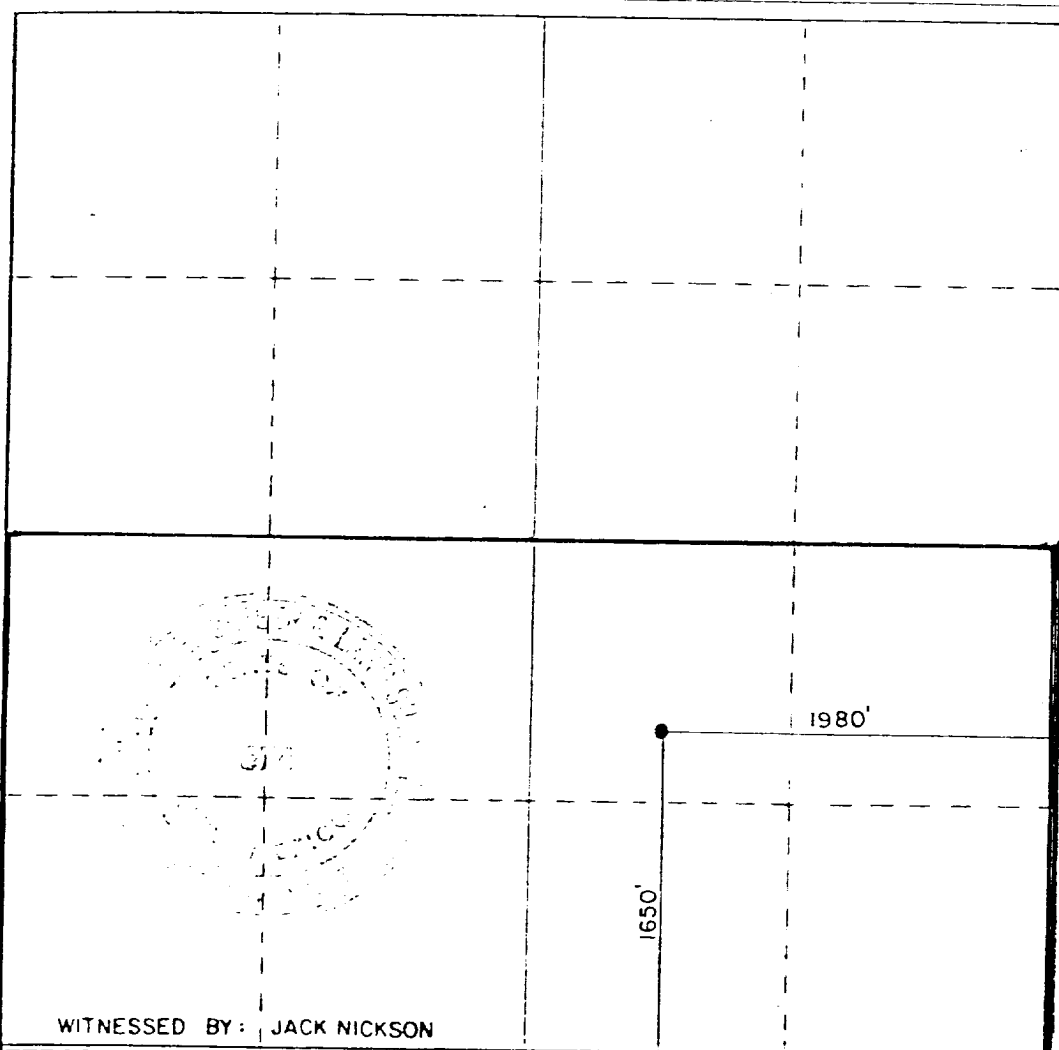

CERTIFICATION

I hereby certify that the information contained herein is true and complete to the best of my knowledge and belief.

A.J. Fore A.J. Fore
Supervisor Regulatory & Permits
Shell Oil Company
July 13, 1981

I hereby certify that the well location shown on this plat was plotted from field notes of actual surveys made by me or under my supervision and that the same is true and correct to the best of my knowledge and belief.

Date Surveyed: 12-7-80

Registered Professional Engineer and or Land Surveyor

John W. West

Certificate No. JOHN W. WEST 676
PATRICK A. ROMERO 6868
Ronald J. Eidson 3239

WITNESSED BY: JACK NICKSON

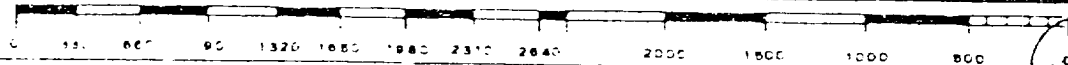

**MEXICO OIL CONSERVATION COMMISSION
WELL LOCATION AND ACREAGE DEDICATION PLAT**

Form C-102
Supersedes C-128
Effective 1-1-65

All distances must be from the outer boundaries of the Section

Lessee Shell Oil Co.			Lease State B. Com.			Well No. 2		
Section J	Section 36	Range 24 South	Range 36 East	County Lea County, N.M.				
Actual Field Location of Well: 1650 feet from the South line and 1980 feet from the East line								
Ground Level Elev. 3267.7	Producing Formation Ellenburger		Pool Custer(Ellenburger)			Estimated Acreage: 320 Acres		

1. Outline the acreage dedicated to the subject well by colored pencil or hatchure marks on the plat below.
2. If more than one lease is dedicated to the well, outline each and identify the ownership thereof (both as to working interest and royalty).
3. If more than one lease of different ownership is dedicated to the well, have the interests of all owners been consolidated by communitization, unitization, force-pooling, etc?

☐ Yes ☐ No If answer is "yes," type of consolidation _____

If answer is "no," list the owners and tract descriptions which have actually been consolidated. (Use reverse side of this form if necessary.) _____

No allowable will be assigned to the well until all interests have been consolidated (by communitization, unitization, forced-pooling, or otherwise) or until a non-standard unit, eliminating such interests, has been approved by the Commission.

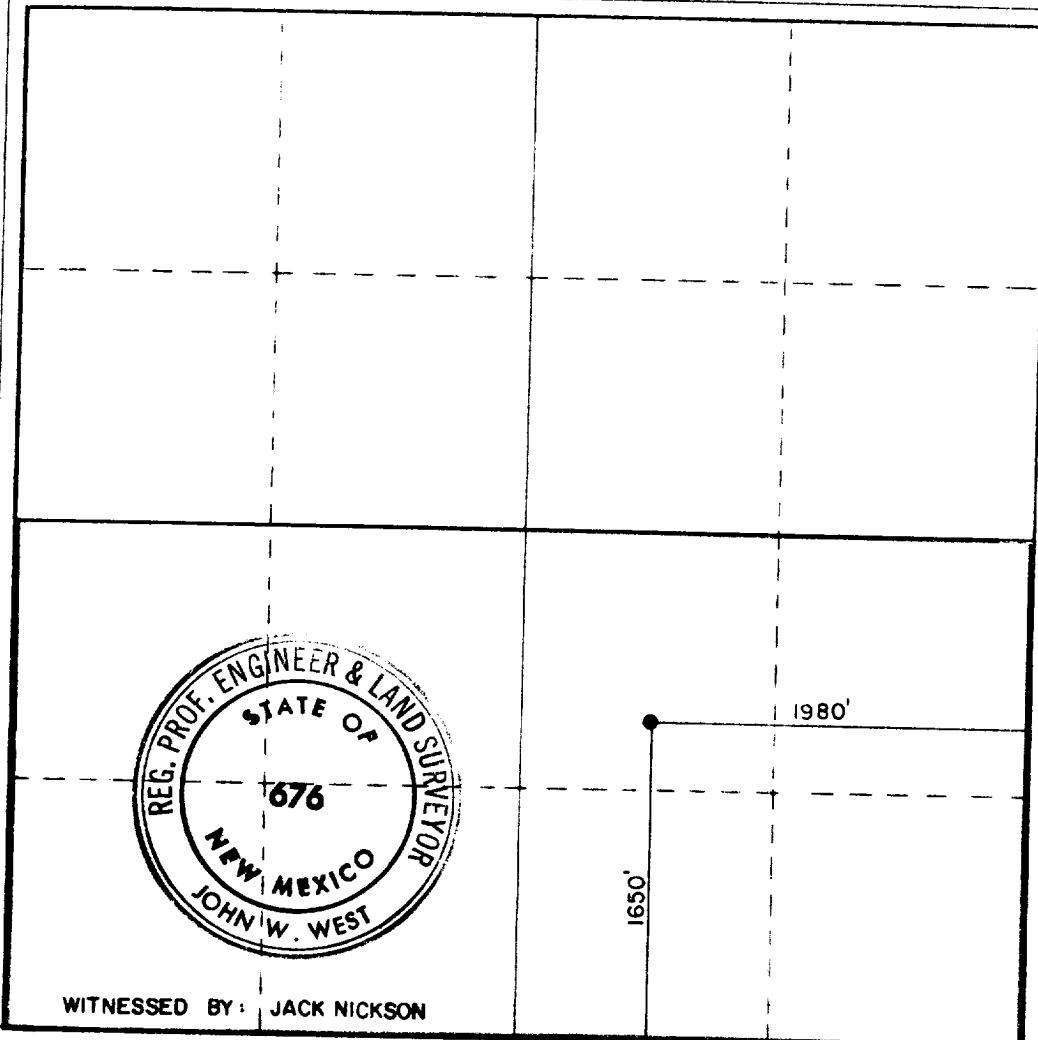

WITNESSED BY: JACK NICKSON

CERTIFICATION

I hereby certify that the information contained herein is true and complete to the best of my knowledge and belief

M. Boatman
Name for

A.J. Fore

Position

Supervisor-Reg & Permits

Company

Shell Oil Company

Date

December 30, 1980

I hereby certify that the well location shown on this plat was plotted from field notes of actual surveys made by me or under my supervision, and that the same is true and correct to the best of my knowledge and belief.

Date Surveyed

12-7-80

Registered Professional Engineer and/or Land Surveyor

John W. West

Certificate No. **JOHN W. WEST 676**
PATRICK A. ROMERO 6663
Ronald J. Eldson 3239

0 330 660 990 1320 1650 1980 2310 2640 2000 1500 1000 500

RECEIVED

JAN 5 1981

OIL CONSERVATION DIV.

173