

20-025-27457

STATE OF NEW MEXICO
ENERGY AND MINERALS DEPARTMENT

OIL CONSERVATION DIVISION

P. O. BOX 2088

SANTA FE, NEW MEXICO 87501

Form C-101
Revised 10-1-78

NO. OF COPIES RECEIVED	
DISTRIBUTION	
SANTA FE	
FILE	
U.S.G.S.	
LAND OFFICE	
OPERATOR	

5A. Indicate Type of Lease	
STATE <input checked="" type="checkbox"/>	FEE <input type="checkbox"/>
5. State Oil & Gas Lease No.	
E-1921	

APPLICATION FOR PERMIT TO DRILL, DEEPEN, OR PLUG BACK

1a. Type of Work

DRILL ☒DEEPEN ☐PLUG BACK ☐

b. Type of Well

OIL WELL ☒GAS WELL ☐

OTHER

SINGLE ZONE ☒MULTIPLE ZONE ☐

2. Name of Operator

Casing Pullers, Inc.

3. Address of Operator

c/o Oil Reports & Gas Services, P. O. Box 763, Hobbs, NM 88240

4. Location of Well

UNIT LETTER M LOCATED 66C FEET FROM THE South LINEAND 660 FEET FROM THE West LINE OF SEC. 29 TWP. 21S RGE. 35E NMPM

7. Unit Agreement Name

8. Farm or Lease Name

Yates ^{15A}

9. Well No.

8

10. Field and Pool, or Wildcat

N. San Simon - Yates

12. County

Lea

11. Elevations (Show whether DE, RI, etc.)	21A. Kind & Status Plug. Bond	19. Proposed Depth	19A. Formation	20. Rotary or C.T.
3625.1 GR	One Well	3950	Yates	Rotary
21B. Drilling Contractor		22. Approx. Date Work will start		
Collier Drlg. Co.		6/25/81		

23.

PROPOSED CASING AND CEMENT PROGRAM

SIZE OF HOLE	SIZE OF CASING	WEIGHT PER FOOT	SETTING DEPTH	SACKS OF CEMENT	EST. TOP
11"	8 5/8"	24#	290	150	Circ.
7 7/8	5 1/2	14#	3760	650	Circ.

To complete openhole, treat as necessary.

Blowout preventor to be adequate for depth & area.

APPROVAL VALID FOR 180 DAYS
 PERMIT EXPIRES 9/12/81
 UNLESS DRILLING UNDERWAY.

4. ABOVE SPACE DESCRIBE PROPOSED PROGRAM; IF PROPOSAL IS TO DEEPEN OR PLUG BACK, GIVE DATA ON PRESENT PRODUCTIVE ZONE AND PROPOSED NEW PRODUCTIVE ZONE. GIVE BLOWOUT PREVENTER PROGRAM, IF ANY.

hereby certify that the information above is true and complete to the best of my knowledge and belief.

Signed Norma Walker Title Agent Date 6/12/81

(This space for State Use)

APPROVED BY [Signature] TITLE [Signature] DATE [Signature]

CONDITIONS OF APPROVAL, IF ANY:

**NEW MEXICO OIL CONSERVATION COMMISSION
WELL LOCATION AND ACREAGE DEDICATION PLAT**

Form C-102
Supersedes C-128
Effective 1-1-65

All distances must be from the outer boundaries of the Section.

Operator Casing Pullers, Inc.,			Lease Yates A		Well No. 8
Unit Letter M	Section 29	Township 21 South	Range 35 East	County Lea	

Actual Footage Location of Well:

660 feet from the **south** line and **660** feet from the **west** line

Ground Level Elev. 3625.1	Producing Formation Yates	Pool North San Simon	Dedicated Acreage: 40 Acres
-------------------------------------	-------------------------------------	--------------------------------	---------------------------------------

1. Outline the acreage dedicated to the subject well by colored pencil or hachure marks on the plat below.
2. If more than one lease is dedicated to the well, outline each and identify the ownership thereof (both as to working interest and royalty).
3. If more than one lease of different ownership is dedicated to the well, have the interests of all owners been consolidated by communitization, unitization, force-pooling, etc?

☐ Yes ☐ No If answer is "yes," type of consolidation _____

If answer is "no," list the owners and tract descriptions which have actually been consolidated. (Use reverse side of this form if necessary.) _____

No allowable will be assigned to the well until all interests have been consolidated (by communitization, unitization, forced-pooling, or otherwise) or until a non-standard unit, eliminating such interests, has been approved by the Commission.

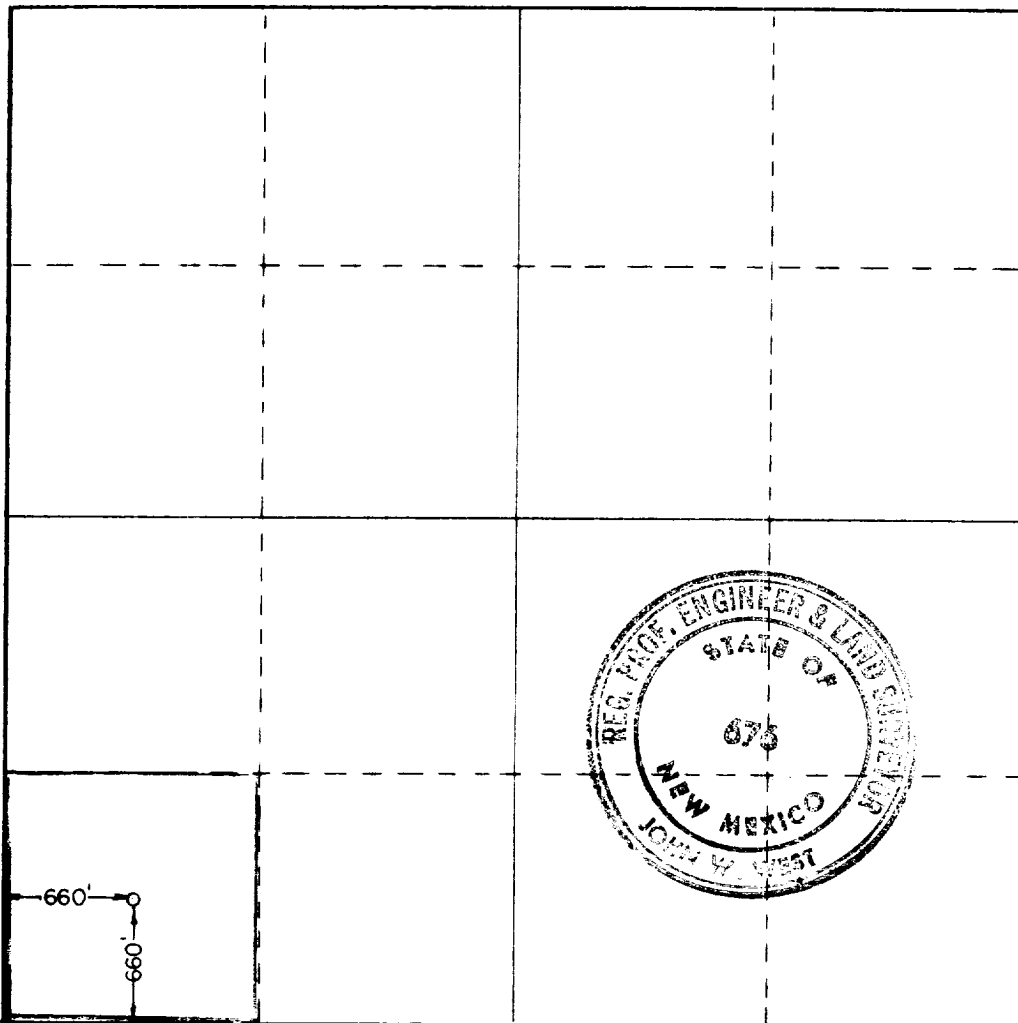

CERTIFICATION

I hereby certify that the information contained herein is true and complete to the best of my knowledge and belief.

Patrick A. Romero

Name

Agent

Position

Casing Pullers, Inc.

Company

June 12, 1981

Date

I hereby certify that the well location shown on this plat was plotted from field notes of actual surveys made by me or under my supervision, and that the same is true and correct to the best of my knowledge and belief.

Date Surveyed

May 23, 1981

Registered Professional Engineer
and/or Land Surveyor

John W. West

Certificate No.	JOHN W. WEST	676
	PATRICK A. ROMERO	6885
	Ronald J. Eidson	3239

