

NO. OF COPIES RECEIVED	
DISTRIBUTION	
SANTA FE	
FILE	
U.S.G.S.	
LAND OFFICE	
OPERATOR	

# NEW MEXICO OIL CONSERVATION COMMISSION

045 - NMOCD, P.O. Box 1980 1 - Foreman  
Hobbs, NM 88240 1 - WIO-Lamerada  
1 - Midland-Admin Unit 1 - File  
1 - Engr. - DW

Form C-101  
Revised 1-1-65

5A. Indicate Type of Lease  
STATE ☒ FEE ☐

5. State Oil & Gas Lease No.

## APPLICATION FOR PERMIT TO DRILL, DEEPEN, OR PLUG BACK

1a. Type of Work		7. Unit Agreement Name	
b. Type of Well DRILL <input checked="" type="checkbox"/> DEEPEN <input type="checkbox"/> PLUG BACK <input type="checkbox"/> OIL WELL <input type="checkbox"/> GAS WELL <input checked="" type="checkbox"/> OTHER <input type="checkbox"/> SINGLE ZONE <input type="checkbox"/> MULTIPLE ZONE <input type="checkbox"/>		8. Farm or Lease Name Berry 5 State Comm.	
2. Name of Operator Getty Oil Company		9. Well No. 2	
3. Address of Operator P.O. Box 730 Hobbs, NM 88240		10. Field and Pool, or Wildcat Undesignated	
4. Location of Well UNIT LETTER <u>G</u> LOCATED <u>1980</u> FEET FROM THE <u>East</u> LINE <u>3300</u> FEET FROM THE <u>South</u> LINE OF SEC. <u>5</u> TWP. <u>21S</u> RGE. <u>34E</u> NMPM		11. County Lea	
19. Proposed Depth 14,250		19A. Formation Morrow	
20. Rotary or C.T. Rotary		21. Elevation (Show whether DE, RT, etc.) 3724.7 GL	
21A. Kind & Status Plug. Bond Blanket Bond		21B. Drilling Contractor Pending	
22. Approx. Date Work will start Pending			

23.

## PROPOSED CASING AND CEMENT PROGRAM

SIZE OF HOLE	SIZE OF CASING	WEIGHT PER FOOT	SETTING DEPTH	SACKS OF CEMENT	EST. TOP
26"	20	94	40	Ready Mix	Surface
17 1/2"	13 3/8	48	1100	1200 sx	"
12 1/4"	9 5/8	36&40	5700	3000 sx.	"
8 1/2"	7	26	11800	2000sx.	"
6 1/8"	4 1/2	13.5	14250	350 sx.	Liner Top

- The above casing program will be used to drill the Morrow formation and any other productive formations. The mud system will be fresh water from surface to 500', and brine and brackish water from 500' to 11,000'. An inverted oil base mud system will be used from 11,100' to 13,400'. The Morrow will be perforated selectively according to electric logs.
- See attachment for BOP's and choke manifold.

APPROVAL VALID FOR 180 DAYS  
PERMIT EXPIRES 12/21/81  
UNLESS DRILLING UNDERWAY

IN ABOVE SPACE DESCRIBE PROPOSED PROGRAM: IF PROPOSAL IS TO DEEPEN OR PLUG BACK, GIVE DATA ON PRESENT PRODUCTIVE ZONE AND PROPOSED NEW PRODUCTIVE ZONE. GIVE BLOWOUT PREVENTER PROGRAM, IF ANY.

I hereby certify that the information above is true and complete to the best of my knowledge and belief.

Signed Dale R. Crockett Title Area Superintendent Date October 16, 1981

(This space for State Use)

APPROVED BY PJB TITLE Area Superintendent DATE OCT 21 1981

CONDITIONS OF APPROVAL, IF ANY:

Rotating Head, If Necessary,  
Furnished By Getty

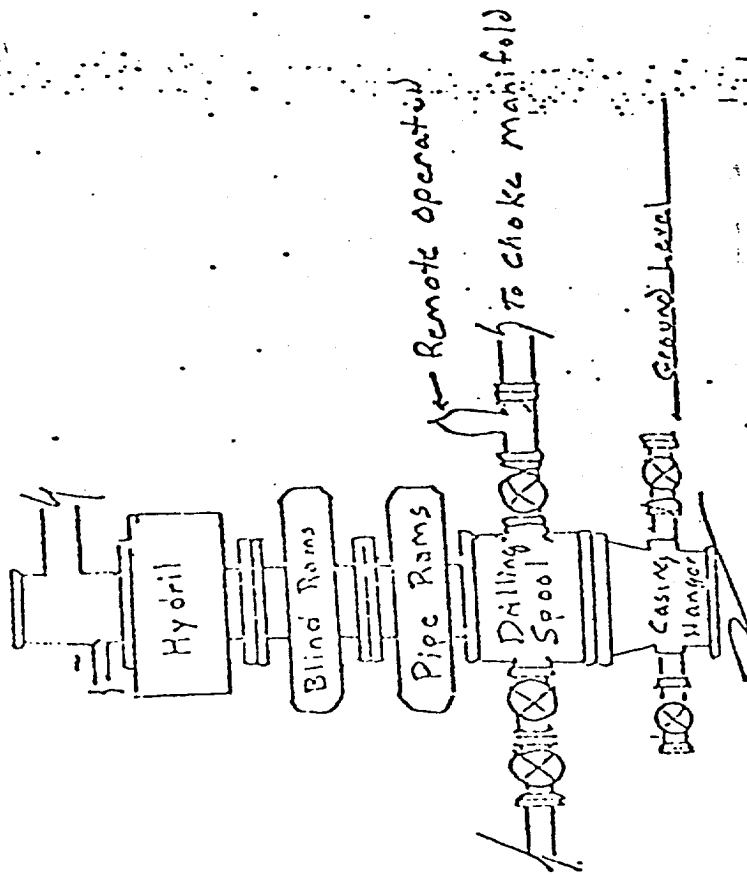

All 5000 psi W.P.

The above stack and manifold system will be used after setting 13 3/8" casing on all other strings.

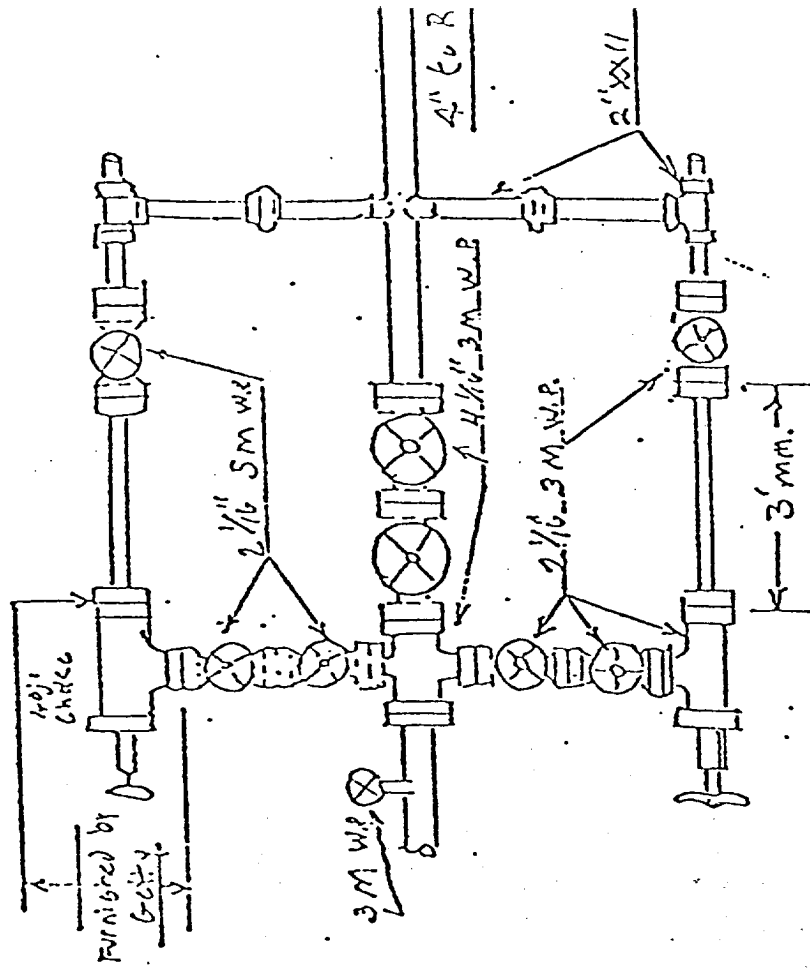

MANIFOLD SHOWN IS MINIMUM THAT IS ACCEPTABLE

**MEXICO OIL CONSERVATION COMMISSION  
WELL LOCATION AND ACREAGE DEDICATION PLAT**

Form C-102  
Supersedes C-128  
Effective 1-1-65

All distances must be from the outer boundaries of the Section.

Operator <b>GETTY OIL COMPANY</b>			Lease <b>Berry 5 State Comm</b>		Well No. <b>2</b>
Unit Letter <b>G</b>	Section <b>5</b>	Township <b>21 South</b>	Range <b>34 East</b>	County <b>Lea</b>	
Actual Footage Location of Well: <b>3300</b> feet from the <b>South</b> line and <b>1980</b> feet from the <b>East</b> line					
Ground Level Elev. <b>3724.7</b>	Producing Formation <b>MORROW</b>	Pool <i>With Berry Morrow</i> <b>Undesignated</b>		Dedicated Acreage: <b>320</b> Acres	

1. Outline the acreage dedicated to the subject well by colored pencil or hachure marks on the plat below.
2. If more than one lease is dedicated to the well, outline each and identify the ownership thereof (both as to working interest and royalty).
3. If more than one lease of different ownership is dedicated to the well, have the interests of all owners been consolidated by communitization, unitization, force-pooling, etc?

☒ Yes    ☐ No    If answer is "yes," type of consolidation communitization

If answer is "no," list the owners and tract descriptions which have actually been consolidated. (Use reverse side of this form if necessary.) \_\_\_\_\_

No allowable will be assigned to the well until all interests have been consolidated (by communitization, unitization, forced-pooling, or otherwise) or until a non-standard unit, eliminating such interests, has been approved by the Commission.

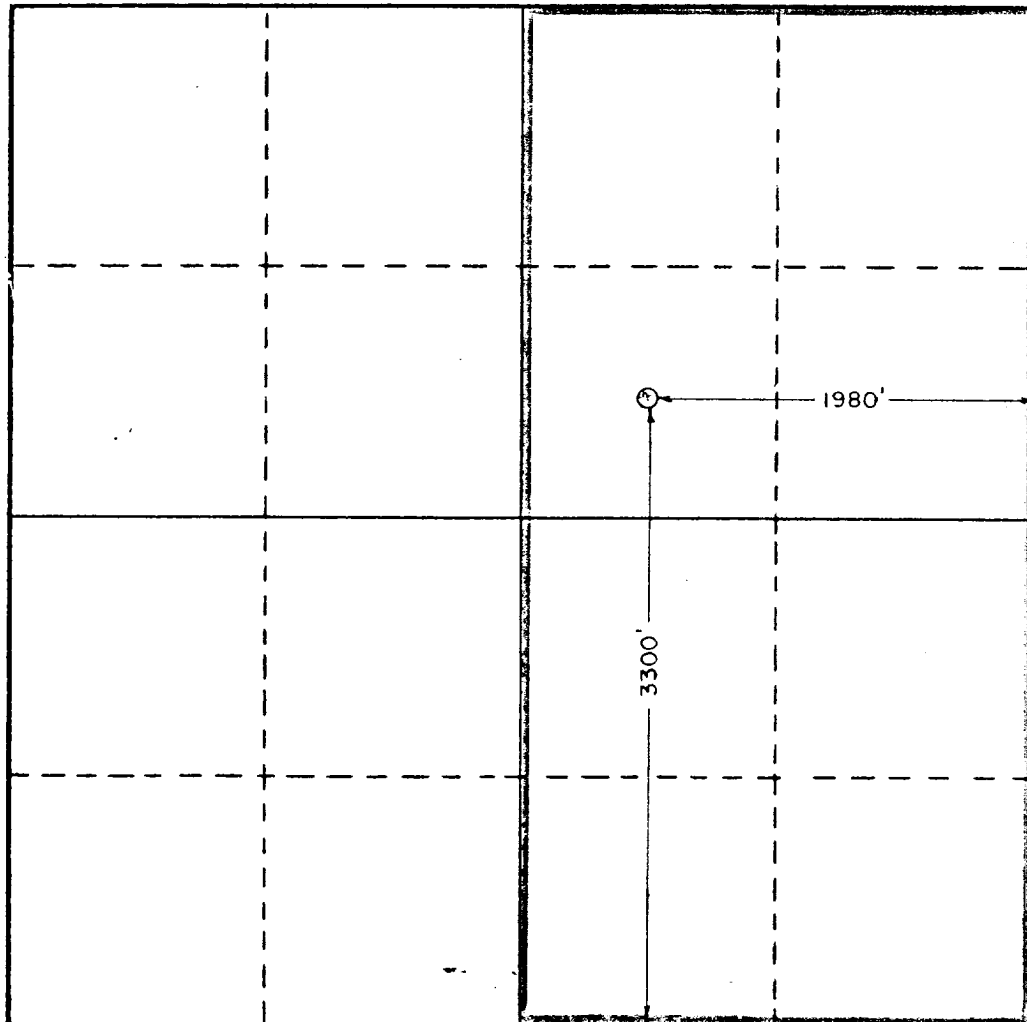

**CERTIFICATION**

I hereby certify that the information contained herein is true and complete to the best of my knowledge and belief.

*Dale R. Crockett*

Name

**Dale R. Crockett**

Position

**Area Superintendent**

Company

**Getty Oil Company**

Date

**October 16, 1981**

I hereby certify that the well location shown on this plat was plotted from field notes. Actual location may be me or under my supervision and that the same is true and correct to the best of my knowledge and belief.



Date Surveyed

**10-09-81**

Registered Professional Engineer and/or Land Surveyor

*Herschel L. Jones*

Certificate No.

**3640**

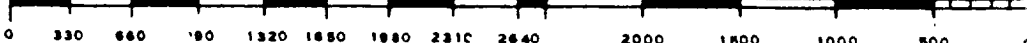

111

RECEIVED

OCT 20 1981

U.S. DEPARTMENT OF JUSTICE