

South Central Region
P. O. Box 26124
Albuquerque, New Mexico 87125

JAN 26 1982

Getty Oil Company
P. O. Box 730
Hobbs, New Mexico 88240

Gentlemen:

Your Application for Permit to Drill well No. 2 Bilbrey Federal in the SE $\frac{1}{4}$ NW $\frac{1}{4}$ sec. 33, T. 21 S., R. 32 E., N.M.P.M. Lea County, New Mexico, lease NM-14332, to a depth of 15,000 feet to test the Morrow formation in the Oil-Potash area, is hereby approved, as amended by stipulations attached to the application.

One copy of the application is returned herewith. Please notify the Supervisory Petroleum Engineering Technician, Geological Survey, Hobbs, New Mexico, in sufficient time for a representative to witness all cementing operations.

Sincerely yours,

(ORIG. SCD.) MICHAEL F. REITZ

FOR Deputy Conservation Manager
Oil and Gas

Enclosure

cc: ✓ NMOCD, Hobbs (2) (w/enclosures)

1. The first of these is the fact that the
the government has a duty to protect the
the public from the effects of the

the government has a duty to protect the

the government has a duty to protect the

the government has a duty to protect the

the government has a duty to protect the
the government has a duty to protect the
the government has a duty to protect the
the government has a duty to protect the

the government has a duty to protect the
the government has a duty to protect the
the government has a duty to protect the
the government has a duty to protect the

the government has a duty to protect the

the government has a duty to protect the

HCH

the government has a duty to protect the

the government has a duty to protect the

RECEIVED

JAN 27 1982

EX. INFORMATION DIV

10/1/82

6-USGS-HOBBS

1-DRLG.FOREMAN

N.M.O.C.D. COPY

1-ENGR-PB

7-WIO'S

1-FILE
Form 9-331C
(May 1983)

SUBMIT IN TR CATE*

Form approved.
Budget Bureau No. 42-R1425.(Other instructions on
reverse side)UNITED STATES
DEPARTMENT OF THE INTERIOR
GEOLOGICAL SURVEY

APPLICATION FOR PERMIT TO DRILL, DEEPEN, OR PLUG BACK

1a. TYPE OF WORK

DRILL ☒DEEPEN ☐PLUG BACK ☐

b. TYPE OF WELL

OIL
WELL ☐GAS
WELL ☒

OTHER

SINGLE
ZONE ☒MULTIPLE
ZONE ☐

2. NAME OF OPERATOR

Getty Oil Company

3. ADDRESS OF OPERATOR

PO Box 730, Hobbs, New Mexico 88240

4. LOCATION OF WELL (Report location clearly and in accordance with any State requirements*)

At surface

Unit Ltr. F 1980' FNL and 1980' FWL, Section 33

At proposed prod. zone

T-21S, R-32-E, Lea County, New Mexico

14. DISTANCE IN MILES AND DIRECTION FROM NEAREST TOWN OR POST OFFICE*

Twenty five miles West of Eunice, New Mexico

15. DISTANCE FROM PROPOSED*

LOCATION TO NEAREST
PROPERTY OR LEASE LINE, FT.
(Also to nearest drlg. unit line, if any)

1980'

16. NO. OF ACRES IN LEASE

640

17. NO. OF ACRES ASSIGNED
TO THIS WELL

320

18. DISTANCE FROM PROPOSED LOCATION*

TO NEAREST WELL, DRILLING, COMPLETED,
OR APPLIED FOR, ON THIS LEASE, FT.

NONE

19. PROPOSED DEPTH

15,000

20. ROTARY OR CABLE TOOLS

Rotary

21. ELEVATIONS (Show whether DF, RT, GR, etc.)

3722.9 GR

22. APPROX. DATE WORK WILL START*

Sept. 1, 1981

23. PROPOSED CASING AND CEMENTING PROGRAM

SIZE OF HOLE	SIZE OF CASING	WEIGHT PER FOOT	SETTING DEPTH	QUANTITY OF CEMENT
26	20	94	40	Ready Mix CIRCULATE
17 1/2	13 3/8	48	500	500 sxs. CIRCULATE
12 1/4	9 5/8	36 & 40	4800	2050 sxs. CIRCULATE
8 1/2	7	23 & 26	13000	1575 sxs.
6 1/8	4 1/2	13.5	12500-15000	300 sxs.

- The subject well will be drilled from surface to 13,000 with brine of sufficient weight and gel additives to control formation pressures and condition the hole for electric logs and running of casing. The mud will be a 10-12 ppg. oil base low solids low fluid loss mud from 13,000' to 15,000' (TD). (Fresh water will be used for the drilling fluid from surface to 500').
- The pump and plug method will be used in cementing all strings of casing. The 13 3/8", 9 5/8", and 7" casing will be cemented to the surface. The 4 1/2" liner will be set at TD with the top at approximately 12,500' inside the 7" casing and cemented from bottom to top.
- See attachment for BOP program.

IN ABOVE SPACE DESCRIBE PROPOSED PROGRAM: If proposal is to deepen or plug back, give data on present productive zone and proposed new productive zone. If proposal is to drill or deepen directionally, give pertinent data on subsurface locations and measured and true vertical depths. Give blowout preventer program, if any.

24.

SIGNED

Dale R. Crockett

TITLE

Area Superintendent

DATE

7-31-81

(This space for Federal or State office use)

PERMIT NO.

APPROVAL DATE

APPROVED BY

TITLE

DATE

CONDITIONS OF APPROVAL, IF ANY:

**NEW MEXICO OIL CONSERVATION COMMISSION
WELL LOCATION AND ACREAGE DEDICATION PLAT**

Form C-162
Supersedes C-128
Effective 1-1-65

All distances must be from the outer boundaries of the Section

Operator GETTY OIL COMPANY		Lease Billbrey 22 Federal 22		Well No. 2
Section "E"	Section 33	Township 21 South	Range 32 East	County Lea County, NM

Actual Footage Location of Well:

1250 feet from the **North** line and 1250 feet from the **West** line

Ground Level Elev 3722.4'	Producing Formation Morrow	Pool Undesignated Morrow	Dedicated Acreage: 320 Acres
-------------------------------------	--------------------------------------	------------------------------------	--

- Outline the acreage dedicated to the subject well by colored pencil or hatchure marks on the plat below.
- If more than one lease is dedicated to the well, outline each and identify the ownership thereof (both as to working interest and royalty).
- If more than one lease of different ownership is dedicated to the well, have the interests of all owners been consolidated by communitization; unitization, force-pooling, etc?

☒ Yes ☐ No If answer is "yes," type of consolidation Working Unit

If answer is "no," list the owners and tract descriptions which have actually been consolidated. (Use reverse side of this form if necessary.) _____

No allowable will be assigned to the well until all interests have been consolidated (by communitization, unitization, forced-pooling, or otherwise) or until a non-standard unit, eliminating such interests, has been approved by the Commission.

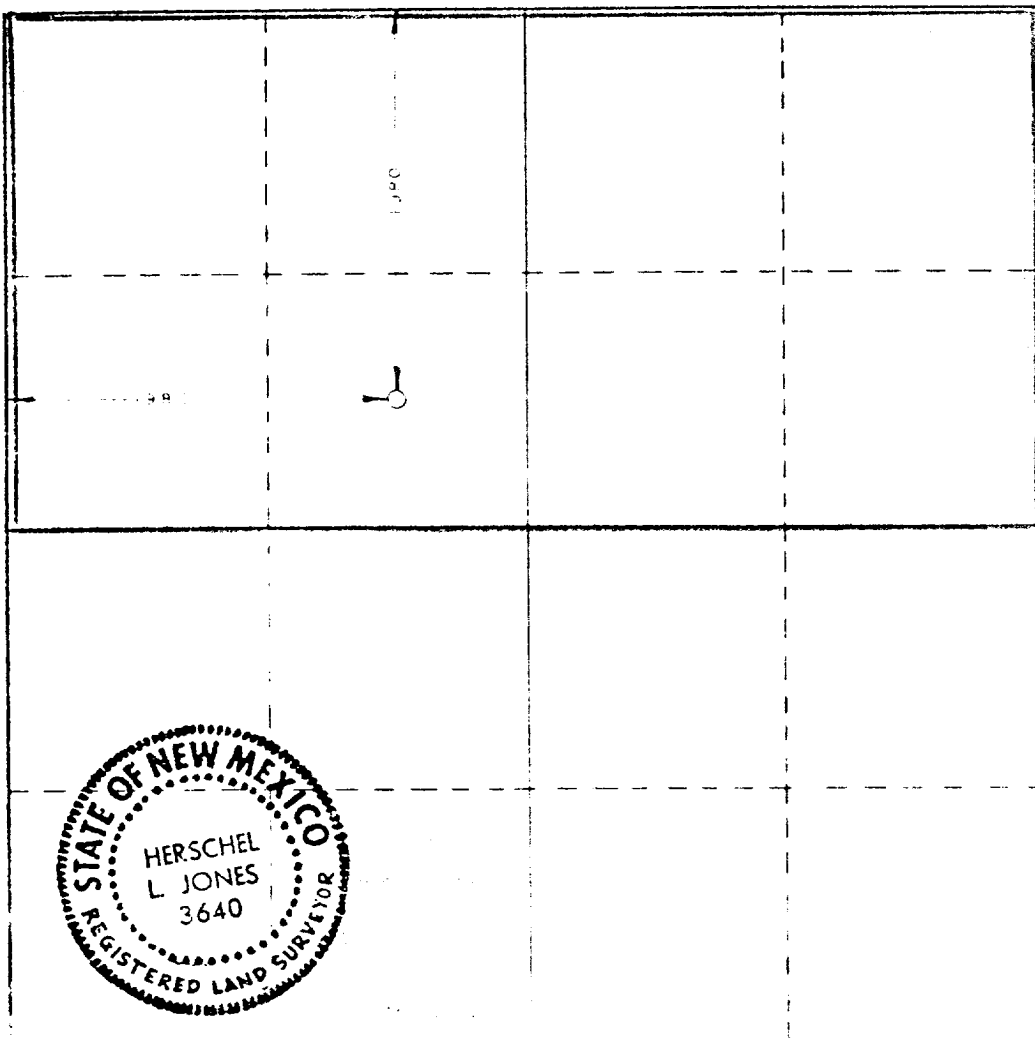

CERTIFICATION

I hereby certify that the information contained herein is true and complete to the best of my knowledge and belief.

Name
Dale R. Crockett
for Dale R. Crockett
Position
Area Superintendent

Company
Getty Oil Company

Date
7-30-81

I hereby certify that the well location shown on this plat was plotted from field notes of actual surveys made by me or under my supervision, and that the same is true and correct to the best of my knowledge and belief.

Date Surveyed
July 2, 1981

Registered Engineer or Registered Land Surveyor

Certificate No.

RECEIVED

JAN 27 1982

U.S. CONSERVATION DIV.

U.S. CONSERVATION DIV.