

P. O. BOX 1980

HOBBS, N. MEXICO 88240

DEPARTMENT OF THE INTERIOR

GEOLOGICAL SURVEY

SUBMIT IN TRIPLICATE*

(Other instructions
reverse side)Form approved.
Budget Bureau No. 42-R1425.

30-025-27731

5. LEASE DESIGNATION AND SERIAL NO.

NM-1311 19858

6. IF INDIAN, ALLOTTEE OR TRIBE NAME

7. UNIT AGREEMENT NAME

8. FARM OR LEASE NAME

Andrikopoulous Federal

9. WELL NO.

1

10. FIELD AND POOL, OR WILDCAT

UNDESIGNATED

11. SEC., T., R., M., OR BLK.
AND SURVEY OR AREA

Sec. 35, T24S, R33E

12. COUNTY OR PARISH

Lea

13. STATE

New Mexico

1a. TYPE OF WORK

DRILL ☒DEEPEN ☐PLUG BACK ☐

b. TYPE OF WELL

OIL
WELL ☐GAS
WELL ☒

OTHER

SINGLE
ZONE ☒MULTIPLE
ZONE ☐

2. NAME OF OPERATOR

THE SUPERIOR OIL COMPANY

3. ADDRESS OF OPERATOR

P.O. Box 4500, The Woodlands, Texas 77380

4. LOCATION OF WELL (Report location clearly and in accordance with any State requirements.*)

At surface

1980' FNL & 1980' FEL of Section 35

At proposed prod. zone

straight hole

14. DISTANCE IN MILES AND DIRECTION FROM NEAREST TOWN OR POST OFFICE*

32 miles East, Northeast of Jal, New Mexico

15. DISTANCE FROM PROPOSED*

LOCATION TO NEAREST
PROPERTY OR LEASE LINE, FT.
(Also to nearest drlg. unit line, if any)

1980

16. NO. OF ACRES IN LEASE

1440

17. NO. OF ACRES ASSIGNED
TO THIS WELL

320

18. DISTANCE FROM PROPOSED LOCATION*
TO NEAREST WELL, DRILLING, COMPLETED,
OR APPLIED FOR, ON THIS LEASE, FT.

None

19. PROPOSED DEPTH

16,500

20. ROTARY OR CABLE TOOLS

Rotary

21. ELEVATIONS (Show whether DF, RT, GR, etc.)

3509.7

22. APPROX. DATE WORK WILL START*

3-15-82

23.

PROPOSED CASING AND CEMENTING PROGRAM

SIZE OF HOLE	SIZE OF CASING	WEIGHT PER FOOT	SETTING DEPTH	QUANTITY OF CEMENT
	30"	309#	40'	Redi-mix to surface
22"	16"	65# H-40	580'	1100 sx Class "C" to surface
14-3/4"	10-3/4"	45.5# K-55	5130'	2700 sx Class "C" & Lite
9-1/2"	7-5/8"	33.7# S-95	13150'	625 sx Class "H"
6-1/2"	5"	18# N-80	16100'	360 sx Class "H" & "POZ"

SEE ATTACHED FOR: SUPPLEMENTAL DRILLING DATA - (10 Point Plan)
SURFACE USE AND OPERATIONS PLAN - (13 Point Plan)
ARCHAEOLOGICAL CLEARANCE REPORT

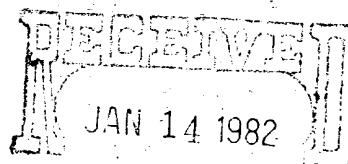
GAS NOT DEDICATEDOIL & GAS
U.S. GEOLOGICAL SURVEY
ROSWELL, NEW MEXICO

IN ABOVE SPACE DESCRIBE PROPOSED PROGRAM: If proposal is to deepen or plug back, give data on present productive zone and proposed new productive zone. If proposal is to drill or deepen directionally, give pertinent data on subsurface locations and measured and true vertical depths. Give blowout preventer program, if any.

24.

SIGNED

G. Bannantine
G. Bannantine

TITLE Regulatory Group Mgr.

DATE January 8, 1982

(This space for Federal or State office use)

PERMIT NO.

APPROVED

APPROVAL DATE

APPROVED BY

CONDITIONS OF APPROVAL, IF ANY:

JAN 8 1982

JAMES A. GILLHAM
DISTRICT SUPERVISOR

TITLE

APPROVAL SUBJECT TO
GENERAL REQUIREMENTS AND
SPECIAL STIPULATIONS
ATTACHED

DATE

MEXICO OIL CONSERVATION COMMISSION
WELL LOCATION AND ACREAGE DEDICATION PLAT

Form O-1
Supersedes O-128
Effective 10-85

All distances must be from the outer boundaries of the Section.

Operator The Superior Oil Co.		Lease Andri Kopoulous		Well No. 1
Unit Letter G	Section 35	Township 24 South	Range 33 East	County Lea
Actual Footage Location of Well: 1980 feet from the North line and 1980 feet from the East line				
Ground Level Elev. 3509.7'	Producing Formation Morrow	Pool Wildcat	Dedicated Acreage: 320	

1. Outline the acreage dedicated to the subject well by colored pencil or hachure marks on the plat below.
2. If more than one lease is dedicated to the well, outline each and identify the ownership thereof (both as to working interest and royalty).
3. If more than one lease of different ownership is dedicated to the well, have the interests of all owners been consolidated by communitization, unitization, force-pooling, etc?

☐ Yes ☒ No If answer is "yes," type of consolidation _____

If answer is "no," list the owners and tract descriptions which have actually been consolidated. (Use reverse side of this form if necessary.) _____

No allowable will be assigned to the well until all interests have been consolidated (by communitization, unitization, forced-pooling, or otherwise) or until a non-standard unit, eliminating such interests, has been approved by the Commission.

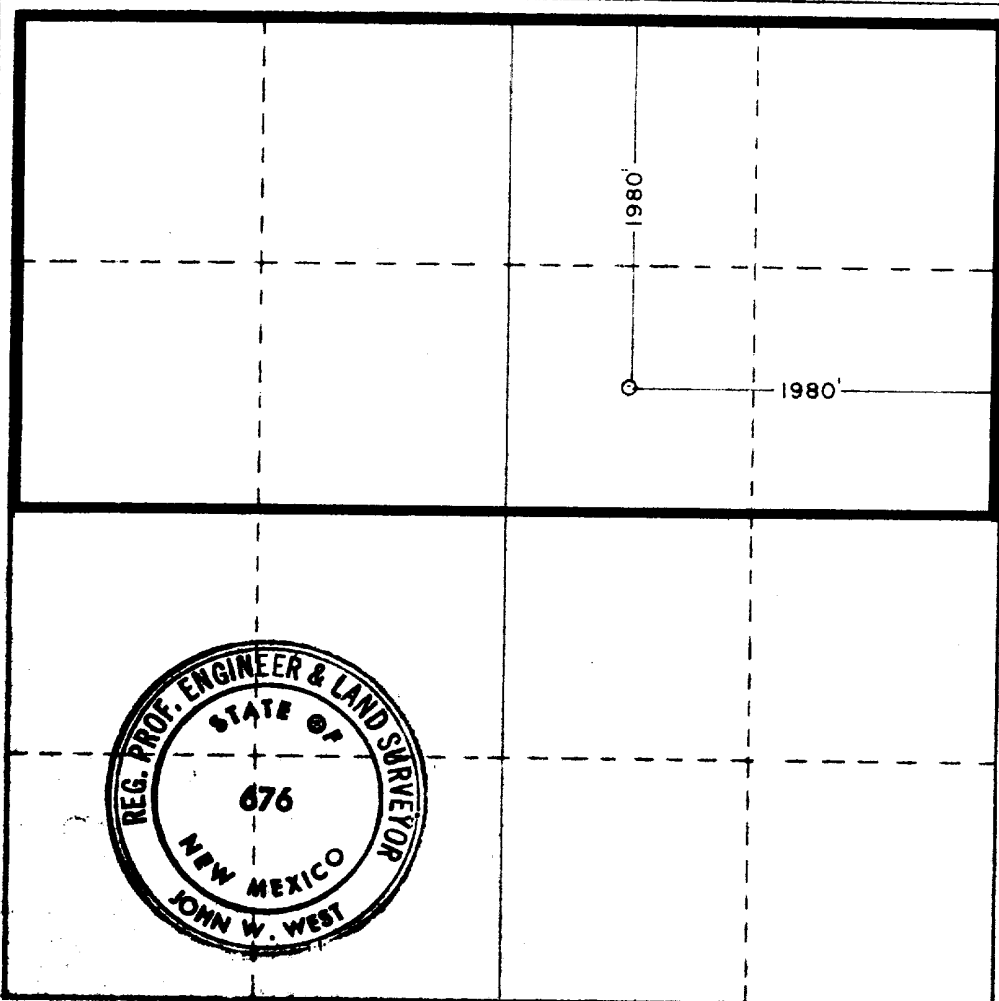

CERTIFICATION

I hereby certify that the information contained herein is true and complete to the best of my knowledge and belief.

G. Bannantine

Name
G. Bannantine
Position
Regulatory Group Manager
Company
The Superior Oil Company
Date
January 8, 1982

I hereby certify that the well location shown on this plat was plotted from field notes of actual surveys made by me or under my supervision, and that the same is true and correct to the best of my knowledge and belief.

Date Surveyed
Dec, 10, 1981
Registered Professional Engineer
and/or Land Surveyor

John W. West

Certificate No. JOHN W. WEST 676
PATRICK A. ROMERO 6863
Ronald J. Eidson 3239

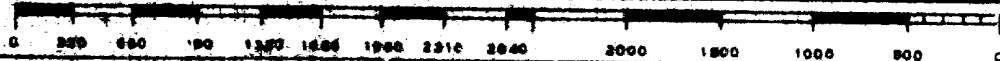

DOUBLE PREVENTER OPTION

(6)

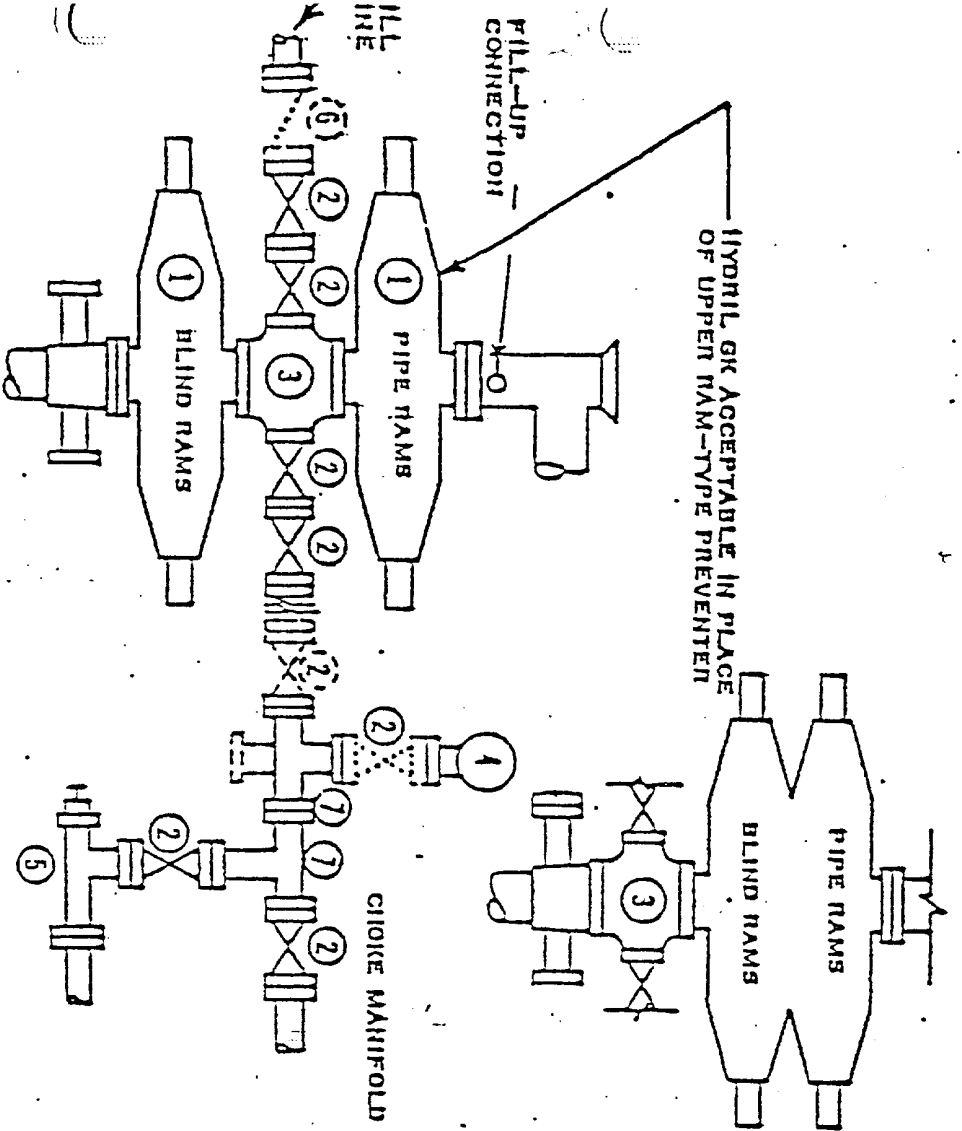

- ① SERIES 900 RAM-TYPE BOP
- ② 2" SERIES 900 VALVE
- ③ SERIES 900 DRILLING SPOOL
- ④ 2" MUD PRESSURE GAUGE
- ⑤ 2" SERIES 900 CHOKE
- ⑥ 2" SERIES 900 CHECK VALVE
- ⑦ 2" SERIES 900 STEEL TEE

NOTES:

1. 3000 PSI WP CLAMP
HUBS MAY BE SUBSTITUTED
FOR FLANGES
2. VALVES MAY BE EITHER HAND OR POWER
OPERATED BUT, IF POWER OPERATED,
THE VALVES FLANGED TO THE BOP HUB
MUST BE CAPABLE OF BEING OPERED AND
CLOSED MANUALLY OR CLOSE ON POWER
FAILURE AND BE CAPABLE OF BEING
OPENED MANUALLY

..... OPTIONAL EQUIPMENT

3000 PSI WORKING PRESSURE
BLOWOUT PREVENTER HOOK-UP
(SERIES 900 FLANGES OR BETTER)

OPTIONAL EQUIPMENT

DOUBLE PREVENTER OPTION

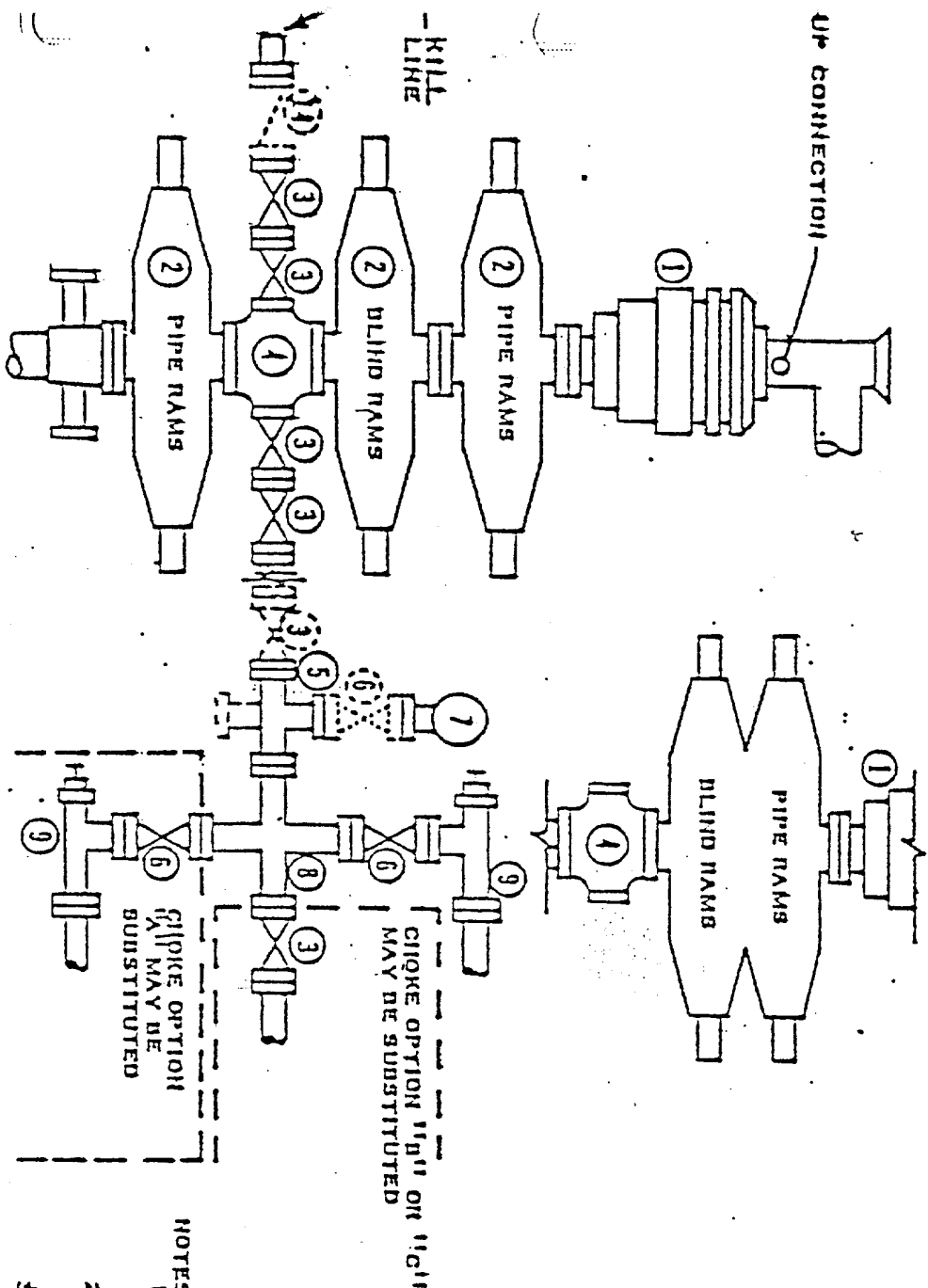

NOTES

1. 5000 PSI WP ON BETTER CLAMP FLANGES MAY BE SUBSTITUTED FOR FLANGES
2. ONE ADJUSTABLE CHOKES MAY BE REPLACED WITH A POSITIVE CHOKES
3. VALVES MAY BE EITHER HAND OR POWER, OPERATED BUT, IF POWER OPERATED, THE VALVES FLANGED TO THE BOP MUST BE CAPABLE OF BEING OPENED AND CLOSED MANUALLY OR CLOSE ON POWER FAILURE AND BE CAPABLE OF BEING OPENED MANUALLY

- (1) 3ER, 1500 HYDRIL CK
- (2) 3ER, 1500 RAM-TYPE BOP (8)
- (3) 3" 3ER, 1500 VALVE
- (4) 3ER, 1500 DRILLING SPOOL
- (5) 3" 3ER, 1500 X 2" 3ER, 1500 STEEL TEE
- (6) 2" 3ER, 1500 VALVE
- (7) 2" 3ER, 1500 PRESSURE GAUGE
- (8) 3" 3ER, 1500 X 2" 3ER, 1500 STEEL CROSS
- (9) 2" 3ER, 1500 ADJ. CHOKES
- (10) 2" 3ER, 1500 ADJ. CHOKES ON 2" 3ER, 1500 HYDRIL VALVE ON SIDE OUTLET OF 2" 3ER, 1500 STEEL TEE
- (11) ADAPTER, 2" 3ER, 1500 X 10,000 LB W FLANGE MATING (12) INLET
- (12) 10,000 LB WP REMOTE CHOKES
- (13) HYDRAULIC CHOKES, 2500 LB WP ON BETTER
- (14) 3" 3ER, 1500 CHECK VALVE

5000 PSI WORKING PRESSURE
BLOWOUT PREVENTER 1100K-UP

(SERIES 1500 FLANGES OR BETTER)

..... OPTIONAL EQUIPMENT

DOUBLE PREVENTER OPTION

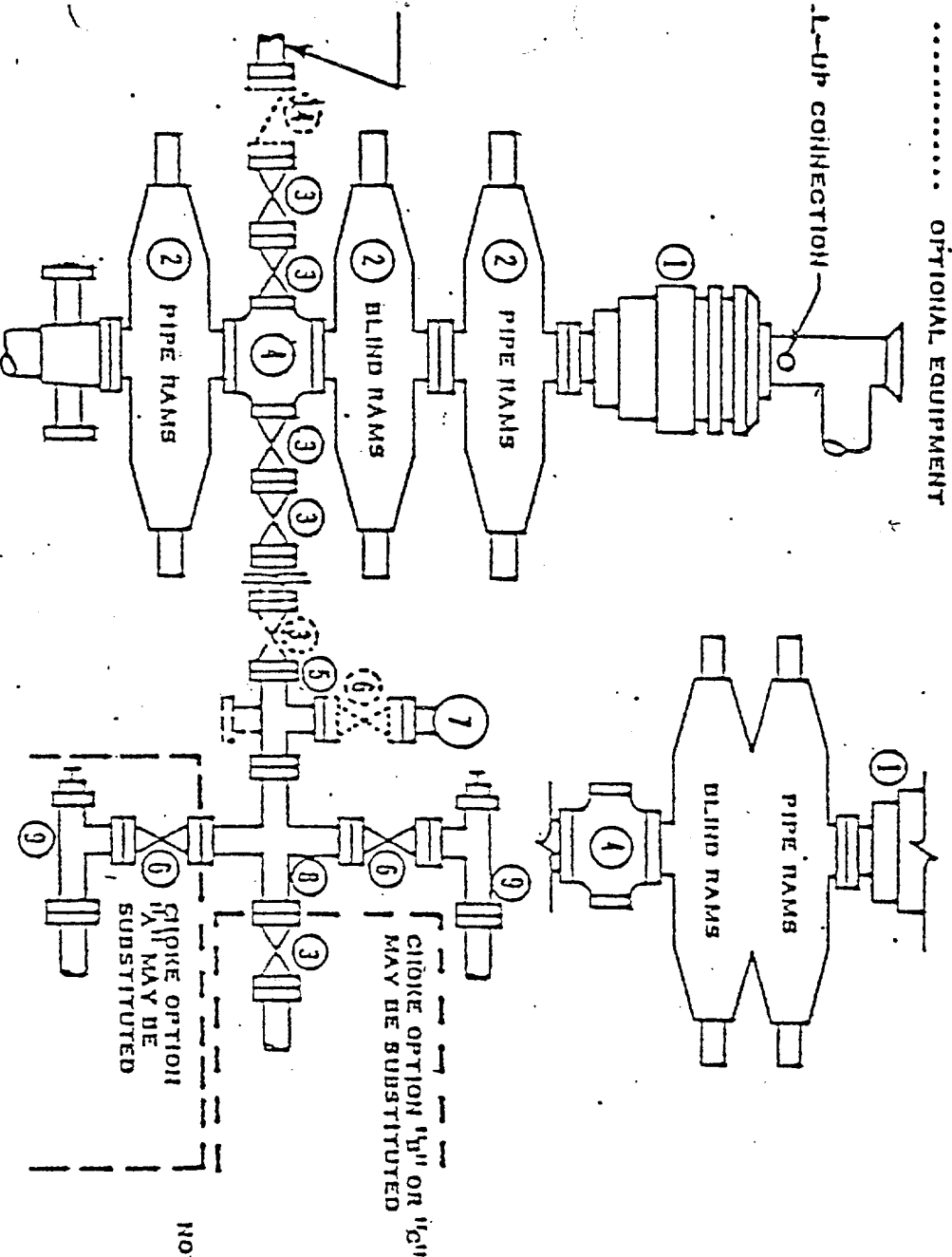

NOTES:

1. 10,000 PSI WP OR BETTER CLAMP FLANGES MAY BE SUBSTITUTED FOR FLANGES
2. ONE ADJUSTABLE CHOKER MAY BE REPLACED WITH A POSITIVE CHOKER
3. VALVES MAY BE EITHER HAND OR POWER OPERATED BUT, IF POWER OPERATED, THE VALVES FLANGED TO THE BOP RUM MUST BE CAPABLE OF BEING OPENED AND CLOSED MANUALLY OR CLOSE ON POWER FAILURE AND BE CAPABLE OF BEING OPENED MANUALLY

10,000 PSI WORKING PRESSURE
BLOWOUT PREVENTER 1100K-UP

(10,000 PSI 6 BX
FLANGES OR BETTER)