

30-025-27760

NO. OF COPIES RECEIVED	
DISTRIBUTION	
SANTA FE	
FILE	
U.S.G.S.	
LAND OFFICE	
OPERATOR	

NEW MEXICO OIL CONSERVATION COMMISSION

Form C-101
Revised 1-1-65

5A. Indicate Type of Lease

STATE ☒ FEE ☐

5. State Oil & Gas Lease No.

L-5113

APPLICATION FOR PERMIT TO DRILL, DEEPEN, OR PLUG BACK

1a. Type of Work

1b. Type of Well

DRILL ☒

DEEPEN ☐

PLUG BACK ☐

OIL WELL ☐

GAS WELL ☒

OTHER

SINGLE ZONE ☒

MULTIPLE ZONE ☐

2. Name of Operator

BTA OIL PRODUCERS

3. Address of Operator

104 South Pecos Midland, Texas 79701

6. Location of Well

UNIT LETTER E F LOCATED 1980 FEET FROM THE North LINE

AND 1500 FEET FROM THE West LINE OF SEC. 2 TWP. 23-S RGE. 34-E NMPM

7. Unit Agreement Name

8. Farm or Lease Name

Antelope, 8006 JV-P

9. Well No.

2

10. Field and Pool, or Wildcat

Antelope Ridge (Morrow)

12. County

Lea

19. Proposed Depth

13,550'

19A. Formation

Morrow

20. Rotary or C.T.

Rotary

21. Elevations (Show whether DT, RL, etc.)

3886' GR

21A. Kind & Status Plug. Bond

Blanket

21B. Drilling Contractor

Parker Drlg Co.

22. Approx. Date Work will start

June 1, 1982

13.

PROPOSED CASING AND CEMENT PROGRAM

SIZE OF HOLE	SIZE OF CASING	WEIGHT PER FOOT	SETTING DEPTH	SACKS OF CEMENT	EST. TOP
26"	20"	94#	1500'	3000	Circ.
17 1/2"	13-3/8"	68#	5000'	3000	Circ.
12 1/4"	9-5/8"	47 & 53.5#	11900'	5000	- -
liner 8 1/2"	7-5/8"	39#	13550'	400	- -

13-3/8" BOP - 12" - 3000# Double Ram & Annular Hydraulic

9-5/8" BOP - 11" - 10000# One Double Ram - One Single Ram & Annular Hydraulic

APPROVAL VALID FOR 180 DAYS
PERMIT EXPIRES 10/20/82
UNLESS DRILLING UNDERWAY

ABOVE SPACE DESCRIBE PROPOSED PROGRAM: IF PROPOSAL IS TO DEEPEN OR PLUG BACK, GIVE DATA ON PRESENT PRODUCTIVE ZONE AND PROPOSED NEW PRODUCTIVE ZONE. GIVE BLOWOUT PREVENTER PROGRAM, IF ANY.

I hereby certify that the information above is true and complete to the best of my knowledge and belief.

Signed Bob K. Newland Title Regulatory Administrator Date 3/19/82

(This space for State Use)

ORIGINAL SIGNED BY

APPROVED BY JERRY SEXTON TITLE _____ DATE APR 20 1982

CONDITIONS OF APPROVAL, IF ANY, ARE _____

NEW MEXICO OIL CONSERVATION COMMISSION
WELL LOCATION AND ACREAGE DEDICATION PLAT

Form C-102
Supersedes C-128
Effective 1-1-65

All distances must be from the outer boundaries of the Section.

Operator BTA OIL PRODUCERS			Lease 8006 JV-P ANTELOPE			Well No. 2		
Unit Letter F	Section 2	Township 23-S	Range 34-E	County LEA				
Actual Footage Location of Well: 1980 feet from the NORTH line and 1500 feet from the WEST line								
Ground Level Elev. 3382'	Producing Formation Morrow		Pool Antelope Ridge (Morrow)			Dedicated Acreage: 320 Acres		

1. Outline the acreage dedicated to the subject well by colored pencil or hachure marks on the plat below.
2. If more than one lease is dedicated to the well, outline each and identify the ownership thereof (both as to working interest and royalty).
3. If more than one lease of different ownership is dedicated to the well, have the interests of all owners been consolidated by communitization, unitization, force-pooling, etc?

☐ Yes ☐ No If answer is "yes," type of consolidation _____

If answer is "no," list the owners and tract descriptions which have actually been consolidated. (Use reverse side of this form if necessary.) _____

No allowable will be assigned to the well until all interests have been consolidated (by communitization, unitization, forced-pooling, or otherwise) or until a non-standard unit, eliminating such interests, has been approved by the Commission.

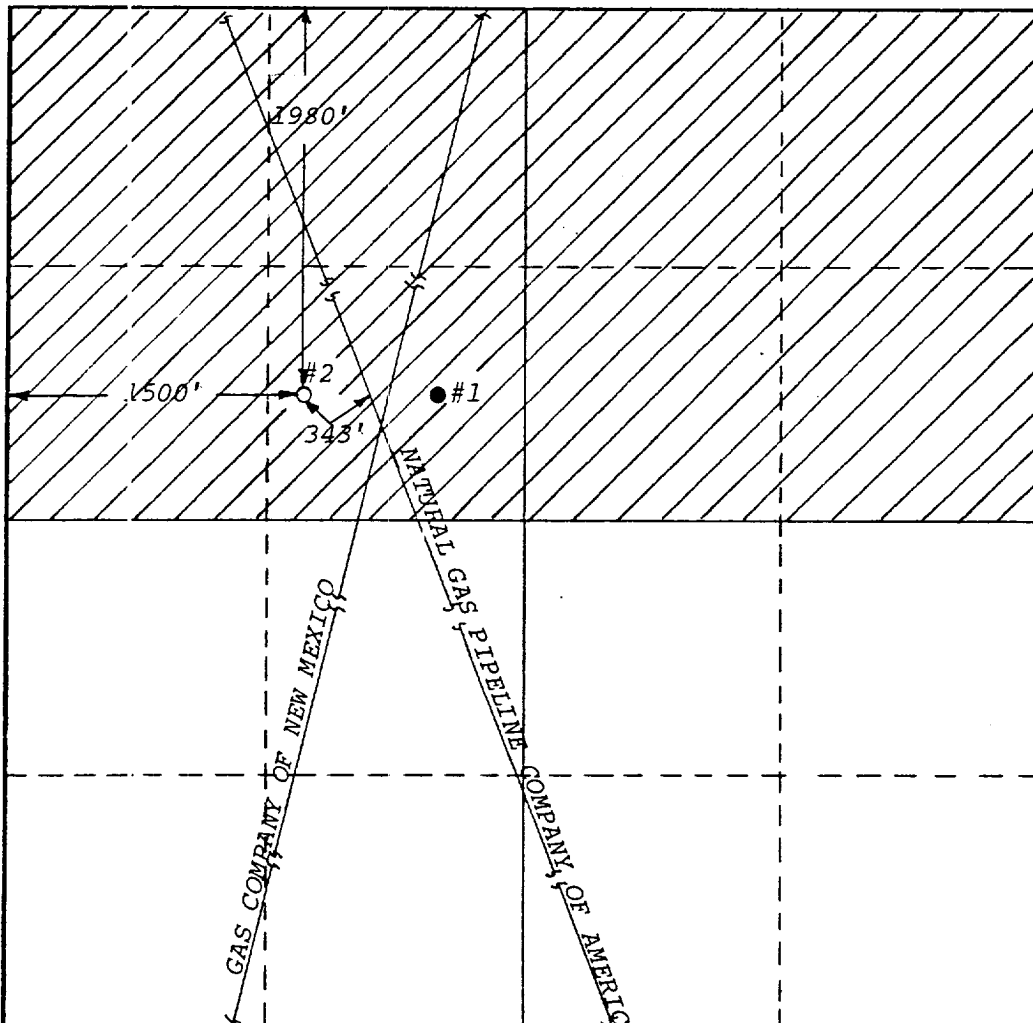

CERTIFICATION

I hereby certify that the information contained herein is true and complete to the best of my knowledge and belief.

Bob K. Newland

Name

BOB K. NEWLAND

Position

Regulatory Administrator

Company

BTA OIL PRODUCERS

Date

March 19, 1982

I hereby certify that the well location shown on this plat was plotted from field notes of actual surveys made by me or under my supervision, and that the same is true and correct to the best of my knowledge and belief.

Date Surveyed

MARCH 15, 1982

Registered Professional Engineer and/or Land Surveyor

Gary D. Boswell

Certificate No.

6689

