

COUNTY LEA FIELD Jalmat

STATE NM

OPR HARTMAN, DOYLE

API 30-025-27786

NO 3 LEASE Toby

MAP

Sec 7, T24S, R37E

COORD

1780 FSL, 1100 FWL of Sec

7-1-31 NM

7 mi N/Jal

SPD 5-28-82

EMP 6-12-82

9 5/8-420-250 sx
7-3450-350 sx
2 3/8-3300

| WELL CLASS INIT D FIN DG LSE CODE | | | |
|-----------------------------------|-------|-----------|-------|
| FORMATION | DATUM | FORMATION | DATUM |
| | | | |
| | | | |
| | | | |
| | | | |
| ID 3450 (SVRV) | | PRI 3386 | |

IP (Yates-Seven Rivers) Perfs 2897-3177 P 194 MCFGPD. Pot based on 24 hr test. GOR Dry; gty (Gas) (NR).

CONTR Cactus #68

OPERSELEN 3303 GL

sub-s 11

F.R. 4-12-82
PD 3450 RT (Yates-Seven Rivers)
6-2-82 Drlg 3135
6-7-82 TD 3450; PBD 3386; Prep Perf
6-15-82 TD 3450; PBD 3386; Recg 1d
Perf (Yates-Seven Rievers) 2897-3177 w/21 shots
Acid (2897-3177) 5600 gals
Frac (2897-3177) 92,000 gals + 214,500# sd
6-28-82 TD 3450; PBD 3386; Complete
LOG TOPS: Rustler 1175, Salt 1275, Base Salt 2730, Yates 2889, Seven Rivers 3118
LOGS RUN: CNL, DENL, SN, GRL, FRXL, GRDL
7-3-82 COMPLETION ISSUED

7-1-31 NM
IC 30-025-70370-82

NEW MEXICO OIL CONSERVATION COMMISSION
WELL LOCATION AND ACREAGE DEDICATION PLAT

Form C-128
Supersedes C-128
Effective 1-1-65

All distances must be from the outer boundaries of the Section

| | | | | | |
|---|--|-------------------------|-----------------------------|----------------------|--------------------------------|
| Operator Doyle Hartman | | Lease Toby | | Well No. 3 | |
| Section Letter I | Section 7 | Township 24-S | Range 37-E | County Lea | |
| Actual Fracture Location of Well: 1780 feet from the South line and 1100 feet from the West line | | | | | |
| Ground Level Elev. 3303.0' | Producing Formation Yates-Seven Rivers | | Pool Jalmat (Gas) | | Estimated Acreage 80 |

1. Outline the acreage dedicated to the subject well by colored pencil or hatchure marks on the plat below.
2. If more than one lease is dedicated to the well, outline each and identify the ownership thereof (both as to working interest and royalty).
3. If more than one lease of different ownership is dedicated to the well, have the interests of all owners been consolidated by communitization, unitization, force-pooling, etc?

☐ Yes ☐ No If answer is "yes," type of consolidation _____

If answer is "no," list the owners and tract descriptions which have actually been consolidated (Use reverse side of this form if necessary.) _____

No allowable will be assigned to the well until all interests have been consolidated (by communitization, unitization, forced-pooling, or otherwise) or until a non-standard unit, eliminating such interests, has been approved by the Commission.

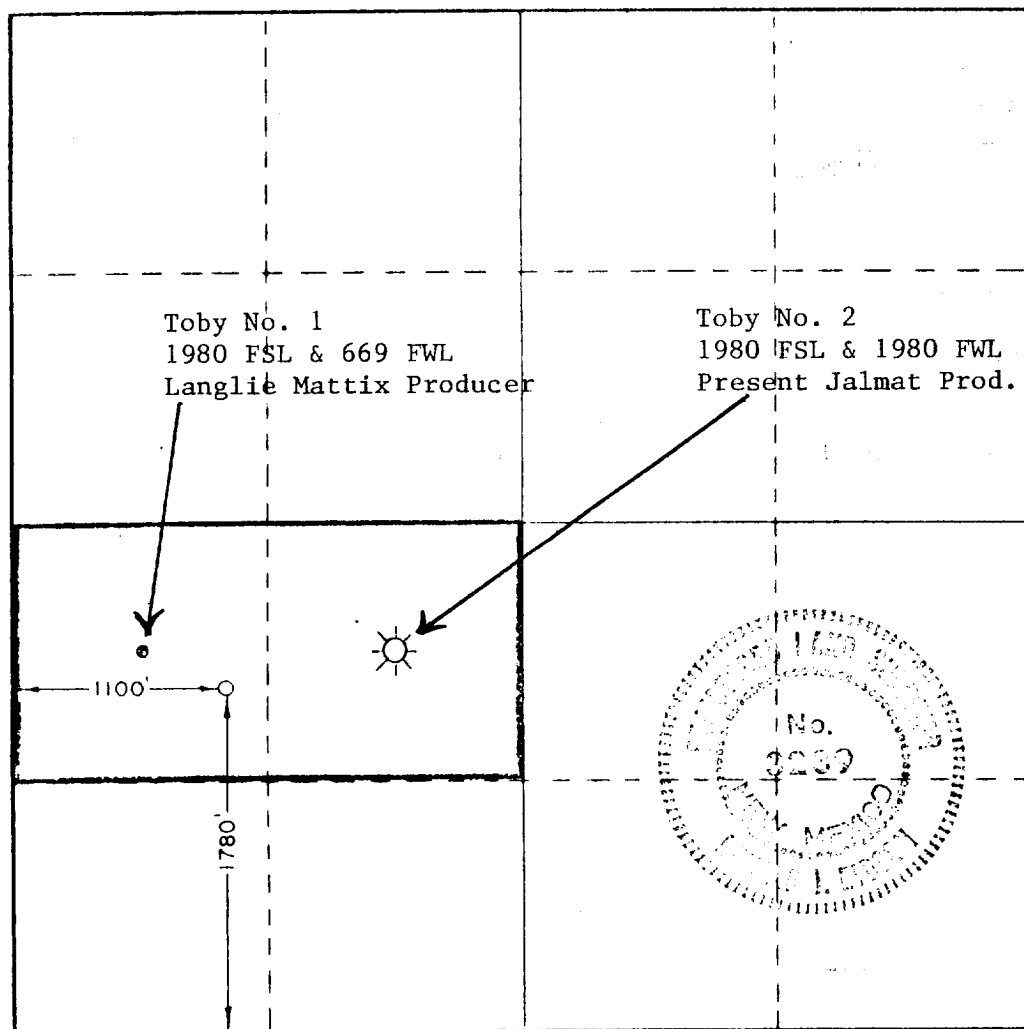

CERTIFICATION

I hereby certify that the information contained herein is true and complete to the best of my knowledge and belief.

Larry Nermyr

Surveyor
Larry G. Nermyr

Engineer

Company
Doyle Hartman

Date
March 31, 1982

I hereby certify that the well location shown on this plat was plotted from field notes of actual surveys made by me or under my supervision, and that the same is true and correct to the best of my knowledge and belief.

Date Surveyed

March 31, 1982

Registered Professional Engineer and/or Land Surveyor

Ronald J. Eidson

Certificate No. **JOHN W. WEST 676**
PATRICK A. ROMERO 6865
Ronald J. Eidson 3239

0 330 660 990 1320 1650 1980 2310 2640 2970 3300 3630 3960 4290 4620 4950 5280 5610 5940 6270 6600

RECEIVED

APR 1 1982

**O.C.D.
HOBBS OFFICE**