

**NEW MEXICO OIL CONSERVATION COMMISSION
WELL LOCATION AND ACREAGE DEDICATION PLAT**

Form C-102
Supersedes C-128
Effective 1-1-65

All distances must be from the outer boundaries of the Section

| | | | | | |
|---|--------------------------------------|-----------------------------|--------------------------------|----------------------|--|
| Operator THE SUPERIOR OIL CO. | | | Lease DUNCAN FEDERAL | | Well No. 1 |
| Tract Letter L | Section 14 | Township 25 SOUTH | Range 32 EAST | County LEA | |
| Actual Well Location of Well: | | | | | |
| 1980 | feet from the | SOUTH | line and | 660 | feet from the WEST line |
| Ground Level Elev. 3440.78' | Producing Formation Morrow | | Pool Wildcat | | Dedicated Acreage: 320 Acres |

1. Outline the acreage dedicated to the subject well by colored pencil or hatchure marks on the plat below.
2. If more than one lease is dedicated to the well, outline each and identify the ownership thereof (both as to working interest and royalty).
3. If more than one lease of different ownership is dedicated to the well, have the interests of all owners been consolidated by communitization, unitization, force-pooling, etc?

☒ Yes ☐ No If answer is "yes," type of consolidation Communitization Agreement

If answer is "no," list the owners and tract descriptions which have actually been consolidated. (Use reverse side of this form if necessary.) _____

No allowable will be assigned to the well until all interests have been consolidated (by communitization, unitization, forced-pooling, or otherwise) or until a non-standard unit, eliminating such interests, has been approved by the Commission.

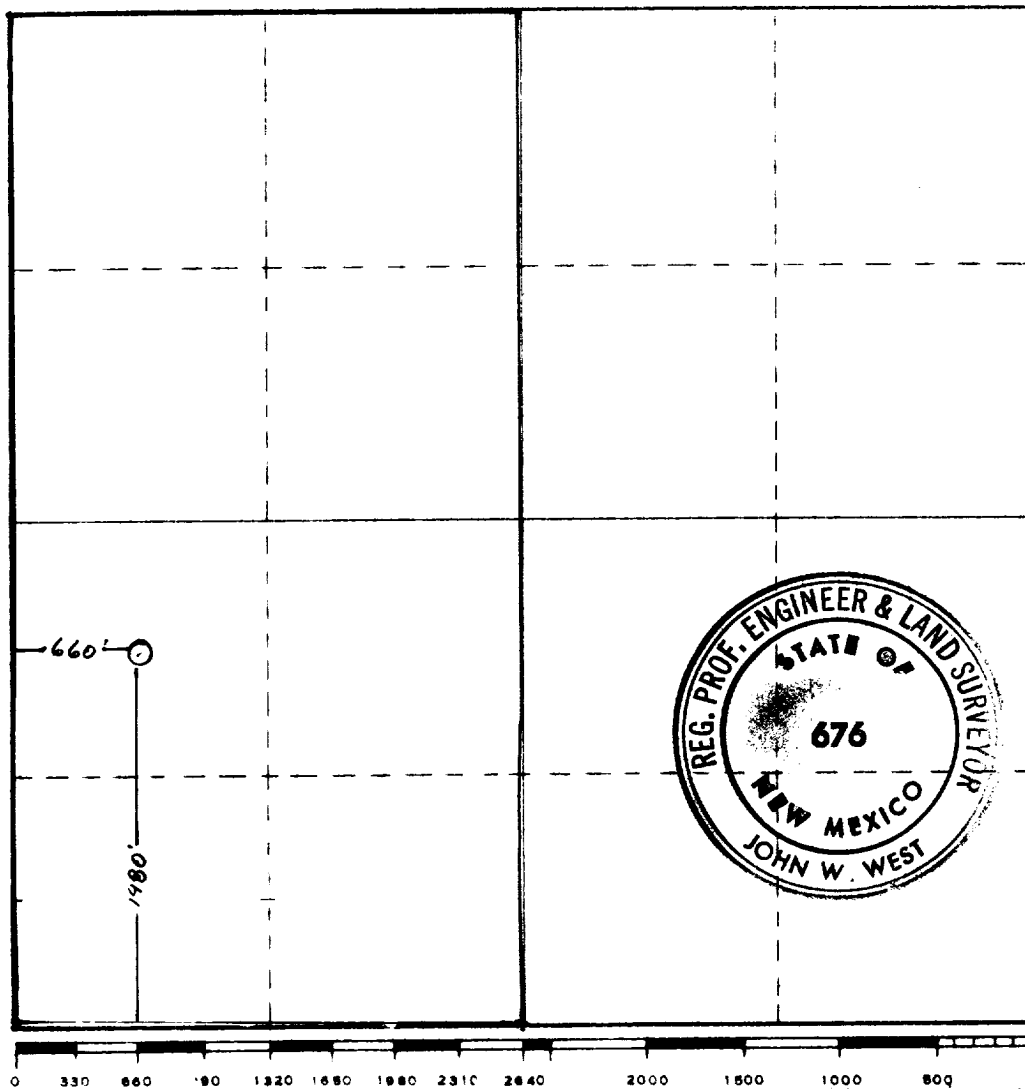

CERTIFICATION

I hereby certify that the information contained herein is true and complete to the best of my knowledge and belief.

Name

G. E. Tate

Position

Production Superintendent

Company

The Superior Oil Company

Date

6-11-82

I hereby certify that the well location shown on this plat was plotted from field notes of actual surveys made by me or under my supervision, and that the same is true and correct to the best of my knowledge and belief.

Date Surveyed

5 - 14 - 82.

Registered Professional Engineer and/or Land Surveyor

John W. West

Certificate No. **JOHN W. WEST 676**
PATRICK A. ROMERO 6888
Ronald J. Eidean 3239