

30-025-28253

NO. OF COPIES RECEIVED	
DISTRIBUTION	
SANTA FE	
FILE	
U.S.G.S.	
LAND OFFICE	
OPERATOR	

NEW MEXICO OIL CONSERVATION COMMISSION

Form C-101
Revised 1-4-65

5A. Indicate Type of Lease	
STATE <input checked="" type="checkbox"/>	FEE <input type="checkbox"/>
5. State Oil & Gas Lease No.	
LG-604	
7. Unit Agreement Name	
8. Farm or Lease Name	
State DR	
9. Well No.	
5	
10. Field and Pool, or Wildcat	
Lusk, Northeast Yates	
12. Country	
Lea	
19. Proposed Depth	19A. Formation
3250	Yates
20. Rotary or C.T.	
Rotary	
21. Kind & Status Plug, bond	21B. Drilling Contractor
Blanket on file	N/A
22. Approx. Date Work will start	

APPLICATION FOR PERMIT TO DRILL, DEEPEN, OR PLUG BACK

1a. Type of work	
b. Type of Well	
DRILL <input checked="" type="checkbox"/>	DEEPEN <input type="checkbox"/>
OIL WELL <input checked="" type="checkbox"/>	CAS WELL <input type="checkbox"/>
OTHER <input type="checkbox"/>	
2. Name of Operator	
Amoco Production Company	
3. Address of Operator	
P. O. Box 68, Hobbs, New Mexico 88240	
4. Location of Well	
UNIT LETTER B	LOCATED 660
FEET FROM THE North LINE	
AND 1980	FEET FROM THE East
LINE OF SEC. 16 TWP. 19-S RGE. 32-E NMPM	
11. Evaluations (Show whether oil, gas, etc.)	
3627' GL	
21A. Kind & Status Plug, bond	
Blanket on file	
21B. Drilling Contractor	
N/A	
22. Approx. Date Work will start	

PROPOSED CASING AND CEMENT PROGRAM

SIZE OF HOLE	SIZE OF CASING	WEIGHT PER FOOT	SETTING DEPTH	SACKS OF CEMENT	EST. TOP
11" of 12-1/4"	8-5/8"	24#	400'	Circulate	Surface
7-7/8"	5-1/2"	15.5#	3250'	Tie back to 8-5/8"	400'

Propose to drill and equip well in the Yates formation. After reaching TD, logs will be run and evaluated. Perforate and/or stimulate as necessary in attempting commercial production.

BOP Diagram Attached.

Mud Program: 0-400' Fresh water and Native Spud Mud.
400-TD Brine with minimum properties for safe hole conditions

0+4-NMOCD, H 1-HOU, R.E.Ogden, Rm 21.150 1-F.J.Nash, HOU, Rm. 4.206 1-CLF

4. ABOVE SPACE DESCRIBE PROPOSED PROGRAM: IF PROPOSAL IS TO DEEPEN OR PLUG BACK, GIVE DATA ON PRESENT PRODUCTIVE ZONE AND PROPOSED NEW PRODUCTIVE ZONE. GIVE BLOWOUT PREVENTER PROGRAM, IF ANY.

I hereby certify that the information above is true and complete to the best of my knowledge and belief.

Signed Cathy L. Forman Title Assist. Admin. Analyst Date 6-29-83
(This space for State Use)

APPROVED BY ORIGINAL SIGNED BY JERRY SEXTON TITLE DISTRICT 1 SUPERVISOR DATE 1001 9 1981
CONDITIONS OF APPROVAL, IF ANY:

APPROVAL VALID FOR 180 DAYS
PERMIT EXPIRES 11/18/84

MEXICO OIL CONSERVATION COMMISS
WELL LOCATION AND ACREAGE DEDICATION PLAT

Form C-102
Supersedes C-128
Effective 1-1-65

All distances must be from the outer boundaries of the Section

Operator Amoco Production Company			Lease State DR		Well No. 5
Unit Letter B	Section 16	Township 19 South	Range 32 East	County Lea County	
Actual Footage Location of Well: <div style="display: flex; justify-content: space-between;"> 660 feet from the North line and 1980 feet from the East line </div>					
Ground Level Elev. 3627.0	Producing Formation Yates	Pool Lusk, Northeast Yates	Dedicated Acreage: 40 Acres		

- Outline the acreage dedicated to the subject well by colored pencil or hatchure marks on the plat below.
- If more than one lease is dedicated to the well, outline each and identify the ownership thereof (both as to working interest and royalty).
- If more than one lease of different ownership is dedicated to the well, have the interests of all owners been consolidated by communitization, unitization, force-pooling, etc?

☐ Yes ☐ No If answer is "yes," type of consolidation _____

If answer is "no," list the owners and tract descriptions which have actually been consolidated. (Use reverse side of this form if necessary.) _____

No allowable will be assigned to the well until all interests have been consolidated (by communitization, unitization, forced-pooling, or otherwise) or until a non-standard unit, eliminating such interests, has been approved by the Commission.

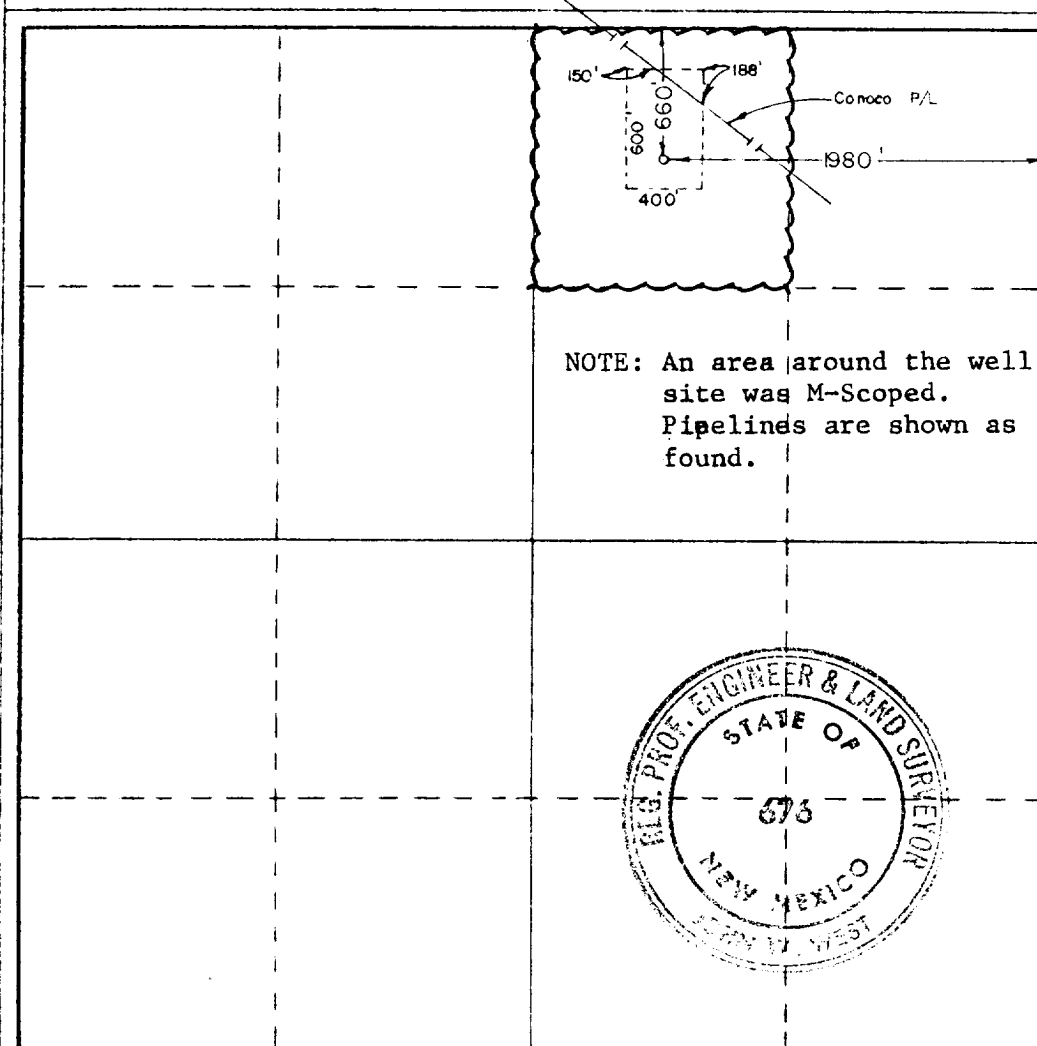

CERTIFICATION

I hereby certify that the information contained herein is true and complete to the best of my knowledge and belief.

Name: *Cathy L. Ferman*
Position: _____

Assist. Admin. Analyst

Company: **Amoco Production Company**

Date: **June 29, 1983**

I hereby certify that the well location shown on this plat was plotted from field notes of actual surveys made by me or under my supervision, and that the same is true and correct to the best of my knowledge and belief.

Date Surveyed: **June 24, 1983**

Registered Professional Engineer in Oil and Land Surveyor

John W. West

Certificate No. **JOHN W. WEST, 676**
RONALD J. EIDSON, 3239

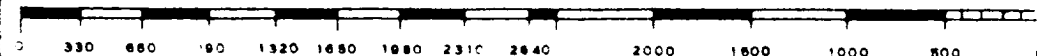

STANDARD 2000 PSI W.P. BOP STACK

1. Blow-out preventers may be manually operated.
2. All equipment must be in good condition, 2,000 psi W.P. (4,000 psi test) minimum.
3. Bell nipple above blow-out preventer shall be same size as casing being drilled through.
4. Kelly cock to be installed on kelly.
5. Full opening safety valve 2,000 psi w.p. (4,000 psi test) minimum must be available on rig floor at all times with proper connection or subs to fit any tool joint in string.
6. Spool or cross may be eliminated if connections are available in the lower part of the blow-out preventer body.
7. Double or space saver type preventers may be used in lieu of two single preventers.
8. BOP rams to be installed as follows:
 - Top preventer - Drill pipe or casing rams
 - Bottom preventer - Blind rams

*Amoco District Superintendent may reverse location of rams.
9. Extensions and hand wheels to be installed and braced at all times.
10. Manifold valves may be gate or plug metal to metal seal 2" minimum.

