

30-025-28328

NO. OF COPIES RECEIVED	
DISTRIBUTION	
SANTA FE	
FILE	
U.S.G.S.	
LAND OFFICE	
OPERATOR	

## NEW MEXICO OIL CONSERVATION COMMISSION

Form C-101  
Revised 1-1-65

5A. Indicate Type of Lease	
STATE <input checked="" type="checkbox"/>	FEE <input type="checkbox"/>
5. State Oil & Gas Lease No.	
B-2148 & B-2229	

## APPLICATION FOR PERMIT TO DRILL, DEEPEN, OR PLUG BACK

1a. Type of Work		7. Unit Agreement Name	
b. Type of Well OIL WELL <input checked="" type="checkbox"/> GAS WELL <input type="checkbox"/> OTHER <input type="checkbox"/>		Mal-Gra Unit	
DRILL <input checked="" type="checkbox"/> DEEPEN <input type="checkbox"/> PLUG BACK <input type="checkbox"/>		8. Farm or Lease Name	
SINGLE ZONE <input checked="" type="checkbox"/> MULTIPLE ZONE <input type="checkbox"/>		Mal Gra Unit B	
2. Name of Operator		9. Well No.	
Crown Central Petroleum Corporation		8-8	
3. Address of Operator		10. Field and Pool, or Wildcat	
731 W. Wadley, Bldg. K, Midland, Texas 79705		Maljamar	
4. Location of Well		12. County	
UNIT LETTER <u>N</u> LOCATED <u>990</u> FEET FROM THE <u>S</u> LINE		Lea	
AND <u>1650</u> FEET FROM THE <u>W</u> LINE OF SEC. <u>20</u> TWP. <u>17S</u> RGE. <u>33E</u> NMPM			
19. Proposed Depth		19A. Formation	
4500		Grayburg/ San Andres	
20. Rotary or C.T.		Rotary	
21. Elevations (Show whether DF, RT, etc.)		21B. Drilling Contractor	
4135 GL		Unknown	
21A. Kind & Status Plug. Bond		22. Approx. Date Work will start	
Blanket		10-15-83	

## PROPOSED CASING AND CEMENT PROGRAM

SIZE OF HOLE	SIZE OF CASING	WEIGHT PER FOOT	SETTING DEPTH	SACKS OF CEMENT	EST. TOP
17 1/2	13 3/8	54.4	30	15	Surface
12 1/4	9 5/8	36	1300	600	Surface
8 3/4	5 1/2	15/5	4500	600	±2800

BOP System: 10" Series 900 (3000 psi or greater) double ram, Hydraulic.

Unit Agreement approved: Case 3102, Order R-2768  
Waterflood Approved : Case 3103, Order R-2769APPROVAL VALID FOR 180 DAYS  
PERMIT EXPIRES 5/1/84  
UNLESS DRILLING UNDERWAY

IN ABOVE SPACE DESCRIBE PROPOSED PROGRAM: IF PROPOSAL IS TO DEEPEN OR PLUG BACK, GIVE DATA ON PRESENT PRODUCTIVE ZONE AND PROPOSED NEW PRODUCTIVE ZONE. GIVE BLOWOUT PREVENTER PROGRAM, IF ANY.

I hereby certify that the information above is true and complete to the best of my knowledge and belief.

Signed [Signature] Title Senior Production Engineer Date August 25, 1983

(This space for State Use)

ORIGINAL SIGNED BY JERRY SEXTON  
DISTRICT I SUPERVISORAPPROVED BY \_\_\_\_\_ TITLE \_\_\_\_\_ DATE AUG 29 1983

CONDITIONS OF APPROVAL, IF ANY:

RECEIVED  
AUG 26 1983  
C.C.D.  
HOBBS OFFICE

NEW MEXICO OIL CONSERVATION COMMISSION  
WELL LOCATION AND ACREAGE DEDICATION PLAT

Form C-102  
Supersedes C-128  
Effective 1-1-65

All distances must be from the outer boundaries of the Section.

Operator <b>CROWN CENTRAL PETROLEUM CO.</b>			Lease <b>MALGRAY "B"</b>		Well No. <b>8</b>
Section Letter <b>N</b>	Section <b>20</b>	Township <b>17 SOUTH</b>	Range <b>33 EAST</b>	County <b>LEA</b>	
Well Location of Well:					
990 feet from the <b>SOUTH</b> line and		1650 feet from the <b>WEST</b> line			
Surface Elev. <b>4135.2</b>	Producing Formation <b>Grayburg-San Andres</b>	Pool <b>Malgamar</b>	Dedicated Acreage: <b>40</b> Acres		

- Outline the acreage dedicated to the subject well by colored pencil or hatchure marks on the plat below.
- If more than one lease is dedicated to the well, outline each and identify the ownership thereof (both as to working interest and royalty).
- If more than one lease of different ownership is dedicated to the well, have the interests of all owners been consolidated by communitization, unitization, force-pooling, etc?

☒ Yes ☐ No If answer is "yes," type of consolidation Unitization for Sec. Rec  
Case 3102, Order R-2768  
If answer is "no," list the owners and tract descriptions which have actually been consolidated. (Use reverse side of this form if necessary.)

No allowable will be assigned to the well until all interests have been consolidated (by communitization, unitization, forced-pooling, or otherwise) or until a non-standard unit, eliminating such interests, has been approved by the Commission.

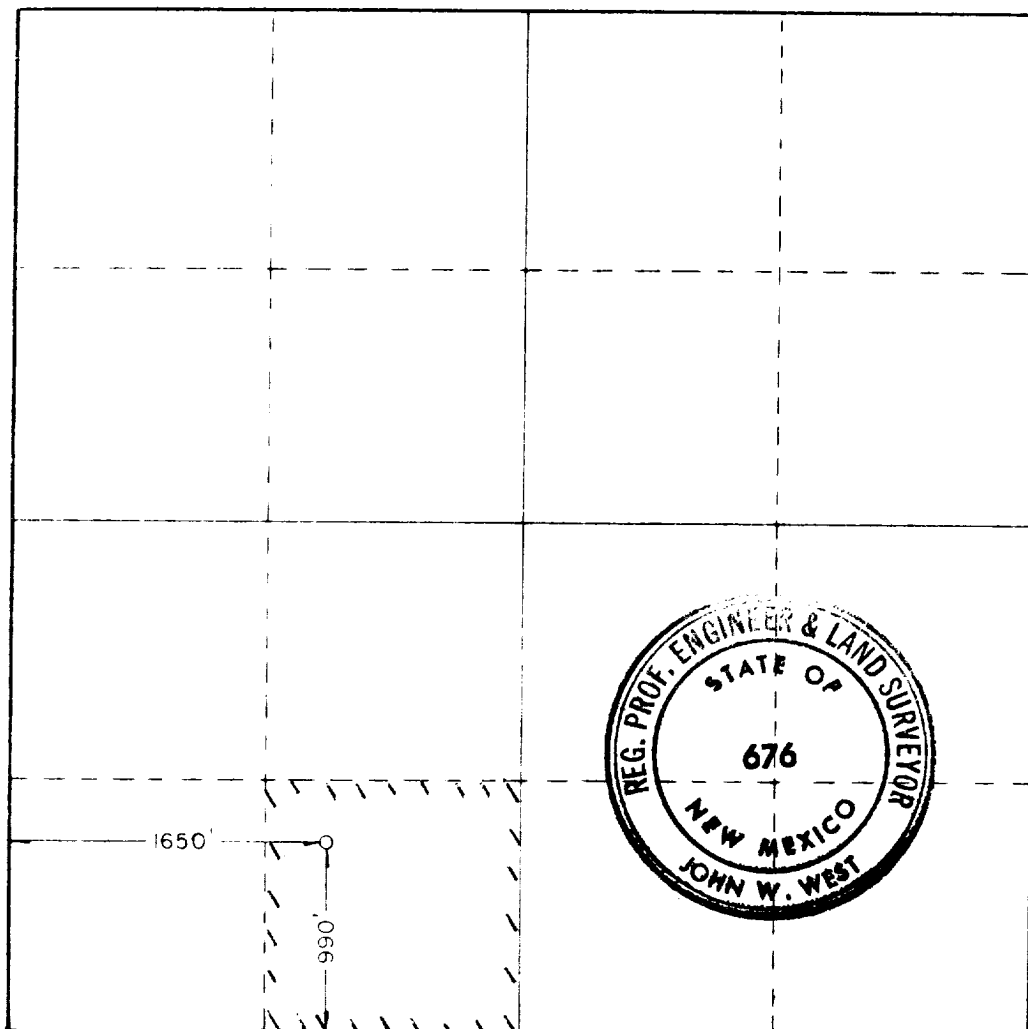

CERTIFICATION

I hereby certify that the information contained herein is true and complete to the best of my knowledge and belief.

*R. P. Canoll*  
Senior Prod. Eng.  
Crown Central Pet. Corp.  
August 25, 1983  
Date

I hereby certify that the well location shown on this plat was plotted from field notes of actual surveys made by me or under my supervision, and that the same is true and correct to the best of my knowledge and belief.

Date Surveyed  
**AUGUST 22, 1983**  
Registered Professional Engineer  
and Land Surveyor

*John W. West*  
Certificate No. **JOHN W. WEST, 676**  
**RONALD J. EIDSON, 3239**

330 660 990 1320 1650 1980 2310 2640 2970 3300 3630

RECEIVED  
AUG 26 1983  
O.C.D.  
HOBBS OFFICE