

STATE OF NEW MEXICO
ENERGY AND MINERALS DEPARTMENT

CONSERVATION DIVISION
P. O. BOX 2088
SANTA FE, NEW MEXICO 87501

Form C-101
Revised 10-1-78

NO. OF COPIES RECEIVED	
DISTRIBUTION	
SANTA FE	
FILE	
U.S.G.S.	
LAND OFFICE	
OPERATOR	

5A. Indicate Type of Lease
STATE ☐ FEE ☒
5. State Oil & Gas Lease No.

APPLICATION FOR PERMIT TO DRILL, DEEPEN, OR PLUG BACK

1a. Type of Work b. Type of Well OIL WELL <input checked="" type="checkbox"/> GAS WELL <input type="checkbox"/> OTHER <input type="checkbox"/> SINGLE ZONE <input checked="" type="checkbox"/> MULTIPLE ZONE <input type="checkbox"/>		2. Name of Operator SHELL OIL COMPANY 3. Address of Operator P. O. BOX 991, HOUSTON, TEXAS 77001 4. Location of Well UNIT LETTER G LOCATED 1392 FEET FROM THE NORTH LINE AND 2477 FEET FROM THE EAST LINE OF SEC. 30 TWP. 18-S RGE. 38-E NMPM		7. Unit Agreement Name N. HOBBS (G/SA) UNIT 8. Farm or Lease Name SECTION 30 9. Well No. 312 10. Field and Pool, or Wildcat HOBBS (G/SA) 12. County LEA	
11. Elevations (Show whether DF, RT, etc.) 3652.9' GL		21A. Kind & Status Plug. Bond BLANKET		19. Proposed Depth 4350' 19A. Formation GRAYBURG/ SAN ANDRES 20. Rotary or C.T. ROTARY	
21B. Drilling Contractor UNKNOWN		22. Approx. Date Work will start NOVEMBER 1, 1983			

PROPOSED CASING AND CEMENT PROGRAM

SIZE OF HOLE	SIZE OF CASING	WEIGHT PER FOOT	SETTING DEPTH	SACKS OF CEMENT	EST. TOP
17-1/2"	13-3/8"	54.5#	40'	50 SX	SURFACE
12-1/4"	8-5/8"	24#	1710'	850 SX	SURFACE
7-7/8"	5-1/2"	14#	4350'	500 SX	SURFACE

BOP PROGRAM: 3,000# REGULAR SERVICE, 3,000# 10" DOUBLE RAM PREVENTER.

APPROVED FOR 180 DAYS
4-12-84

NSL-1749

IN ABOVE SPACE DESCRIBE PROPOSED PROGRAM: IF PROPOSAL IS TO DEEPEN OR PLUG BACK, GIVE DATA ON PRESENT PRODUCTIVE ZONE AND PROPOSED NEW PRODUCTIVE ZONE. GIVE BLOWOUT PREVENTER PROGRAM, IF ANY.

I hereby certify that the information above is true and complete to the best of my knowledge and belief.

Signed A. J. Fore A. J. FORE Title SUPERVISOR REGULATORY & PERMITS Date SEPTEMBER 27, 1983

(This space for State Use)

ORIGINAL SIGNED BY JERRY SEXTON

APPROVED BY DISTRICT 1 SUPERVISOR TITLE

(CONDITIONS OF APPROVAL, IF ANY)

DATE OCT 12 1983

RECEIVED
SEP 29 1983
C.C.D.
HOBBS OFFICE

NEW MEXICO OIL CONSERVATION COMMISSION
WELL LOCATION AND ACREAGE DEDICATION PLAT

Form O-111
Supersedes O-128
Effective 1-1-75

All distances must be from the outer boundaries of the Section

Owner SHELL OIL CO.			Lease N H U		Acres 30-312
Section G	Section 30	Township 18 SOUTH	Range 38 EAST	County LEA	
Well Location and Wells					
1392 feet from the NORTH line and		2477 feet from the EAST line			
Well Elev 3652.9	Producing Formation GRAYBURG/SAN ANDRES		Pool HOEBS (GRAYBURG/SAN ANDRES)	Estimated Acreage 40	

1. Outline the acreage dedicated to the subject well by colored pencil or hatchure marks on the plat below.
2. If more than one lease is dedicated to the well, outline each and identify the ownership thereof (both as to working interest and royalty).
3. If more than one lease of different ownership is dedicated to the well, have the interests of all owners been consolidated by communitization, unitization, force-pooling, etc?

☒ Yes ☐ No If answer is "yes," type of consolidation UNITIZATION

If answer is "no," list the owners and tract descriptions which have actually been consolidated (Use reverse side of this form if necessary.) _____

No allowable will be assigned to the well until all interests have been consolidated (by communitization, unitization, forced-pooling, or otherwise) or until a non-standard unit, eliminating such interests, has been approved by the Commission.

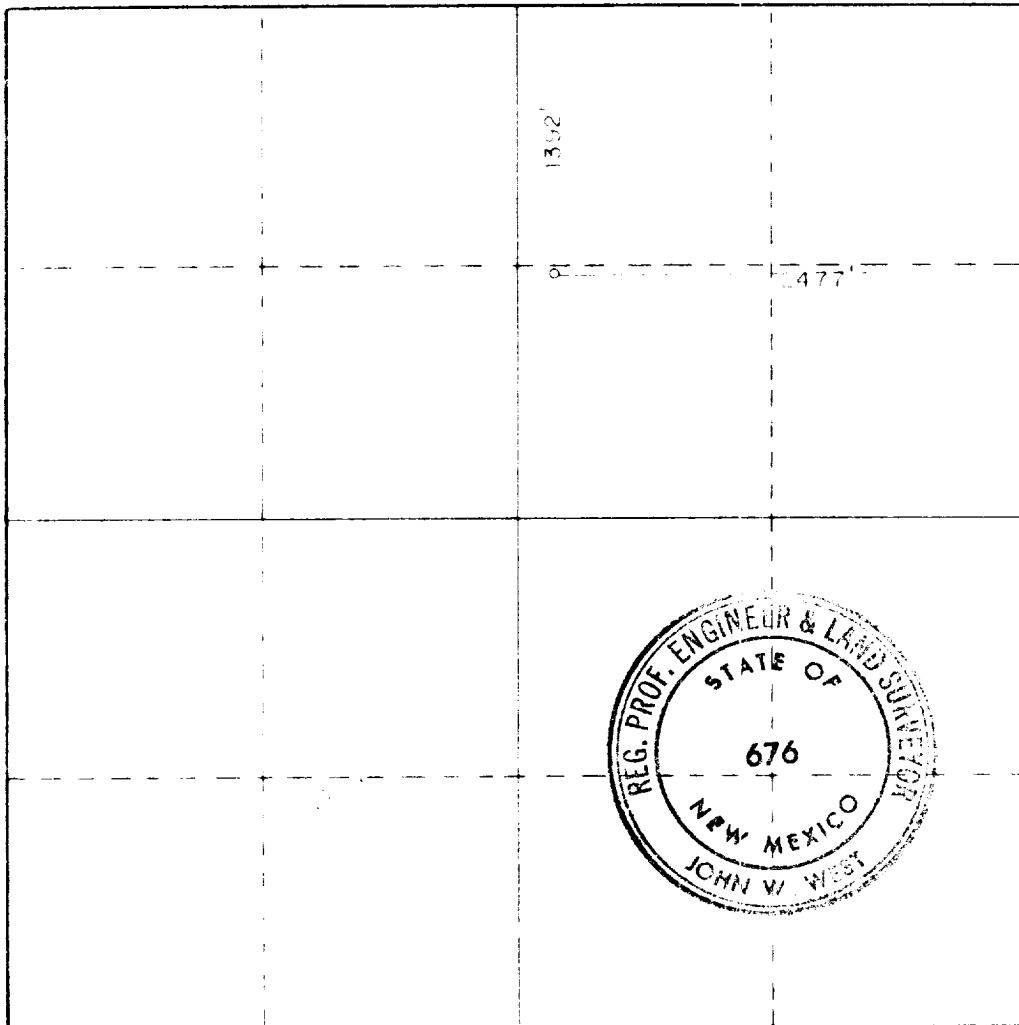

CERTIFICATION

I hereby certify that the information contained herein is true and complete to the best of my knowledge and belief.

A. J. Fore A. J. FORE
SUPERVISOR REG. & PERMITTING

SHELL OIL COMPANY

SEPTEMBER 27, 1983

I hereby certify that the well location shown on this plat was plotted from field notes of actual surveys made by me or under my supervision and that the same is true and correct to the best of my knowledge and belief.

9-22-83

John W. West
Certificate No. **JOHN W. WEST** 676
RONALD J. EIDSON 5239

330 660 990 1320 1650 1980 2310 2640 2970 3300 3630 3960 4290 4620 4950 5280 5610 5940 6270 6600 6930 7260 7590 7920 8250 8580 8910 9240 9570 9900