

30-025-28920

NO. OF COPIES RECEIVED	
DISTRIBUTION	
SANTA FE	
FILE	
U.S.G.S.	
LAND OFFICE	
OPERATOR	

NEW MEXICO OIL CONSERVATION COMMISSION
0+6-NMOCD-Hobbs
1-File
1-Engr JM
1-Foreman
1-Mr. J.A.-Midland

Form C-101
Revised 1-1-85

5A. Indicate Type of Lease STATE <input checked="" type="checkbox"/> FEE <input type="checkbox"/>
5. State Oil & Gas Lease No. B-9519

APPLICATION FOR PERMIT TO DRILL, DEEPEN, OR PLUG BACK

1a. Type of Work b. Type of Well OIL WELL <input checked="" type="checkbox"/> GAS WELL <input type="checkbox"/> OTHER <input type="checkbox"/> DRILL <input checked="" type="checkbox"/> DEEPEN <input type="checkbox"/> PLUG BACK <input type="checkbox"/> SINGLE ZONE <input checked="" type="checkbox"/> MULTIPLE ZONE <input type="checkbox"/>		7. Unit Agreement Name
2. Name of Operator GETTY OIL COMPANY		8. Farm or Lease Name Mexico "K"
3. Address of Operator P.O. BOX 730, HOBBS, N.M. 88240		9. Well No. 17
4. Location of Well UNIT LETTER H LOCATED 660 FEET FROM THE East LINE AND 1980 FEET FROM THE North LINE OF SEC. 29 TWP. 24S RGE. 38E NMPM		10. Field and Pool, or Wildcat Dollarhide-Tubb-Dr. - 20
		12. County Lea
		19. Proposed Depth 7,000
		19A. Formation Drinkard
		20. Rotary or C.T. Rotary
21. Elevations (Show whether D.F., R.F., etc.) 3202.1' GL	21A. Kind & Status Plug. Bond Blanket	21B. Drilling Contractor Pending
		22. Approx. Date Work will start 12/1/84

23.

PROPOSED CASING AND CEMENT PROGRAM

SIZE OF HOLE	SIZE OF CASING	WEIGHT PER FOOT	SETTING DEPTH	SACKS OF CEMENT	EST. TOP
12 1/4"	8 5/8"	24	±1275'	598 sx	surface
7 7/8"	5 1/2"	15.5	±7000'	1026 sx	surface

- The above casing program will be used to drill the Tubb-Drinkard-Abo formations. The mud system will consist of fresh water from 0-1275', and brine and brackish water from 1275' to approximately 7000' (TD). A low water loss mud system will be utilized in the pay interval from 6000-7000'. Perforations will be selectively chosen from the electric logs.
- See attachment for BOP's and choke manifold.

APPROVAL VALID FOR 180 DAYS
PERMIT EXPIRES 3/20/85
UNLESS DRILLING UNDERWAY

IN ABOVE SPACE DESCRIBE PROPOSED PROGRAM: IF PROPOSAL IS TO DEEPEN OR PLUG BACK, GIVE DATA ON PRESENT PRODUCTIVE ZONE AND PROPOSED NEW PRODUCTIVE ZONE. GIVE BLOWOUT PREVENTER PROGRAM, IF ANY.

I hereby certify that the information above is true and complete to the best of my knowledge and belief.

Signed Dale R. Crockett Title Area Superintendent Date 9/13/84

(This space for State Use)

APPROVED BY Oil & Gas Inspector

TITLE

DATE

CONDITIONS OF APPROVAL, IF ANY:

SEP 20 1984

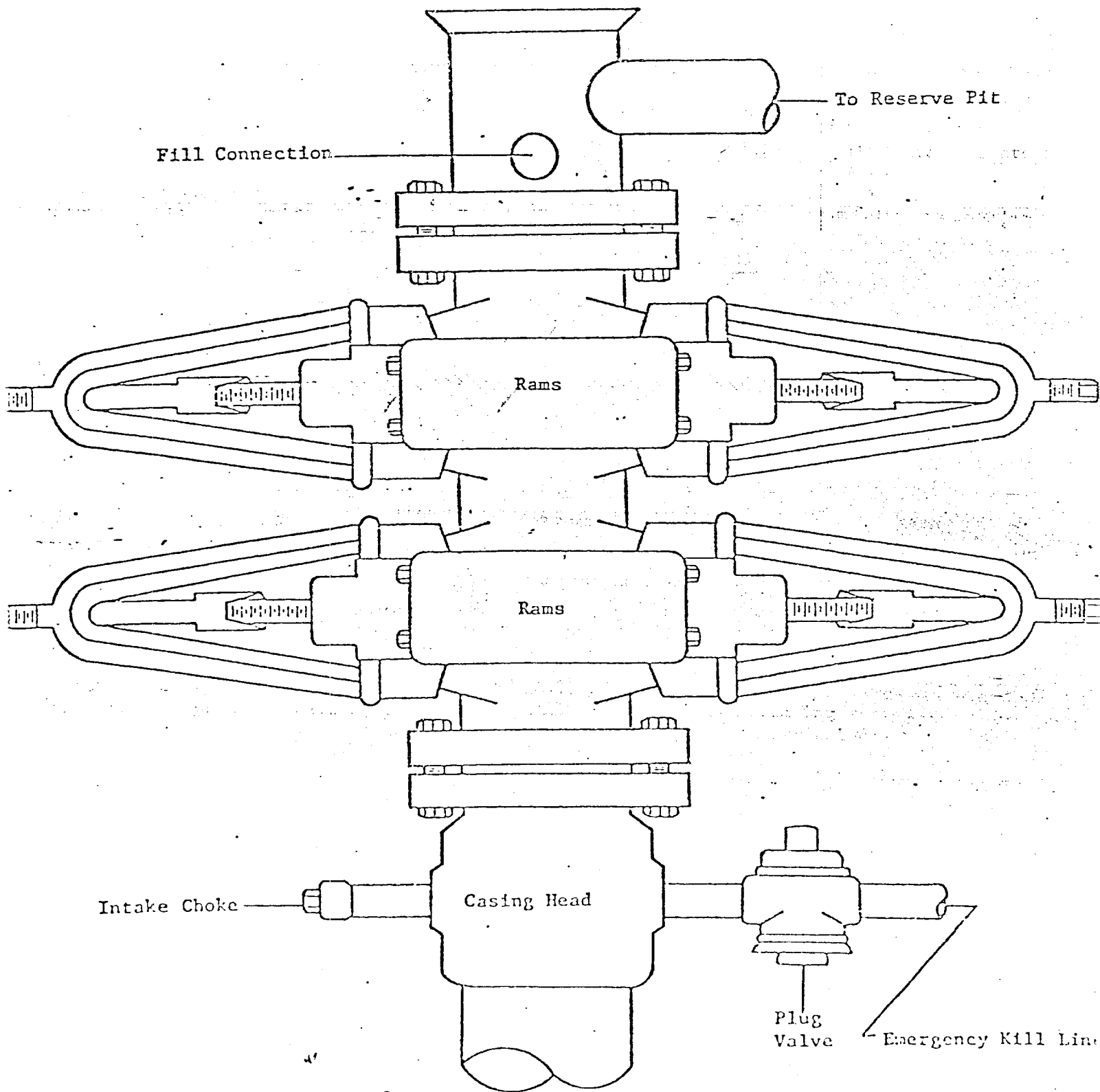

FIGURE I
GETTY OIL COMPANY

5000 PSI WORKING PRESSURE
DRILLING CONTROL HOOK-UP

0+6-NMOCD-Hobbs
1-File
1-Engr JM
1-Foreman
1-Mr. H.O. Woods-
Midland

NEW MEXICO OIL CONSERVATION COMMISSION
WELL LOCATION AND ACREAGE DEDICATION PLAT

Form C-102
Supersedes C-128
Effective 1-1-65

All distances must be from the outer boundaries of the Section.

Operator GETTY OIL COMPANY		Lease MEXICO "K"		Well No. 17
Unit Letter "H"	Section 29	Township 24 South	Range 38 East	County Lea
Actual Footage Location of Well: 1980' feet from the North line and 660 feet from the East line				
Ground Level Elev. 3202.1	Producing Formation Tubb-Drinkard-Abo	Pool West Dollarhide		Dedicated Acreage: 40 Acres

1. Outline the acreage dedicated to the subject well by colored pencil or hachure marks on the plat below.
2. If more than one lease is dedicated to the well, outline each and identify the ownership thereof (both as to working interest and royalty).
3. If more than one lease of different ownership is dedicated to the well, have the interests of all owners been consolidated by communitization, unitization, force-pooling, etc?

☐ Yes ☐ No If answer is "yes," type of consolidation _____

If answer is "no," list the owners and tract descriptions which have actually been consolidated. (Use reverse side of this form if necessary.) _____

No allowable will be assigned to the well until all interests have been consolidated (by communitization, unitization, forced-pooling, or otherwise) or until a non-standard unit, eliminating such interests, has been approved by the Commission.

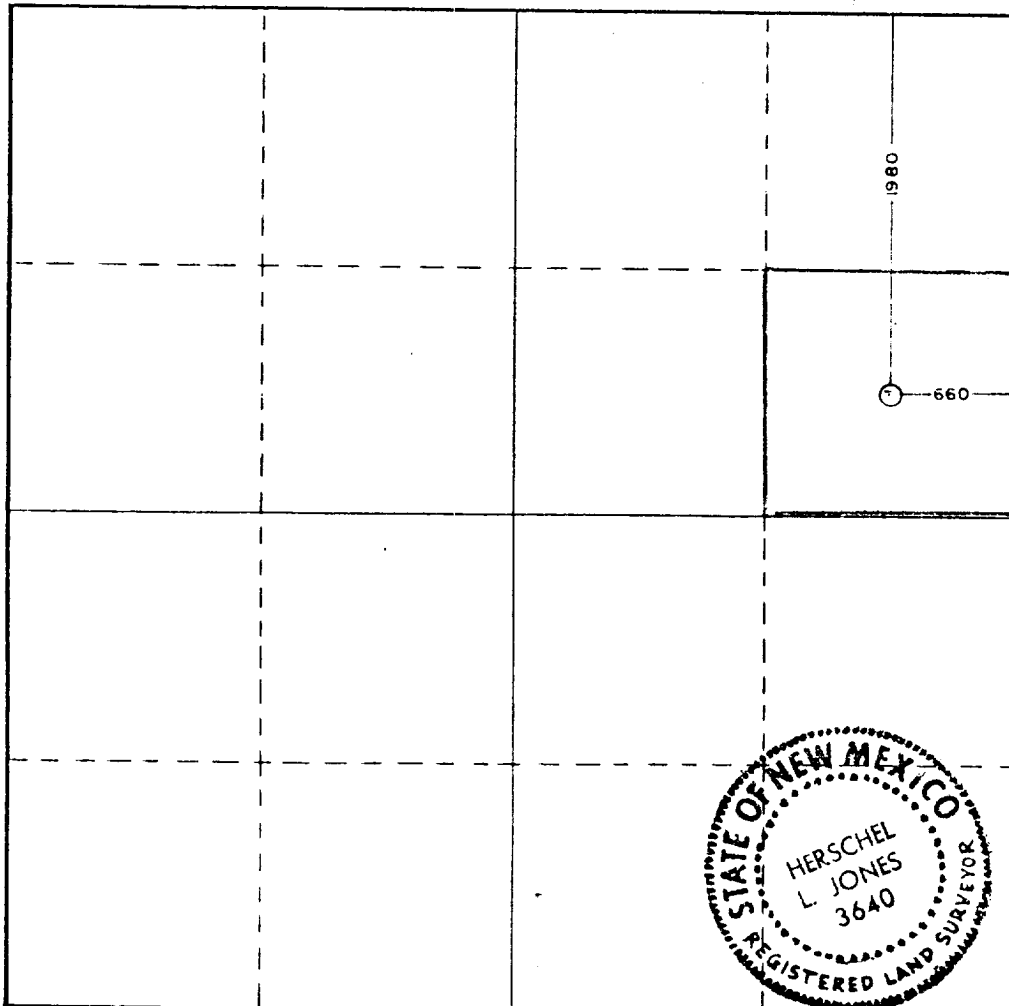

CERTIFICATION

I hereby certify that the information contained herein is true and complete to the best of my knowledge and belief.

Name
Dale R. Crockett
Position
Area Superintendent
Company
Getty Oil Company

Date
September 13, 1984

I hereby certify that the well location shown on this plat was plotted from field notes of actual surveys made by me or under my supervision, and that the same is true and correct to the best of my knowledge and belief.

Date Surveyed
September 6, 1984

Registered Professional Engineer and/or Land Surveyor

Certificate No.
3640