

30-025-28949

NO. OF COPIES RECEIVED	
DISTRIBUTION	
SANTA FE	
FILE	
U.S.G.S.	
LAND OFFICE	
OPERATOR	

NEW MEXICO OIL CONSERVATION COMMISSION

0+6-NMOCD-Hobbs 1-Mr. J.A.-Midland
1-File
1-Engr PJB
1-Foreman CRM

Form C-101
Revised 1-1-65

5A. Indicate Type of Lease	
STATE <input type="checkbox"/>	FEE <input checked="" type="checkbox"/>
5. State Oil & Gas Lease No.	

APPLICATION FOR PERMIT TO DRILL, DEEPEN, OR PLUG BACK

1a. Type of Work		7. Unit Agreement Name	
b. Type of Well OIL WELL <input checked="" type="checkbox"/> GAS WELL <input type="checkbox"/> OTHER <input type="checkbox"/> DEEPEN <input type="checkbox"/> PLUG BACK <input type="checkbox"/>		Skelly Penrose A Unit	
2. Name of Operator Getty Oil Company		8. Farm or Lease Name	
3. Address of Operator P.O. Box 730, Hobbs, New Mexico 88240		9. Well No. 68	
4. Location of Well UNIT LETTER N LOCATED 58.3 FEET FROM THE South LINE AND 2555.4 FEET FROM THE West LINE OF SEC. 3 TWP. 23S RGE. 37E NMPM		10. Field and Pool, or Wildcat Langlie Mattix	
11. County Lea		12. County Lea	
19. Proposed Depth 3750		19A. Formation Queen-Penrose	
20. Rotary or C.T. Rotary		21. Elevations (show whether DE, RT, etc.) 3300.7 GL	
21A. Kind & Status Plug. Bond Blanket		21B. Drilling Contractor Pending	
22. Approx. Date Work will start Pending			

PROPOSED CASING AND CEMENT PROGRAM

SIZE OF HOLE	SIZE OF CASING	WEIGHT PER FOOT	SETTING DEPTH	SACKS OF CEMENT	EST. TOP
12 1/4	8 5/8	24	500	330 sx	surface
7 7/8	5 1/2	15.5	3750	505 sx	surface

- The above casing program will be used to drill the Queen-Penrose sand. The mud system will be fresh water from surface to 500'. Brine and brackish water will be used from 500' to TD. The Queen and Penrose sections will be selectively perforated according to electric logs.
- The above unorthodox location was approved by NSL-1896.
- See attachment for BOP arrangement.

See Review Casing Program
NSL-1896

APPROVAL VALID FOR 180 DAYS
PERMIT EXPIRES 4/17/85
UNLESS DRILLING UNDERWAY

IN ABOVE SPACE DESCRIBE PROPOSED PROGRAM; IF PROPOSAL IS TO DEEPEN OR PLUG BACK, GIVE DATA ON PRESENT PRODUCTIVE ZONE AND PROPOSED NEW PRODUCTIVE ZONE. GIVE BLOWOUT PREVENTER PROGRAM, IF ANY.

I hereby certify that the information above is true and complete to the best of my knowledge and belief.

Signed Eddie W. Seay Title Area Superintendent Date 9/26/84
Eddie R. Crockett

(This space for State Use)

Eddie W. Seay

APPROVED BY Oil & Gas Inspector TITLE DATE OCT 1 1984
CONDITIONS OF APPROVAL, IF ANY:

RECEIVED

SEP 28 1984

HOLLYWOOD

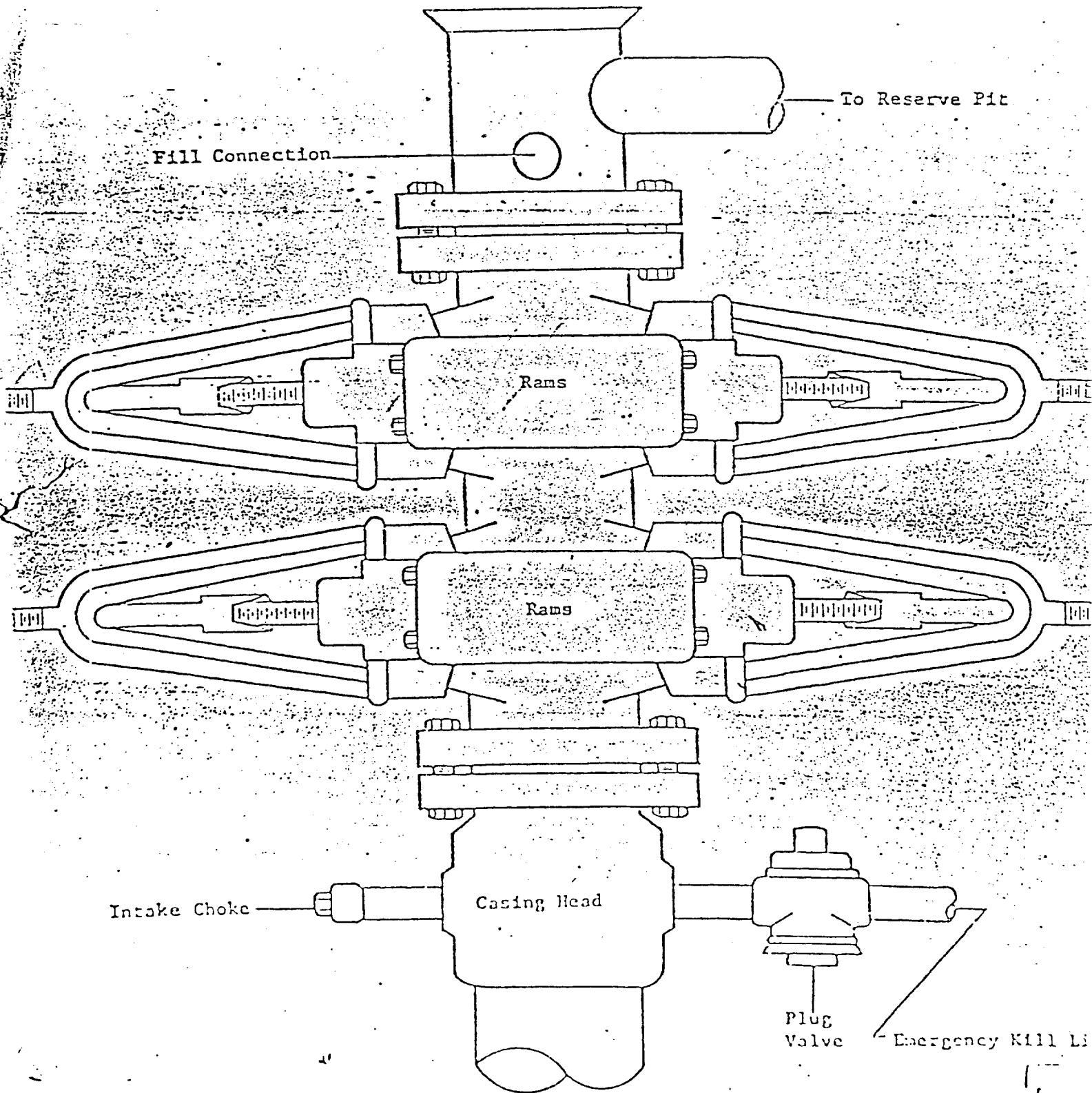

FIGURE I
GETTY OIL COMPANY

5000 PSI WORKING PRESSURE

RECEIVED

SEP 28 1984

200
HOBBS OFFICE

**NEW MEXICO OIL CONSERVATION COMMISSION
WELL LOCATION AND ACREAGE DEDICATION PLAT**

Form C-102
Supersedes C-128
Effective 1-1-65

All distances must be from the outer boundaries of the Section.

Operator GETTY OIL COMPANY			Lease Skelly Penrose A Unit		Well No. 68
Unit Letter N	Section 3	Township 23 South	Range 37 East	County Lea	
Actual Footage Location of Well: 58.3 feet from the South line and 2555.4 feet from the West line					
Ground Level Elev. 3300.7	Producing Formation Queen-Penrose		Pool Langlie Mattix		Dedicated Acreage: 40 Acres

1. Outline the acreage dedicated to the subject well by colored pencil or hatchure marks on the plat below.
2. If more than one lease is dedicated to the well, outline each and identify the ownership thereof (both as to working interest and royalty).
3. If more than one lease of different ownership is dedicated to the well, have the interests of all owners been consolidated by communitization, unitization, force-pooling, etc.?

☐ Yes ☐ No If answer is "yes," type of consolidation _____

If answer is "no," list the owners and tract descriptions which have actually been consolidated. (Use reverse side of this form if necessary.) _____

No allowable will be assigned to the well until all interests have been consolidated (by communitization, unitization, forced-pooling, or otherwise) or until a non-standard unit, eliminating such interests, has been approved by the Commission.

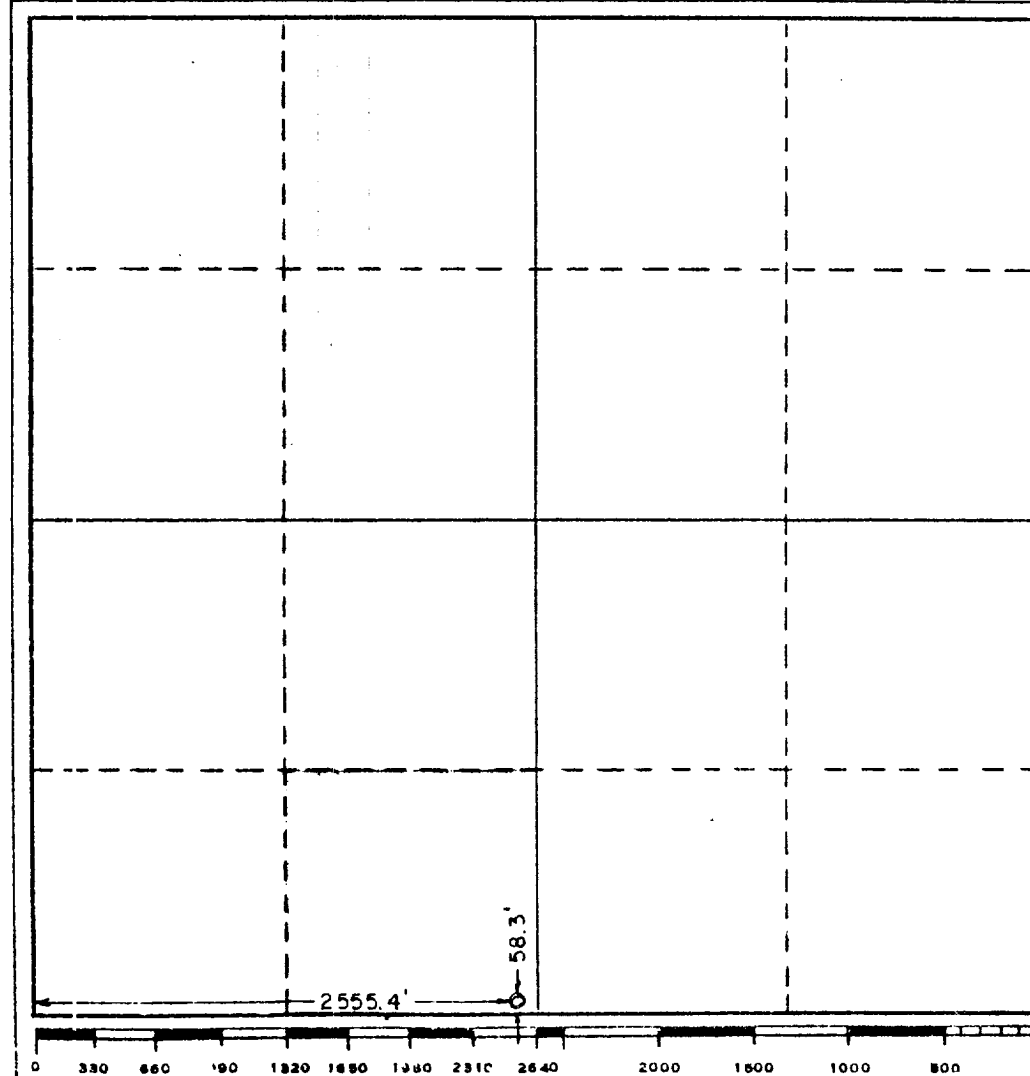

CERTIFICATION

I hereby certify that the information contained herein is true and complete to the best of my knowledge and belief.

Name
Dale R. Crockett

Position
Area Superintendent

Company
Getty Oil Company

Date
9/26/84

I hereby certify that the well location shown on this plat was plotted from field notes of actual surveys made by me or under my supervision, and that the same is true and correct to the best of my knowledge.

Date Surveyed
August 3, 1984

Registered Professional Engineer and/or Land Surveyor

Certificate No.

3640

RECEIVED

SEP 28 1984

HOBBY OFFICE