

70-025-29308

NO. OF COPIES RECEIVED	
DISTRIBUTION	
SANTA FE	
FILE	
U.S.G.S.	
LAND OFFICE	
OPERATOR	

NEW MEXICO OIL CONSERVATION COMMISSION

Form C-101
Revised 1-1-65

5A. Indicate Type of Lease
STATE <input checked="" type="checkbox"/> FEE <input type="checkbox"/>
5. State Oil & Gas Lease No.
N/A

APPLICATION FOR PERMIT TO DRILL, DEEPEN, OR PLUG BACK

1a. Type of Work			7. Unit Agreement Name		
b. Type of Well DRILL <input checked="" type="checkbox"/> DEEPEN <input type="checkbox"/> PLUG BACK <input type="checkbox"/>			N.E. Salado Draw (Deep) U		
OIL WELL <input type="checkbox"/> GAS WELL <input checked="" type="checkbox"/> OTHER <input type="checkbox"/> SINGLE ZONE <input checked="" type="checkbox"/> MULTIPLE ZONE <input type="checkbox"/>			8. Farm or Lease Name		
2. Name of Operator			9. Well No.		
SOHIO PETROLEUM COMPANY			2		
3. Address of Operator			10. Field and Pool, or Wildcat		
#10 DESTA DRIVE, 600 WEST, MIDLAND, TEXAS 79705					
4. Location of Well			12. County		
UNIT LETTER <u>P</u> LOCATED <u>1075'</u> FEET FROM THE <u>South</u> LINE			LEA		
AND <u>990'</u> FEET FROM THE <u>East</u> LINE OF SEC. <u>36</u> TWP. <u>25S</u> RGE. <u>33E</u> NMPM					
			19. Proposed Depth		
			16,400'		
			19A. Formation		
			MORROW/WLFEMP.		
			20. Rotary or C.T.		
			ROTARY		
21. Elevations (Show whether DF, RT, etc.)			21B. Drilling Contractor		
3121.0'			UNKNOWN		
21A. Kind & Status Plug. Bond			22. Approx. Date Work will start		
ON FILE			7-1-85		

PROPOSED CASING AND CEMENT PROGRAM

SIZE OF HOLE	SIZE OF CASING	WEIGHT PER FOOT	SETTING DEPTH	SACKS OF CEMENT	EST. TOP
20"	16"	65 & 75	1000'	2000	Surface
12 1/2"	10 3/4"	51	5200'	5400	Surface
9 1/2"	7 3/4"	46.1	13,000'	3500	5000'
6 1/2"	5"	23.2	16,400-12,700'	400	12,600'

SEE ATTACHED BOP PROGRAM AND WELLHEAD EQUIPMENT

Permit Expires 6 Months From Approval
Date Unless Drilling Unlawful.

IN ABOVE SPACE DESCRIBE PROPOSED PROGRAM: IF PROPOSAL IS TO DEEPEN OR PLUG BACK, GIVE DATA ON PRESENT PRODUCTIVE ZONE AND PROPOSED NEW PRODUCTIVE ZONE. GIVE BLOWOUT PREVENTER PROGRAM, IF ANY.

I hereby certify that the information above is true and complete to the best of my knowledge and belief.

Signed E.A. RIKE Title DISTRICT DRILLING ENGINEER Date 5-29-85

(This space for State Use)

ORIGINAL SIGNED BY JERRY SEXTON

APPROVED BY DISTRICT SUPERVISOR TITLE

CONDITIONS OF APPROVAL, IF ANY:

AUG 20 1985

**NEW MEXICO OIL CONSERVATION COMMISSION
WELL LOCATION AND ACREAGE DEDICATION PLAT**

Form C-102
Supersedes C-128
Effective 1-1-65

All distances must be from the outer boundaries of the Section.

Operator Sohio Petroleum Company			Lease <i>W. Salado Fed. Unit</i>		Well No. 2
Unit Letter P	Section 36	Township 25-South	Range 33-East	County Lea	
Actual Footage Location of Well: 1075 feet from the South line and 990 feet from the East line					
Ground Level Elev. 3121.0'	Producing Formation MORROW/WOLFCAMP		Pool		Dedicated Acreage: 320 Acres

1. Outline the acreage dedicated to the subject well by colored pencil or hatchure marks on the plat below.
2. If more than one lease is dedicated to the well, outline each and identify the ownership thereof (both as to working interest and royalty).
3. If more than one lease of different ownership is dedicated to the well, have the interests of all owners been consolidated by communitization, unitization, force-pooling, etc?

☒ Yes ☐ No If answer is "yes," type of consolidation Unitization

If answer is "no," list the owners and tract descriptions which have actually been consolidated. (Use reverse side of this form if necessary.) _____

No allowable will be assigned to the well until all interests have been consolidated (by communitization, unitization, forced-pooling, or otherwise) or until a non-standard unit, eliminating such interests, has been approved by the Commission.

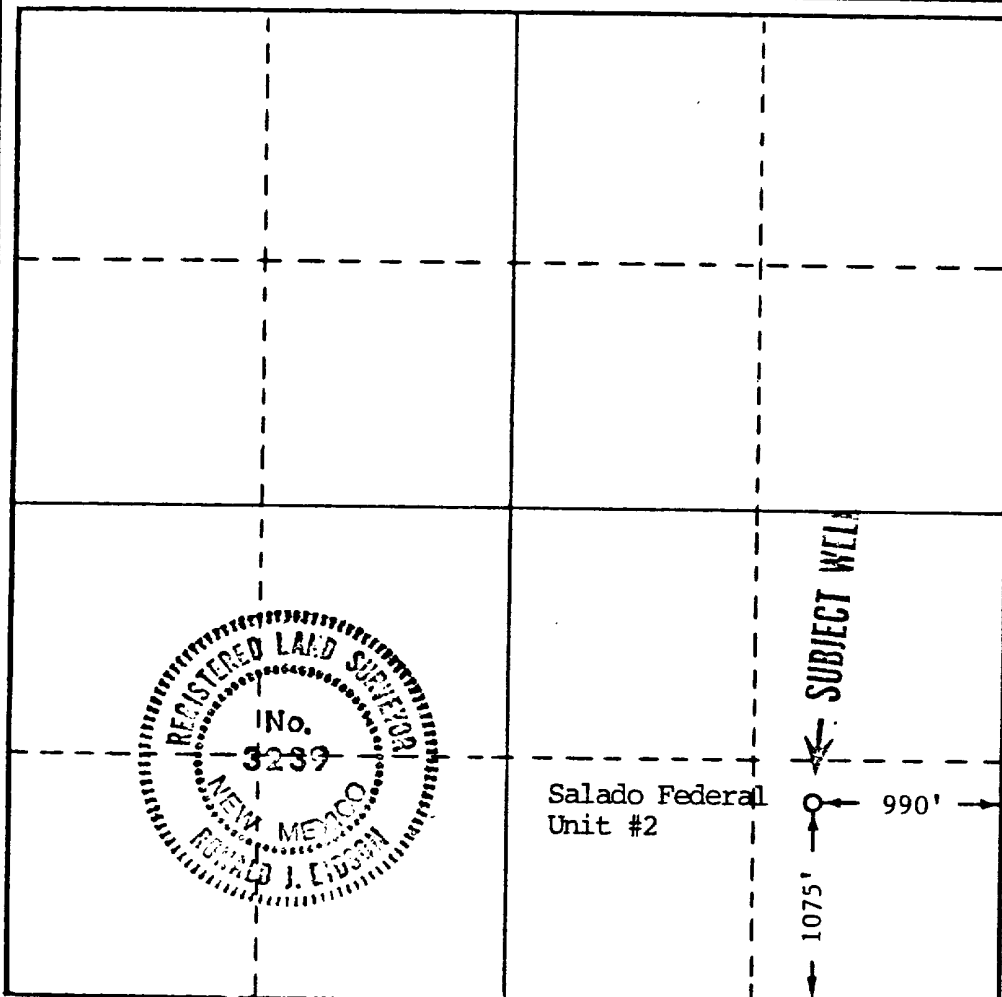

CERTIFICATION

I hereby certify that the information contained herein is true and complete to the best of my knowledge and belief.

Name

E.A. Rike

Position

District Drilling Engineer

Company

Sohio Petroleum Company

Date

5-28-85

I hereby certify that the well location shown on this plat was plotted from field notes of actual surveys made by me or under my supervision, and that the same is true and correct to the best of my knowledge and belief.

Date Surveyed

4-14-85

Registered Professional Engineer and/or Land Surveyor

Ronald J. Eidson

Certificate No. **JOHN WEST, 676**

RONALD J. EIDSON, 3239

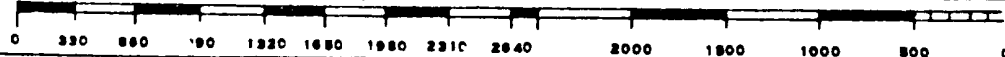

R 33 E

R 34 E

T 25 S

T 26 S

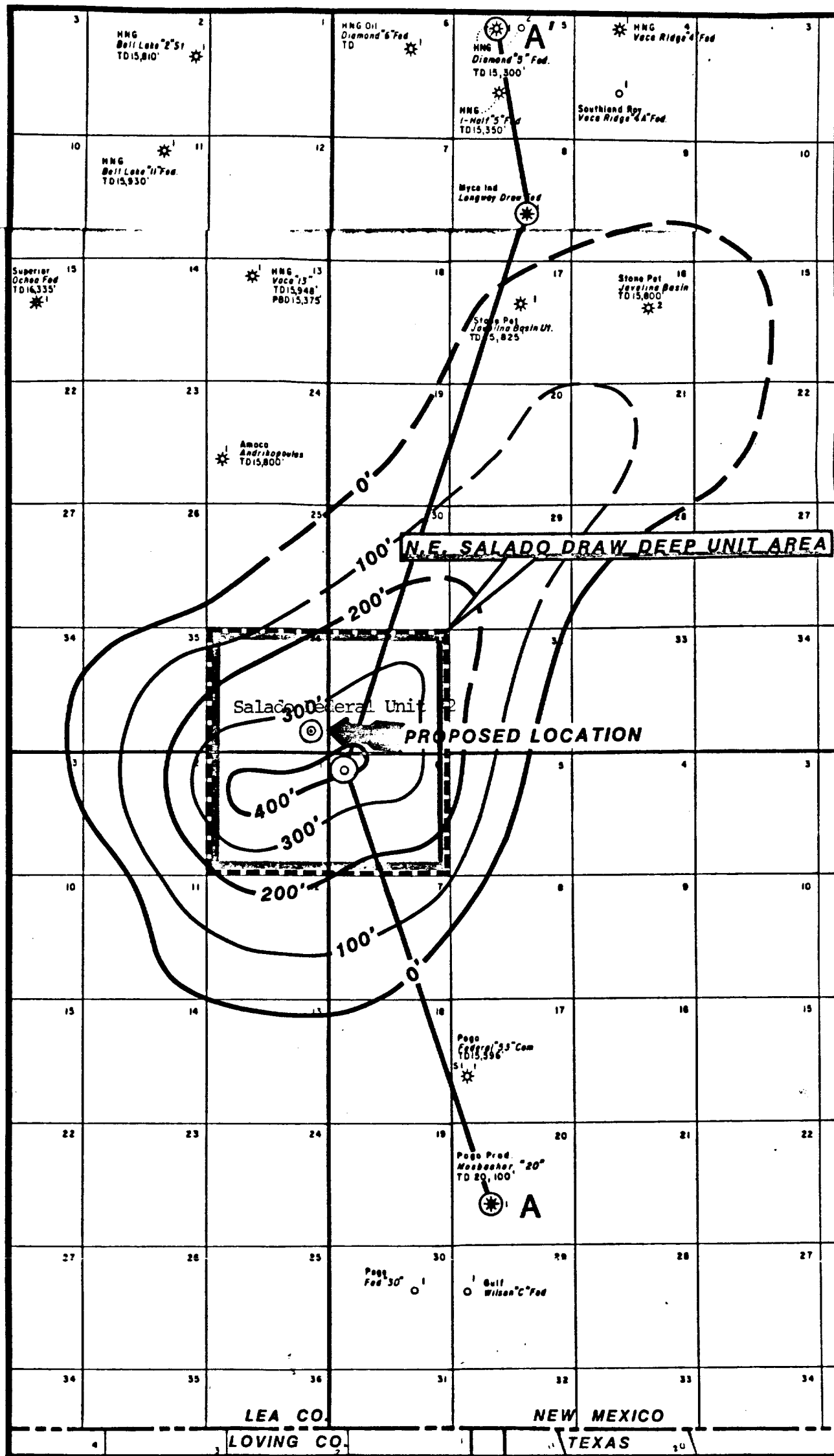

C.I. = 100'

ISOPACH MAP UPPER MORROW SEDIMENTS

SEISMICALLY DETERMINED ISOPACH

