

NO. OF COPIES RECEIVED	
DISTRIBUTION	
SANTA FE	
FILE	
U.S.G.S.	
LAND OFFICE	
OPERATOR	

P. O. BOX 2088

SANTA FE, NEW MEXICO 87501

5A. Indicate Type of Lease

STATE ☒ FEE ☐

5. State Oil & Gas Lease No.

B-1113-1

APPLICATION FOR PERMIT TO DRILL, DEEPEN, OR PLUG BACK

7. Unit Agreement Name

8. Farm or Lease Name

Central Vacuum Unit

9. Well No.

165

10. Field and Pool, or Wildcat

Vacuum Grayburg-SA

12. County

Lea

19. Proposed Depth

4720'

19A. Formation

Grayburg-SA

20. Rotary or C.T.

Rotary

21. Elevations (show whether DF, KT, etc.)

3975' GR

21A. Kind & Status Plug. Bond

Blanket

21B. Drilling Contractor

22. Approx. Date Work will start

January, 1986

PROPOSED CASING AND CEMENT PROGRAM

SIZE OF HOLE	SIZE OF CASING	WEIGHT PER FOOT	SETTING DEPTH	SACKS OF CEMENT	EST. TOP
24"	20"	94#	350'	700	Circulate
17-1/2"	13-3/8"	48#	1550'	1150	Circulate
12-1/4"	9-5/8"	1800'-32.3#	2800'	1600	Circulate
		1000'-36.0#			
8-1/2"	7"	23#	4300'	750	Circulate

Below 7" casing to TD will be drilled with 6-1/8" bit and completed open hole.

CEMENTING PROGRAM

SURFACE CASING: 700 sxs Class "H" with 2% CaCl and 1/4# flocele (15.6 ppg, 1.18 cu.ft./sx.).

1ST INTEREDIATE CASING: 900 sxs 50/50 Pozmix Class "H" with 2% CaCl, 1/4# flocele (14.15 ppg, 1.26 cu.ft./sx.) followed by 250 sxs Class "H" with 2% CaCl, 1/4# flocele (15.6 ppg, 1.18 cu.ft./sx.).

2ND INTEREDIATE CASING: 1ST STAGE: 750 sxs 50/50 Pozmix Class "H" with 10# salt (14.15 ppg, 1.28 cu.ft./sx.) followed by 250 sxs Class "H" with 2% CaCl (15.8 ppg, 1.18 cu.ft./sx.). 2ND STAGE: 600 sxs Class "H" with 2% CaCl (15.8 ppg, 1.18 cu.ft./sx.). (ECP @ 1560'. DV Tool above ECP.)

PRODUCTION CASING: 500 sxs 50/50 Pozmix Class "H" with 1/4# flocele (14.15 ppg, 1.28 cu.ft./sx.) followed by 250 sxs Class "H" with 1/4# flocele (15.8 ppg, 1.18 cu.ft./sx.).

N ABOVE SPACE DESCRIBE PROPOSED PROGRAM: IF PROPOSAL IS TO DEEPEN OR PLUG BACK, GIVE DATA ON PRESENT PRODUCTIVE ZONE AND PROPOSED NEW PRODUCTIVE ZONE. GIVE BLOWOUT PREVENTER PROGRAM, IF ANY.

hereby certify that the information above is true and complete to the best of my knowledge and belief.

W. A. Baker, II

Signed W. A. Baker, II Title District Drilling Manager Date October 23, 1985

(This space for State Use)

Eddie W. Seay

APPROVED BY Oil & Gas Inspector TITLE DATE

CONDITIONS OF APPROVAL, IF ANY:

DEC 9 - 1985

Permit Expires 6 Months From Approval
Date Unless Drilling Underway.

RECEIVED

OCT 29 1985

O.C.D.
HOBBS OFFICE

All distances must be from the outer boundaries of the Section.

Operator Texaco Producing Inc.		Lease Central Vacuum Unit		Well No. 165
Unit Letter F	Section 6	Township 18-S	Range 35-E	County Lea
Actual Footage Location of Well: 1911 feet from the North line and 2450 feet from the West line				
Ground Level Elev. 3975'	Producing Formation Vacuum San Andres	Pool Vacuum (Grayburg - San Andres)	Dedicated Acreage: 40 Acres	

1. Outline the acreage dedicated to the subject well by colored pencil or hachure marks on the plat below.
2. If more than one lease is dedicated to the well, outline each and identify the ownership thereof (both as to working interest and royalty).
3. If more than one lease of different ownership is dedicated to the well, have the interests of all owners been consolidated by communitization, unitization, force-pooling, etc?

☐ Yes ☐ No If answer is "yes," type of consolidation _____

If answer is "no," list the owners and tract descriptions which have actually been consolidated. (Use reverse side of this form if necessary.) _____

No allowable will be assigned to the well until all interests have been consolidated (by communitization, unitization, forced-pooling, or otherwise) or until a non-standard unit, eliminating such interests, has been approved by the Division.

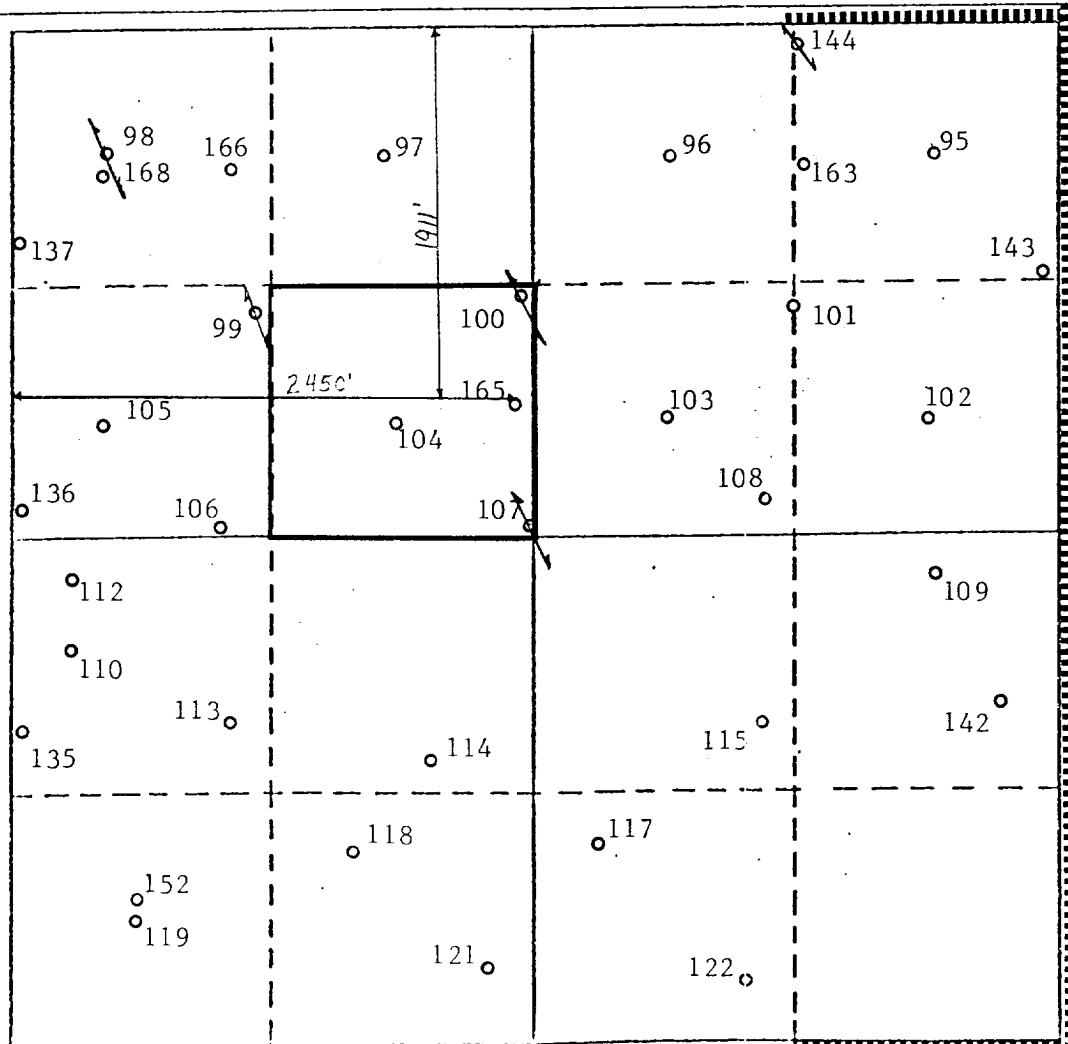

CERTIFICATION

I hereby certify that the information contained herein is true and complete to the best of my knowledge and belief.

B. L. Eiland

Name
B. L. Eiland
Position
Division Surveyor
Company
Texaco Producing Inc.
Date
September 20, 1985

I hereby certify that the well location shown on this plat was plotted from field notes of actual surveys made by me or under my supervision, and that the same is true and correct to the best of my knowledge and belief.

Date Surveyed
September 16, 1985
New Mexico
Registered Professional Engineer
and/or Land Surveyor
B. L. Eiland
B. L. Eiland
Certified No. 4386

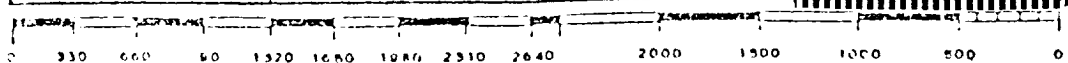

RECEIVED

OCT 29 1985

O.C.B.
HOBBY OFFICE