

Exxon Lse. No. _____ NE MEXICO OIL CONSERVATION COMMISSION
State Lse. No. _____ WELL LOCATION AND ACREAGE DEDICATION PLAT

Form C-102
Supersedes C-128
Effective 1-1-65

Federal Lse. No. _____ All distances must be from the outer boundaries of the Section.

| | | | | | |
|--|------------------------------------|-----------------|----------------------------|---------------|--------------------------------|
| Operator Exxon Corporation | | | Lease WHITE FEDERAL | | Well No. 3 |
| Unit Letter J | Section 5 | Township 18S | Range 32E | County LEA | |
| Actual Footage Location of Well: 1650 feet from the SOUTH line and 1980 feet from the EAST line | | | | | |
| Ground Level Elev. 3832.5' | Producing Formation BONE SPRING | | Pool UNDES. NORTH YOUNG | | Dedicated Acreage: 40 Acres |

1. Outline the acreage dedicated to the subject well by colored pencil or hachure marks on the plat below.
2. If more than one lease is dedicated to the well, outline each and identify the ownership thereof (both as to working interest and royalty).
3. If more than one lease of different ownership is dedicated to the well, have the interests of all owners been consolidated by communitization, unitization, force-pooling, etc?

☐ Yes ☐ No If answer is "yes," type of consolidation _____

If answer is "no," list the owners and tract descriptions which have actually been consolidated. (Use reverse side of this form if necessary.) _____

No allowable will be assigned to the well until all interests have been consolidated (by communitization, unitization, forced-pooling, or otherwise) or until a non-standard unit, eliminating such interests, has been approved by the Commission.

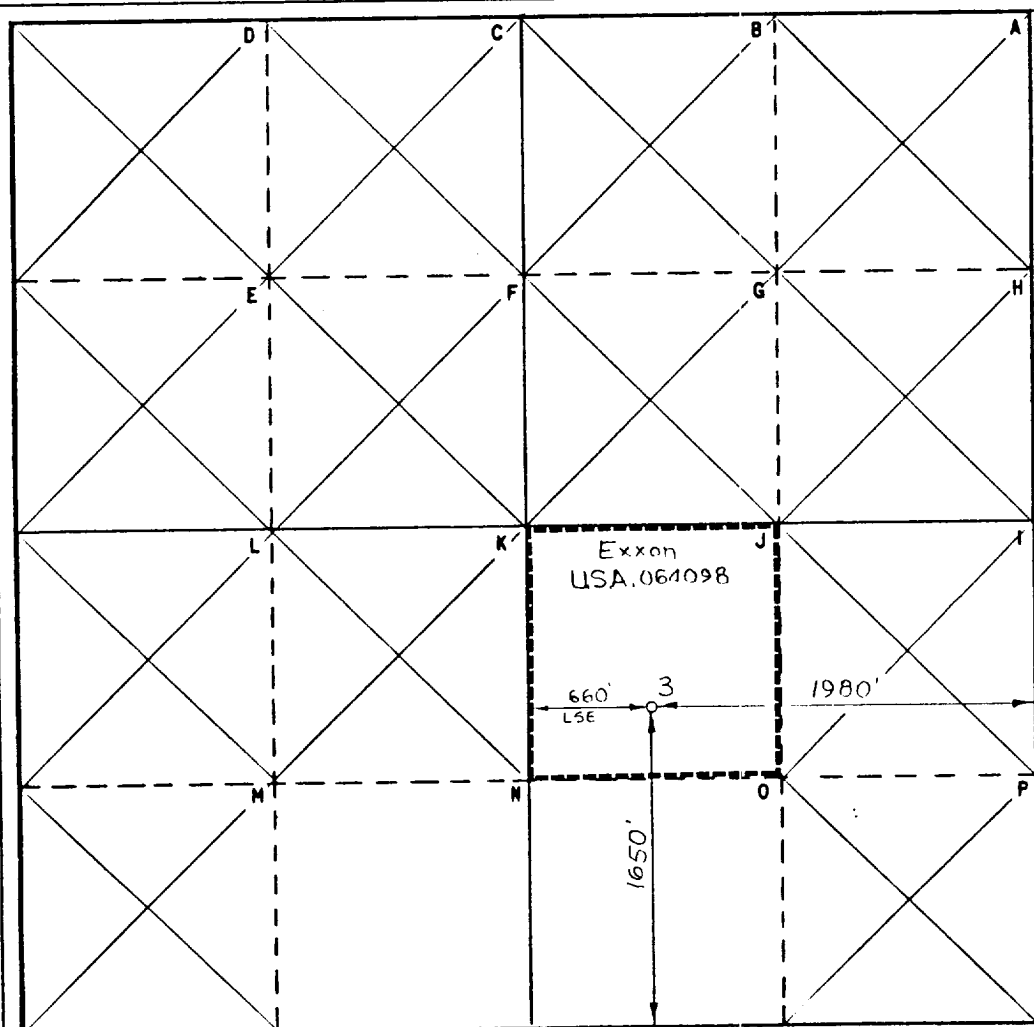

CERTIFICATION

I hereby certify that the information contained herein is true and complete to the best of my knowledge and belief.

Name
Melba Knippling
Position
UNIT HEAD

Company Exxon Corporation
Box 1600 Midland, Texas

Date
2-13-86

I hereby certify that the well location shown on this plat was plotted from field notes, actual surveys made by me or under my supervision, and that the same is true and correct to the best of my knowledge and belief.

Date Surveyed
1-3-86

Registered Professional Engineer
and/or Land Surveyor

Bruce R. Pennell
Certificate No.

9062

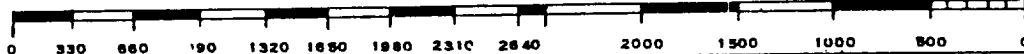

7.5 Miles SE of MALJAMAR, New Mexico

C.E. Sec. File No. W-A-9182-B

RECEIVED
MAR 4 - 1986
C.C.C.
HCBBS OFFICE