

NO. OF COPIES RECEIVED	
DISTRIBUTION	
SANTA FE	
FILE	
U.S.G.S.	
LAND OFFICE	
OPERATOR	

NEW MEXICO OIL CONSERVATION COMMISSION

Form C-101  
Revised 1-1-85

AMENDED APPLICATION - CHANGE OF LOCATION

APPLICATION FOR PERMIT TO DRILL, DEEPEN, OR PLUG BACK

1a. Type of Work  
b. Type of Well  
OIL WELL ☒ GAS WELL ☐ OTHER ☐  
2. Name of Operator  
SAGE ENERGY COMPANY  
3. Address of Operator  
P. O. DRAWER 3068, MIDLAND, TEXAS 79702  
4. Location of Well  
UNIT LETTER M LOCATED 560 FEET FROM THE South LINE  
AND 1100 FEET FROM THE West LINE OF SEC. 29 TWP. 14S RGE. 34E NMPM

5A. Indicate Type of Lease  
STATE ☐ FEE ☒  
5. State Oil & Gas Lease No.  
NA  
7. Unit Agreement Name  
8. Farm or Lease Name  
John Etcheverry, Jr.  
9. Well No.  
2  
10. Field and Pool, or Wildcat  
West Tres Papalotes Penn.  
12. County  
Lea

19. Proposed Depth  
10,600'  
19A. Formation  
Permo-Penn  
20. Rotary or C.T.  
Rotary  
21. Elevations (Show whether DF, RT, etc.)  
GL 4141.5  
21A. Kind & Status Plug. Bond  
NA  
21B. Drilling Contractor  
Sterling Drilling Co.  
22. Approx. Date Work will start  
March 9, 1987

23. PROPOSED CASING AND CEMENT PROGRAM

SIZE OF HOLE	SIZE OF CASING	WEIGHT PER FOOT	SETTING DEPTH	SACKS OF CEMENT	EST. TOP
17 1/2"	12 3/4"	32#	400±	350	Circulated
11"	8 5/8"	24# and 32#	4400±	400	400'
7 7/8"	4 1/2"	10.5# and 11.6# DV Tool	10,600± 6,000±	400 400	7900' 3200'

Blow out prevention system: 4 1/2" drill pipe rams  
Set of blanks  
Hydril clamped around Kelly

NSL R-8418  
IN ABOVE SPACE DESCRIBE PROPOSED PROGRAM: IF PROPOSAL IS TO DEEPEN OR PLUG BACK, GIVE DATA ON PRESENT PRODUCTIVE ZONE AND PROPOSED NEW PRODUCTIVE ZONE. GIVE BLOWOUT PREVENTER PROGRAM, IF ANY.

I hereby certify that the information above is true and complete to the best of my knowledge and belief.

Signed John W. West Title Agent Date 2-26-87

(This space for State Use)  
ORIGINAL SIGNED BY JERRY SEXTON  
DISTRICT I SUPERVISOR  
APPROVED BY \_\_\_\_\_ TITLE \_\_\_\_\_ DATE \_\_\_\_\_  
CONDITIONS OF APPROVAL, IF ANY:

MAR 30 1987

Permit Expires 6 Months From Approval  
Date Unless Drilling Underway.

**NEW MEXICO OIL CONSERVATION COMMISSION**  
**WELL LOCATION AND ACREAGE DEDICATION PLAT**

Form C-102  
 Supersedes C-128  
 Effective 1-1-65

All distances must be from the outer boundaries of the Section

Operator <b>SAGE ENERGY COMPANY</b>			Lease <b>JOHN ETCHEVERRY, Jr.</b>		Well No. <b>2</b>
Unit Letter <b>M</b>	Section <b>29</b>	Township <b>14 SOUTH</b>	Range <b>34 EAST</b>	County <b>LEA</b>	
Actual Footage Location of Well: <b>560</b> feet from the <b>SOUTH</b> line and <b>1100</b> feet from the <b>WEST</b> line					
Ground Level Elev. <b>4141.5</b>	Producing Formation <b>PERMO-PENN</b>		Pool <b>WEST TRES PAPALOTES PENN</b>	Dedicated Acreage: <b>160</b> Acres	

1. Outline the acreage dedicated to the subject well by colored pencil or hachure marks on the plat below.
2. If more than one lease is dedicated to the well, outline each and identify the ownership thereof (both as to working interest and royalty).
3. If more than one lease of different ownership is dedicated to the well, have the interests of all owners been consolidated by communitization, unitization, force-pooling, etc?

☐ Yes ☒ No If answer is "yes," type of consolidation \_\_\_\_\_

If answer is "no," list the owners and tract descriptions which have actually been consolidated. (Use reverse side of this form if necessary.) \_\_\_\_\_

No allowable will be assigned to the well until all interests have been consolidated (by communitization, unitization, forced-pooling, or otherwise) or until a non-standard unit, eliminating such interests, has been approved by the Commission.

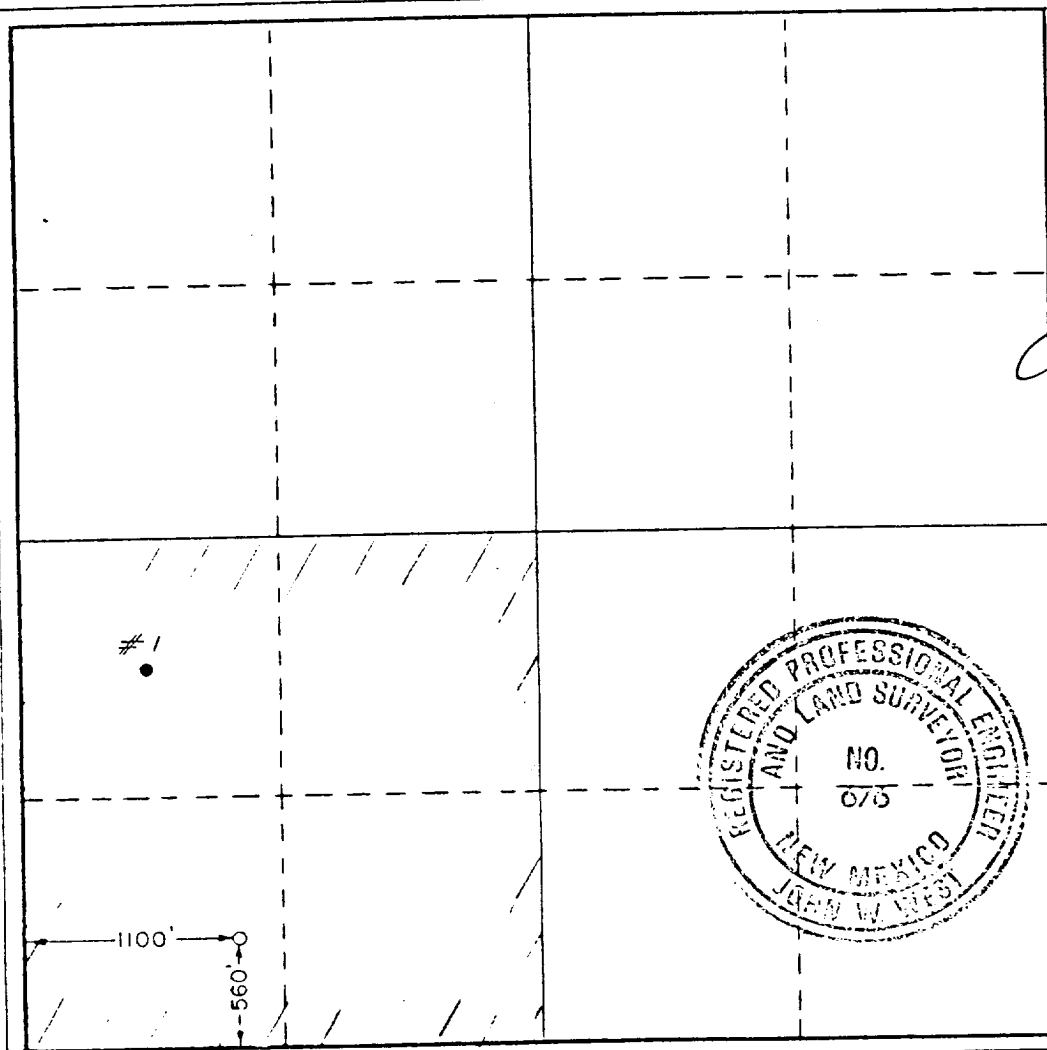

**CERTIFICATION**

I hereby certify that the information contained herein is true and complete to the best of my knowledge and belief.

Name *John W. West*

Position  
**AGENT**

Company  
**SAGE ENERGY COMPANY**

Date  
**FEB. 26, 1987**

I hereby certify that the well location shown on this plat was plotted from field notes of actual surveys made by me or under my supervision, and that the same is true and correct to the best of my knowledge and belief.

Date Surveyed  
**February 25, 1987**

Registered Professional Engineer and/or Land Surveyor

*John W. West*

Certificate No. **JOHN W. WEST, 676**  
**RONALD J. EIDSON, 3239**