

STATE OF NEW MEXICO  
ENERGY AND MINERALS DEPARTMENT

OIL CONSERVATION DIVISION

P. O. BOX 2088  
SANTA FE, NEW MEXICO 87501

Form C-101  
Revised 10-1-78

|                        |  |
|------------------------|--|
| NO. OF COPIES RECEIVED |  |
| DISTRIBUTION           |  |
| SANTA FE               |  |
| FILE                   |  |
| U.S.G.S.               |  |
| LAND OFFICE            |  |
| OPERATOR               |  |

5A. Indicate Type of Lease  
STATE ☒ FEE ☐

5. State Oil & Gas Lease No.  
V-2037

APPLICATION FOR PERMIT TO DRILL, DEEPEN, OR PLUG BACK

|   |  |  |
|---|--|--|
| 1a. Type of Work<br>DRILL <input checked="" type="checkbox"/> DEEPEN <input type="checkbox"/> PLUG BACK <input type="checkbox"/>  |  | 7. Unit Agreement Name                                     |
| b. Type of Well<br>OIL WELL <input checked="" type="checkbox"/> GAS WELL <input type="checkbox"/> OTHER <input type="checkbox"/> SINGLE ZONE <input checked="" type="checkbox"/> MULTIPLE ZONE <input type="checkbox"/> |  | 8. Farm or Lease Name<br>New Mexico "FC" State             |
| 2. Name of Operator<br>Exxon Corporation Attn: David A. Murray  |  | 9. Well No.<br>2   |
| 3. Address of Operator<br>P. O. Box 1600, Midland, TX 79702   |  | 10. Field and Pool, or Wildcat Undesig.<br>Dean Permo-Penn |
| 4. Location of Well<br>UNIT LETTER Lot 3 LOCATED 660 FEET FROM THE North LINE<br>AND 2400 FEET FROM THE West LINE OF SEC. 6 TWP. 16S RGE. 37E NMPM  |  | 12. County<br>Lea  |
| 19. Proposed Depth<br>12,000  |  | 19A. Formation<br>Strawn                                   |
| 20. Rotary or C.T.<br>Rotary  |  |  |
| 21. Elevations (Show whether DF, RT, etc.)<br>GR 3872'  | 21A. Kind & Status Plug. Bond<br>Blanket | 21B. Drilling Contractor<br>Unknown                        |
| 22. Approx. Date Work will start<br>9-15-87   |  |  |

23.

PROPOSED CASING AND CEMENT PROGRAM

| SIZE OF HOLE | SIZE OF CASING | WEIGHT PER FOOT | SETTING DEPTH | SACKS OF CEMENT | EST. TOP |
|--------------|----------------|-----------------|---------------|-----------------|----------|
| 17 1/2       | 13 3/8"        | 54.5            | 350           | 400 sx CLC      | Surface  |
| 11           | 8 5/8"         | 24, 32          | 4400          | 1300 sx CLC     | Surface  |
| 7 7/8        | 5 1/2"         | 15.5, 17, 20    | 12000         | 800 sx CLH      | 4000'    |

Blow out Preventer Program Attached

IN ABOVE SPACE DESCRIBE PROPOSED PROGRAM; IF PROPOSAL IS TO DEEPEN OR PLUG BACK, GIVE DATA ON PRESENT PRODUCTIVE ZONE AND PROPOSED NEW PRODUCTIVE ZONE. GIVE BLOWOUT PREVENTER PROGRAM, IF ANY.

I hereby certify that the information above is true and complete to the best of my knowledge and belief.

Signed David A. Murray Title Permits Supervisor Date 8-31-87  
(This space for State Use)

APPROVED BY Eddie W. Seay TITLE Oil & Gas Inspector DATE SEP 8 1987

Production pending NSP approval

Permit Expires 6 Months From Approval Date Unless Drilling Underway.

State License No. \_\_\_\_\_ WELL LOCATION AND ACREAGE DEDICATION PLAT

Federal License No. \_\_\_\_\_ All distances must be from the outer boundaries of the Section.

|   |                                      |                                       |  |                      |                      |
|---|--------------------------------------|---------------------------------------|--|----------------------|----------------------|
| Operator<br><b>Exxon Corporation</b>  |                                      |                                       | Lease<br><b>NEW MEXICO "FC" STATE</b>    |                      | Well No.<br><b>2</b> |
| Unit Letter<br><b>LOT 3</b>   | Section<br><b>6</b>                  | Township<br><b>16 S</b>               | Range<br><b>37 E</b>                     | County<br><b>LEA</b> |                      |
| Actual Footage Location of Well:<br><b>660</b> feet from the <b>NORTH</b> line and <b>2400</b> feet from the <b>WEST</b> line |                                      |                                       |  |                      |                      |
| Ground Level Elev.<br><b>3872</b>   | Producing Formation<br><b>STRAWN</b> | Pool<br><b>UNDES. DEAN PERMO-PENN</b> | Dedicated Acreage:<br><b>91.28</b> Acres |                      |                      |

1. Outline the acreage dedicated to the subject well by colored pencil or hachure marks on the plat below.
2. If more than one lease is dedicated to the well, outline each and identify the ownership thereof (both as to working interest and royalty).
3. If more than one lease of different ownership is dedicated to the well, have the interests of all owners been consolidated by communitization, unitization, force-pooling, etc?

☐ Yes ☐ No If answer is "yes," type of consolidation \_\_\_\_\_

If answer is "no," list the owners and tract descriptions which have actually been consolidated. (Use reverse side of this form if necessary.) \_\_\_\_\_

No allowable will be assigned to the well until all interests have been consolidated (by communitization, unitization, forced-pooling, or otherwise) or until a non-standard unit, eliminating such interests, has been approved by the Commission.

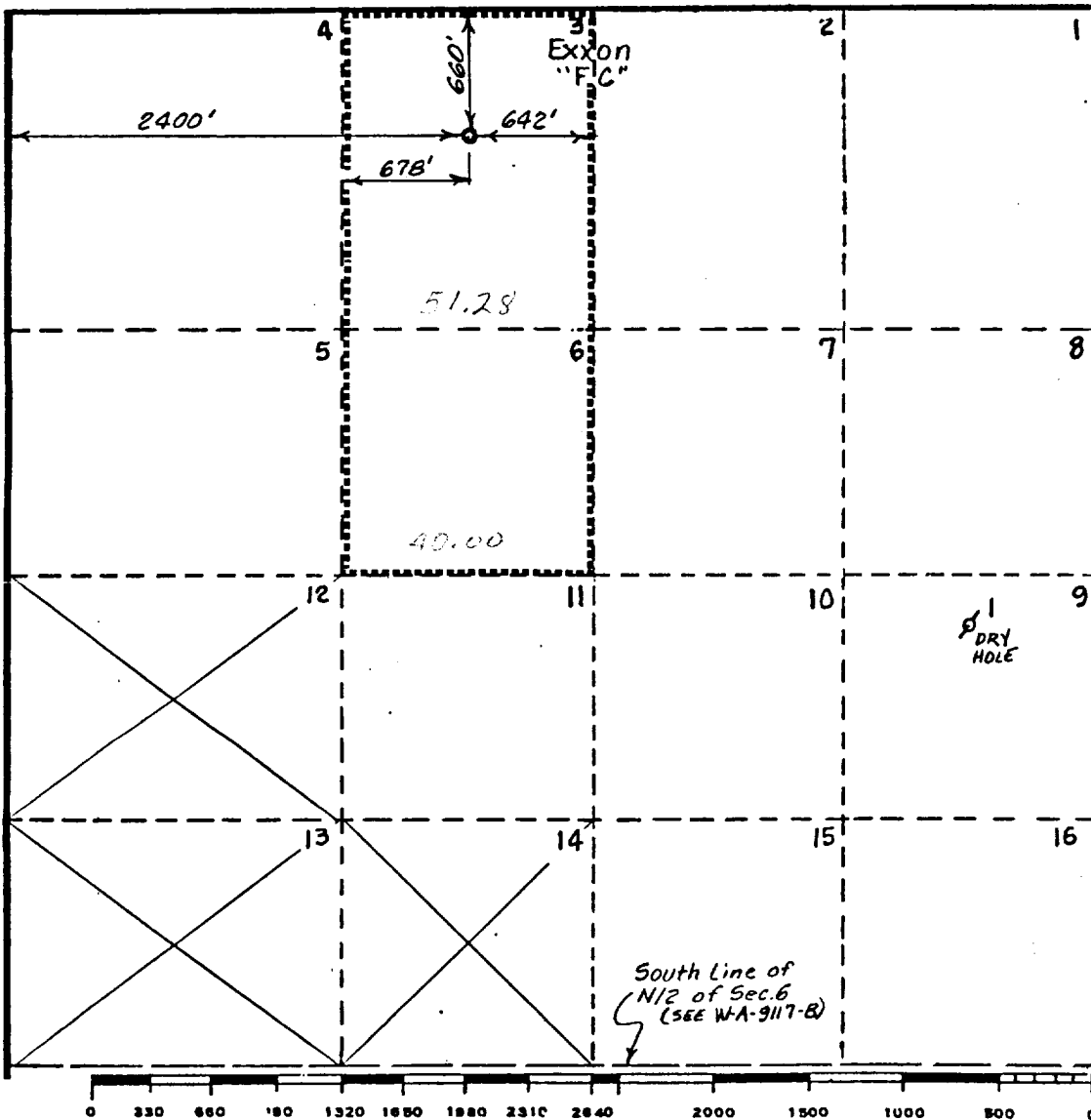

# CERTIFICATION

I hereby certify that the information contained herein is true and complete to the best of my knowledge and belief.

Name **David A. Murray**  
Position **Permits Supervisor**

Company **Exxon Corporation**  
**Box 1600 Midland, Texas**

Date **9-2-87**

I hereby certify that the well location shown on this plat was plotted from field notes of actual surveys made by me or under my supervision, and that the same is true and correct to the best of my knowledge and belief.

Date Surveyed **8-14-87**

Registered Professional Engineer and/or Land Surveyor

**Bruce R. Pennell**  
Certificate No. **9262**

# TYPE RRA BOP STACK

THREE PREVENTERS

8 5/8"

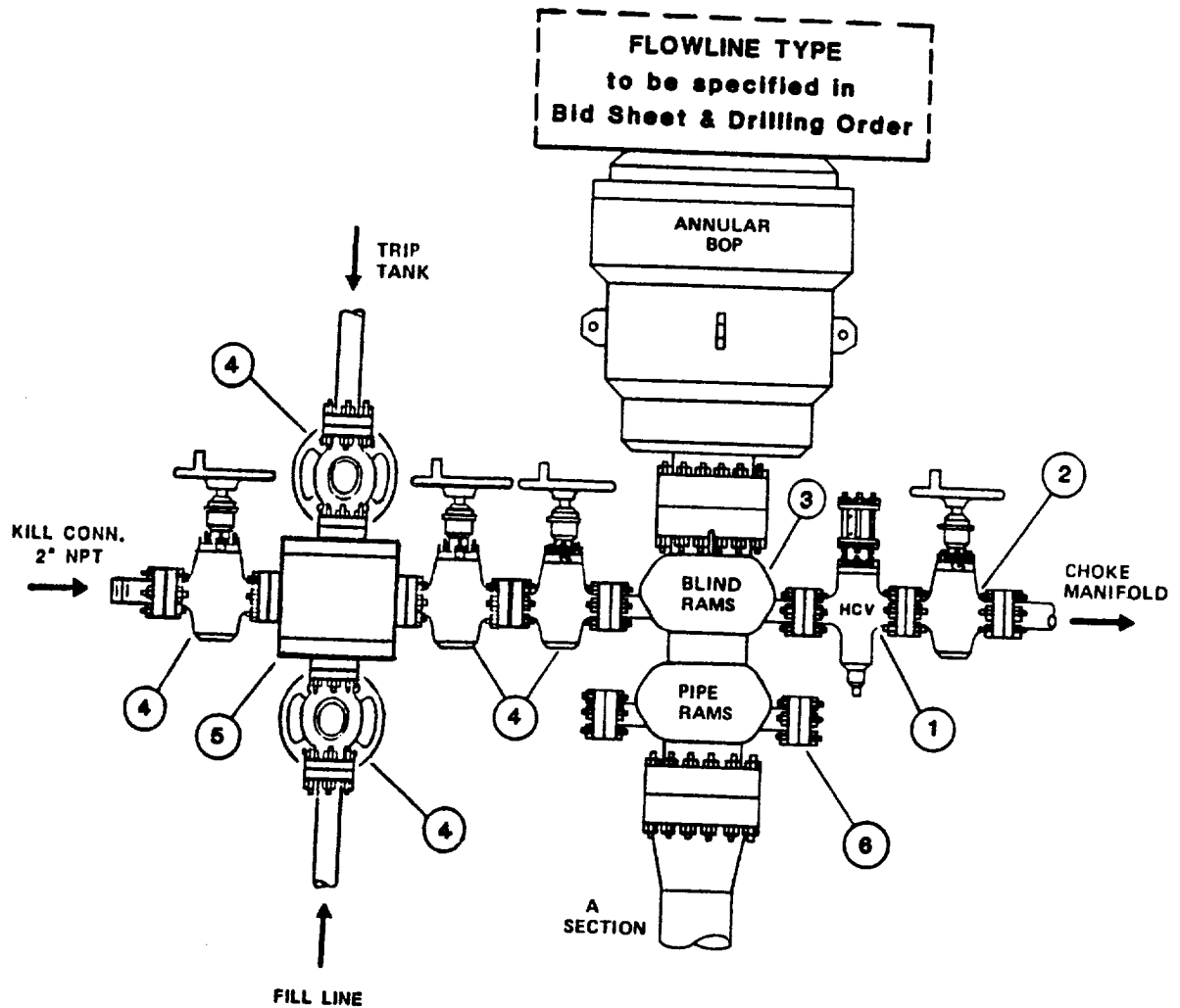

# TYPE SA BOP

13 <sup>3</sup>/<sub>8</sub>"

