

00725 30002

STATE OF NEW MEXICO  
ENERGY AND MINERALS DEPARTMENT

OIL CONSERVATION DIVISION

P. O. BOX 2088  
SANTA FE, NEW MEXICO 87501

Form C-101  
Revised 10-1-78

NO. OF COPIES RECEIVED	
DISTRIBUTION	
SANTA FE	
FILE	
U.S.G.S.	
LAND OFFICE	
OPERATOR	

5A. Indicate Type of Lease  
STATE ☒ FEE ☐  
5. State Oil & Gas Lease No.  
B-10272

APPLICATION FOR PERMIT TO DRILL, DEEPEN, OR PLUG BACK

1a. Type of Work b. Type of Well OIL WELL <input type="checkbox"/> GAS WELL <input type="checkbox"/> OTHER Water injection well <input checked="" type="checkbox"/> SINGLE ZONE <input checked="" type="checkbox"/> MULTIPLE ZONE <input type="checkbox"/>		DRILL <input checked="" type="checkbox"/> DEEPEN <input type="checkbox"/> PLUG BACK <input type="checkbox"/>	7. Unit Agreement Name West Dollarhide Queen Sand Unit 8. Farm or Lease Name
2. Name of Operator Sirgo-Collier, Inc.		9. Well No. 145	10. Field and Pool, or Wildcat Dollarhide Queen
3. Address of Operator P. O. Box 3531, Midland, Texas 79702			
4. Location of Well UNIT LETTER <u>A</u> LOCATED <u>1050</u> FEET FROM THE <u>North</u> LINE AND <u>620</u> FEET FROM THE <u>East</u> LINE OF SEC. <u>6</u> TWP. <u>25S</u> REC. <u>38E</u> NMPM		17. County Lea	
19. Proposed Depth 3900'		19A. Formation Queen	20. Rotary or C.T. Rotary
21. Elevations (Show whether DF, RT, etc.) 3124' GR	21A. Kind & Status Plug. Bond Cash Statewide	21B. Drilling Contractor	22. Approx. Date Work will start July 1988

23.

PROPOSED CASING AND CEMENT PROGRAM

SIZE OF HOLE	SIZE OF CASING	WEIGHT PER FOOT	SETTING DEPTH	SACKS OF CEMENT	EST. TOP
12-1/4"	8-5/8"	24#	420'	250 sx	Surface
7-7/8"	5-1/2"	15.5 & 17#	3900'	1000 sx	Surface

The Queen zone will be selectively perforated and acidized as needed for optimum water injectivity rates.

Texaco Producing, Inc. operates the West Dollarhide Drinkard Unit #80, also located in this quarter quarter section.

4. ABOVE SPACE DESCRIBE PROPOSED PROGRAM; IF PROPOSAL IS TO DEEPEN OR PLUG BACK, GIVE DATA ON PRESENT PRODUCTIVE ZONE AND PROPOSED NEW PRODUCTIVE ZONE. GIVE BLOWOUT PREVENTER PROGRAM, IF ANY.

hereby certify that the information above is true and complete to the best of my knowledge and belief.

Signed Amy L. Whittle Title Agent Date March 9, 1988

(This space for State Use)

APPROVED BY ORIGINAL SIGNED BY JERRY SEXTON TITLE DISTRICT SUPERVISOR DATE APR 13 1988  
CONDITIONS OF APPROVAL, IF ANY:

• NSL 2488 WEX-570

Permit Expires 6 Months From Approval  
Date Unless Drilling Underway.

N MEXICO OIL CONSERVATION COMMISSION  
WELL LOCATION AND ACREAGE DEDICATION PLAT

Form C-102  
Supersedes C-128  
Effective 1-1-65

All distances must be from the outer boundaries of the Section.

Operator <b>SIRGO-COLLIER, INC.</b>		Lease <b>WDQSU (West Dollarhide Queen Sand Unit)</b>		Well No. <b>145</b>
Unit Letter <b>A</b>	Section <b>6</b>	Township <b>25 South</b>	Range <b>38 East</b>	County <b>Lea County, N.M.</b>
Actual Footage Location of Well: <b>1050</b> feet from the <b>North</b> line and <b>620</b> feet from the <b>East</b> line				
Ground Level Elev. <b>3124.</b>	Producing Formation <b>Queen</b>	Pool <b>Dollarhide Queen</b>	Dedicated Acreage: <b>40</b> Acres	

1. Outline the acreage dedicated to the subject well by colored pencil or hachure marks on the plat below.
2. If more than one lease is dedicated to the well, outline each and identify the ownership thereof (both as to working interest and royalty).
3. If more than one lease of different ownership is dedicated to the well, have the interests of all owners been consolidated by communitization, unitization, force-pooling, etc?

☒ Yes    ☐ No    If answer is "yes," type of consolidation Unitization, R-2356

If answer is "no," list the owners and tract descriptions which have actually been consolidated. (Use reverse side of this form if necessary.) \_\_\_\_\_

No allowable will be assigned to the well until all interests have been consolidated (by communitization, unitization, forced-pooling, or otherwise) or until a non-standard unit, eliminating such interests, has been approved by the Commission.

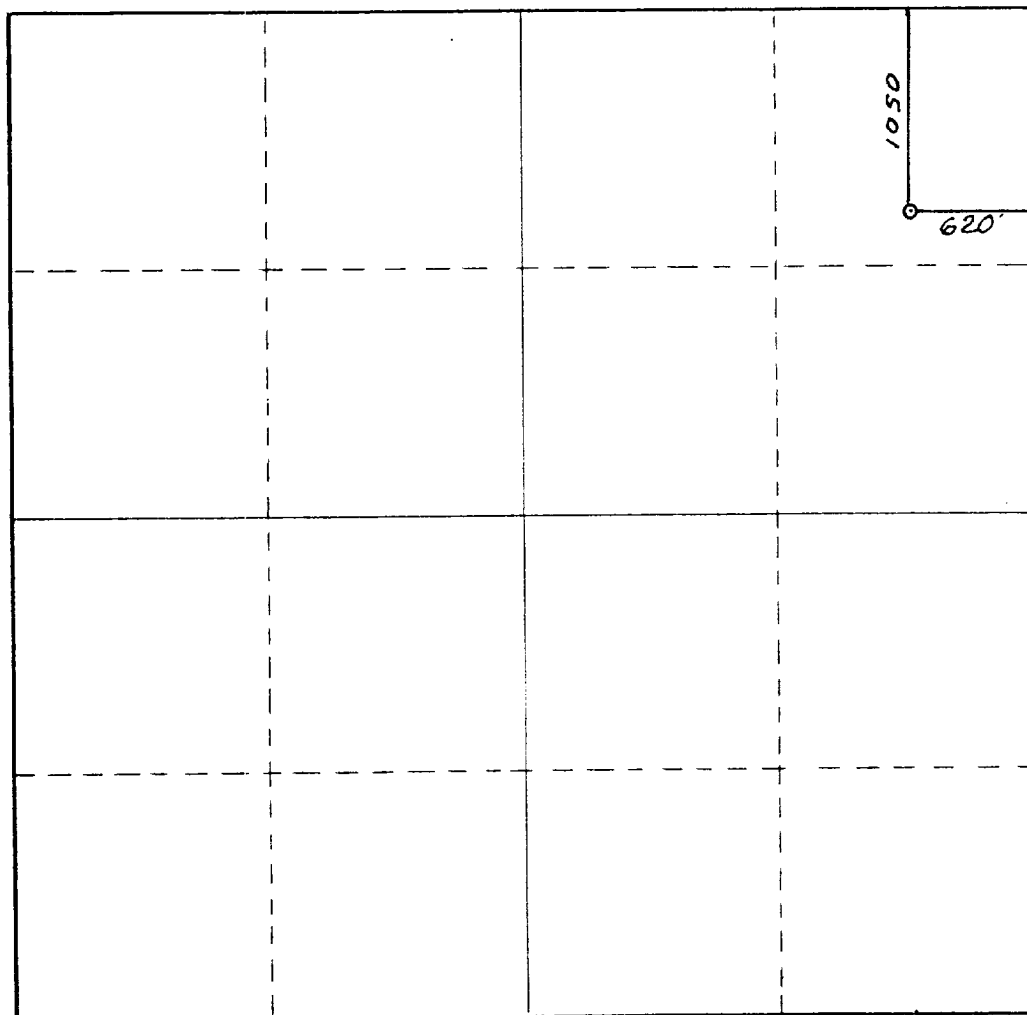

CERTIFICATION

I hereby certify that the information contained herein is true and complete to the best of my knowledge and belief.

*Amy L. Whitley*

Name

**Amy L. Whitley**

Position

**Agent**

Company

**Sirgo-Collier, Inc.**

Date

**March 8, 1988**

I hereby certify that the well location shown on this plat was plotted from field notes of actual surveys made by me or under my supervision, and that the same is true and correct to the best of my knowledge and belief.

Date Surveyed

**February 23, 1988**

Registered Professional Engineer and/or Land Surveyor

*Dan R. Reddy*

Certificate No.

**NM PE&LS NO. 5412**

0 330 660 990 1320 1650 1980 2310 2640 2000 1500 1000 500 0

# BOP

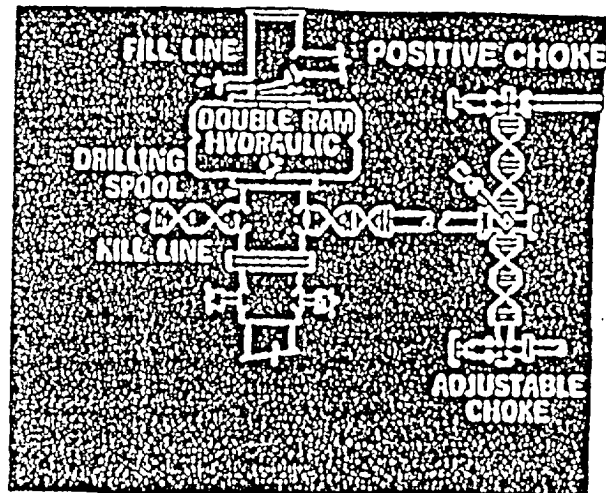

**RECEIVED**

MAR 10 1988  
OCD  
HOBBS OFFICE