

STATE OF NEW MEXICO  
ENERGY AND MINERALS DEPARTMENT

OIL CONSERVATION DIVISION

P. O. BOX 2088  
SANTA FE, NEW MEXICO 87501

30-025-30377

Form C-101  
Revised 10-1-78

NO. OF COPIES RECEIVED	
DISTRIBUTION	
SANTA FE	
FILE	
U.S.G.L.	
LAND OFFICE	
OPERATOR	

5A. Indicate Type of Lease  
STATE ☐ FEDERAL ☒

5. State Oil & Gas Lease No.

APPLICATION FOR PERMIT TO DRILL, DEEPEN, OR PLUG BACK

1a. Type of Work DRILL <input checked="" type="checkbox"/> DEEPEN <input type="checkbox"/> PLUG BACK <input type="checkbox"/>		7. Unit Agreement Name Skelly Penrose B Unit
b. Type of Well OIL WELL <input checked="" type="checkbox"/> GAS WELL <input type="checkbox"/> OTHER <input type="checkbox"/> SINGLE ZONE <input checked="" type="checkbox"/> MULTIPLE ZONE <input type="checkbox"/>		8. Farm or Lease Name
2. Name of Operator Sirgo-Collier, Inc.		9. Well No. 71
3. Address of Operator P. O. Box 3531, Midland, Texas 79702		10. Field and Pool, or Wildcat Langlie Mattix SR-Q-Gyl
4. Location of Well UNIT LETTER <u>D</u> LOCATED <u>1220</u> FEET FROM THE <u>North</u> LINE AND <u>330</u> FEET FROM THE <u>West</u> LINE OF SEC. <u>5</u> TWP. <u>23S</u> RGE. <u>37E</u> NMDM		11. County Lea
19. Proposed Depth 3950'		19A. Formation Queen
20. Rotary or C.T. Rotary		21. Elevation (Show whether DE, RT, etc.) 3374' GR
21A. Kind & Status Plug. Bond Cash Statewide		21B. Drilling Contractor Odessa Exploration
22. Approx. Date Work will start July 10, 1988		

PROPOSED CASING AND CEMENT PROGRAM

SIZE OF HOLE	SIZE OF CASING	WEIGHT PER FOOT	SETTING DEPTH	SACKS OF CEMENT	EST. TOP
12-1/4"	8-5/8"	24#	410'	250	Surface
7-7/8"	5-1/2"	15.5 & 17#	3950'	1000	Surface

The Queen zone will be selectively perforated and stimulated as needed for optimum production.

IN ABOVE SPACE DESCRIBE PROPOSED PROGRAM; IF PROPOSAL IS TO DEEPEN OR PLUG BACK, GIVE DATA ON PRESENT PRODUCTIVE ZONE AND PROPOSED NEW PRODUCTIVE ZONE. GIVE BLOWOUT PREVENTER PROGRAM, IF ANY.

I hereby certify that the information above is true and complete to the best of my knowledge and belief.

Signed Amy L. Whitley Title Agent Date May 9, 1988

(This space for State Use)

ORIGINAL SIGNED BY JERRY SEXTON

APPROVED BY DISTRICT 1 SUPERVISOR

TITLE

DATE

CONDITIONS OF APPROVAL, IF ANY:

N & L-2511

Permit Expires 6 Months From Approval Date Unless Drilling Underway.

JUN 1 1988

RECEIVED  
MAY 11 1986  
OCD  
HOBBS OFFICE

**MEXICO OIL CONSERVATION COMMIS.**  
**WELL LOCATION AND ACREAGE DEDICATION PLAT**

Form C-102  
 Supersedes C-128  
 Effective 1-1-65

All distances must be from the outer boundaries of the Section.

Operator <b>SIRGO-COLLIER, INC.</b>			Lease <b>Skelly Penrose "B" Unit</b>		Well No. <b>71</b>
Unit Letter <b>D</b>	Section <b>5</b>	Township <b>23 South</b>	Range <b>37 East</b>	County <b>Lea County, N.M.</b>	
Actual Footage Location of Well: <b>1220</b> feet from the <b>North</b> line and <b>330</b> feet from the <b>West</b> line					
Ground Level Elev. <b>3372.</b>	Producing Formation <b>SR-Queen-Grayburg</b>		Pool <b>Langlie Mattix</b>		Dedicated Acreage: <b>40</b> Acres

1. Outline the acreage dedicated to the subject well by colored pencil or hatchure marks on the plat below.
2. If more than one lease is dedicated to the well, outline each and identify the ownership thereof (both as to working interest and royalty).
3. If more than one lease of different ownership is dedicated to the well, have the interests of all owners been consolidated by communitization, unitization, force-pooling, etc?

☒ Yes    ☐ No    If answer is "yes," type of consolidation Unitization, R-2915

If answer is "no," list the owners and tract descriptions which have actually been consolidated. (Use reverse side of this form if necessary.) \_\_\_\_\_

No allowable will be assigned to the well until all interests have been consolidated (by communitization, unitization, forced-pooling, or otherwise) or until a non-standard unit, eliminating such interests, has been approved by the Commission.

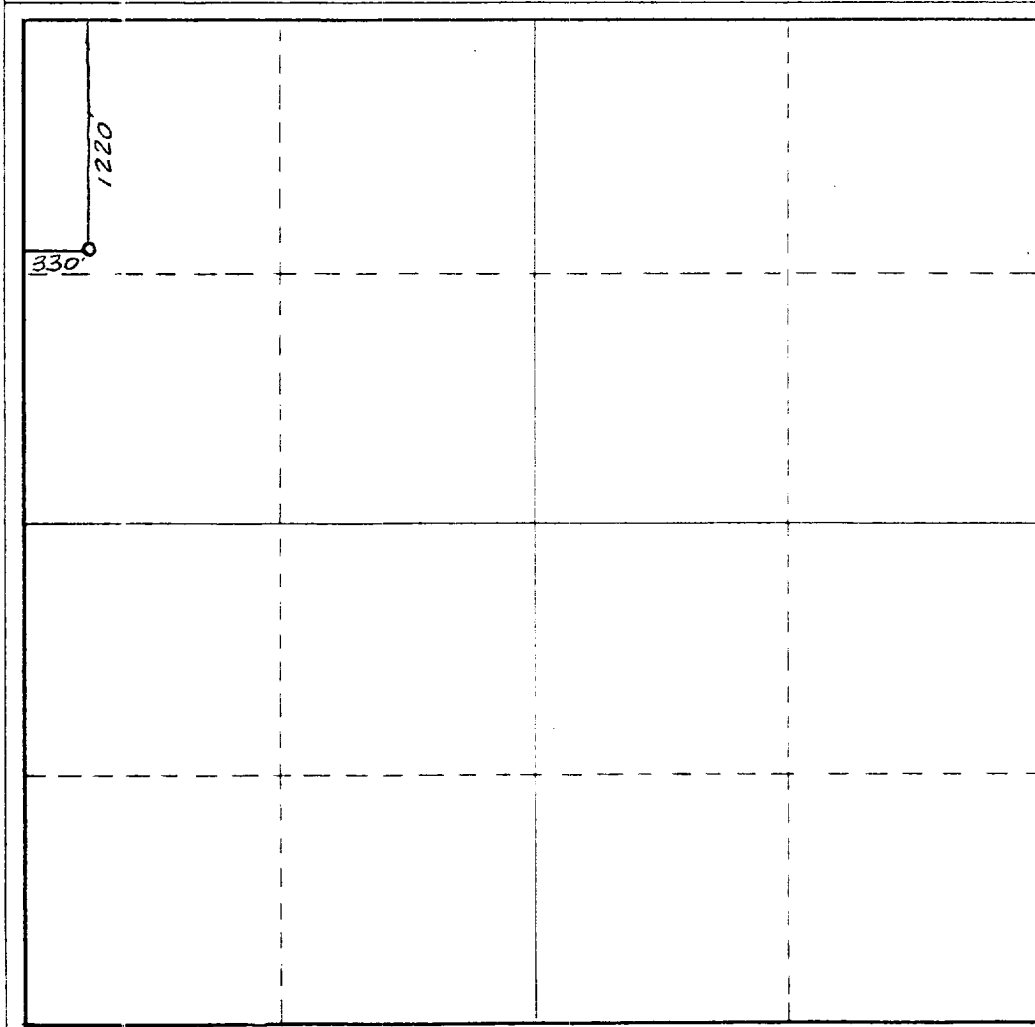

**CERTIFICATION**

I hereby certify that the information contained herein is true and complete to the best of my knowledge and belief.

*Amy L. Whitley*  
 Name

Amy L. Whitley

Position:  
 Agent

Company  
 Sirgo-Collier, Inc.

Date  
 May 9, 1988

I hereby certify that the well location shown on this plat was plotted from field notes of actual surveys made by me or under my supervision, and that the same is true and correct to the best of my knowledge and belief.

*Don R. Reddy*  
 REGISTERED PROFESSIONAL ENGINEER  
 SURVEYOR

Date Surveyed  
 April 5, 1988

Registered Professional Engineer  
 and/or Land Surveyor

*Don R. Reddy*  
 Certificate No.

NM FE&LS NO. 5412

0 330 660 990 1320 1650 1980 2310 2640 2970 3300 3630 3960 4290 4620 4950 5280 5610 5940 6270 6600

RECEIVED

MAY 11 1986

CCO  
KIDDER SERVICE

# BOP

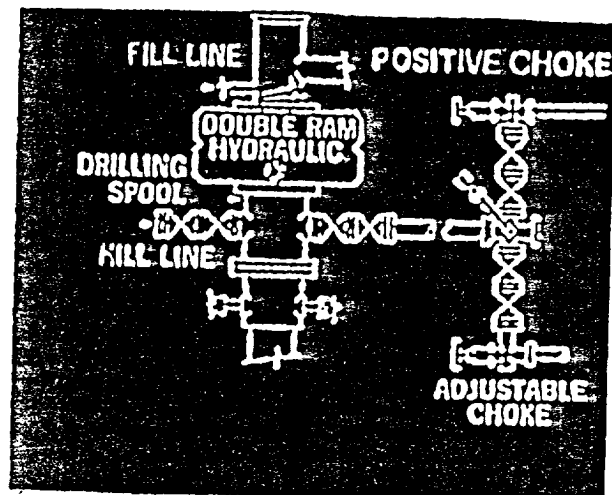

RECEIVED

MAY 11 1988

OCD  
HOBBS OFFICE