

STATE OF NEW MEXICO
ENERGY AND MINERALS DEPARTMENT

OIL CONSERVATION DIVISION

P. O. BOX 2088

SANTA FE, NEW MEXICO 87501

Form C-101
Revised 10-1-78

NO. OF COPIES RECEIVED	
DISTRIBUTION	
SANTA FE	
FILE	
U.S.G.S.	
LAND OFFICE	
OPERATOR	

5A. Indicate Type of Lease
STATE ☐ FEE ☒
5. State Oil & Gas Lease No.

APPLICATION FOR PERMIT TO DRILL, DEEPEN, OR PLUG BACK

1a. Type of Work b. Type of Well OIL WELL <input checked="" type="checkbox"/> GAS WELL <input type="checkbox"/> OTHER <input type="checkbox"/> SINGLE ZONE <input checked="" type="checkbox"/> MULTIPLE ZONE <input type="checkbox"/>		7. Unit Agreement Name Skelly Penrose B Unit 8. Farm or Lease Name	
2. Name of Operator Sirgo-Collier, Inc.		9. Well No. 72	
3. Address of Operator P. O. Box 3531, Midland, Texas 79702		10. Field and Pool, or Wildcat Langlie Mattix SR-Q-Gy	
4. Location of Well UNIT LETTER <u>L</u> LOCATED <u>1380</u> FEET FROM THE <u>South</u> LINE AND <u>30</u> FEET FROM THE <u>West</u> LINE OF SEC. <u>5</u> TWP. <u>23S</u> RGE. <u>37E</u> NMPM		17. County Lea	
19. Proposed Depth 3950'		19A. Formation Queen	
20. Rotary or C.T. Rotary		21. Elevation (Show whether DF, RT, etc.) 3358' GR	
21A. Kind & Status Plug. Bond Cash Statewide		21B. Drilling Contractor Odessa Exploration	
22. Approx. Date Work will start July 20, 1988			

PROPOSED CASING AND CEMENT PROGRAM

SIZE OF HOLE	SIZE OF CASING	WEIGHT PER FOOT	SETTING DEPTH	SACKS OF CEMENT	EST. TOP
12-1/4"	8-5/8"	24#	410'	250	Surface
7-7/8"	5-1/2"	15.5 & 17#	3950'	1000	Surface

The Queen zone will be selectively perforated and stimulated as needed for optimum production.

IN ABOVE SPACE DESCRIBE PROPOSED PROGRAM: IF PROPOSAL IS TO DEEPEN OR PLUG BACK, GIVE DATA ON PRESENT PRODUCTIVE ZONE AND PROPOSED NEW PRODUCTIVE ZONE. GIVE BLOWOUT PREVENTER PROGRAM, IF ANY.

I hereby certify that the information above is true and complete to the best of my knowledge and belief.

Signed Amy L. Whitley Title Agent Date May 9, 1988

(This space for State Use)
ORIGINAL SIGNED BY JERRY SEXTON
DISTRICT I SUPERVISOR

APPROVED BY _____ TITLE _____ DATE JUN 1 1988

CONDITIONS OF APPROVAL, IF ANY:

782-2511

Permit Expires 6 Months From Approval
Date Unless Drilling Underway.

RECEIVED

MAY 11 1988

SCD
GOODS OFFICE

NEW MEXICO OIL CONSERVATION COMMISSION
WELL LOCATION AND ACREAGE DEDICATION PLAT

Form C-102
 Supersedes C-128
 Effective 1-1-65

All distances must be from the outer boundaries of the Section.

Operator SIRGO-COLLIER, INC.			Lease Skelly Penrose "B" Unit		Well No. 72
Unit Letter L	Section 5	Township 23 South	Range 37 East	County Lea County, N.M.	
Actual Spotage Location of Well: 30 feet from the West line and 1380 feet from the South line					
Ground Level Elev. 3358.	Producing Formation SR-Queen-Grayburg		Pool Langlie Mattix		Dedicated Acreage: 40 Acres

1. Outline the acreage dedicated to the subject well by colored pencil or hachure marks on the plat below.
2. If more than one lease is dedicated to the well, outline each and identify the ownership thereof (both as to working interest and royalty).
3. If more than one lease of different ownership is dedicated to the well, have the interests of all owners been consolidated by communitization, unitization, force-pooling, etc?

☒ Yes ☐ No If answer is "yes," type of consolidation Unitization, R-2915

If answer is "no," list the owners and tract descriptions which have actually been consolidated. (Use reverse side of this form if necessary.) _____

No allowable will be assigned to the well until all interests have been consolidated (by communitization, unitization, forced-pooling, or otherwise) or until a non-standard unit, eliminating such interests, has been approved by the Commissioner.

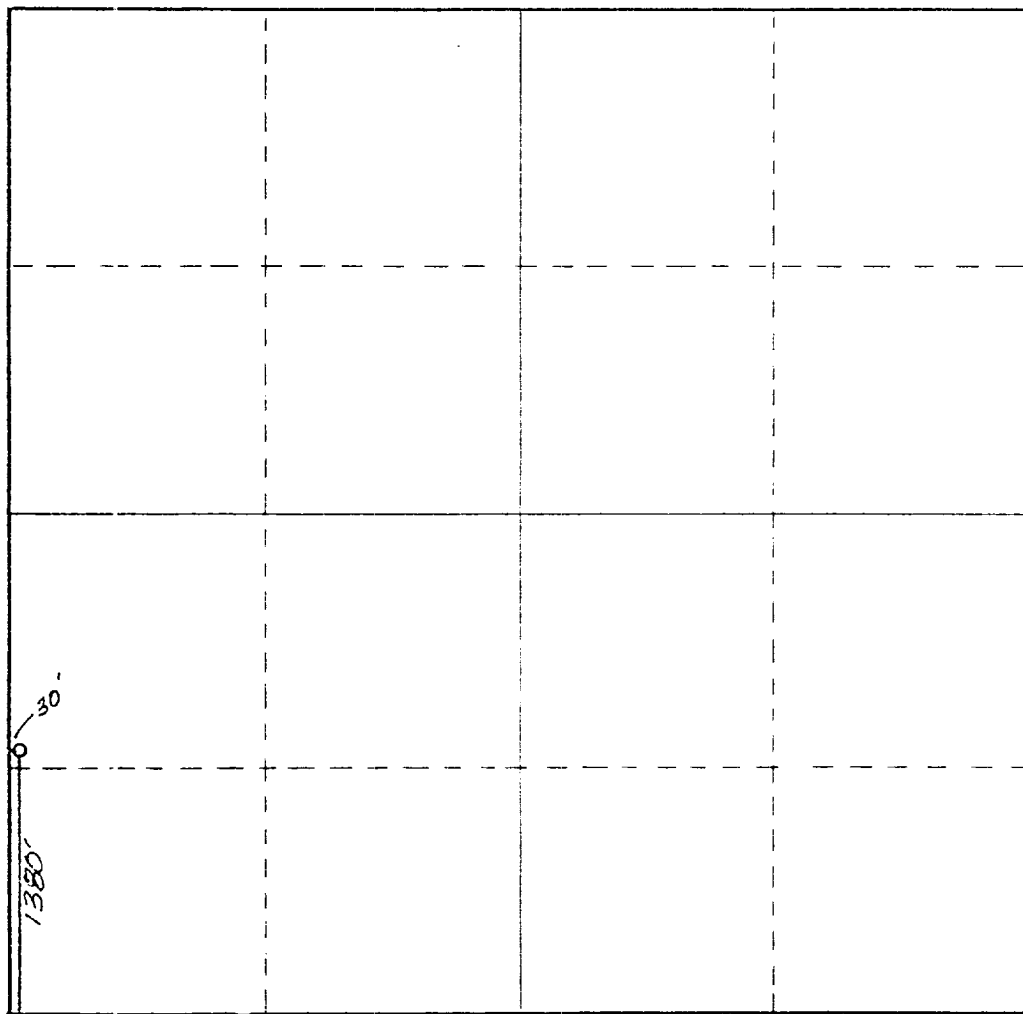

CERTIFICATION

I hereby certify that the information contained herein is true and complete to the best of my knowledge and belief.

Amy L. Whitley
 Name

Amy L. Whitley

Position

Agent

Company

Sirgo-Collier, Inc.

Date

May 9, 1988

I hereby certify that the well location shown on this plat was plotted from field notes of actual surveys made by me or under my supervision, and that the same is true and correct to the best of my knowledge and belief.

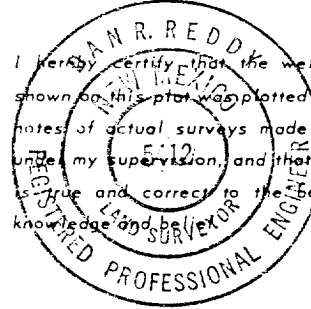

Date Surveyed

March 22, 1988

Registered Professional Engineer
 and/or Land Surveyor

Dan R. Reddy
 Certificate No.

N.M. PE&LS NO. 5412

BOP

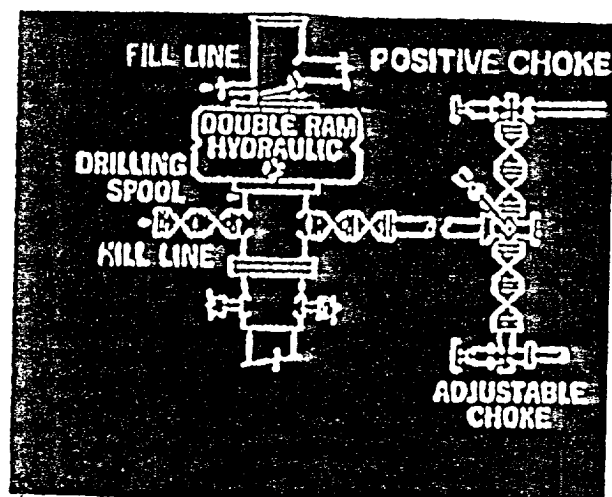

RECEIVED

MAY 11 1988

003
HOBBS OFFICE