

STATE OF NEW MEXICO
ENERGY AND MINERALS DEPARTMENT

OIL CONSERVATION DIVISION
P. O. BOX 2088
SANTA FE, NEW MEXICO 87501

30-025-30385

Form C-101
Revised 10-1-78

NO. OF COPIES RECEIVED	
DISTRIBUTION	
SANTA FE	
FILE	
U.S.G.S.	
LAND OFFICE	
OPERATOR	

5A. Indicate Type of Lease
STATE ☒ FEE ☐
5. State Oil & Gas Lease No.

APPLICATION FOR PERMIT TO DRILL, DEEPEN, OR PLUG BACK

1a. Type of Work		7. Unit Agreement Name	
b. Type of Well DRILL <input checked="" type="checkbox"/> DEEPEN <input type="checkbox"/> PLUG BACK <input type="checkbox"/> OIL WELL <input checked="" type="checkbox"/> GAS WELL <input type="checkbox"/> OTHER <input type="checkbox"/> SINGLE ZONE <input type="checkbox"/> MULTIPLE ZONE <input type="checkbox"/>		8. Farm or Lease Name State 36	
2. Name of Operator PRIMARY FUELS, INC.		9. Well No. 1	
3. Address of Operator PO Box 569 Houston TX 77001		10. Field and Pool, or Wildcat Foster San Andres	
4. Location of Well UNIT LETTER <u>NP</u> LOCATED <u>330</u> FEET FROM THE <u>South</u> LINE AND <u>330</u> FEET FROM THE <u>East</u> LINE OF SEC. <u>36</u> TWP. <u>18S</u> RGE. <u>38E</u> NMPM		12. County Lea	
21. Elevations (Show whether DF, RT, etc.) 3609.8 GL		19. Proposed Depth 4550	19A. Formation San Andres
21A. Kind & Status Plug. Bond Blanket - Active	21B. Drilling Contractor Not Determined	20. Rotary or C.T. Rotary	
22. Approx. Date Work will start 5/25/88			

PROPOSED CASING AND CEMENT PROGRAM

SIZE OF HOLE	SIZE OF CASING	WEIGHT PER FOOT	SETTING DEPTH	SACKS OF CEMENT	EST. TOP
12-1/4	8-5/8	24#	300	180	Surface
7-7/8	5-1/2	15.50#	4550	175	3000

BOP schematic attached.

Form C-102 sent under separate cover.

Permit Expires 6 Months From Approval
Date Unless Drilling Underway.

IN ABOVE SPACE DESCRIBE PROPOSED PROGRAM; IF PROPOSAL IS TO DEEPEN OR PLUG BACK, GIVE DATA ON PRESENT PRODUCTIVE ZONE AND PROPOSED NEW PRODUCTIVE ZONE. GIVE BLOWOUT PREVENTER PROGRAM, IF ANY.

I hereby certify that the information above is true and complete to the best of my knowledge and belief.

Signed Manz Porter Title Mgr-Drilling & Production Date 5/18/88
(This space for State Use)

APPROVED BY _____ TITLE _____ DATE MAY 19 1988
CONDITIONS OF APPROVAL, IF ANY:

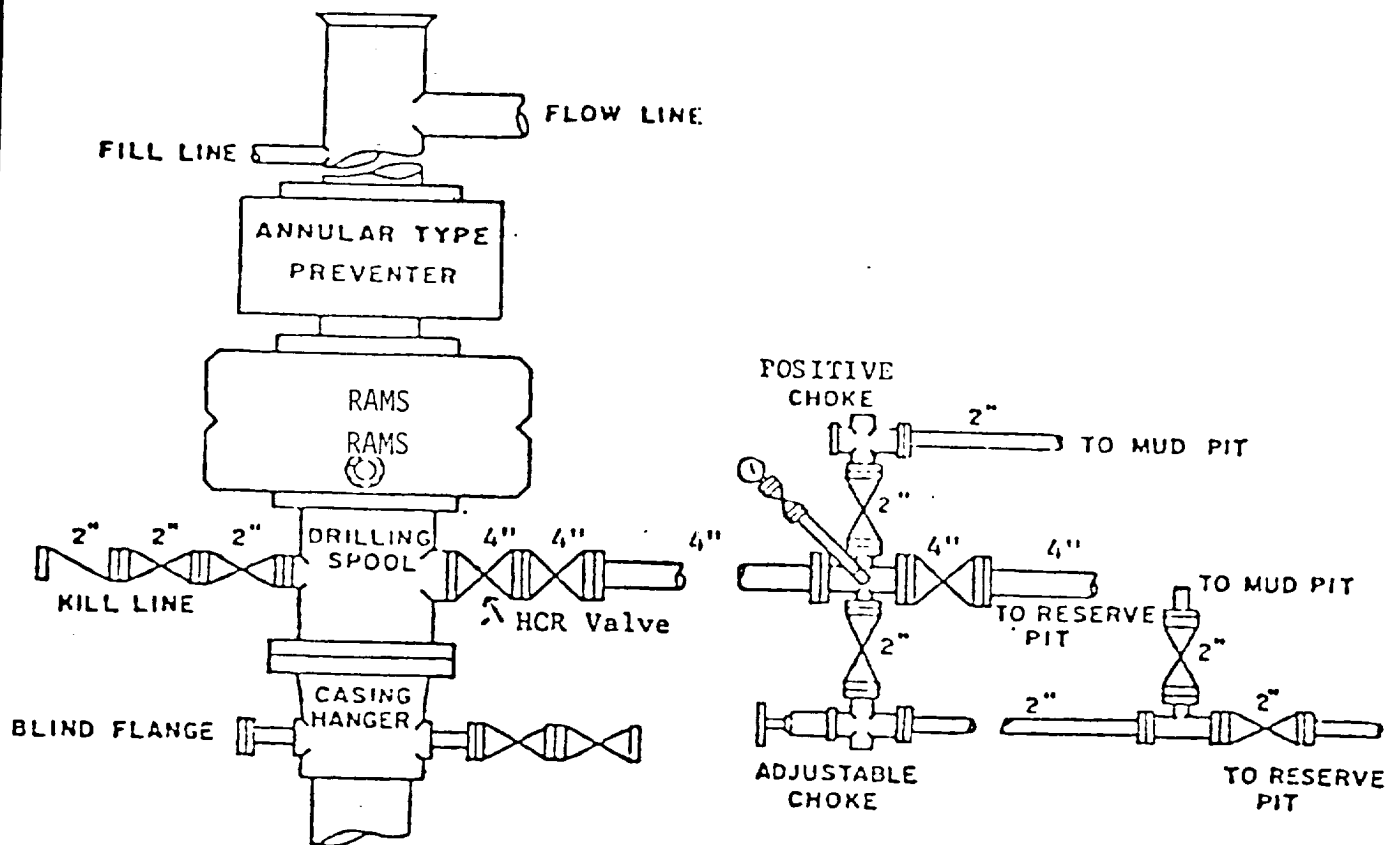

BOP STACK

3000 PSI WORKING PRESSURE

BOP ARRANGEMENT

NEW MEXICO OIL CONSERVATION COMMISSION
WELL LOCATION AND ACREAGE DEDICATION PLAT

Form C-121
Supersedes C-128
Effective 1-1-65

All distances must be from the outer boundaries of the Section

Operator Primary Fuels, Inc.		Lease State 36		Well No. 1
Section P	Section 36	Township 18 South	Range 38 East	County Lea County
Actual Location of Well: 330 feet from the South line and 330 feet from the East line				
Ground Level Elev. 3609.8	Producing Formation San Andres	Pool Foster San Andres	Estimated Acreage 40 Acres	

- 1 Outline the acreage dedicated to the subject well by colored pencil or hatchure marks on the plat below.
- 2 If more than one lease is dedicated to the well, outline each and identify the ownership thereof (both as to working interest and royalty).
- 3 If more than one lease of different ownership is dedicated to the well, have the interests of all owners been consolidated by communitization, unitization, force-pooling, etc?

☐ Yes ☐ No If answer is "yes," type of consolidation _____

If answer is "no," list the owners and tract descriptions which have actually been consolidated. (Use reverse side of this form if necessary) _____

No allowable will be assigned to the well until all interests have been consolidated (by communitization, unitization, forced-pooling, or otherwise) or until a non-standard unit, eliminating such interests, has been approved by the Commission.

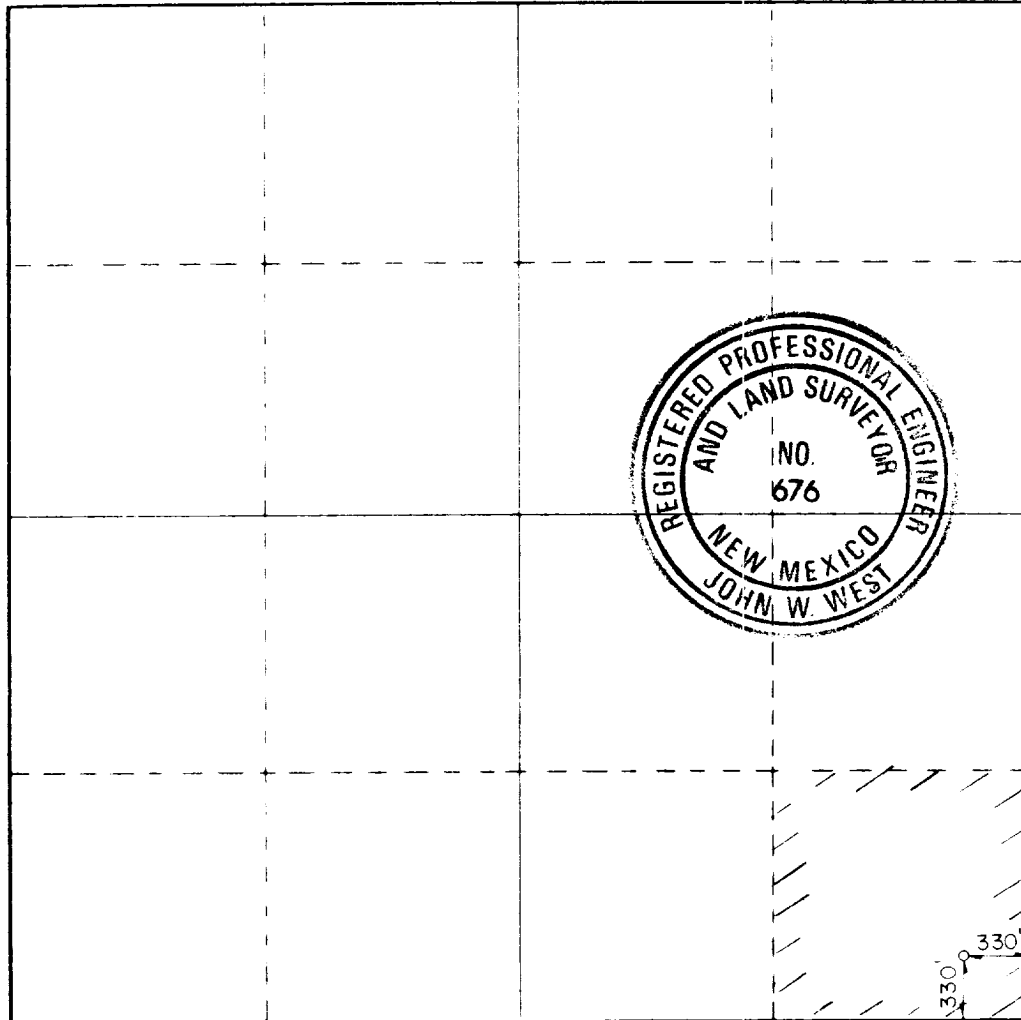

CERTIFICATION

I hereby certify that the information contained herein is true and complete to the best of my knowledge and belief

John W. West

Drilling Superintendent

Primary Fuels, Inc.

5-18-88

I hereby certify that the well location shown on this plat was plotted from field notes of actual surveys made by me or under my supervision, and that the same is true and correct to the best of my knowledge and belief.

Date Surveyed
May 17, 1988

Registered Professional Engineer
and Land Surveyor

John W. West
Certificate No. JOHN W. WEST, 676
RONALD J. EIDSON, 3239

