

30-025-30450

NO. OF COPIES RECEIVED	
DISTRIBUTION	
SANTA FE	
FILE	
U.S.G.S.	
LAND OFFICE	
OPERATOR	

NEW MEXICO OIL CONSERVATION COMMISSION

Form C-101
Revised 1-1-65

5A. Indicate Type of Lease STATE <input checked="" type="checkbox"/> FEE <input type="checkbox"/>
5. State Oil & Gas Lease No. LG-3362

APPLICATION FOR PERMIT TO DRILL, DEEPEN, OR PLUG BACK

1a. Type of Work DRILL <input checked="" type="checkbox"/> DEEPEN <input type="checkbox"/> PLUG BACK <input type="checkbox"/>		7. Unit Agreement Name
b. Type of Well OIL WELL <input checked="" type="checkbox"/> GAS WELL <input type="checkbox"/> OTHER <input type="checkbox"/> SINGLE ZONE <input type="checkbox"/> MULTIPLE ZONE <input type="checkbox"/>		8. Farm or Lease Name State 1
2. Name of Operator Mobil Producing Texas & New Mexico, Inc.		9. Well No. 1
3. Address of Operator P. O. Box 633, Midland, TX 79702		10. Field, and Pool, or Wildcat <i>Undesignated Wildcat Wolfcamp</i>
4. Location of Well UNIT LETTER <u>C</u> LOCATED <u>660</u> FEET FROM THE <u>north</u> LINE AND <u>1980</u> FEET FROM THE <u>west</u> LINE OF SEC. <u>/</u> TWP. <u>17-S</u> RGE. <u>35-E</u> NMPM		12. County Lea
19. Proposed Depth 11,200'		19A. Formation Wolfcamp
20. Rotary or C.T. Rotary		
21. Elevations (Show whether DF, RT, etc.) 3938 GR	21A. Kind & Status Plug. Bord On File	21B. Drilling Contractor NA
22. Approx. Date Work will start 9-1-88		

PROPOSED CASING AND CEMENT PROGRAM

SIZE OF HOLE	SIZE OF CASING	WEIGHT PER FOOT	SETTING DEPTH	SACKS OF CEMENT	EST. TOP
(1) 17-1/2"	13-3/8"	48.0#	0-450	500	Surface
(2) 11"	8-5/8"	32.0#	0-5200'	2250	Surface
(3) 7-7/8"	5-1/2"	15.5-17.0#	5200-11,200'	1475	5200'

CEMENT PROGRAM

- (1) 500 sx C + CaCl₂
- (2) Lead 2000 sx H + SIL + Salt
Tail 250 sx C + Add
- (3) Lead 1200 sx H + SILICA
Tail 275 sx H + LAP

BLOWOUT PREVENTER PROGRAM

SECT	Size	Depth	BOP Size	Rating	Mim ARR	Choke Rating	Test
Intr.	13-3/8"	450'	13-5/8"	3000	SRR	3000	1000
Prod.	11"	5200'	11"	5000	SRRA	5000	2000

IN ABOVE SPACE DESCRIBE PROPOSED PROGRAM: IF PROPOSAL IS TO DEEPEN OR PLUG BACK, GIVE DATA ON PRESENT PRODUCTIVE ZONE AND PROPOSED NEW PRODUCTIVE ZONE. GIVE BLOWOUT PREVENTER PROGRAM, IF ANY.

I hereby certify that the information above is true and complete to the best of my knowledge and belief.

Signed C.C. Smith for M. E. Sweeney Title Environmental & Regulatory Mgr. Date 8-18-88

(This space for State Use)

ORIGINAL SIGNED BY JERRY SEXTON

AUG 22 '88

APPROVED BY DISTRICT SUPERVISOR TITLE DATE

CONDITIONS OF APPROVAL, IF ANY:

Permit Expires 6 Months From Approval
Date Unless Drilling Underway.

RECEIVED

AUG 19 1988

OCD
HOBBS OFFICE

CONSERVATION DIVISION

STATE OF NEW MEXICO
ENERGY AND MINERALS DEPARTMENT

P. O. BOX 2088
SANTA FE, NEW MEXICO 87501

Form C-102
Revised 10-1-78

All distances must be from the outer boundaries of the Section.

Operator MOBIL EXPLORATION AND PRODUCING U.S. INC.			Lease STATE 1		Well No. 1
Unit Letter C	Section 1	Township 17-S	Range 35-E	County LEA	
Actual Footage Location of Wells 660 feet from the NORTH line and 1980 feet from the WEST line					
Ground Level Elev. 3938	Producing Formation Wolfcamp	Pool Wildcat	Dedicated Acreage 40 Acres		

1. Outline the acreage dedicated to the subject well by colored pencil or hatchure marks on the plat below.
2. If more than one lease is dedicated to the well, outline each and identify the ownership thereof (both as to working interest and royalty).
3. If more than one lease of different ownership is dedicated to the well, have the interests of all owners been consolidated by communitization, unitization, force-pooling, etc?

☐ Yes ☐ No If answer is "yes," type of consolidation _____

If answer is "no," list the owners and tract descriptions which have actually been consolidated. (Use reverse side of this form if necessary.) _____

No allowable will be assigned to the well until all interests have been consolidated (by communitization, unitization, forced-pooling, or otherwise) or until a non-standard unit, eliminating such interests, has been approved by the Division.

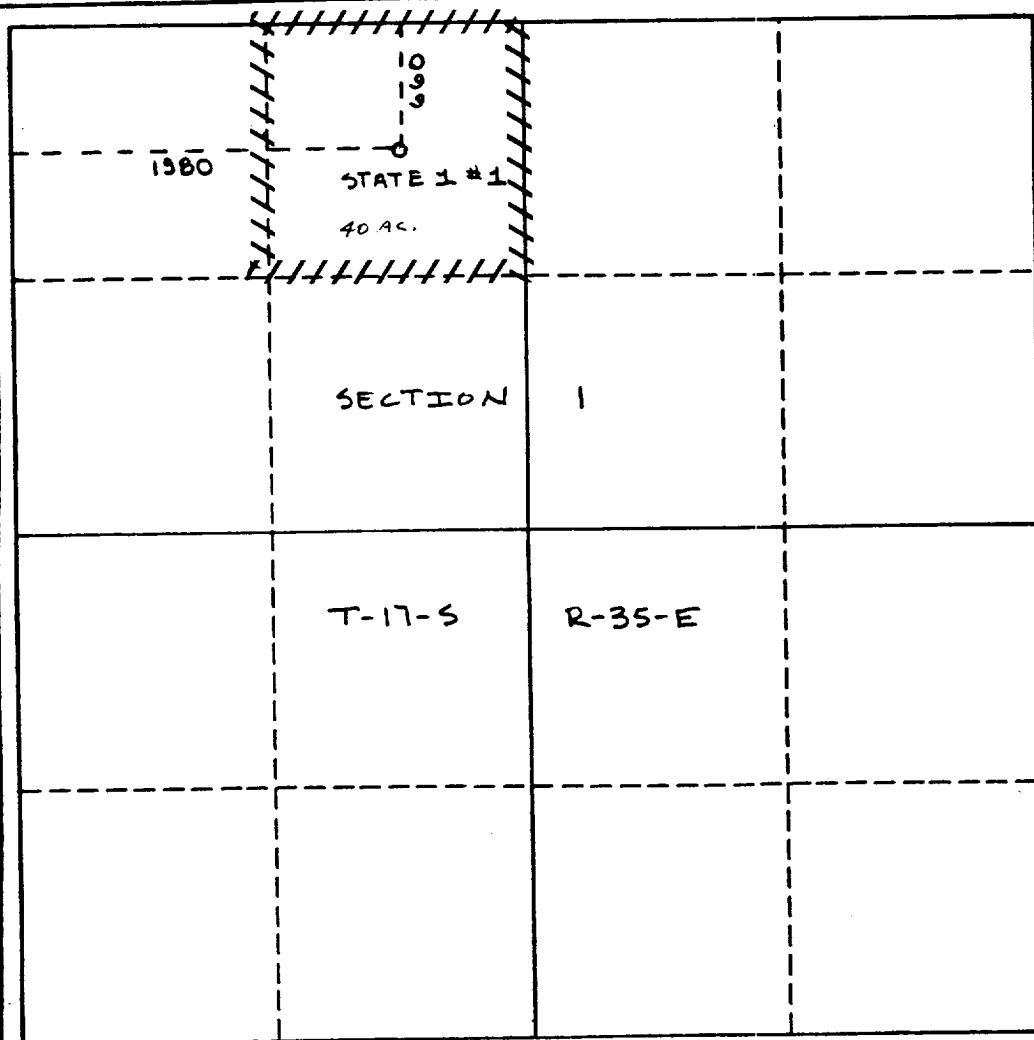

CERTIFICATION

I hereby certify that the information contained herein is true and complete to the best of my knowledge and belief.

C. E. Smith - for

Name
M. E. Sweeney
Position
Env. & Regulatory Manager
Company
Mobil Exploration & Prod. US
Date
9-18-88

I hereby certify that the well location shown on this plat was plotted from field notes of actual surveys made by me or under my supervision, and that the same is true and correct to the best of my knowledge.

Date Surveyed
9-18-88
Registered Professional Engineer and/or Land Surveyor
Thomas J. Curry
Certificate No.

9669

2

RECEIVED

AUG 19 1988

OCD
HOBBS OFFICE