

UNITED STATES
DEPARTMENT OF THE INTERIOR
GEOLOGICAL SURVEY

APPLICATION FOR PERMIT TO DRILL, DEEPEN, OR PLUG BACK

1a. TYPE OF WORK

DRILL ☒DEEPEN ☐PLUG BACK ☐

b. TYPE OF WELL

OIL
WELL ☒GAS
WELL ☐

OTHER

SINGLE
ZONE ☒MULTIPLE
ZONE ☐

2. NAME OF OPERATOR

Highland Production Company

3. ADDRESS OF OPERATOR

810 N. Dixie Blvd., Suite 202, Odessa, Texas 79761

4. LOCATION OF WELL (Report location clearly and in accordance with any State requirements.)*

At surface

660' FEL and 1650' FNL

At proposed prod. zone

660' FEL and 1650' FNL

14. DISTANCE IN MILES AND DIRECTION FROM NEAREST TOWN OR POST OFFICE*

17 Miles SW Jal, New Mexico

15. DISTANCE FROM PROPOSED*

LOCATION TO NEAREST
PROPERTY OR LEASE LINE, FT. 660' FNL
(Also to nearest drlg. unit line, if any)

16. NO. OF ACRES IN LEASE

80

17. NO. OF ACRES ASSIGNED
TO THIS WELL

40

18. DISTANCE FROM PROPOSED LOCATION*

TO NEAREST WELL, DRILLING, COMPLETED,
OR APPLIED FOR, ON THIS LEASE, FT. 1363.6'

19. PROPOSED DEPTH

4400'

20. ROTARY OR CABLE TOOLS

Rotary to 4330' Cable into Forma-

21. ELEVATIONS (Show whether DF, RT, GR, etc.)

3145.0 GR

22. APPROX. DATE WORK WILL START* tion

March 5, 1990

23.

PROPOSED CASING AND CEMENTING PROGRAM

SIZE OF HOLE	SIZE OF CASING	WEIGHT PER FOOT	SETTING DEPTH	QUANTITY OF CEMENT
12 1/2"	8 5/8"	24. #	1200'	600 Sacks Class C - Circulate
7 7/8"	5 1/2"	15.5#	4400'	750 Sacks HLCW Class C - Circulate

Additional Information:

1. Surface foramtion is Tertiary with some Triassic exposed.
2. Estimated geological tops: Rustler - 950'; Anhydrite - 1,000'; Top Salt - 1,300'; Castile - 3,000'; Lamar Line - 4,100'; Top of Delaware - 4,320'.
3. Pressure control equipment: Double hydraulic pressure tested to 3,000 PSI, full closing hydril on top tested to 3,000 PSI. Pressure control diagram is attached. Testing will be on installation, daily and on trips.
4. Proposed circulating medium: 0-1,200' - Spud Mud; 1,200' to 4,500' - Brine Water.
5. Estimate will encounter water from 890' to 950'.
6. Estimate will encounter oil at 4,320'. OH COMPLETION ~~SS~~
7. Logging Program: Acoustic Velocity Gamma Ray Caliper Log: FOROXO Guard Log.
8. No coring or drill stem testing.
9. No abnormal pressures or temperatures are expected to be encountered.
10. Anticipated starting date is March 5, 1990.

IN ABOVE SPACE DESCRIBE PROPOSED PROGRAM: If proposal is to deepen or plug back, give data on present productive zone and proposed new productive zone. If proposal is to drill or deepen directionally, give pertinent data on subsurface locations and measured and true vertical depths. Give blowout preventer program if any.

24.

SIGNED

MARVIN L. SMITH

TITLE President

DATE February 13, 1990

(This space for Federal or State office use)

PERMIT NO.

APPROVAL DATE

APPROVED BY

TITLE

DATE

CONDITIONS OF APPROVAL, IF ANY:

APPROVAL SUBJECT TO
GENERAL REQUIREMENTS AND
SPECIAL STIPULATIONS
ATTACHED

RECEIVED
MAR 2 1990
OCD
HOBBS OFFICE

All distances must be from the outer boundaries of the Section.

Operator Highland Production Company			Lease Conoco Federal		Well No. #2
Unit Letter H	Section 30	Township 26 South	Range 32 East	County Lea	
Actual Footage Location of Well:					
1650.0 feet from the North line and		660.0 feet from the East line			
Ground Level Elev. 3145.0	Producing Formation Delaware	Pool North Mason		Dedicated Acreage: 40 Acres	

1. Outline the acreage dedicated to the subject well by colored pencil or hatchure marks on the plat below.
2. If more than one lease is dedicated to the well, outline each and identify the ownership thereof (both as to working interest and royalty).
3. If more than one lease of different ownership is dedicated to the well, have the interests of all owners been consolidated by communitization, unitization, force-pooling, etc?

☐ Yes ☐ No If answer is "yes," type of consolidation _____

If answer is "no," list the owners and tract descriptions which have actually been consolidated. (Use reverse side of this form if necessary.) _____

No allowable will be assigned to the well until all interests have been consolidated (by communitization, unitization, forced-pooling, or otherwise) or until a non-standard unit, eliminating such interests, has been approved by the Division

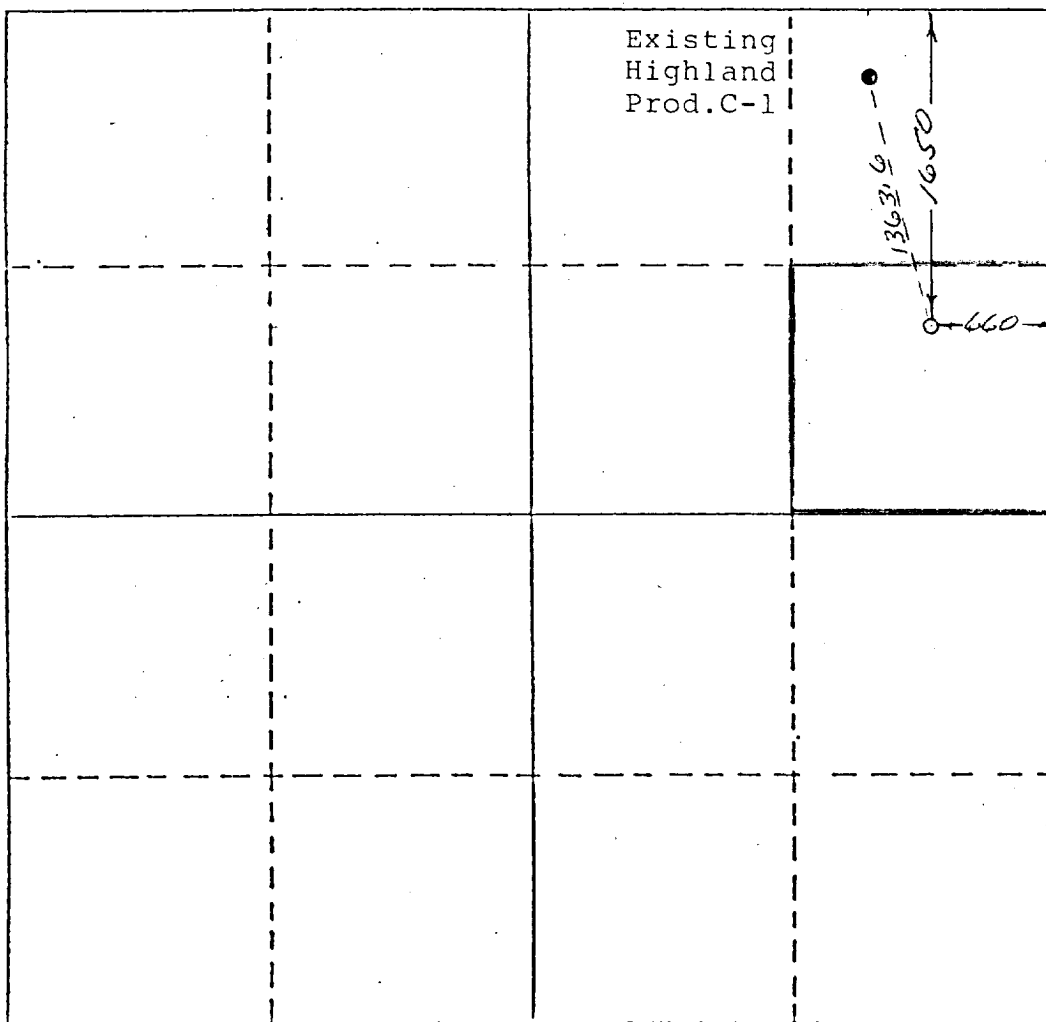

CERTIFICATION

I hereby certify that the information contained herein is true and complete to the best of my knowledge and belief.

Name

Marvin L. Smith

Position

President

Company

Highland Production Company

Date

February 14, 1990

I hereby certify that the well location shown on this plat was plotted from field notes of actual surveys made by me or under my supervision, and that the same is true and correct to the best of my knowledge and belief.

Date Surveyed

2-6-1990

Registered Professional Engineer and/or Land Surveyor

Truman Gaskin

Certificate No.

2126

RECEIVED

MAR 2 1990

OCD
HOBBS OFFICE

ASE ROTARY TABLE

Flow line will have to be made
to fit UNDER Rotary.

2" 1500
4" 900

Optional

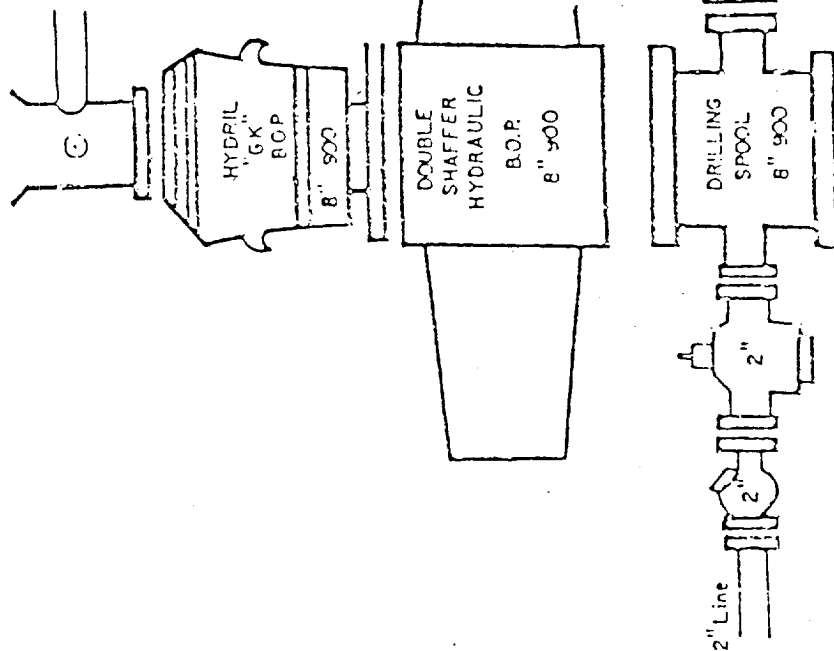
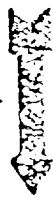

KILL LINE
MANIFOLD

Highland Production Company
Conoco "C" Federal Well No. 2
Lea County, New Mexico

RECEIVED

MAR 2 1990

OOD
HOBBS OFFICE

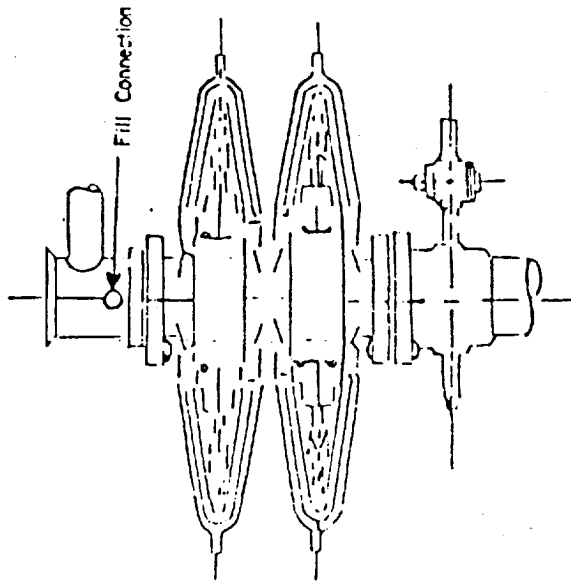

Shaffer Type E Series 900 Hydraulic B.O.P.

3000 PSI WORKING PRESSURE
BLOWOUT PREVENTER HOOK-UP

Series 900 Flanges, or Better.

Note: B.O.P. system will meet the conditions of drilling approval
required by the USGS District Office in Hobbs, New Mexico.

Highland Production Company
Conoco "C" Federal Well No. 2
Lea County, New Mexico

RECEIVED

MAR 2 1990

OCD
HOBBS OFFICE