

UNITED STATES
DEPARTMENT OF THE INTERIOR
BUREAU OF LAND MANAGEMENT

SUBMIT IN TRIP. DATE*
(Other instructions on re-
verse side)

Form approved.
Budget Bureau No. 1004-0135
Expires August 31, 1985

SUNDRY NOTICES AND REPORTS ON WELLS

(Do not use this form for proposals to drill or to deepen or plug back to a different reservoir.
Use "APPLICATION FOR PERMIT—" for such proposals.)

1. <input type="checkbox"/> OIL WELL <input type="checkbox"/> GAS WELL <input checked="" type="checkbox"/> OTHER		5. LEASE DESIGNATION AND SERIAL NO. NM-85932	
2. NAME OF OPERATOR COLLINS & WARE, INC.		6. IF INDIAN, ALLOTTEE OR TRIBE NAME	
3. ADDRESS OF OPERATOR 600 W. ILLINOIS, SUITE 701, MIDLAND, TEXAS 79701		7. UNIT AGREEMENT NAME	
4. LOCATION OF WELL (Report location clearly and in accordance with any State requirements.* See also space 17 below.) At surface 1980' FSL AND 2102' FWL OF SECTION 31		8. FARM OR LEASE NAME BILBREY "31" FEDERAL	
14. PERMIT NO.		9. WELL NO. 1	
15. ELEVATIONS (Show whether DF, RT, GR, etc.) 3622.4' GR		10. FIELD AND POOL, OR WILDCAT UNDES. BILBREY MORROW	
		11. SEC., T., R., M., OR BLK. AND SURVEY OR AREA SEC. 31, T. 21 S., R. 32 E.	
		12. COUNTY OR PARISH LEA	
		13. STATE NEW MEXICO	

16. Check Appropriate Box To Indicate Nature of Notice, Report, or Other Data

NOTICE OF INTENTION TO:		SUBSEQUENT REPORT OF:	
TEST WATER SHUT-OFF <input type="checkbox"/>	PULL OR ALTER CASING <input type="checkbox"/>	WATER SHUT-OFF <input type="checkbox"/>	REPAIRING WELL <input type="checkbox"/>
FRACTURE TREAT <input type="checkbox"/>	MULTIPLE COMPLETE <input type="checkbox"/>	FRACTURE TREATMENT <input type="checkbox"/>	ALTERING CASING <input type="checkbox"/>
SHOOT OR ACIDIZE <input type="checkbox"/>	ABANDON* <input type="checkbox"/>	SHOOTING OR ACIDIZING <input type="checkbox"/>	ABANDONMENT* <input type="checkbox"/>
REPAIR WELL <input type="checkbox"/>	CHANGE PLANS <input type="checkbox"/>	(Other) <input type="checkbox"/>	(Other) <input type="checkbox"/>
(Other) <input type="checkbox"/>	CHANGE WELL LOCATION <input checked="" type="checkbox"/>	(NOTE: Report results of multiple completion on Well Completion or Recompletion Report and Log form.)	

17. DESCRIBE PROPOSED OR COMPLETED OPERATIONS (Clearly state all pertinent details, and give pertinent dates, including estimated date of starting any proposed work. If well is directionally drilled, give subsurface locations and measured and true vertical depths for all markers and zones pertinent to this work.) *

IT IS PROPOSED NOW TO CHANGE THE LOCATION OF THIS WELL -

FROM: 1980' FSL AND 1980' FWL OF SECTION 31,
AS PROPOSED IN THE APPLICATION FOR PERMIT TO DRILL DATED 5-3-91.

TO: 1980' FSL AND 2102' FWL OF SECTION 31,
AS SET OUT IN ITEM 4 ABOVE.

BECAUSE OF EXCESS ACREAGE IN THE WEST HALF OF SECTION 31, THIS LOCATION
CAN BE MOVED 122 FEET EAST AND STILL BE AN ORTHODOX LOCATION. MOVING
THE LOCATION WILL PERMIT TAKING ADVANTAGE OF AN EXISTING WELL PAD.

A REVISED WELL LOCATION AND ACREAGE DEDICATION PLAT IS ATTACHED.

18. I hereby certify that the foregoing is true and correct

SIGNED Arthur R. Brown TITLE Agent

(This space for Federal or State office use)

APPROVED BY ____ TITLE ____

CONDITIONS OF APPROVAL, IF ANY:

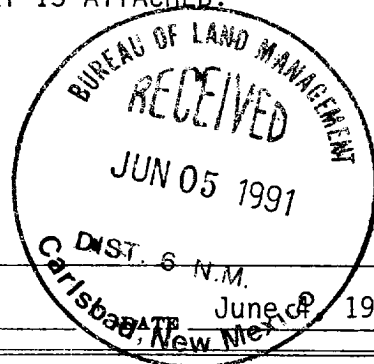

DATE 6-5-91

*See Instructions on Reverse Side

10/10/1991

HOBBS OFFICE

. 1 0 1991

039

HOBBS OFFICE

Submit to Appropriate
District Office
State Lease - 4 copies
Fee Lease - 3 copies

State of New Mexico
Energy, Minerals and Natural Resources Department

Form C-102
Revised 1-1-89

OIL CONSERVATION DIVISION

P.O. Box 2088

Santa Fe, New Mexico 87504-2088

DISTRICT I
P.O. Box 1988, Hobbs, NM 88240

DISTRICT II
P.O. Drawer DD, Artesia, NM 88210

DISTRICT III
1000 Rio Brazos Rd., Aztec, NM 87410

WELL LOCATION AND ACREAGE DEDICATION PLAT

All Distances must be from the outer boundaries of the section

Operator COLLINS & WARE INC.			Lease BILBREY 31 FEDERAL		Well No. 1
Unit Letter K	Section 31	Township 21 SOUTH	Range 32 EAST	County LEA	
Actual Footage Location of Well: 1980 feet from the SOUTH line and 2102 feet from the WEST line					
Ground level Elev. 3622.4	Producing Formation MORROW		Pool UNDESIGNATED BILBREY MORROW	Dedicated Acreage: 334.72 Acres	

- Outline the acreage dedicated to the subject well by colored pencil or hatchure marks on the plat below.
- If more than one lease is dedicated to the well, outline each and identify the ownership thereof (both as to working interest and royalty).
- If more than one lease of different ownership is dedicated to the well, have the interest of all owners been consolidated by communitization, unitization, force-pooling, etc.?
☐ Yes ☒ No If answer is "yes" type of consolidation TO BE COMMUNITIZED

If answer is "no" list the owners and tract descriptions which have actually been consolidated. (Use reverse side of this form if necessary.)

No allowable will be assigned to the well until all interests have been consolidated (by communitization, unitization, forced-pooling, or otherwise) or until a non-standard unit, eliminating such interest, has been approved by the Division.

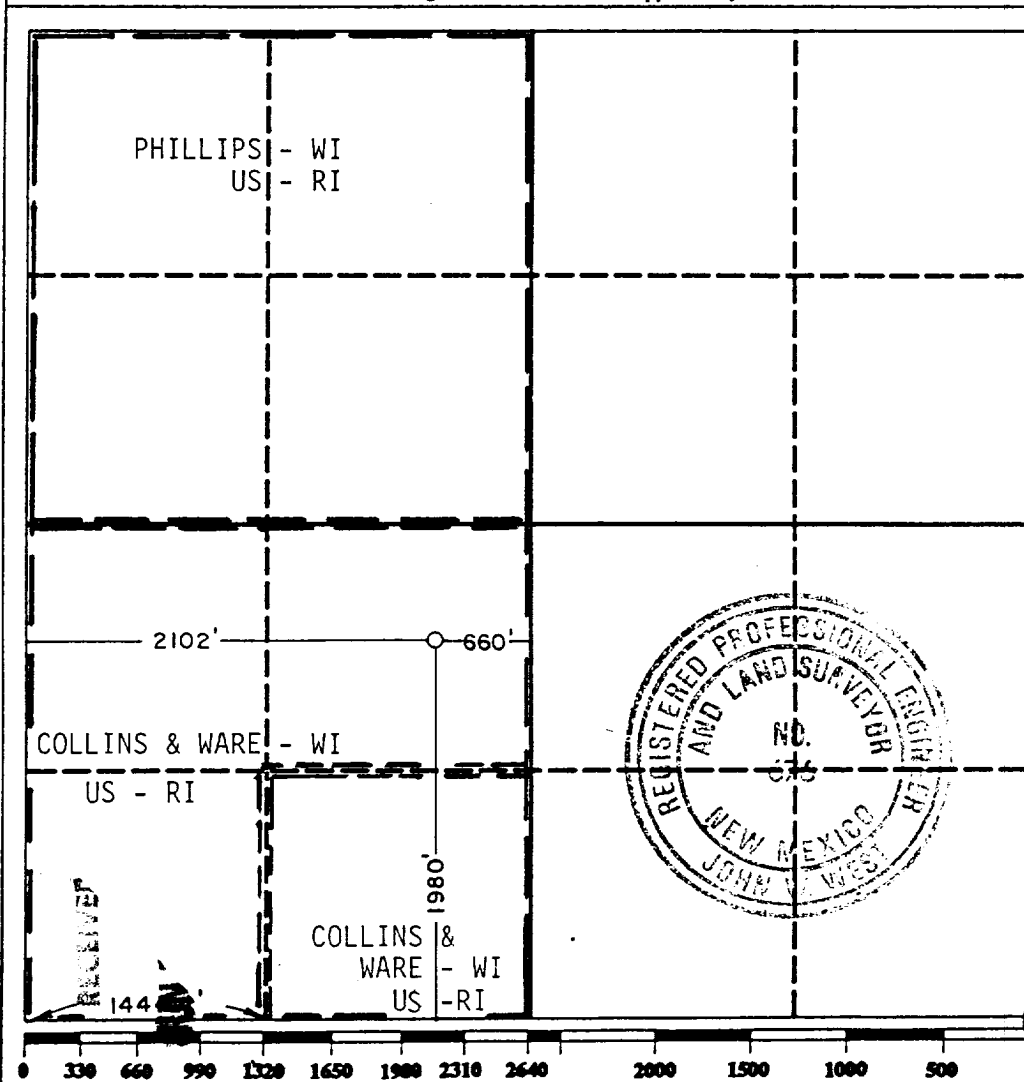

OPERATOR CERTIFICATION

I hereby certify that the information contained herein is true and complete to the best of my knowledge and belief.

Signature

Printed Name

Arthur R. Brown

Position

Agent

Company

COLLINS & WARE, INC

Date

June 4, 1991

SURVEYOR CERTIFICATION

I hereby certify that the well location shown on this plat was plotted from field notes of actual surveys made by me or under my supervision, and that the same is true and correct to the best of my knowledge and belief.

Date Surveyed

MARCH 25, 1981

Signature & Seal of
Professional Surveyor

Certificate No.

JOHN W. WEST,

676

RONALD J. EIDSON,

3239