

30-025-31493

Form 3160-3
(July 1989)
(formerly 9-331C)

UNITED STATES
DEPARTMENT OF THE INTERIOR
BUREAU OF LAND MANAGEMENT

CONTACT RECEIVING
OFFICE FOR NUMBER
OF COPIES REQUIRED
(Other instructions on
reverse side)

BLM Roswell District
Modified Form No.
NMO60-3160-2

APPLICATION FOR PERMIT TO DRILL, DEEPEN, OR PLUG BACK

1a. TYPE OF WORK DRILL <input checked="" type="checkbox"/> DEEPEN <input type="checkbox"/> PLUG BACK <input type="checkbox"/>			5. LEASE DESIGNATION AND SERIAL NO. NM-93	
b. TYPE OF WELL OIL WELL <input checked="" type="checkbox"/> GAS WELL <input type="checkbox"/> OTHER <input type="checkbox"/>			6. IF INDIAN, ALLOTTEE OR TRIBE NAME	
2. NAME OF OPERATOR Southland Royalty Company			7. UNIT AGREEMENT NAME	
3. ADDRESS OF OPERATOR P.O. Box 51810, Midland, TX 79710-1810			8. FARM OR LEASE NAME West Corbin Federal	
4. LOCATION OF WELL (Report location clearly and in accordance with any State requirements.) At surface K, 1980' FSL & 1830' FWL <i>7610' K</i> At proposed prod. zone			9. WELL NO. 23	
14. DISTANCE IN MILES AND DIRECTION FROM NEAREST TOWN OR POST OFFICE* 12 miles SE of Maljamar, NM			10. FIELD AND POOL, OR WILDCAT South Corbin Wolfcamp	
15. DISTANCE FROM PROPOSED* LOCATION TO NEAREST PROPERTY OR LEASE LINE, FT. (Also to nearest drig. unit line, if any) 1830'			11. SEC., T., R., M., OR BLK. AND SURVEY OR AREA 18, T-18-S, R-33-E	
16. NO. OF ACRES IN LEASE 640			12. COUNTY OR PARISH Lea	
17. NO. OF ACRES ASSIGNED TO THIS WELL 80			13. STATE NM	
18. DISTANCE FROM PROPOSED LOCATION* TO NEAREST WELL, DRILLING COMPLETED, OR APPLIED FOR, ON THIS LEASE, FT. 1190'			19. PROPOSED DEPTH 11,550	
20. ROTARY OR CABLE TOOLS Rotary			21. APPROX. DATE WORK WILL START* Upon Approval	
21. ELEVATIONS (Show whether DF, RT, GR, ETC.) 3836.2' GR			22. APPROX. DATE WORK WILL START* Upon Approval	

PROPOSED CASING AND CEMENTING PROGRAM

HOLE SIZE	CASING SIZE	WEIGHT/FOOT	GRADE	THREAD TYPE	SETTING DEPTH	QUANTITY OF CEMENT
17 1/2"	13 3/8"	48#	H-40	STC	350'	425 sxs-Circ
12 1/4"	8 5/8"	28#	K-55	BTC	2900'	1200 sxs-Circ
7 7/8"	5 1/2"	17#	K-55 & N-80	LTC	11,550'	2100 sxs-TOC @ 2700'

MUD PROGRAM: 0-350' spud mud, 350'-2900' brine, 2900'-10,700' cut brine and sweeps (chloride 30,000+), 10,700'-TD cut brine and drispac. MW 9.0-9.2. (Solids must be less than 5% w/VIS 32-36.)

BOP PROGRAM: 13 5/8" - 2M annular BOP to be installed on 13 3/8" csg. 10" - 3M# stack to be installed on 8 5/8" and left on for remainder of drilling.

APPROVAL SUBJECT TO
GENERAL REQUIREMENTS AND
SPECIAL STIPULATIONS
ATTACHED

IN ABOVE SPACE DESCRIBE PROPOSED PROGRAM: If proposal is to deepen or plug back, give data on present productive zone and proposed new productive zone. If proposal is to drill or deepen directionally, give pertinent data on subsurface locations and measured and true vertical depths. Give blowout preventer program, if any.

24. SIGNED Maria L. Perez TITLE Production Asst. DATE 11-19-91
(This space for Federal or State office use)

PERMIT NO. APPROVAL DATE
APPROVED BY TITLE DATE 12-12-91
CONDITIONS OF APPROVAL, IF ANY:

Submit to Appropriate
District Office
State Lease - 4 copies
Fee Lease - 3 copies

State of New Mexico
Energy, Minerals and Natural Resources Department

Form C-102
Revised 1-1-89

OIL CONSERVATION DIVISION
P.O. Box 2088
Santa Fe, New Mexico 87504-2088

DISTRICT I
P.O. Box 1980, Hobbs, NM 88240

DISTRICT II
P.O. Drawer DD, Artesia, NM 88210

DISTRICT III
1000 Rio Brizos Rd., Aztec, NM 87410

WELL LOCATION AND ACREAGE DEDICATION PLAT
All Distances must be from the outer boundaries of the section

Operator Southland Royalty Company			Lease West Corbin Federal		Well No. 23
Unit Letter K	Section 18	Township 18 South	Range 33 East	County Lea	
Actual Footage Location of Well: 1980 feet from the South line and 1830 feet from the West line					
Ground level Elev. 3836.2'	Producing Formation Wolfcamp		Pool South Corbin Wolfcamp	Dedicated Acreage: 80 Acres	

1. Outline the acreage dedicated to the subject well by colored pencil or hatchure marks on the plat below.
2. If more than one lease is dedicated to the well, outline each and identify the ownership thereof (both as to working interest and royalty).
3. If more than one lease of different ownership is dedicated to the well, have the interest of all owners been consolidated by communitization, unitization, force-pooling, etc.?
☐ Yes ☐ No If answer is "yes" type of consolidation _____
If answer is "no" list the owners and tract descriptions which have actually been consolidated. (Use reverse side of this form if necessary.)
No allowable will be assigned to the well until all interests have been consolidated (by communitization, unitization, forced-pooling, or otherwise) or until a non-standard unit, eliminating such interest, has been approved by the Division.

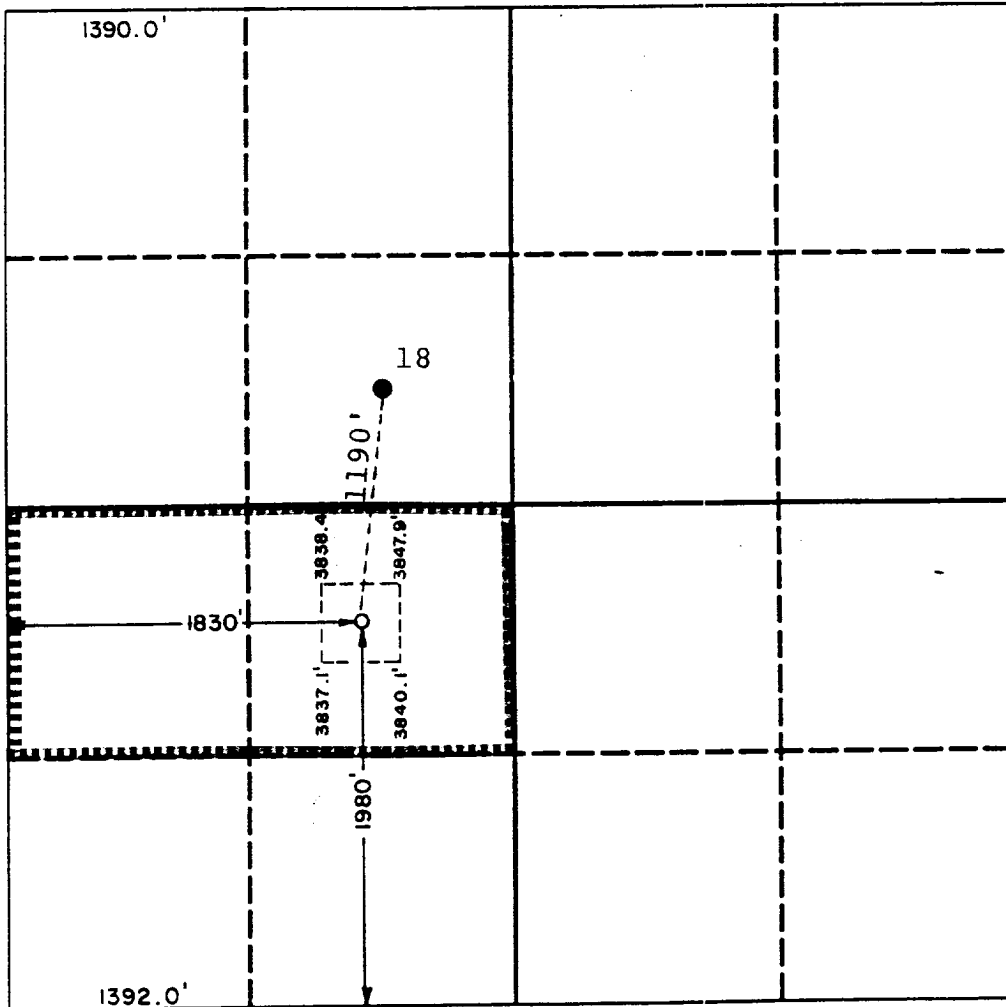

OPERATOR CERTIFICATION

I hereby certify that the information contained herein is true and complete to the best of my knowledge and belief.

Signature

Printed Name

Maria L. Perez

Position

Production Asst.

Company

Southland Royalty Co.

Date

11-18-91

SURVEYOR CERTIFICATION

I hereby certify that the well location shown on this plat was plotted from field notes of actual surveys made by me or under my supervision, and that the same is true and correct to the best of my knowledge and belief.

Date Surveyed

November 5, 1991

Signature & Seal of Professional Surveyor

REGISTERED LAND SURVEYOR
No. 3333
Certificate No. 676
91-17-0260

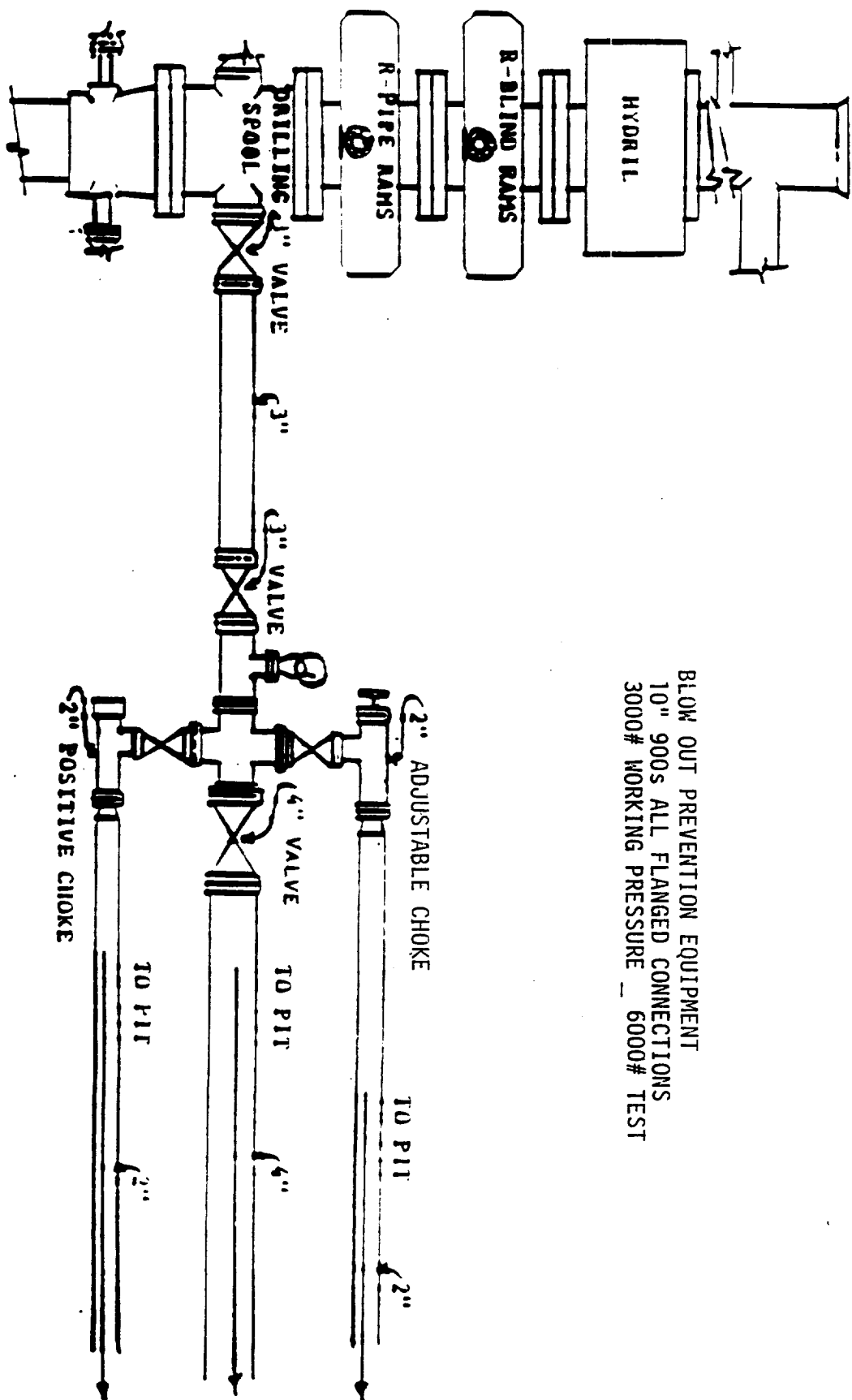

BLOW OUT PREVENTION EQUIPMENT
 10" 900S ALL FLANGED CONNECTIONS
 3000# WORKING PRESSURE _ 6000# TEST