

Submit to Appropriate
District Office
State Lease - 6 copies
Fee Lease - 5 copies

State of New Mexico
Energy, Minerals and Natural Resources Department

Form C-101
Revised 1-1-89

OIL CONSERVATION DIVISION

DISTRICT I
P.O. Box 1980, Hobbs, NM 88240

DISTRICT II
P.O. Drawer DD, Artesia, NM 88210

DISTRICT III
1000 Rio Brazos Rd., Aztec, NM 87410

P.O. Box 2088
Santa Fe, New Mexico 87504-2088

API NO. (assigned by OCD on New Wells)

30-025-31747

5. Indicate Type of Lease

STATE ☒ FEE ☐

6. State Oil & Gas Lease No.

APPLICATION FOR PERMIT TO DRILL, DEEPEN, OR PLUG BACK

1a. Type of Work:

DRILL ☒ RE-ENTER ☐ DEEPEN ☐ PLUG BACK ☐

b. Type of Well:

OIL WELL ☒ GAS WELL ☐ OTHER ☐

SINGLE ZONE ☒ MULTIPLE ZONE ☐

7. Lease Name or Unit Agreement Name

Comanche State (8)

2. Name of Operator

Conoco Inc.

8. Well No.

2

3. Address of Operator

10 Desta Drive, Ste. 100W, Midland, Tx 79705

9. Pool name or Wildcat

Undesignated Delaware

4. Well Location

Unit Letter P : 660 Feet From The South Line and 660 Feet From The East Line

Section 8 Township 21S Range 33E NMPM Lea County

10. Proposed Depth
8950

11. Formation
Delaware

12. Rotary or C.T.
Rotary

13. Elevations (Show whether DF, RT, GR, etc.)

GL 3852.8

14. Kind & Status Plug. Bond

15. Drilling Contractor

16. Approx. Date Work will start

17. PROPOSED CASING AND CEMENT PROGRAM

SIZE OF HOLE	SIZE OF CASING	WEIGHT PER FOOT	SETTING DEPTH	SACKS OF CEMENT	EST. TOP
17 1/2	13 3/8	61	500	550 sx	circ
11	8 5/8	32	5550	1185 sx	circ
7 7/8	5 1/2	17	8950	625 sx	5000

This well is to be drilled as a Delaware oil producer. The following are attached:

1. Well Location and Acreage Dedication Plat
2. Proposed Well Plan Outline
3. Cementing Program Outline
4. BOP Specifications

IN ABOVE SPACE DESCRIBE PROPOSED PROGRAM: IF PROPOSAL IS TO DEEPEN OR PLUG BACK, GIVE DATA ON PRESENT PRODUCTIVE ZONE AND PROPOSED NEW PRODUCTIVE ZONE. GIVE BLOWOUT PREVENTER PROGRAM, IF ANY.

I hereby certify that the information above is true and complete to the best of my knowledge and belief.

SIGNATURE

Jerry W. Hoover
Jerry W. Hoover

TITLE

Sr. Conservation Coordinator

DATE

10/2/92

TYPE OR PRINT NAME

(915) 686-6548

TELEPHONE NO.

(This space for State Use)

ORIGINAL SIGNED BY JERRY SEXTON

APPROVED BY

DISTRICT I SUPERVISOR

TITLE

DATE

CONDITIONS OF APPROVAL, IF ANY:

Permit Expires 6 Months From Approval
Date Unless Drilling Underway.

OCT 29 '92

Submit to Appropriate
District Office
State Lease - 4 copies
Fee Lease - 3 copies

State of New Mexico
Energy, Minerals and Natural Resources Department

Form C-102
Revised 1-1-89

OIL CONSERVATION DIVISION

P.O. Box 2088
Santa Fe, New Mexico 87504-2088

DISTRICT I
P.O. Box 1980, Hobbs, NM 88240

DISTRICT II
P.O. Drawer DD, Artesia, NM 88210

DISTRICT III
1000 Rio Brazos Rd., Aztec, NM 87410

WELL LOCATION AND ACREAGE DEDICATION PLAT

All Distances must be from the outer boundaries of the section

Operator CONOCO INC.			Lease COMANCHE STATE (8)		Well No. 2
Unit Letter P	Section 8	Township 21 SOUTH	Range 33 EAST NMPM	County LEA	
Actual Footage Location of Well: 660 feet from the SOUTH line and 660 feet from the EAST line					
Ground Level Elev. 3852.8'	Producing Formation Delaware		Pool Undesignated Delaware		Dedicated Acreage: 40 Acres

- Outline the acreage dedicated to the subject well by colored pencil or hatchure marks on the plat below.
- If more than one lease is dedicated to the well, outline each and identify the ownership thereof (both as to working interest and royalty).
- If more than one lease of different ownership is dedicated to the well, have the interest of all owners been consolidated by communitization, unitization, force-pooling, etc.?
☐ Yes ☐ No If answer is "yes" type of consolidation _____
If answer is "no" list of owners and tract descriptions which have actually been consolidated. (Use reverse side of this form necessary.)
No allowable will be assigned to the well unit all interests have been consolidated (by communitization, unitization, forced-pooling, otherwise) or until a non-standard unit, eliminating such interest, has been approved by the Division.

OPERATOR CERTIFICATION

I hereby certify that the information contained herein is true and complete to the best of my knowledge and belief.

Signature

Printed Name

Jerry W. Hoover

Position

Sr. Conservation Coordinator

Company

Conoco Inc.

Date

October 2, 1992

SURVEYOR CERTIFICATION

I hereby certify that the well location shown on this plat was plotted from field notes of actual surveys made by me or under my supervision, and that the same is true and correct to the best of my knowledge and belief.

Date Surveyed

SEPTEMBER 26, 1992

Signature & Seal of
Professional Surveyor

Signature
Certificate No.

JOHN W. WEST, 676
RONALD J. EIDSON, 3239
GARY L. JONES, 7877

92-11-1428

PROPOSED WELL PLAN OUTLINE

WELL NAME **COMANCHE STATE 8 NO. 2**
 LOCATION **SECTION 8, T-21S, R-33E**

TVD IN 1000'	MD	FORMATION TOPS & TYPE	DRILLING PROBLEMS	TYPE OF FORMATION EVALUATION	HOLE SIZE	CASING SIZE DEPTH	FRAC GRAD	FORMATION PRESSURE GRADIENT	MUD WEIGHT & TYPE	DAYS
0					17-1/2"	13-3/8", 61# @ .500' W/550 SX			8.4 Native Mud	
1			Red Bed Problems							
2		Top Rustler	Severe Salt Water Flow Possible H2S possible w/ waterflow		11"				10# Brine	
3										
4		Bottom of Salt Top Yates								
5			Lost Circulation into Captain Reef Possible if Reef development is good			8-5/8", 32# @ 5550' W/ 1185 SX				12 & 13
6		Top Delaware	Cl required (120,000 ppm) due to swelling clays						Cut Brine	
7		Top Brushy Canyon			7-7/8"					
8				Logging: GR/ CNL-LDT GR/ DLL-MSFL GR/ BHC SONIC SIDEWALL CORES DIPMETER						19
9		Top Bonespring Proposed TD				5-1/2", 17# LT&C W/ 625 SX				20 & 21
10										
11										
12										
13										
14										
15										
16										

DATE _____

WELL NAME: Comanche State 8 No. 2

LOCATION : 660' FSL & 660' FEL, Sec. 8, T-21S, R-33E

Casing Program

Surface 13 3/8 inch in 17 1/2 hole at 500 ft.
Inter 8 5/8 inch in 11 hole at 5550 ft.
Prod 5 1/2 inch in 7 7/8 hole at 8950 ft.

Cementing Program

Surface

Lead 250 sxs Class C Mixed at 13.3 ppg
Additives 6% Gel. 2% A-7 & 1/4 pps Cello Flake
Tail 200 sxs Class C Mixed at 14.8 ppg
Additives 2% A-7 & 1/4 pps Cello Flake

Intermediate (first stage)

Lead 240 sxs Class C lite Mixed at 12.6 ppg
Additives 0.2% Sodium Metasilicate & 5 pps Gilsonite
Tail 200 sxs Class C Mixed at 14.5 ppg
Additives 5 pps Gilsonite
Percent free water 0 Water loss 500 cc

(second stage)

Lead 985 sxs Class C lite Mixed at 12.75 ppg
Additives 0.2% Sodium Metasilicate + 5 pps Gilsonite + 10% salt
Tail 200 sxs Class C Mixed at 14.5 ppg
Additives 5 pps Gilsonite + 190 CaCl
Percent free water 0 Water loss 500 cc

Production (first stage)

Lead 325 sxs Class C lite Mixed at 12.6 ppg
Additives 0.2% Sodium Metasilicate + 5 pps Gilsonite
Tail 300 sxs Class H Mixed at 15.6 ppg
Additives 0.8% FL-62 + 0.3% CD-32 + 0.2% Sodium Metasilicate
Percent free water 0 Water loss 250 cc

(second stage)

Lead _____ sxs Class _____ Mixed at _____ ppg
Additives _____
Tail _____ sxs Class _____ Mixed at _____ ppg
Additives _____
Percent free water _____ Water loss _____ cc

BOP SPECIFICATIONS

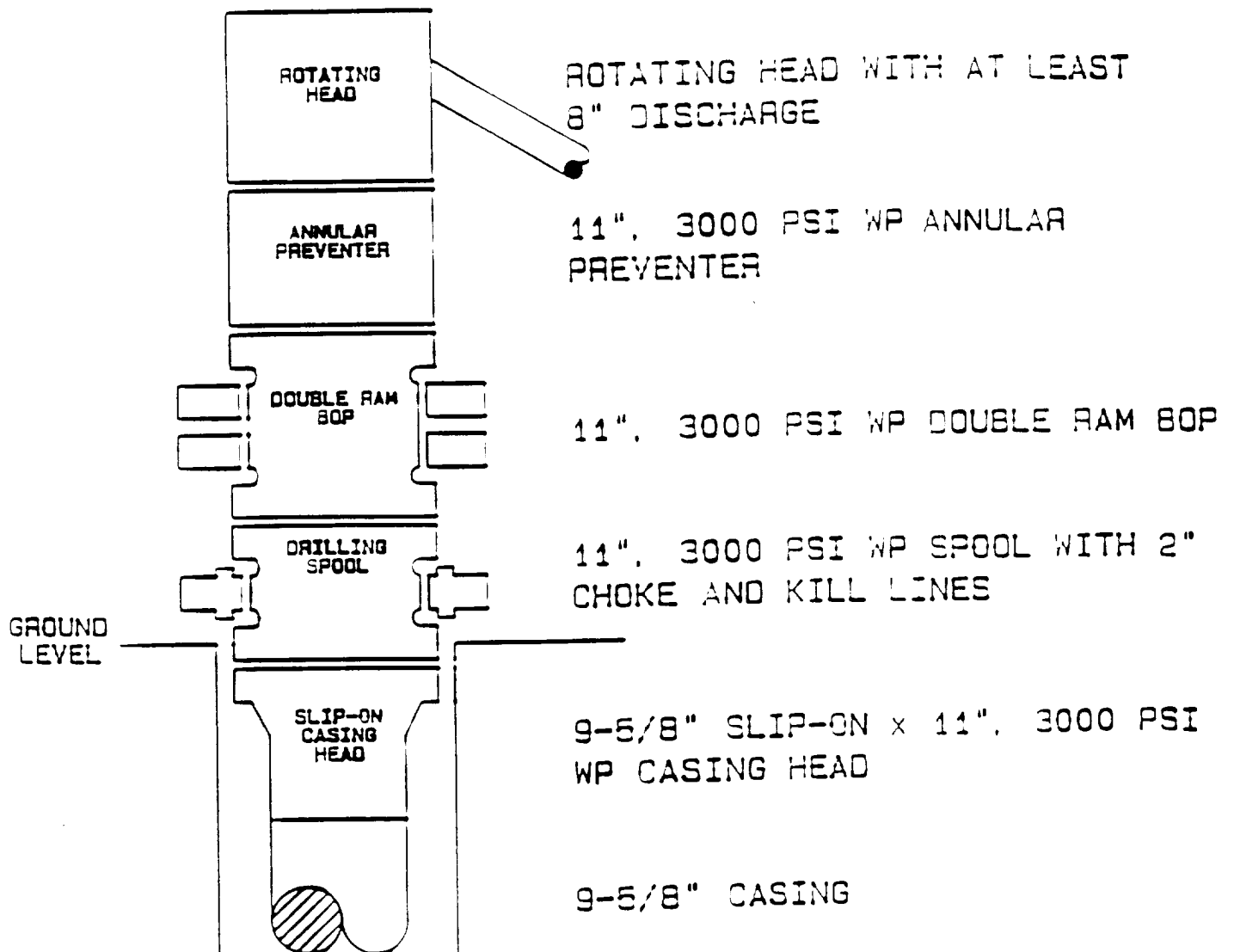

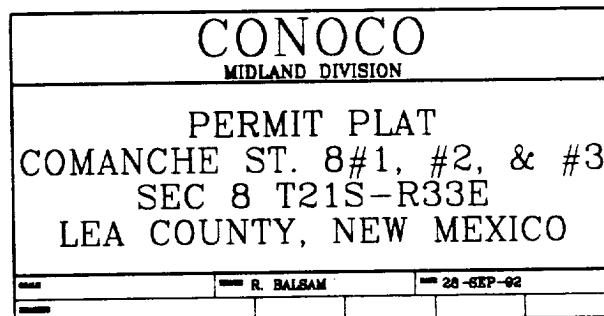

5000 FEET

