

N.M. OIL CONS. COM. FORM 1000
APPLICANT
UNITED STATES
DEPARTMENT OF THE INTERIOR
BUREAU OF LAND MANAGEMENT

30-025-32418
Form approved.
Budget Bureau No. 1004-0136
Expires August 31, 1985

APPLICATION FOR PERMIT TO DRILL, DEEPEN, OR PLUG BACK

1a. TYPE OF WORK

DRILL ☒

DEEPEN ☐

PLUG BACK ☐

b. TYPE OF WELL

OIL WELL ☒

GAS WELL ☐

OTHER

SINGLE ZONE ☒

MULTIPLE ZONE ☐

2. NAME OF OPERATOR

Pogo Producing Company

3. ADDRESS OF OPERATOR

P.O. Box 10340, Midland, Texas 79702

4. LOCATION OF WELL (Report location clearly and in accordance with any State requirements.)*

At surface

330' FNL & 1980' FWL of Sec. 30, T-22S, R-32E

At proposed prod. zone

Same

14. DISTANCE IN MILES AND DIRECTION FROM NEAREST TOWN OR POST OFFICE*

30 miles east of Carlsbad, New Mexico

15. DISTANCE FROM PROPOSED*

LOCATION TO NEAREST
PROPERTY OR LEASE LINE, FT.
(Also to nearest drlg. unit line, if any)

330

16. NO. OF ACRES IN LEASE

600

17. NO. OF ACRES ASSIGNED
TO THIS WELL

18. DISTANCE FROM PROPOSED LOCATION*

TO NEAREST WELL, DRILLING, COMPLETED,
OR APPLIED FOR, ON THIS LEASE, FT.

1650'

19. PROPOSED DEPTH

8600'

20. ROTARY OR CABLE TOOLS

Rotary

21. ELEVATIONS (Show whether DF, RT, GR, etc.)

3597.8' Ground Level

Carlsbad

22. APPROX. DATE WORK WILL START*

Upon approval of application

23.

PROPOSED CASING AND CEMENTING PROGRAM

SIZE OF HOLE	SIZE OF CASING	WEIGHT PER FOOT	SETTING DEPTH	QUANTITY OF CEMENT
17 1/2"	13 3/8"	54.5#	850'	Sufficient to Circulate
11"	8 5/8"	32# & 24#	4500	Sufficient to Circulate
7 7/8"	5 1/2"	17# & 15.5#	8600'	1200 sx

After setting production casing, pay zone will be perforated
and stimulated as necessary.

See attached for: Supplemental Drilling Data
ROP Sketch
Surface Use and Operations Plan

OPER. GRID NO. 017891

PROPERTY NO. 13272

POOL CODE 96036

EFF. DATE 2-16-94

API NO. 30-025-32418

IN ABOVE SPACE DESCRIBE PROPOSED PROGRAM: If proposal is to deepen or plug back, give data on present productive zone and proposed new productive zone. If proposal is to drill or deepen directionally, give pertinent data on subsurface locations and measured and true vertical depths. Give blowout preventer program, if any.

24.

SIGNED

James M.C. Ritchie, Jr.

TITLE

Agent

DATE

July 27, 1993

(This space for Federal or State office use)

PERMIT NO.

APPROVAL DATE

APPROVED BY

AS/ Don Dutton

TITLE

AREA MANAGER

DATE

OCT 12 1993

CONDITIONS OF APPROVAL, IF ANY:

Approval Subject to
Consent of the Bureau and

8/1/93

*See Instructions On Reverse Side

Submit to Appropriate
District Office
State Lease - 4 copies
Fee Lease - 3 copies

State of New Mexico
Energy, Minerals and Natural Resources Department

Form C-102
Revised 1-1-80
RECEIVED

OIL CONSERVATION DIVISION

P.O. Box 2088
Santa Fe, New Mexico 87504-2088

FEB 7 12 28 PM '94

DISTRICT I

P.O. Box 1980, Hobbs, NM 88240

DISTRICT II

P.O. Drawer DD, Artesia, NM 88210

DISTRICT III

1000 Rio Brazos Rd., Aztec, NM 87410

WELL LOCATION AND ACREAGE DEDICATION PLAT

All Distances must be from the outer boundaries of the section

CARL
AREA
ERS

Operator POGO PRODUCING CO.			Lease PROXIMITY "30" FEDERAL		Well No. 1
Unit Letter C	Section 30	Township 22 SOUTH	Range 32 EAST	County NMPM LEA	
Actual Footage Location of Well:					
330 feet from the NORTH line and		1980 feet from the WEST line			
Ground Level Elev. 3597.8'	Producing Formation Delaware	Pool Wildcat	Dedicated Acreage: 48 Acres		

1. Outline the acreage dedicated to the subject well by colored pencil or hachure marks on the plat below.
 2. If more than one lease is dedicated to the well, outline each and identify the ownership thereof (both as to working interest and royalty).
 3. If more than one lease of different ownership is dedicated to the well, have the interest of all owners been consolidated by communitization, unitization, force-pooling, etc.?
☐ Yes ☐ No If answer is "yes" type of consolidation _____
- If answer is "no" list of owners and tract descriptions which have actually been consolidated. (Use reverse side of this form necessary.)
No allowable will be assigned to the well unit all interests have been consolidated (by communitization, unitization, forced-pooling, otherwise) or until a non-standard unit, eliminating such interest, has been approved by the Division.

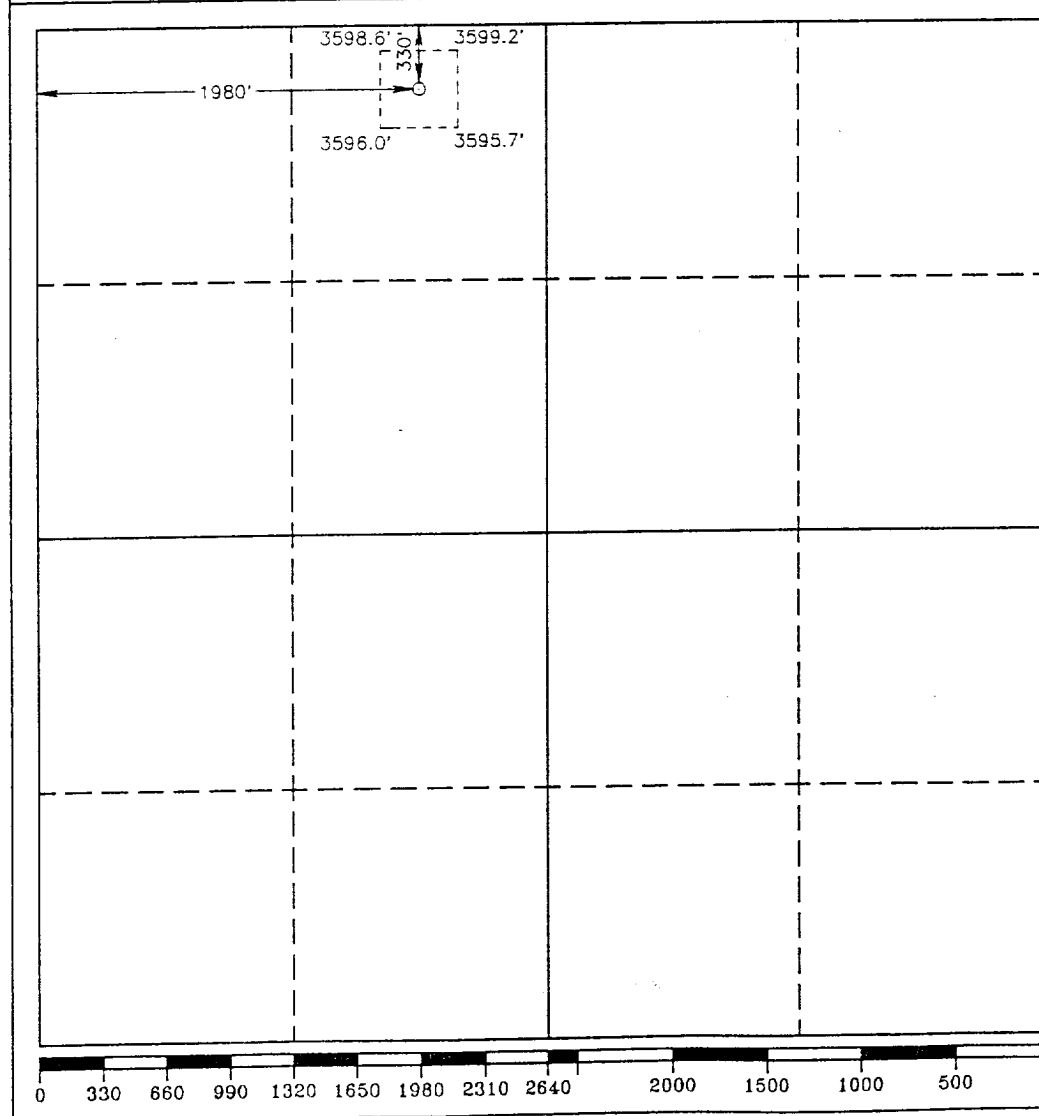

OPERATOR CERTIFICATION

I hereby certify the the information
contained herein is true and complete to the
best of my knowledge and belief.

Signature
Richard L. Wright
Printed Name
Richard L. Wright
Position
Division Operations Mgr.
Company
Pogo Producing Company
Date
February 3, 1994

SURVEYOR CERTIFICATION

I hereby certify that the well location shown
on this plat was plotted from field notes of
actual surveys made by me or under my
supervision, and that the same is true and
correct to the best of my knowledge and
belief.

Date Surveyed
JUNE 25, 1993
Signature & Seal of
Professional Surveyor
Gary L. Jones
Certificate No. **JOHN W. WEST, 676**
RONALD J. EIDSON, 3239
GARY L. JONES, 7927

93-11-1110

SUPPLEMENTAL DRILLING DATA

POGO PRODUCING COMPANY
PROXIMITY "30" FEDERAL WELL NO. 1

1. SURFACE FORMATION: Quaternary.

2. ESTIMATED TOPS OF GEOLOGIC MARKERS:

Rustler Anhydrite	800'
Delaware Lime	4600'
Cherry Canyon	5600'
Brushy Canyon	7300'

3. ANTICIPATED POSSIBLE HYDROCARBON BEARING ZONE:

Delaware	Oil
----------	-----

4. PROPOSED CASING AND CEMENTING PROGRAM:

<u>CASING SIZE</u>	<u>SETTING DEPTH</u>		<u>WEIGHT</u>	<u>GRADE</u>	<u>JOINT</u>
	<u>FROM</u>	<u>TO</u>			
13 3/8"	0	850'	54.5#	J-55	STC
8 5/8"	0	1000'	32#	J-55	STC
"	1000'	2200'	24#	J-55	STC
"	2200'	4500'	32#	J-55	STC
5 1/2"	0	1000'	17#	J-55	LTC
"	1000'	6000'	15.5#	J-55	LTC
"	6000'	8600'	17#	N-80	LTC

MINIMUM DESIGN FACTORS: Collapse 1.125 Burst 1.1 Tension 1.7

13 3/8" casing is to be set at approximately 850' in 17-1/2" hole. Casing to be cemented with 500 sacks of Light cement tailed in with 200 sacks of Class "C". Cement to circulate.

8 5/8" casing is to be set at approximately 4500' in 11" hole. Casing is to be cemented with 1200 sacks of Light cement tailed in with 200 sacks of Class "C". Cement to circulate.

5 1/2" casing is to be set at 8600' in 7 7/8" hole. Casing is to be cemented with 600 sacks of Class "H" cement tailed in with 700 sx Class "C". Cement to tie back to 8 5/8" casing.

5. PRESSURE CONTROL EQUIPMENT:

Blowout prevention equipment, while drilling the 11" hole, will be either a 3000 psi working pressure double ram type preventer or a 3000 psi working pressure annular type preventer.

6. CIRCULATING MEDIUM:

<u>Surface to 850 feet:</u>	Fresh water spud mud. Viscosity 30 to 36 as required for hole cleaning.
<u>850 feet to 4500 feet:</u>	Brine conditioned as necessary for control of viscosity. Weight 9.8 to 10.0. PH 9 to 10. Viscosity 32 to 36.
<u>4500 feet to T.D.:</u>	Water based drilling fluid conditioned as necessary for control of weight, viscosity, ph and water-loss. Weight 9 to 10. Viscosity 38 - 45. ph 9-10. Filtrate while drilling pay zone 6-15.

7. AUXILIARY EQUIPMENT:

A mudlogging trailer will be used while drilling below intermediate casing.

8. TESTING, LOGGING, AND CORING PROGRAMS:

Drill Stem tests will be made when well data indicate a test is warranted.

It is planned that electric logs will include GR-CNL- Density logs and GR-DLL logs.

No coring is planned.

9. ABNORMAL PRESSURES, TEMPERATURES, OR HYDROGEN SULFIDE GAS:

None anticipated.

Expected bottom hole pressure is approximately 3700 psi.

Expected bottom hole temperature is approximately 130 degrees Fahr

10. ANTICIPATED STARTING DATE:

It is planned that operations will commence upon approval of this application, with drilling and completion operations lasting about 30 days.

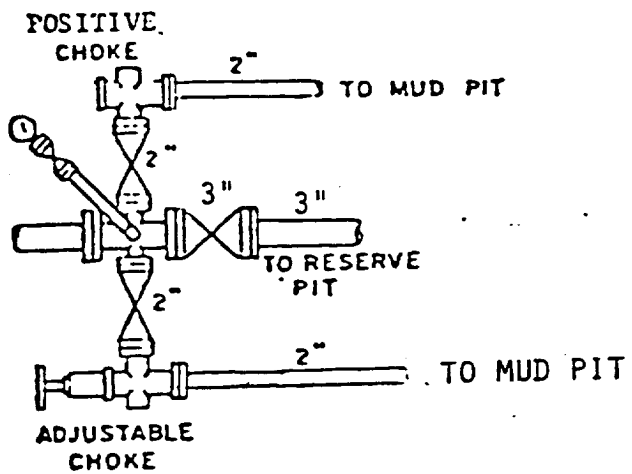
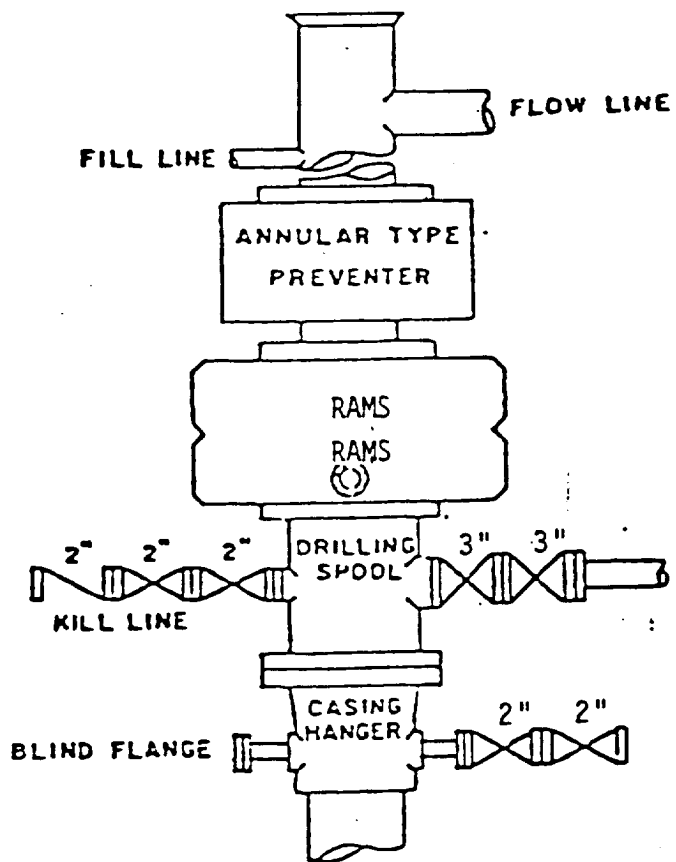

BOP STACK

3000 PSI WORKING PRESSURE

BOP ARRANGEMENT